

FRONTE

12 cm

12,5 cm

AIRTAME Making screens smarter

Airtame Hub

Installation guide

The optimal installation is only a few steps away

Alternative mounting options

Table setup

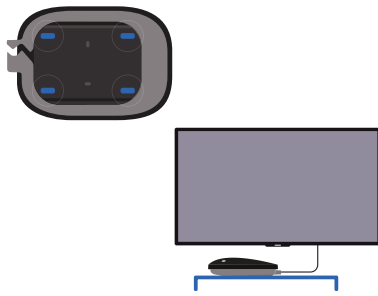

Place Airtame Hub on a flat surface. The Friction Pads on the Mounting Plate prevent the device from sliding, and will also protect the surface against abrasion.

Adhesive setup

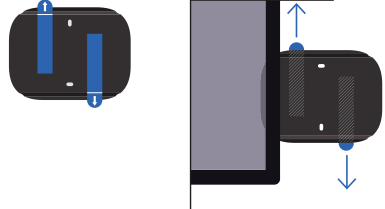

To use 3M Command Strips for mounting Airtame Hub, clean and dry the selected wall surface.

Place the strips on the Mounting Plate making sure the release tabs stick out from under the Mounting Plate as indicated by the printed guides.

Remove the release liner on the Command Strips and mount the Airtame Hub on the wall.

Note: The strips cannot be reused once removed.

Buttons & Ports

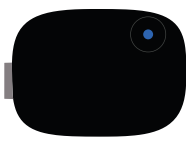

LED Button functions

- Reboot the Airtame Hub
- Wake the Airtame Hub up from Sleep Mode
- Disconnect an ongoing streaming or conferencing session
- LED light indicates power and streaming status

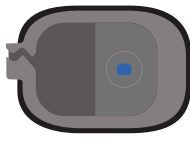

Reset Button functions

- Reset Wi-Fi on the Airtame Hub
- Factory reset the Airtame Hub to go back to original system settings

Power

- 1x PoE+ port: 42.5-57V ≈ max 30W
- 1x DC Power port: 12V ≈ max 30W

Note: When powering the device using Power over Ethernet (PoE), the infrastructure should be compliant with IEEE802.3at Type 2 (also known as PoE+) or higher, in order to provide sufficient power to the device.

Note: The DC Power port is an alternative powering option if your network infrastructure is not PoE+ enabled.

Screens

- 2 x HDMI 1.4 ports to support two screens

Peripherals

- 2 x USB-A 3.0: 5V ≈ max 1.3A
- 1 x USB-C 3.0: 5V ≈ max 1.5A

Note: These ports should not be used to power Airtame Hub.

What's in the box

Airtame Hub

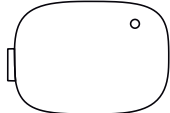

Mounting Plate

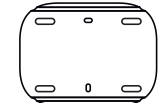

Accessory kit containing

- 1 x HDMI Cable (1 meter = 3'4")
- 2 x Wall screws
- 2 x Wall Plugs
- 2 x 3M Command Strips L

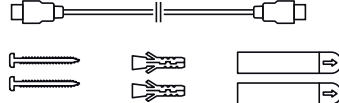

Not in the box

DC Power Adaptor

Required if your network infrastructure is not PoE+ enabled. Can be purchased separately.

Ethernet cable

For power and/or network we Recommended Ethernet cable category for PoE+ is CAT 5e or higher.

Tools you may need

Hex key for locking mechanism
Drill & Screwdriver for mounting on wall

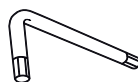

3 cm



Revision I

For further safety related details, please reference the Safety Manual by scanning here



RETRO

12 cm

12,5 cm

Overview

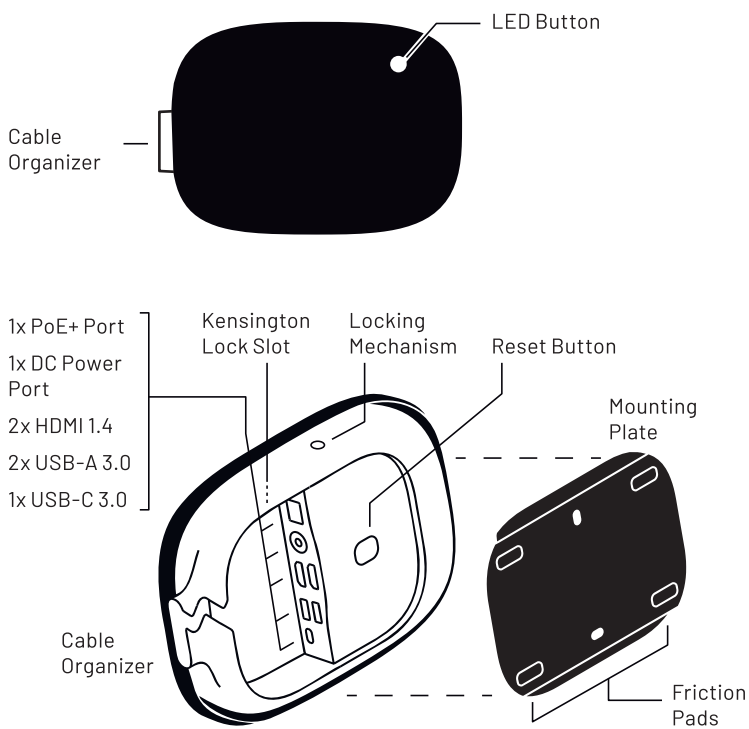

1. Select location

Select location to set up the Airtame Hub

Make sure all cables, ports and peripherals are within the right distance of the Airtame Hub.

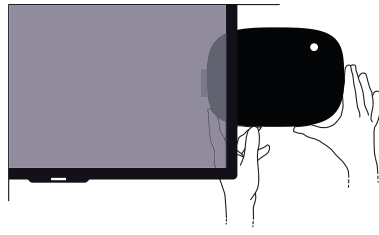

2. Fix Mounting Plate

Remove Mounting Plate from Airtame Hub

Push down on the end of the Mounting Plate by the label

Fix Mounting Plate

Drill holes in the selected location for Wall Plugs.

Insert Wall Plugs in the holes, and fix the Mounting Plate using the Screws (can be found in the Accessory Kit).

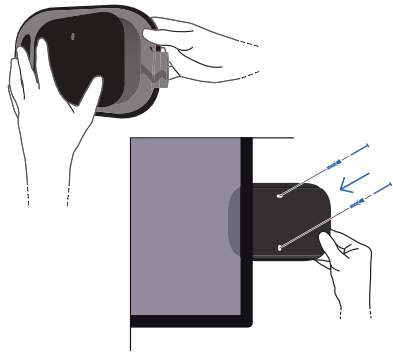

3. Connect cables to Airtame Hub

Connect conferencing peripherals to the USB ports.

Connect screens to HDMI ports.

Power Airtame Hub by connecting an ethernet cable into the PoE+ port. LED Button will light up after a few seconds when connected.

Adjust and align the cables through the Cable Organizer to ensure ports are protected.

You can secure your device with a Kensington Microsaver 2.0, by using the available Kensington lock slot

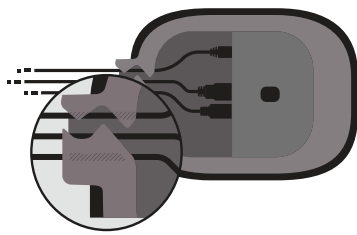

4. Place Airtame Hub

Place Airtame Hub on the Mounting Plate. The magnets will hold it in place.

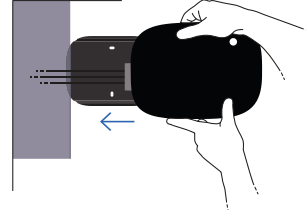

Optional: lock the Airtame Hub to the Mounting Plate.

Use the Locking Mechanism to secure Airtame Hub to the Mounting Plate. This prevents people from tampering with the cable setup.

Use a hex key to engage the Locking Mechanism and secure the Airtame Hub to it.

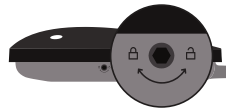

5. Get started with Airtame Hub

To get up and running with Airtame, visit www.airtame.com/setup and follow the instructions.

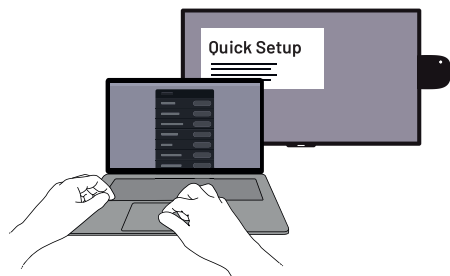

6. Join Airtame Cloud

Add your Airtame Hub to your cloud organization at www.airtame.cloud to enable video conferencing, easy management and much more.



3 cm