

WIRELESS CHARGER&Portable Power

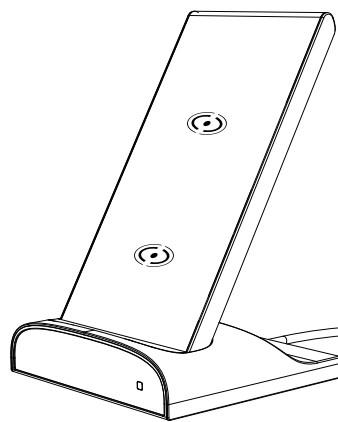

User Manual

Model NO.: TB-WDC02

Thanks for choosing our wireless charging power bank! This is a smartphone wireless charging power bank for Samsung Galaxy S8, S8+, iPhone 8, iPhone 8 Plus, iPhone X, Qi-enabled devices and other digital devices. Please kindly read the user manual before using.

Product Outline

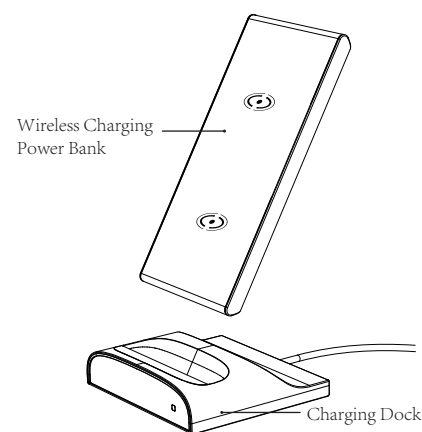

1

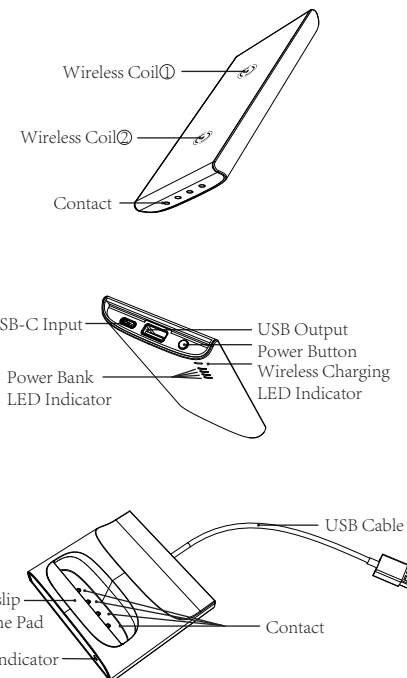

2

Method of use

- Three charging ways
- Whether your smartphone is placed horizontally or vertically, even lying down without cell phone holder, charging is still perfect.

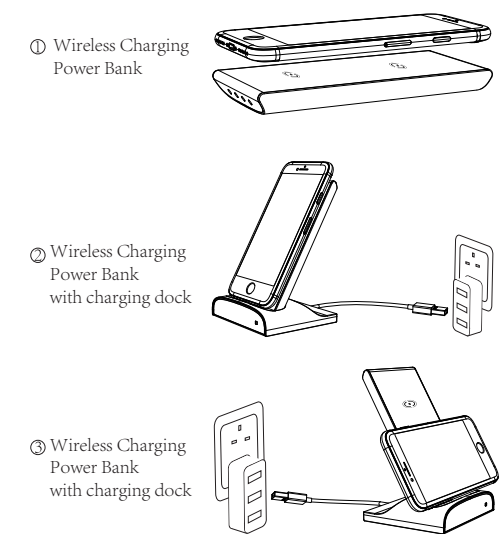

3

Instructions

Connect USB Plug into Compatible Power Supply (for Optimal Charging use Min 2A Charing Supply), or PC/Laptop.

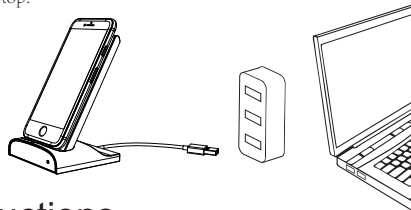

Instructions

Enables pass-through charging while connected to a power source. Power is sent to your smartphone first, and then the TB-WDC02 recharges itself. When TB-WDC02 is in the charging mode, the power indicator shows the charging status in different signs:

Signs:



0%-25%
LED1 BLINK



25%-50%
LED1 ON
LED2 BLINK



50%-75%
LED1-LED2
ON LED3 BLINK



75%-99%
LED1-LED3
ON LED4 BLINK



100%
LED1-LED4 ON

4

- Short press the button for power remain



- The power indicator will turn green (standby or no device under after long press the button for 3 seconds)



GREEN

- Place the mobile with wireless function when the light is under green. The power indicator will turn blue when charging



BLUE

- When charging the stand, the power indicator will remain white

WHITE

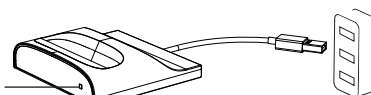

5

Product Specifications

- Charging Dock
Input: DC 5V/2A, DC 9V/1.67A max
- Power Bank
Rated capacity: 5000mAh/18.5Wh
Input: DC 5V/2A
USB Output: DC 5V/2.4A max
- Wireless Charging
Output: 10W
Transmission Distance: < 8mm
Conversion Efficiency: ≥72%

Size

- Wireless Charging Power Bank :
134.15x68x14mm
- Charging Dock :
74.9x84.20x21 mm

Note

- When TB-WDC02 is not connected to power source, priority USB output port charging. USB output port charging and Qi wireless charging couldn't enable at the same time.
- When TB-WDC02 is connected to power source, USB output port charging will be disabled.

6

Products Supplied

- Wireless Charging Power Bank
- Charging Dock
- User Manual

Attention

- Please keep the charger away from water and other liquid.
- Please make sure it is not connected power supply if you need to clean the charger.
- Using environment temperature remains 0-45 C.

7

FCC ID: 2ADDWTB-WDC02

Shenzhen Topband Co.,Ltd

Model name: WIRELESS CHARGER&Portable Power

Model No.: TB-WDC02

This device complies with Part 15 of the FCC Rules.

Operation is subject to the following two conditions: (1) this device may not cause harmful interference, and (2) this device must accept any interference received, including interference that may cause undesired operation.

Changes or modifications not expressly approved by the party responsible for compliance could void the user's authority to operate the equipment.

Note: This equipment has been tested and found to comply with the limits for a Class B digital device, pursuant to part 15 of the FCC Rules. These limits are designed to provide reasonable protection against harmful interference in a residential installation. This equipment generates, uses and can radiate radio frequency energy and, if not installed and used in accordance with the instructions, may cause harmful interference to radio communications. However, there is no guarantee that interference will not occur in a particular installation. If this equipment does cause harmful interference to radio or television reception, which can be determined by turning the equipment off and on, the user is encouraged to try to correct the interference by one or more of the following measures:

- Reorient or relocate the receiving antenna.
- Increase the separation between the equipment and receiver.
- Connect the equipment into an outlet on a circuit different from that to which the receiver is connected.
- Consult the dealer or an experienced radio/TV technician for help.