



1080p Wire-Free Battery Camera

battery camera
Astro

V4.0

Features

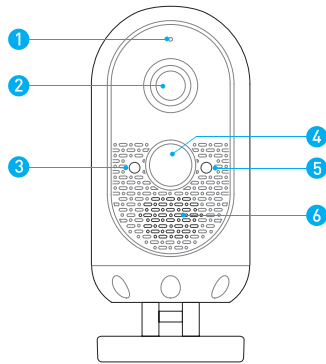

- 1. Microphone
- 2. Wide-angle Lens
- 3. Indicator Lights
- 4. Motion Sensor
- 5. Light Sensor
- 6. Speaker

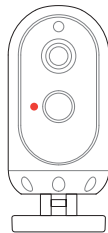

Red Indicator Light

Flashing red
Wi-Fi connection

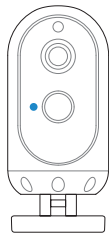

Blue Indicator Light

Blue light
Live view

Flashing blue
Motion detection

In the box

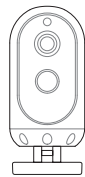

Astro
Battery Camera



Rechargeable
6000mAh
Battery Pack

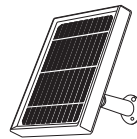

Solar Panel +
Mounting arm

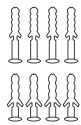

Anchor Packs

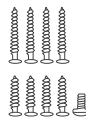

Screw Packs



User Manual

Charge the battery

Charge the included battery.

Fully charge the battery by plugging it into a USB port using a Micro USB cable.

It takes about 6–8 hours for the battery to fully charge. When only one blue LED is lit, that indicates the battery is fully charged.

● = Charging ● = Fully Charged

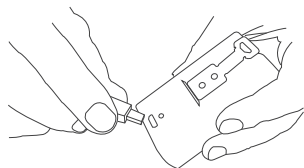

Set up your Astro

1. Attach the stand to the camera.

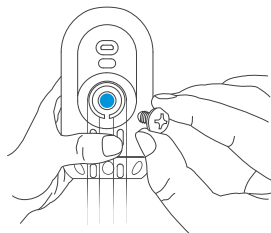

2. Secure tightly with the stand screw.

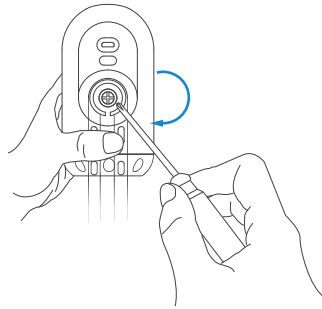

3. Remove the battery cover.

Twist the battery cover counterclockwise to unlock, and then remove it from your Astro.

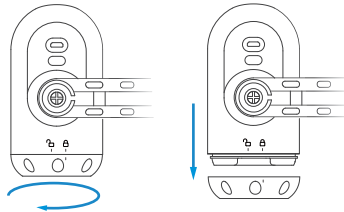

4. Insert a MicroSD card.

Insert a MicroSD card (4GB – 64GB) into the card slot with the label facing the battery compartment. You can eject the card by pressing it into the slot with your fingernail.

Note: Please format your microSD card before use.

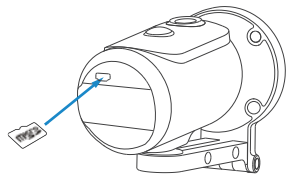

5. Insert the battery.

Insert the fully charged battery into the bottom of your Astro until it clicks into place.

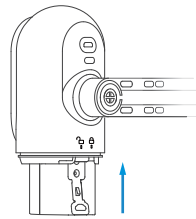

6. Set up your device in the Aiwit app.

Before You Start

1. Download and install Aiwit App.
Scan the QR code below or search for Aiwit on the Apple App Store or Google Play. Download and install the app.
2. Create an Aiwit account.



Aiwit



iOS / Android
App Download

Set up your Astro in the Aiwit app.

To pair your Astro, follow the steps below and in-app instructions.

1. Open Aiwit App and log in to your account.
2. To add your camera, select the + icon.
3. Select **Battery Camera 2**.
4. Press and hold the **Setup Button** until the red light is flashing.
5. Enter your 2.4GHz Wi-Fi network and the Wi-Fi password, then tap **Next** (5GHz is not supported).
6. Use your Astro camera to scan the QR Code shown on the app, then select **Confirm** once the Wi-Fi setup has finished.

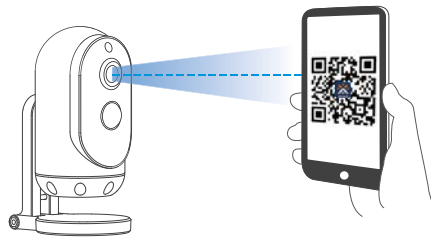

4 inches (10 cm)

7. Attach the battery cover.

Find the Open Lock symbol located behind your Astro. Align the symbol with the line on the battery cover. Push the cover on and turn clockwise until it locks.

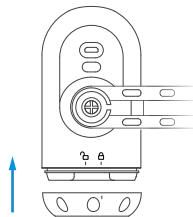

8. Give it a try!

After setup, tap the Live View in the Aiwit app to see live video from your Astro.

Install your Astro

Choose any location.

Place the Astro anywhere, inside or outside your home. It can be mounted on a wall, ceiling, or placed on a tabletop. Put it in an area where you wish to view.



Mounted on a ceiling



Mounted on a wall



Table or shelf

Install the Astro on a ceiling:

Using the axis to rotate the stand, position the base above the camera. Ensure the base is directly positioned above your Astro.

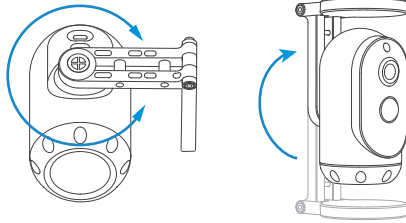

Install the Astro on a wall:

The base is hinged, so rotate the base behind the Astro prior to wall installation.

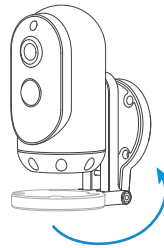

Once you have chosen a wall or a ceiling for your Astro, Mark drill holes and use a bit to drill holes in your wall or ceiling. Insert anchors and secure your Astro with mounting screws.

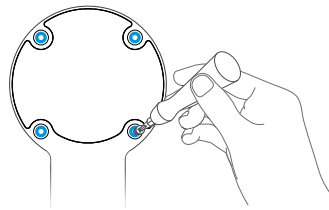

Place the Astro on a flat surface:

Flip the base under the Astro, so it can stand upright. Use the flipped base as a stand for table or shelf placement. Installation is complete. Your Astro is now ready to use!

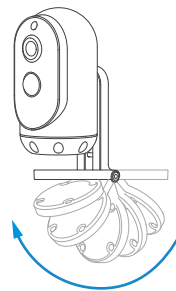

Need help setting up?

If you experience some issues during the app setup, try these steps:

Check your WiFi password.

The most common issue during setup is incorrect Wi-Fi passwords. Passwords are case sensitive. Please double-check your password.

Reboot the router/modem.

If you have entered the correct password, but still experiencing issues, try unplugging the power to your router/modem. Wait for 30 seconds, then plug the power back and turn it back on. Proceed to setup again in the Aiwit app.

Frequently asked questions

How to RESET network settings

Press and hold the Setup Button until red light is flashing. Follow the in-app instructions to finish your Wi-Fi setup.

How to share the device with my family

Open the Aiwit app. From the home page, tap the Share icon. Tap Share via Email or Share via QR Code. You can share the device with up to 8 users.

Share via Email:

The new user has to download the Aiwit app and create an account with the same email address which the device owner has shared with. Log in to the account and you'll see the shared device.

Share via QR Code:

1. Open the Aiwit App on a new user's smartphone.
2. From the home page, tap +.
3. Tap **QR Code Sharing**, then scan the QR code the device owner generated before.
4. You will see **Share successful**, then tap **Confirm**.

How many users can view the video at the same time?

Up to 3 users may view the video feed, but only 1 user can use the direct intercom. Both iOS and Android are compatible.

Is 5GHz Wi-Fi supported?

No. Only 2.4GHz Wi-Fi is supported.

Why is my Wi-Fi signal poor on my device?

Your device may be too far away from your wireless router or you may have some obstructions in between that reduce signal strength. You might try repositioning your router or getting a signal extender/repeater for your wireless router.

How to adjust Motion Detection Sensitivity

From the home page, tap Motion Detection icon.

Motion Detection Sensitivity

- Fast: Records and notifies you about every motion. Shortest battery life.
- Medium: Records and notifies you about motion less often. Standard battery life.
- Slow: Records and notifies you about motion even less often. Maximum battery life.

How to enable Notifications on my phone

To do this, you need to give permission for the Aiwit app to access to your microphone and enable notifications. Follow these steps to enable notifications.

1. Open Settings. Go to Aiwit app permissions and select Notifications.
2. Make sure all switches are on.

What size MicroSD card should I use?

This device is compatible with 4GB, 8GB, 16GB, 32GB and 64GB capacity microSD cards. We recommend only purchasing name brand microSD cards through official resellers.

Install your Solar Panel

Please complete the battery camera setup in the App prior to installing the solar panel.

1. Choose the installation location

Pick an unshaded spot for best sun exposure. The solar panel should be installed where it will receive several hours of direct sun daily.

2. Mark your spot

Place the solar panel mounting arm mark where you plan to install, and mark the screw hole positions lightly with a pencil.

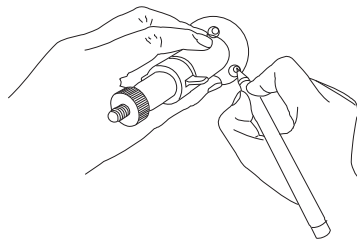

3. Drill the holes

Optional: You may opt to use a drill bit to drill the holes where you have previously marked.

- For mounting surfaces that are brick, concrete, or stucco, please use the plastic anchors. You may need to use a hammer to install the anchors.

- For mounting surfaces that are wood or vinyl, you can omit the anchors, and use the screws directly.

4. Install the mounting arm

Use a screwdriver to secure the mounting arm to the wall, tighten securely.

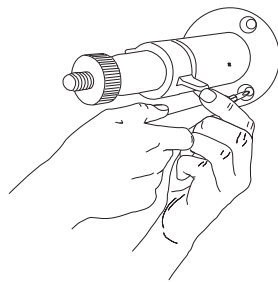

5. Attach the solar panel

Attach the solar panel onto the mounting arm, ensure that it is installed correctly.

Note: You may adjust the angle of the solar panel for better sun coverage. Simply loosen the adjustment screw on the mounting arm, adjust to desired angle, and re-tighten the screw.

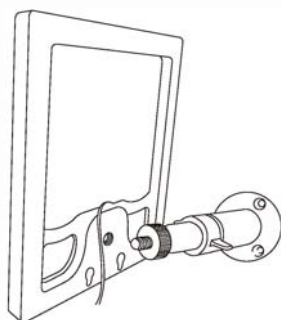

6. Plug the cable

Lastly, plug the solar panel charging cable into the Astro. Let's start charging!

FCC Statement:

Changes or modifications not expressly approved by the party responsible for compliance could void your authority to operate the equipment.

This equipment has been tested and found to comply with the limits for a Class B digital device, pursuant to Part 15 of the FCC rules. These limits are designed to provide reasonable protection against harmful interference in a residential installation. This equipment generates, uses and can radiate radio frequency energy and if not installed and used in accordance with the instructions, may cause harmful interference to radio communications. However, there is no guarantee that interference will not occur in a particular installation. If this equipment does cause harmful interference to radio or television reception, which can be determined by turning the equipment off and on, the user is encouraged to try correct the interference by one or more of the following measures:

- Reorient the receiving antenna.
- Increase the separation between the equipment and receiver.
- Connect the equipment into and outlet on a circuit different from that to which the receiver is connected.
- Consult the dealer or an experienced radio/TV technician for help.
- This device complies with Part 15 of the FCC rules. Operation is subject to the following two conditions: 1) this device may not cause harmful interference, and 2) this device must accept any interference received, including interference that may cause undesired operation.
- The equipment comply with FCC radiation exposure limits set forth for an uncontrolled environment. This equipment should be installed and operated with minimum distance 20cm between the radiator and your body.

CE NB

Herby, EKEN GROUP LIMITED declares that this battery camera, Astroids in compliance with the essential requirements and other relevant provisions of Directive 2014/53/EU. In accordance with Article 10(2) and Article 10(10), this product allowed to be used in all EU member states.

Use the battery camera in the environment with the temperature between -10°C and 45°C,

Risk of explosion if battery is replaced by an incorrect type.

Dispose of used batteries according to the instructions.

Operation Frequency: 2412MHz~2472MHz

(802.11b/802.11g/802.11n(HT20))

2422MHz~2462MHz (802.11n(HT40))

max output power: 0.0092W

Manufacturer: EKEN GROUP LIMITED

Address: Room 2511-2512, Meilan Business Center,
Qianjin Two Road, XiXiang, Baoan District, Shenzhen,
Guangdong, China

Tel: +86-755-85261055

Fax: +86-755-85261055-802

E-mail: Amanda@eken.com

DECLARATION OF CONFORMITY

I hereby declare that the product

Product:

Product Name: battery camera
Model: Astro, Argus, Astro 2, Astro 3, Astro 4, Astro5, Astro 6, Astro 7, Astro 8, Astro 9, Argus 2, Argus 3, Argus 4, Argus 5, Argus 6, Argus 7, Argus 8, Argus 9
Brand Name: N/A
Hardware Version: SATROMANV2.0
Software Version: SOCS 4.4, MCU 1.5.6

Accessories:

Battery information:
Model: CB192
Specification: 3.7V, 6000mAh, 22.2Wh
Manufacturer: Shenzhen Puje Electronics Co., Ltd.
Fixed mount#1
Model: bracket
Size: 6cm in diameter and 15.5cm in height
Manufacturer: Shenzhen Meige Plastic Technology Co., Ltd
Fixed mount#2
Model: 503 aluminum bracket
Size: 120mm high
Manufacturer: Anshijia metal products factory
Solar panels
Model: FC087
Maximum power(Wp): 3.3W
Maximum power voltage(V): 5.5V
Maximum power current(A): 0.6A
Manufacturer: Pioneer Electronics

(Name of product, type or model, batch or serial number)

satisfies all the technical regulations applicable to the product within the scope of Council Directives 2014/53/EU, 2014/95/EU and 2014/30/EU and declare that the same application has not been lodged with any other notified body.

EN 62368-1:2014-A11:2017

EN 62311:2008

Draft ETSI EN 301 489-17 V2.2.2 (2019-12)

ETSI EN 301 488-1 V2.2.3 (2019-11)

ETSI EN 300 328 V2.2.2 (2019-01)

(Title(s) of regulations, standards, etc.)

All essential radio test suites have been carried out.

NOTIFIED BODY: MICOM Labs Inc

- Address:

575 Boulder Court
Pasadena, California 91456
USA
Identification Number: 2260

MANUFACTURER or AUTHORISED REPRESENTATIVE:

- Address:

EKEN GROUP LIMITED
Room 2511-2512, Meilan Business Center, Qianjin Two Road, Xixiang, Baoan District, Shenzhen, Guangdong, China

This declaration is issued under the sole responsibility of the manufacturer and, if applicable, his authorised representative.

Point of contact:

Amanda Liang, +86-755-85281055/+86-755-85281055-802
(Name, telephone and fax number)

2020-10-13
(Place, date of issue)

(Signature)

Amanda Liang, Sales manager

(Name and title in block letters)