

Quick installation guide for CO 11.01 Gateway (1/3)

1. Before you begin please make sure that you have the following items at hand:

- A. Gateway
- B. 2 x antennas (long)
- C. 1 x antenna (short)
- D. Wall adapter
- E. GPS antenna (optional)

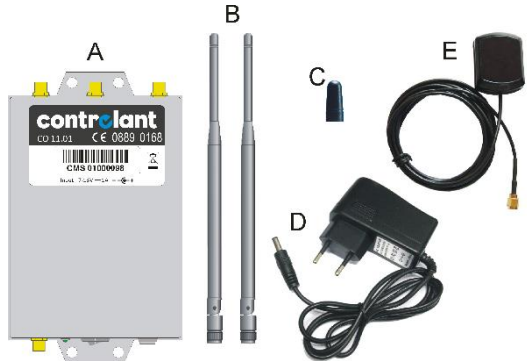

2. Fasten the all antennas (B C and E) to the gateway (A) and screw tight.
3.

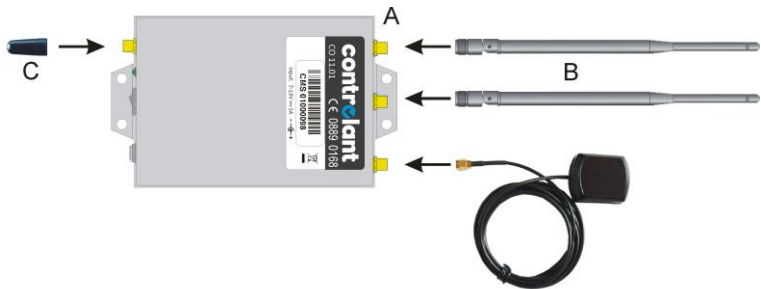

4. Plug the wall adapter (D) and to an available wall socket (110/220 Vac).
5. Plug the wall adapter plug into the gateway (F).

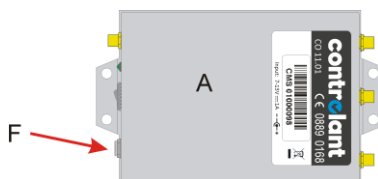

Quick installation guide for CO 11.01 Gateway (2/3)

6. Turn the gateway ON (G).

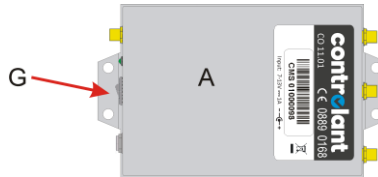

7. Wait until the power light (H) lights green and blinks (turns off shortly) every 4 seconds.

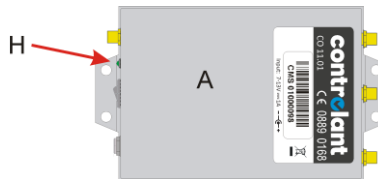

8. Make sure that the gateway (A) is securely mounted with the antennas pointing upwards. For optimal functionality avoid mounting the transceiver on metal surface and try to have as few obstacles between the Transceiver and the wireless sensors as possible.

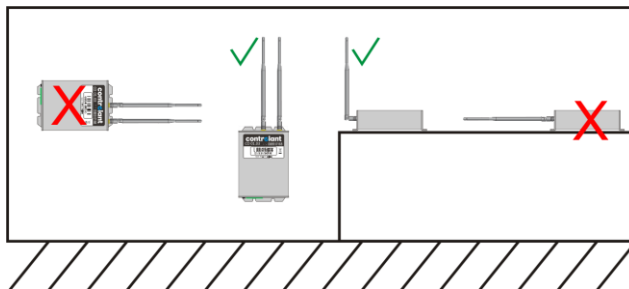

9. Please email or call our support desk for further information or assistance if needed.

Quick installation guide for CO 11.01 Gateway (3/3)

FCC Regulatory notices

Interference statement

This device complies with Part 15 of the FCC Rules and Industry Canada license-exempt RSS standard(s). Operation is subject to the following two conditions: (1) this device may not cause interference, and (2) this device must accept any interference, including interference that may cause undesired operation of the device.

Wireless notice

This equipment complies with FCC and IC radiation exposure limits set forth for an uncontrolled environment. The antenna should be installed and operated with minimum distance of 20 cm between the radiator and your body.

FCC Class B digital device notice

This equipment has been tested and found to comply with the limits for a Class B digital device, pursuant to part 15 of the FCC Rules. These limits are designed to provide reasonable protection against harmful interference in a residential installation. This equipment generates, uses and can radiate radio frequency energy and, if not installed and used in accordance with the instructions, may cause harmful interference to radio communications. However, there is no guarantee that interference will not occur in a particular installation. If this equipment does cause harmful interference to radio or television reception, which can be determined by turning the equipment off and on, the user is encouraged to try to correct the interference by one or more of the following measures:

- Reorient or relocate the receiving antenna. - Increase the separation between the equipment and receiver.
- Connect the equipment into an outlet on a circuit different from that to which the receiver is connected.
- Consult the dealer or an experienced radio/TV technician for help.