

Bluetooth Speaker User Manual

Model: K23

Product features

- 1: You can be connected with the MP3,PC,iPod,CD and other audio source.
- 2: Bluetooth 2.1 EDR
- 3: Design in a high-quality audio decoder chip, perfect sound performance
- 4: Use a high-fidelity full-range speaker, middle and high ,bass hierarchy.

Technical Parameters

Output power: 3mW

Input charging voltage: DC5V \pm 10%

Frequency response: 20Hz-20KHz

SNR: \geq 85dB

Distortion (%): $<$ 1

Bluetooth communication distance: $>$ 10m

Operating Instructions

(1) Bluetooth Pairing

a: Short press the ON/OFF button to turn on, after that,it's defaulted to be a Bluetooth connection mode .

b:The first will enter a pairing mode when connecting with a Bluetooth device , the machine called Bluetooth: UB-SPB25-101, no password,click the UB-SPB25-101 to connect ,the connection will be successful .

c: After the pairing is successful ,the machine will automatically search for the last device. If it found it ,Bluetooth device will automatically connect.If it do not search to the last device within 10 seconds, then enter the status of wait for a connection

d: When in a Bluetooth connection with your phone, press Play, Pause, call button, you can answer /hang up, long press the keys ,you can redial last phone number.

(3) LINE IN input function

When in a turned on mode, insert the LINE IN input line, it is automatically converted to the LINE IN function; for mobile phones, computers, MP3 and other equipment to make use of external speakers .

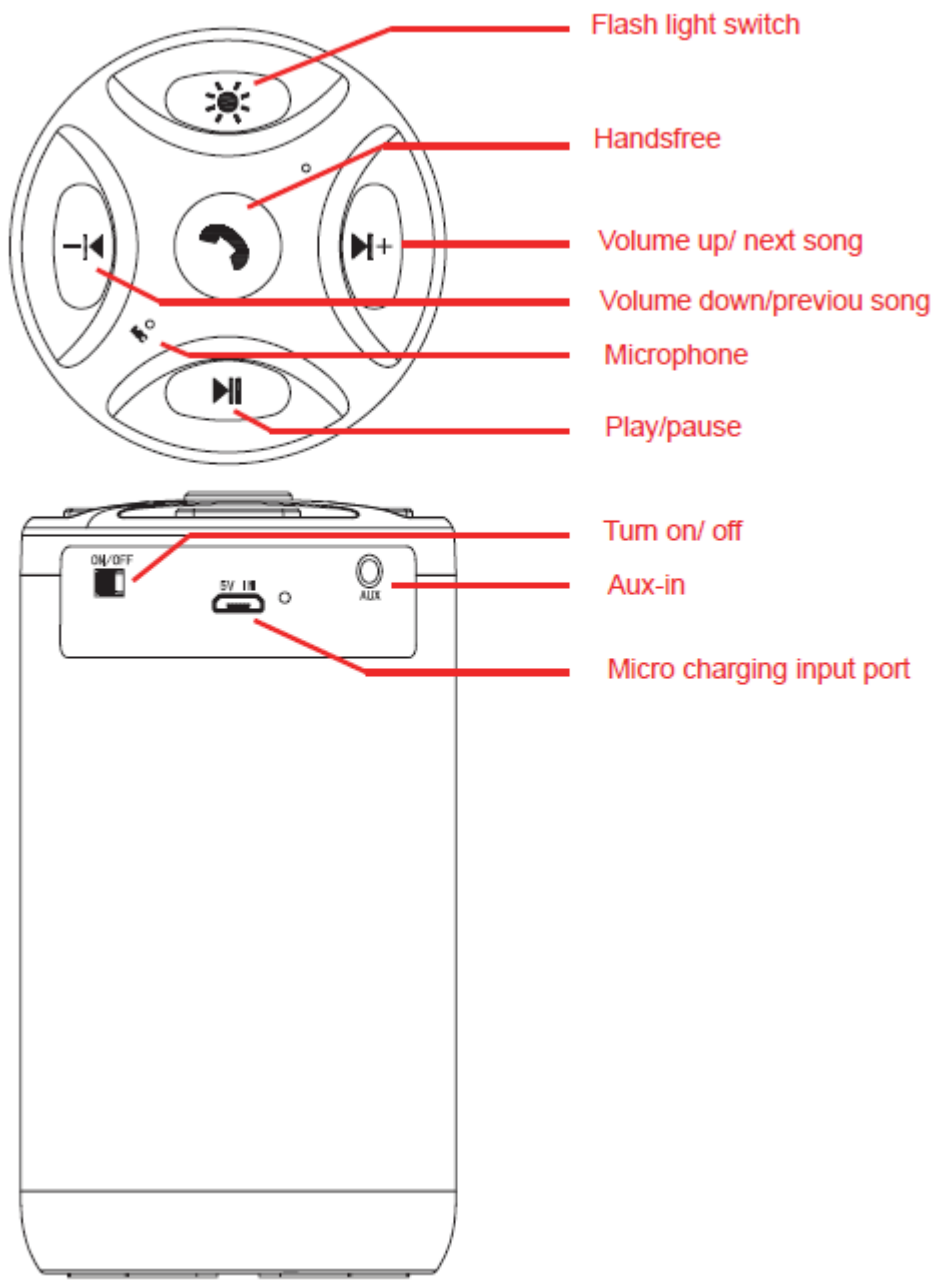

FCC Warning:

This equipment has been tested and found to comply with the limits for a Class B digital device, pursuant to part 15 of the FCC Rules. These limits are designed to provide reasonable protection against harmful interference in a residential installation. This equipment generates, uses and can radiate radio frequency energy and, if not installed and used in accordance with the instructions, may cause harmful interference to radio communications. However, there is no guarantee that interference will not occur in a particular installation. If this equipment does cause harmful interference to radio or television reception, which can be determined by turning the equipment off and on, the user is encouraged to try to correct the interference by one or more of the following measures:

- Reorient or relocate the receiving antenna.
- Increase the separation between the equipment and receiver.
- Connect the equipment into an outlet on a circuit different from that to which the receiver is connected.
- Consult the dealer or an experienced radio/TV technician for help.

Caution: Any changes or modifications to this device not explicitly approved by manufacturer could void your authority to operate this equipment.

This device complies with part 15 of the FCC Rules. Operation is subject to the following two conditions: (1) This device may not cause harmful interference, and (2) this device must accept any interference received, including interference that may cause undesired operation.