

7 Maintenance and cleaning

NOTE

Observe country-specific Regulations!

Some countries have legal regulations which require regular safety inspections of electrical devices or systems by the operator.

NOTE

Perform maintenance regularly!

Observe the regular maintenance intervals (see "Maintenance intervals [-> 53]").

NOTE

Observe error messages

You must observe error messages shown on the display on in the software. If the error message does not disappear even after you have performed the prompted action, contact your service engineer.

⚠ CAUTION

Observe the requirements regarding the environment and cleaning aids

When cleaning and disposing of operating materials, make sure that this always takes place in a well-ventilated room and that protective goggles and gloves are worn.

⚠ CAUTION

Replace the activated carbon filter at regular intervals

The activated carbon filter must be replaced regularly.

- Replace the activated carbon filter when prompted to do so on the unit's display.

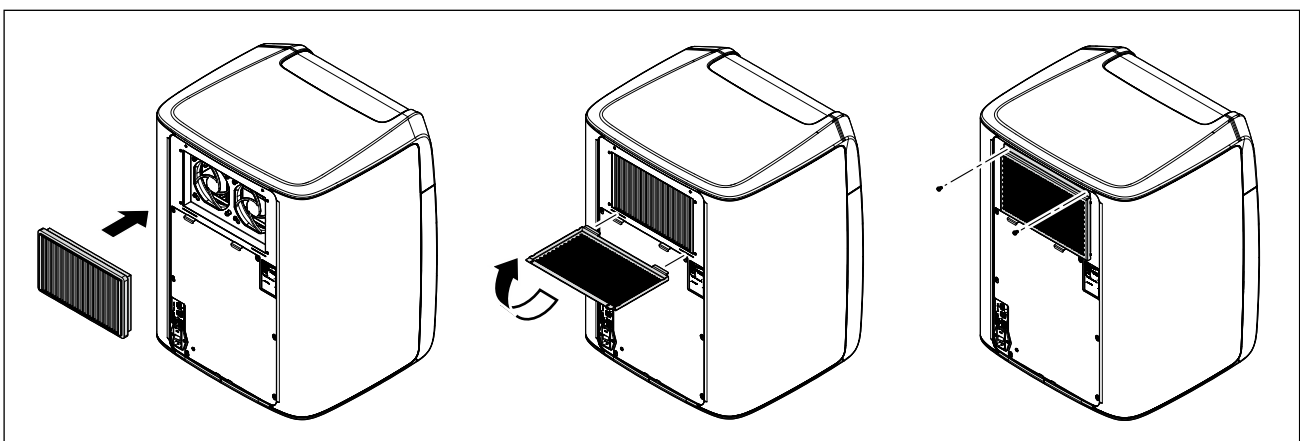

7.1 Care, cleaning agents, and disinfectants

NOTE

Approved care, cleaning, and disinfecting agents

Use only care, cleaning, and disinfecting agents approved by Dentsply Sirona!

A continuously updated list of approved agents can be downloaded on the internet from the online portal for technical documents. You can reach this portal at the address:

www.dentsplysirona.com/manuals

Click on the menu items "*General documents*", "*All products*" and then open the "*Care, cleaning and disinfection agents*" document (REF 59 70 905).

7.2 Maintenance intervals

| Interval | Scope of maintenance |
|------------------------|--|
| Daily (recommended) | Wiping out the machining chamber at the end of the work day. |
| Weekly | - |
| Monthly | - |
| Annually (recommended) | System maintenance by service technician using the Primeprint PPU maintenance kit (REF 6762939). |

7.3 Cleaning surfaces

NOTE

Do not allow liquids to run into the ventilation slots!

7.3.1 Disinfecting

Wipe surfaces down with a surface disinfectant (wiping disinfectant, see "Care, cleaning agents, and disinfectants [→ 53]").

Observe the manufacturer's instructions regarding restrictions for use.

7.3.2 Protection against medicaments

Due to their high concentrations and the substances they contain, many medicaments can dissolve, etch, bleach or discolor surfaces. Therefore, any substance that comes into contact with the unit should be immediately removed.

NOTE

Damage to the surface

Clean the surface immediately with a moist cloth and a cleaning agent.

7.3.3 Cleaning of contamination

Remove dirt, grime and disinfectant residue regularly using mild, commercially available cleaning agents.

7.4 Cleaning the build platform

CAUTION

Risk of injury when reaching into the build chamber

There is the risk of cut and crush injuries caused by sharp edges and movable parts.

➤ Be sure not to touch the sharp edges and movable parts.

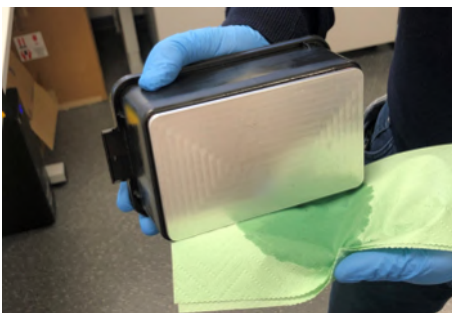

1. Remove all residues from the build platform using the spatula.

2. In addition, clean the build platform with a paper towel moistened with a little isopropanol.

3. First pull the paper towel over the edge and then, if necessary, over the entire surface of the build platform until there is no residual resin left.

NOTE

Film can become irreversibly damaged

In rare cases, buildups can occur on the film on the bottom of the vat.

- Remove them very carefully with the supplied plastic playing card (playing card set: REF 6753631).
- Never use a spatula or other tools, as you could irreversibly damage the film.

7.5 Resetting the vat for use of another material

CAUTION

Handling isopropanol 99%

Follow the instructions for using isopropanol set forth by the manufacturer's instructions for use. Wear gloves and protective goggles and only work in well-ventilated rooms.

Isopropanol 99%, disposable gloves, absorbent paper towels and a mouthguard is required to clean the vat.

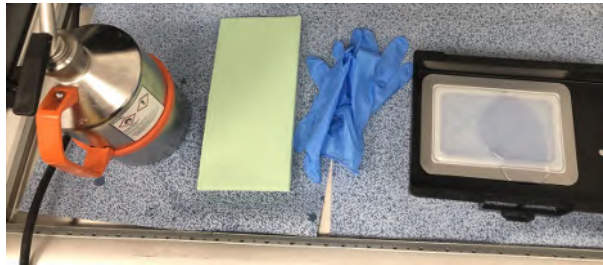

We recommend that you also cover the work surface with absorbent fleece before cleaning.

7.5.1 Removing the cover of the material unit

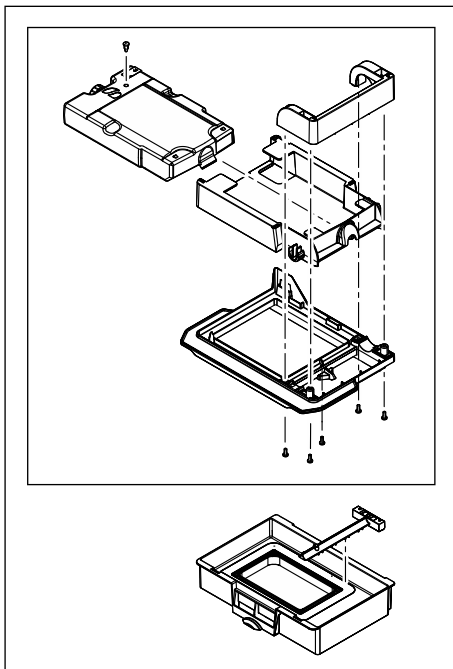

In order to clean the vat, replace the film insert or remove the wiper, the cover of the material unit must be removed so that you have free access to the vat. Always wear gloves during all steps of the vat cleaning process.

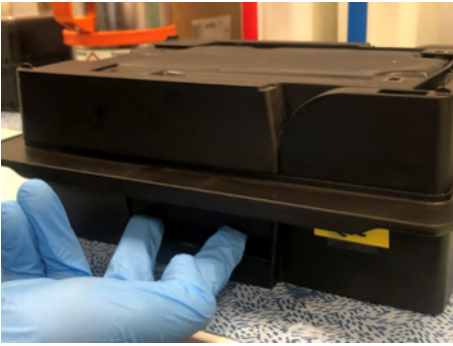

1. To remove the cover, first lever the slats forward with your index finger and middle finger.

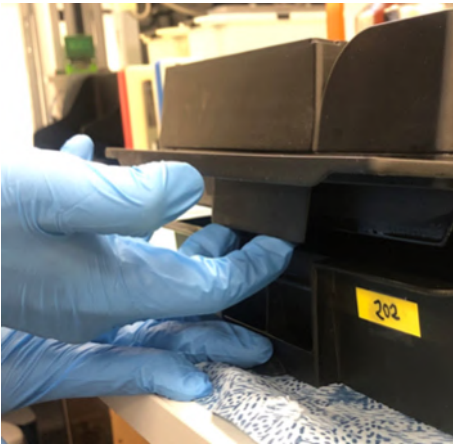

2. With the other hand, fix the vat so that you can fold the cover up and away.



3. Use both hands to lift up the cover of the material unit. Place the cover on a separate paper towel to keep the furniture surfaces clean.

7.5.2 Changeover/cleaning of the vat

IMPORTANT

The procedure described here should be carried out quickly step by step. Do not leave the vat open with residual resin, as the residual resin stocks could harden and then block the leak tightness of the vat.

1. Remove the cover of the material unit by opening the lock.
2. Use the supplied tweezers to remove the wiper/recoater from the vat.
3. Remove the remaining material from the vat into a disposal container. Observe the disposal instructions of the material manufacturer.
4. Fill approx. 100 ml isopropanol 99% into the vat so that the entire vat floor is covered and the isopropanol can reach all places inside the vat. Allow it to act for approx. 5 min.

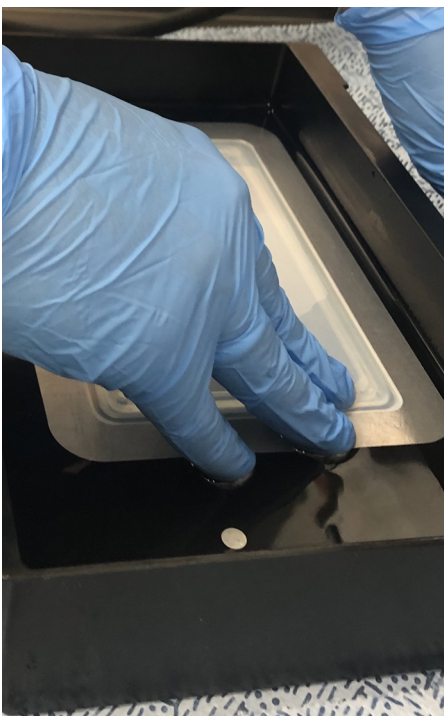
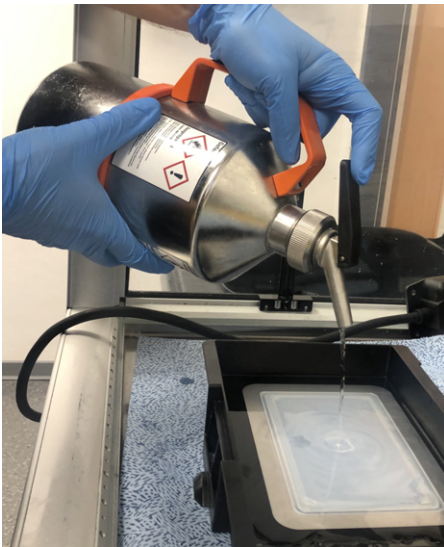

5. Remove the resin residues by rubbing the entire vat floor with your fingers until no residues stick to the vat floor.
6. Clean the wiper in a separate container with 99% isopropanol. The best way is to rub off the resin residues with your fingers in isopropanol.

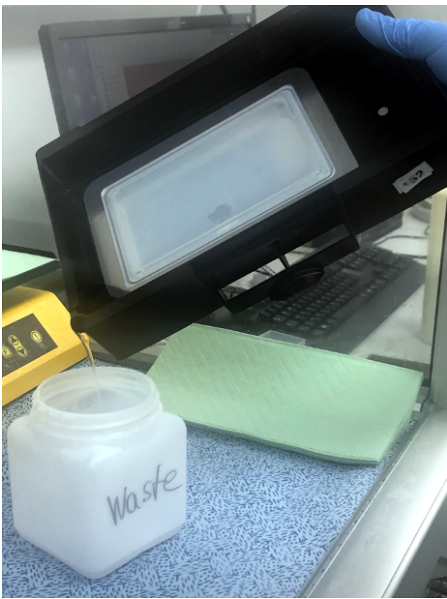

7. Empty the isopropanol with the residual resin from the vat into a reclosable disposal container provided for this purpose.

NOTE

Observe the local waste disposal regulations.

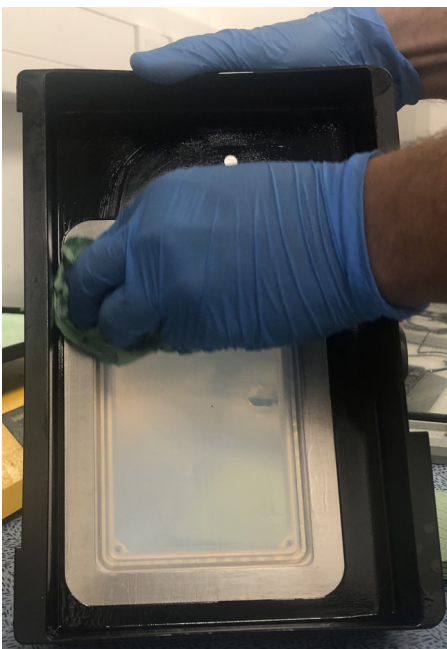

8. Wipe the vat with a clean cleaning cloth. Make sure that all resin residues are removed.
9. For fine cleaning, add a small amount of isopropanol to the edges of the film insert and clean these joints.
10. Repeat the last 3 steps.
11. Dispose of the gloves. Fresh clean gloves should also be worn when replacing the film (see "Replacing the film insert [→ 60]").
 - ↳ The vat has been cleaned and can be used for another material.

7.5.3 Replacing the film insert

If the service life of the film in a vat is exhausted, this is shown on the touch display.

Proceed as follows to replace the film insert:

1. Follow the instructions for cleaning the vat (see "Changeover/cleaning of the vat [-> 58]").
↳ The vat has been cleaned and the film insert can be replaced.
2. Use clean gloves to protect yourself from residual resin.
3. Start by rotating the vat.
4. Unscrew the screws of the film insert on the rear of the vat using the torque wrench (TX10) provided.

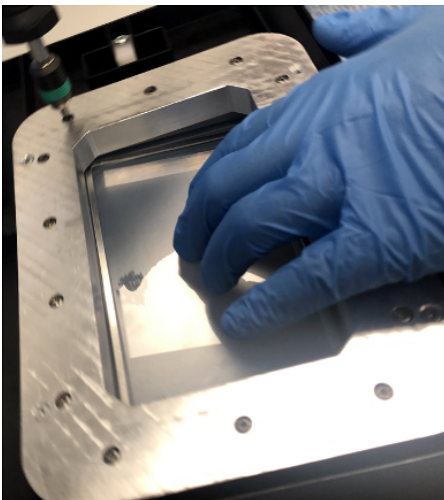
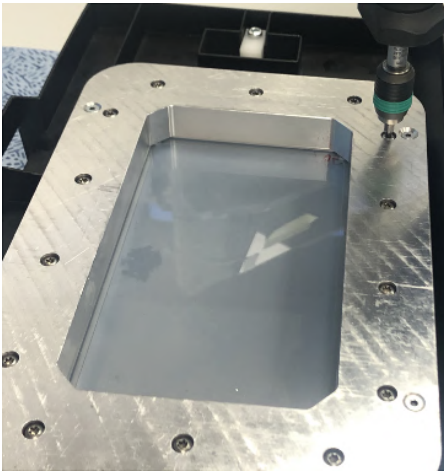

5. Before unscrewing the last screw, exert a light pressure on the film insert so that it detaches from the vat.
6. Then rotate the vat back again and carefully shake out the loose screws.
7. Remove the blue sealing ring with a paper towel soaked in isopropanol to remove any resin residues and to ensure that the new film insert is installed tightly.
8. Take a new film insert (REF 6744911) and insert it into the vat.
9. Retighten the screws with the torque wrench provided for this purpose.

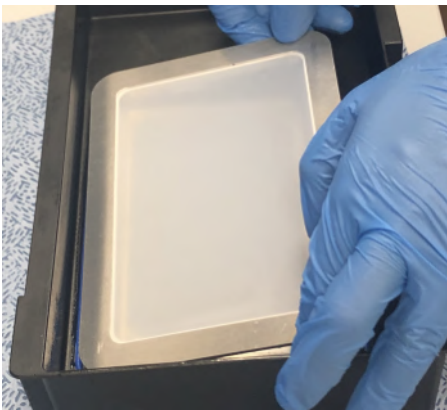

10. Insert the tenter from above into the vat frame.

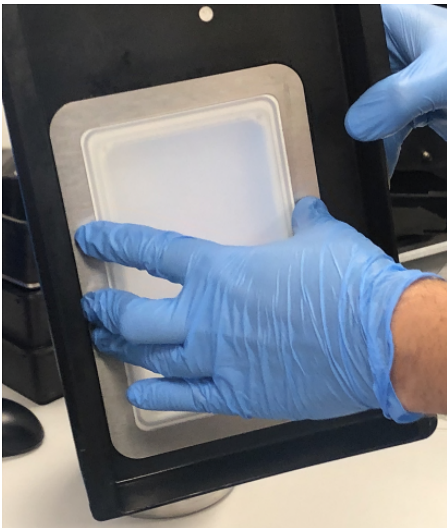

11. Now put one hand on the tenter to fix it and rotate the entire vat so that you can now place a first screw.

Tip: In order to have your hands free, you can also place the vat on a pedestal from below, before fixing it).

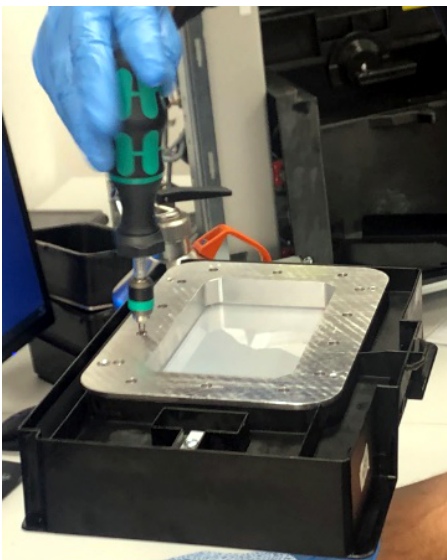

12. Using the torque wrench (TX10) supplied, first tighten two opposite screws until the torque is reached (audible click).

13. Then tighten all further screws accordingly.

Tip: Before reusing the vat, fill it with water so that the bottom of the vat is covered and leave the vat stand like this for about 15 min. Then check whether water has leaked anywhere. If you have followed all steps of these instructions, this should not be the case. If it is leaking, redo the entire film replacement procedure.

7.5.4 Insert the wiper and cover of the material unit back on the vat

After cleaning and/or replacing the film insert of the vat, the cleaned wiper must be inserted back into the vat.

1. Insert the wiper as shown in the figure.

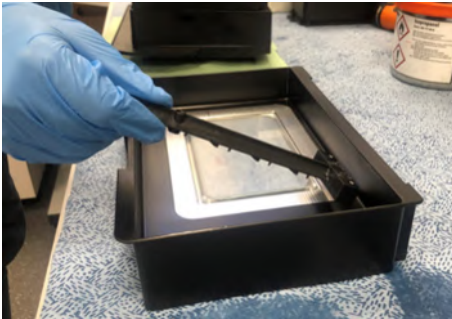

2. Position the wiper so that it lies at a right angle to the tenter and the left side of the wiper is flush with the right side of the tenter.



3. After the wiper has been inserted, the cover of the material unit will now be combined again with the vat. To do this, the inner slats of the cover must engage in the slats of the vat.

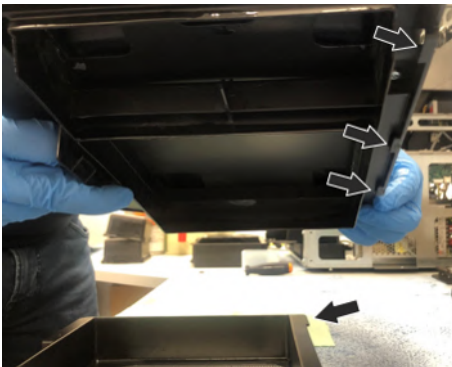

4. First hook the slats in at the back and then fold the cover down at the front.



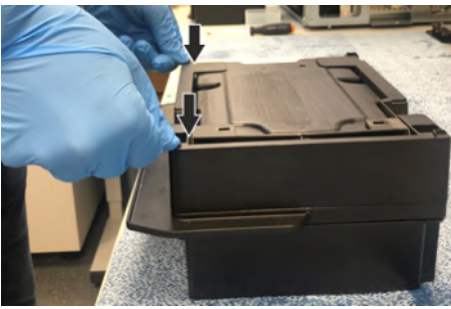

5. To snap the cover into place, push the cover down with a light pressure, as shown in the image, until it snaps into place.

IMPORTANT

Do not press on the cartridge, press only on the frame of the cover.

7.6 Cleaning the vat after a printing error

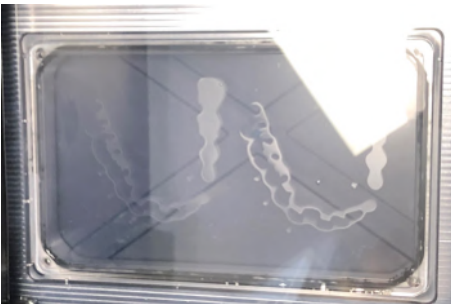

In the event of a printing error, layers or print areas can stick to the film instead of to the build platform. These buildups are usually difficult to remove. Fragments could fall into the resin and hinder subsequent print jobs. It is therefore recommended to print a cleaning layer on in such cases. This way the fragments can be simply removed as one piece.

1. To print the cleaning layer, select on the printer ...
2. Arrange a paper towel and wear gloves, otherwise you will come into contact with liquid resin. Avoid all skin contact.
3. Use the supplied plastic playing card (REF 6753631) to remove the cleaning layer.

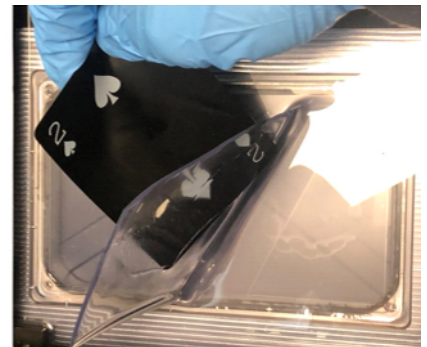
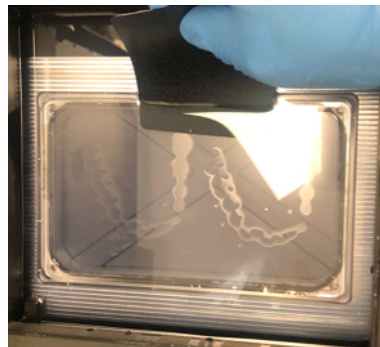

4. Lift the detached cleaning layer out of the vat and let the resin drip off over the vat.
5. Place the layer on the previously arranged paper towel and then place both in the fresh air in the sun to harden (out of reach of children).

7.7 Cleaning the glass pane in the printer

The glass pane in the printer should be cleaned at least every 14 days if the pane is obviously dusty or under error conditions.

1. Moisten the supplied microfiber cloth (REF 6754241) with isopropanol.

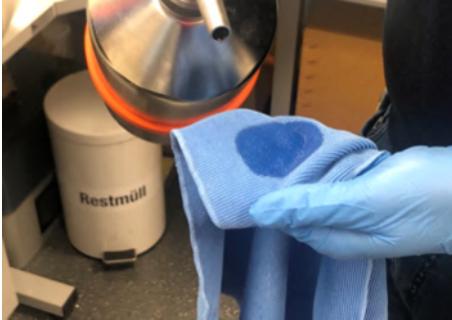

2. Wipe the surfaces and the glass pane and check in particular that the glass pane is dust-free.



7.8 Replacing the main fuse

WARNING

Electric shock

Disconnect the power plug at the unit end before replacing the fuses.

NOTE

Fuse type

The main fuses F1 and F2 are of the T5AH250V type. They are available under REF 6757525 (replacement Primeprint fuses).

➤ Use only fuses of the same type in the fuse holder!

- ✓ The power plug must be disconnected.
- 1. Use a screwdriver to carefully pry off the cover of the fuses on the back side of the unit.
- 2. Pull out the fuse holder.
- 3. Replace the defective fuses.
- 4. Reinsert the fuse holder.
- 5. Close the cover.

7.9 Consumables:

The following consumables and spare parts are available for the Primeprint unit.

- Playing card set (REF 6753631)
- Activated carbon filter (REF 6745603)
- Microfiber cloth (REF 6758556)
- LAN cable 2M (REF 6006626)
- Torx torque wrench (size 10) (REF)
- Standard film insert (REF 6744911)

8 Disposal



In accordance with Directive 2012/19/EU and national disposal regulations regarding old electrical and electronic devices, please be advised that such items must be disposed of in a special way within the European Union (EU). These regulations require the environmentally friendly recycling/disposal of old electrical and electronic devices. Such items must not be disposed of as domestic refuse. This has been expressed using the icon of the “crossed out trash can”.

Disposal procedure

We feel responsible for our products from the first idea to their disposal. For this reason, we give you an option to return our old electronic and electrical devices.

If you wish to dispose of your devices, please proceed as follows:

In Germany

To initiate return of the electrical device, please send a disposal request to enretec GmbH. You have the following options here:

- Use the 'Returning an electrical device' button under the 'eom' menu item on the enretec GmbH homepage (www.enretec.de).
- Alternatively, you can also contact enretec GmbH directly.

enretec GmbH
Kanalstraße 17
16727 Velten, Germany
Phone: +49 3304 3919-500
E-mail: eom@enretec.de

In accordance with the national disposal regulations regarding old electrical and electronic devices (ElektroG), as the manufacturer, we assume the costs for disposing of the electrical and electronic devices in question. Disassembly, transport and packaging costs shall be borne by the owner / operator.

Prior to disassembly/disposal of the unit, it must be prepared professionally (cleaned/disinfected/sterilized).

If your unit is not permanently installed, it will be collected from the practice. If it is permanently installed, it will be picked up curbside at your address by appointment.

Other countries

For country-specific information on disposal, contact your local dental dealers.

Index

B

- Build platform, 55
- Building installation, 12

C

- Care, cleaning, and disinfecting agents, 53
- Cartridge, 48
- CE mark, 20
- Cleaning layer, 63
- Connection
 - Ethernet, 32
 - LAN, 32
 - WLAN (Wi-Fi), 38
- Consumable, 65
- Cover of material unit, 56, 62
- Customer Service Center, 5

D

- Dimensions, 29
- Disinfection, 54
- Disposal of old electrical and electronic devices, 66

E

- enretec GmbH, 66

F

- Film insert, 60
- Fuse
 - Fuse type, 65
 - Replacement, 65

G

- Glass pane, 64

H

- Humidity range, 29

I

- Installing the unit
 - automatic, 43
 - manual, 43
 - removal, 44
- Interval, 53

L

- Leak tightness of the vat, 61

M

- Maintenance, 9, 12
 - Regulations, 52
- Maintenance intervals, 53
- Manufacturer's address, 5
- Material unit, 48
- Material unit, cover, 56

N

- Nominal current, 29

O

- Operating mode, 29

P

- Packaging, 30
- Packing, 33
- Primeprint box, 50
- Printing errors, 63
- Product safety, 13
- Protection class, 29

R

- Rated line voltage, 29
- Referencing run, 47
- Repair, 12

S

- Safety instructions, 7
- Scope of supply, 23

Seal, 60

Spare parts, 65

T

Temperature range, 29

Type designation, 29

U

Unpacking, 30

V

Vat, 58

Ventilation slots, 18

W

Water, 29

Weight, 29

Wiper, 62

We reserve the right to make any alterations which may be required due to technical improvements.

© Sirona Dental Systems GmbH
D3691.201.01.01.02 04.2021

Sprache: englisch
Ä.-Nr.: 000000

Printed in Germany

Sirona Dental Systems GmbH



Fabrikstr. 31
64625 Bensheim
Germany
www.dentsplysirona.com

Order No **6745173 D3691**