

Minimalist setting

There is only a few steps to open an intelligent business device

- Press the power button, the screen is lit, enter the first boot interface, and follow the prompts to operate. There are two modes to access internet.
- WiFi setting
 - Click the [Settings] button, then turn on the WLAN, enter the WLAN search interface, and wait for the available WLAN hotspots;
 - Click the WLAN you want. If you choose an encrypted network, you need to enter the access password to connect it.
- LAN setting

How to download / use the App

Related applications can be used in the network mode, open the application market, browse and download the application to complete the installation

Package content

- Host 1 pcs
- Power adapter
- User Manual Book
(including packaging content, product warranty card)

Product warranty card

Product name	_____	We do not provide free warranty for the following situations
Product Model	_____	• Disassembled or repaired products without permission
Product number	_____	• Product barcode and warranty card which is altered or incomplete
Purchase date	_____	• Failure to operate the equipment in accordance with the instructions
Contact information	_____	• Failure caused by water or fall
Company address	_____	• Failure or damage caused by an irresistible factor
Contact information	_____	• Out of warranty
Our company provide _____ day of warranty service from the purchase date	_____	

The name and content of the poisonous and harmful substances of this product are expressed. See the details in below sheet.

Part Name	Poisonous or hazardous substances or elements					
	(Pb)	(Hg)	(Cd)	(Cr(VI))	(PBB)	(PBDE)
Circuit board assembly	×	○	○	○	○	○
Printhead assembly	×	○	○	○	○	○

Products which meet or exceed the environmental life span should be recycled and reused according to the provisions of the "Control Measures for Electronic Information Products" and they should not be discarded at random.

O: It indicates that the content of the toxic and hazardous substance in all homogeneous materials of the part is below the limit requirement of SJ / T11363-2006.

X: It indicates that the content of the poisonous and harmful substance in at least one homogeneous material of the part exceeds the limit requirement in SJ / T11363-2006. However, the reason for some of the content of the part marked "X" which exceeds the limit requirement is that there is no mature alternative technology in the current industry.

Common troubleshooting

Symptom	Confirmed matter
Printer does not work	<ul style="list-style-type: none"> Confirm that the paper cover is closed properly Make sure you use the suitable paper and install it properly. Please check if there is 80 / 58mm thermal paper roll in the paper bin. When printing blank content, please check if the paper roll is in the opposite direction.
How to do with the crash?	Long press the power button 8S, then power off, short press to reboot.

Important safety instruction

- Avoid installing or using the machine during thunder and lightning, otherwise there's a danger of being shocked by lightning;
- When you find abnormal smell, overheating or smoke, please immediately cut off the power supply;
- The paper knife is sharp, please don't touch it!

Precautions

Safety Warning

- Please insert the ac plug into the corresponding ac socket as required on the power adapter;
- Using the machine with potential explosive gas is strictly prohibited;
- Non-professionals should not open the power adapter at random so as to avoid danger;
- It is Class A product. In the living environment, this product may cause radio interference. In this case, the user may be required to take practical measures to decrease the interference.
- Battery replacement
 - There is explosion hazard when replacing batteries with a wrong type!
 - The replaced battery should be handed over to the maintenance personnel, do not put it into the fire!

Proposal

- Don't use it near water or in humid environment to avoid liquid falling into the terminal;
- Don't use it in extremely cold and hot environment to avoid small objects falling into the terminal;
- Don't use it near medical equipment without permission.

Statement

The company is not responsible for the following actions

- Damage caused by the use and maintenance beyond the scope of this guide;
- Our company will not be responsible for any damage or problems caused by the selection of materials or consumables (products which are not originally provided or approved by the company). Any one has no right to modify or change the product without the consent of our company.

Disclaimer

Due to the update of the product, some details of this document may not be in conformity with the product. Please refer to the actual material. The interpretation of this document belongs to our company. Our company reserves the right to amend this manual without prior notice.

100 mm

iMachine A1

User Manual Book

170 mm

400 mm

Product introduction

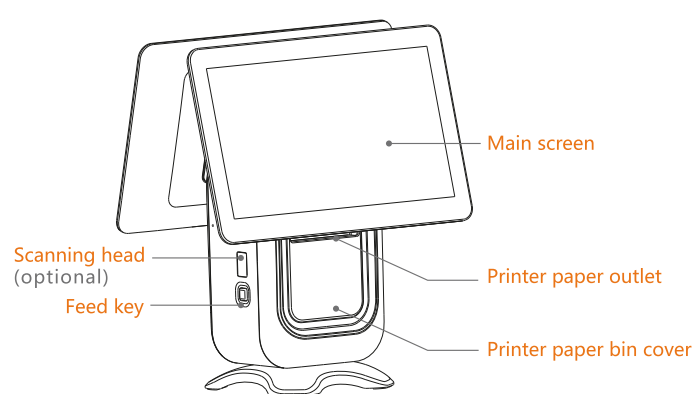

Main screen
Touch screen used by operator

Auxiliary display screen
A screen used for advertising

Printer paper outlet
It is used to print documents in the boot state.

Decorative cover
After opening, you can connect various kinds of wire.

Power button

- Under shut down state, short press then it would start up.
- Under the use state, long press 2-3 seconds, you can choose to shut down or restart.
- In the state of crash, long press 11 seconds, then power off.

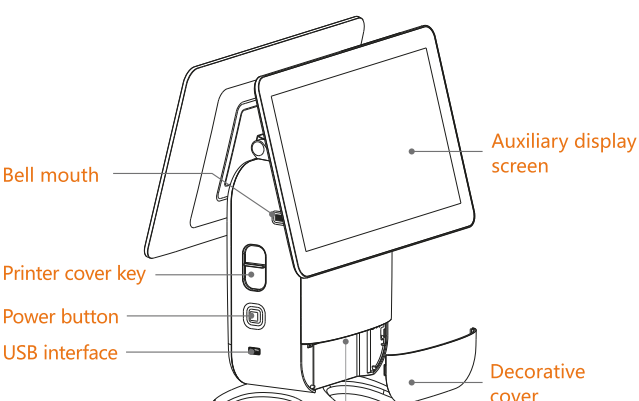

Printer cover key
It is used to open the paper storehouse and change the paper.

USB interface

It is used for external interface, such as keyboard, mouse, U disk

TF card slot

It is used for external expansion of TF memory card.

Installation

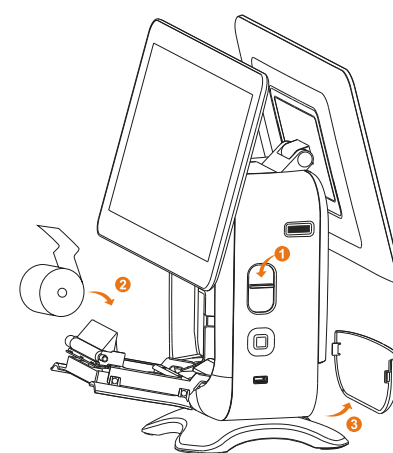

1 Open the door of paper storehouse.

Press the printer cover key then the cover will pop up automatically.

2 Install printing paper

Put 58mm/80mm thermal paper in the machine and pull out a section of the printing paper outside the mouth, then cover the paper storehouse.

3 Connect the power cord

Plug the adapter power interface to the power port at the bottom of the host. Plug the other end of the adapter into an electrical outlet.



100 mm

Basic parameters

Operating system	Android 6.0
Processor	Cortex-A17 architecture processor, ARM Mali-T764 graphics processor
Main Screen	14.1" Multi-touch capacitive screen/FHD1920 × 1080
Auxiliary Screen	14.1" LCD/FHD1920 × 1080
Storage	1GB DDR3+8GB eMMC
WiFi	802.11 b/g/n
Bluetooth	BT3.0
Printer	58mm, 80mm interchangeable
Speaker	2PCS
External interface	5 * USB 2.0, 1 * RJ12 serial port, 1 * RJ11 cashbox port,
External memory card	Update 128GB
Machine size	353.2x207.1x402.7mm
Power Adapter	Output:DC24V/2.5A

170 mm

400 mm

Any Changes or modifications not expressly approved by the party responsible for compliance could void the user's authority to operate the equipment.

This device complies with part 15 of the FCC Rules. Operation is subject to the following two conditions: (1) This device may not cause harmful interference, and (2) this device must accept any interference received, including interference that may cause undesired operation.

FCC Radiation Exposure Statement:

This equipment complies with FCC radiation exposure limits set forth for an uncontrolled environment.

This transmitter must not be co-located or operating in conjunction with any other antenna or transmitter.

This equipment should be installed and operated with minimum distance 20cm between the radiator &you body.

Note: This equipment has been tested and found to comply with the limits for a Class B digital device, pursuant to part 15 of the FCC Rules. These limits are designed to provide reasonable protection against harmful interference in a residential installation. This equipment generates uses and can radiate radio frequency energy and, if not installed and used in accordance with the instructions, may cause harmful interference to radio communications. However, there is no guarantee that interference will not occur in a particular installation. If this equipment does cause harmful interference to radio or television reception, which can be determined by turning the equipment off and on, the user is encouraged to try to correct the interference by one or more of the following measures:

—Reorient or relocate the receiving antenna.

—Increase the separation between the equipment and receiver.

—Connect the equipment into an outlet on a circuit different from that to which the receiver is connected.

—Consult the dealer or an experienced radio/TV technician for help.