

Quick start guide

This will be physically supplied with the product. Printed onto a single 114mm piece of card



SILVER

114mm

MINIRIG[®] QUICK START GUIDE

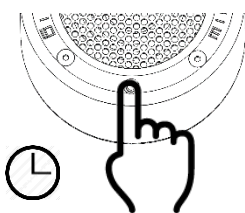

TO TURN ON OR TURN OFF

Press and hold button



Open Bluetooth settings and select MINIRIG

TO CONNECT



MINIRIG

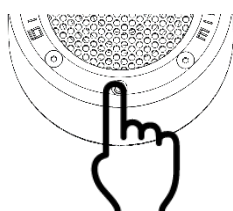

TO CHANGE GAIN (VOLUME)

Press and release button once

FOR FULL MANUAL VISIT WWW.MINIRIGS.CO.UK/SUPPORT



The following complete user manual is accessed via the web link above



ABOUT THE MINIRIG

First of all we want to offer you a big thank you from everyone here at Minirigs for purchasing a Minirig Bluetooth speaker. We have spent years developing this product, building on the success of our wired Minirig and bringing it up-to-date with the latest Bluetooth features and improvements. We hope it brings you many years of joy.

UNPACKING

Before you begin, open up the box and check the contents. You should have:

- Minirig speaker
- Zip case for the Minirig
- 3.5mm aux audio cable
- Barrel to USB power cable

KNOW YOUR MINIRIG

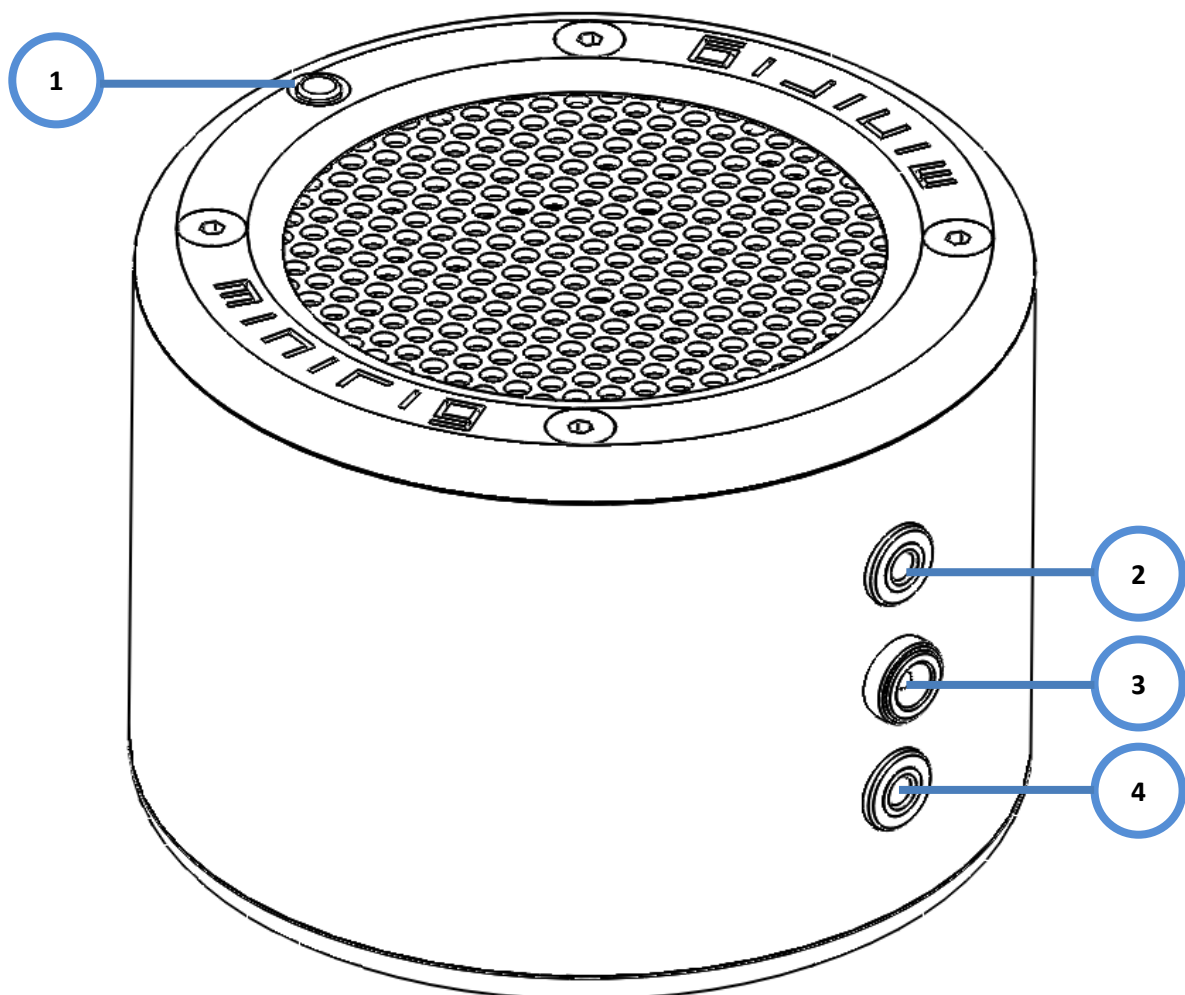

1

Button / Status LED – Lights up to show status. Multifunction button to operate the Minirig

2

AUX socket (high gain) – Audio input from audio player or output to another Minirig or subwoofer

3

Power socket – Plug supplied power cable in here to charge the Minirig or take power out

4

AUX socket (low gain) – Audio input from audio player or output to another Minirig or subwoofer

TURNING ON - BLUETOOTH MODE

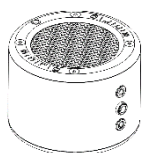

- Start with the Minirig OFF and no AUX audio cables plugged in.

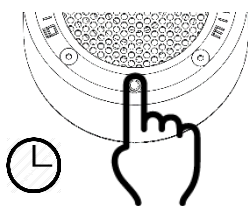

- Press and **hold** the button for 2 seconds or more.



- The Minirig LED will turn green for a moment and play a tone (tones can be disabled via the APP)

It is now ready to connect to your device....

PAIRING YOUR DEVICE

To connect your audio device with the Minirig, they have to be “paired” first.

The Minirig will always be available for pairing as long as it is ON, in Bluetooth mode, and doesn't have two devices already connected to it. There is no pairing “mode” unlike other Bluetooth speakers, which makes pairing simpler and easier.

To pair with the Minirig:



- Locate the Bluetooth settings on your device (E.g. smartphone). Turn Bluetooth ON and search for devices.

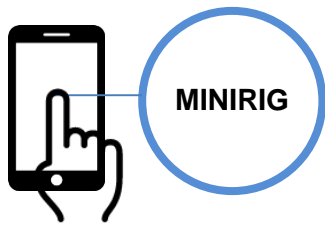

"MINIRIG CONNECTED"

- Find and select the "MINIRIG". Your device will indicate that they are "pairing"

- Your device will confirm when they have paired and you can begin playing music.

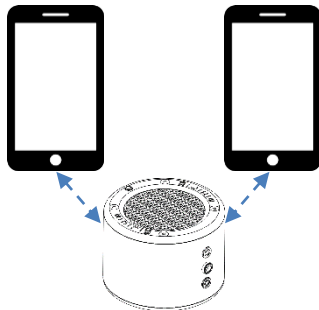

- Now that they are paired, they will connect automatically when you turn the Minirig on – providing your device is in range and has Bluetooth turned ON.
- The Minirig can remember up to 8 paired devices
- You can pair and connect two devices to a Minirig at the same*. To switch between them you need to stop the music on the device playing then start playing music on the second device.

* Another Minirig counts as a device, see wireless stereo below.

CHANGING GAIN (VOLUME)

The Minirig has two gain (volume) settings – LOW and HIGH. In Bluetooth mode it will always start in LOW gain. In AUX mode it will start in LOW or HIGH gain depending on which AUX socket you plug in to.

To change gain at any time:

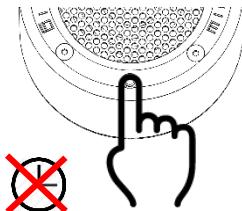

- Check that the Minirig is ON and audio is playing
- Press the button once, do not hold it down
- In high gain the LED will be brighter than in low gain

We recommend that you use LOW gain at normal listening levels for the best sound quality

AUDIO OUT

In Bluetooth mode, the Minirig will output audio from both AUX sockets. This allows you to connect to another Minirig, Minirig subwoofer or Hi-Fi system using the supplied audio cable or any 3.5mm audio jack cable.

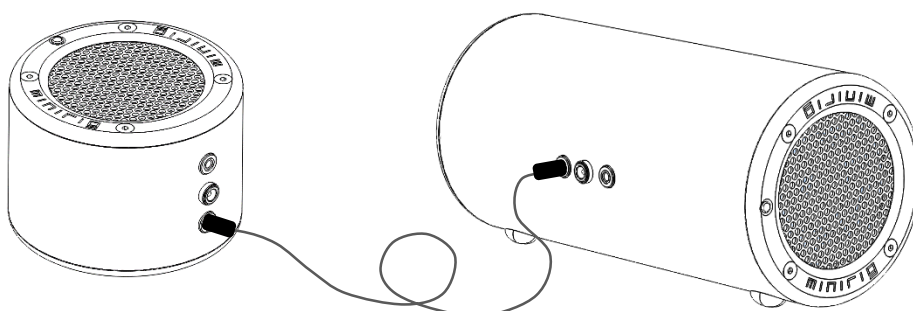



- Using the Minirig APP, you can mute the speaker which allows you to use the Minirig as a Bluetooth audio receiver. In this mode the battery life will be extended to over 100 hours.

Please **DO NOT** attempt to feed audio **IN** to these sockets while it is in Bluetooth mode.

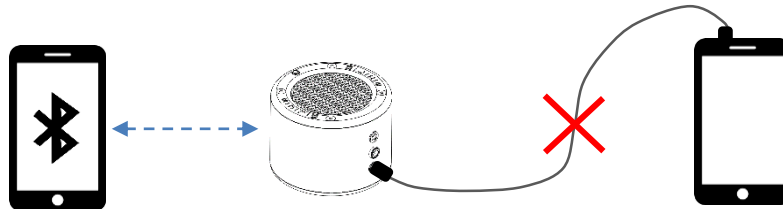

You can now leave the cable plugged in and turn the Minirig OFF and ON again as usual. It will remain in Bluetooth mode until you pull the cable out and re-insert it while the Minirig is OFF (see AUX mode below)

TURNING OFF

To turn the Minirig OFF:

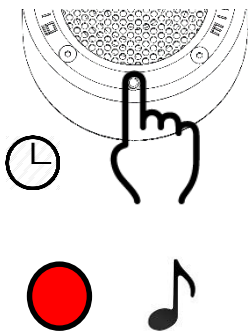

- Press and hold the button for 2 seconds or more
- The LED will turn red and you will hear a tone (tones can be disabled via the APP)

AUX (WIRED) MODE

If your device does not have Bluetooth or you would like to use a wired connection instead, you can connect to the Minirig using the supplied AUX cable.

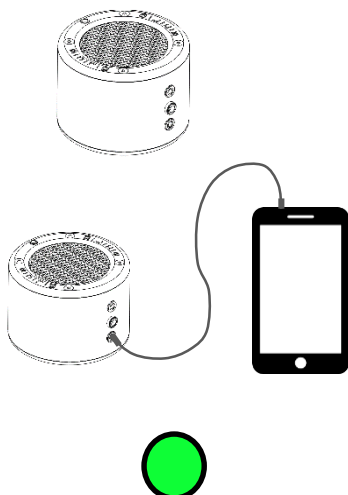

- Start with no audio cables plugged in and the Minirig OFF
- Plug one end of the AUX cable into the headphone socket on your audio device
- Plug the other end into one of the AUX sockets on the Minirig
- The Minirig will turn on when you plug the cable in. There will be **no** tone.

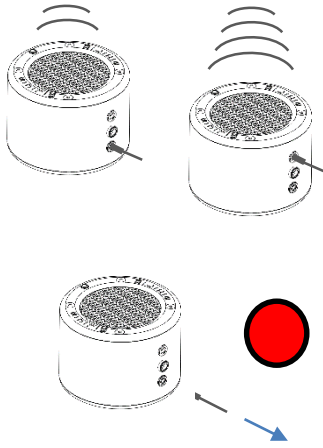

- The top socket will put the Minirig in high gain, the bottom socket low gain.
- You can still change gain using the button as in Bluetooth mode
- You can turn the Minirig OFF and ON by pressing and holding the button. However, it will stay in AUX mode until you remove **all** the audio cables.
- In AUX mode, removing the audio cables will also turn the Minirig OFF. Again there will be no tone in AUX mode.
- You must do this before you can use the Minirig in Bluetooth mode.

Remember:

- 1) You need to turn the Minirig OFF before inserting the audio cable to use it in AUX mode.
- 2) You need to unplug **all** the audio cables and let it turn off before you can use it in Bluetooth mode again.

LINKING UP

In AUX mode you can use the spare audio socket to link out to another Minirig or Minirig subwoofer. If using a subwoofer, please feed the audio into the Bluetooth Minirig **FIRST** as shown. Ensure that you match the gain levels.

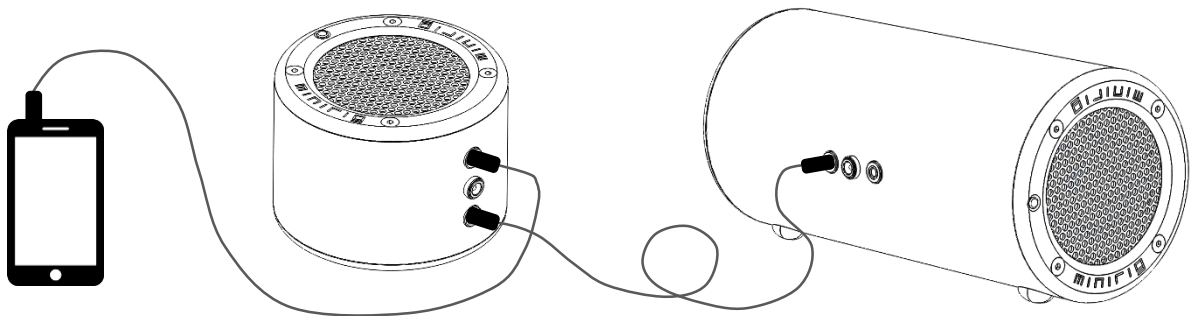

Please see our demo videos at www.minirigs.co.uk/support for more information on linking up.

POWER SAVING FEATURES

To save power, the amplifier circuit will automatically turn off while there is no music playing, even though the Minirig remains ON.

In this “standby” mode, a full battery can last up to 14 days in Bluetooth mode or 40 days in AUX mode.

If you are listening to the Minirig at low volumes in AUX mode, please use the low gain setting to ensure the Minirig does not turn off unexpectedly.

In Bluetooth mode, the Minirig will turn OFF automatically if there are no devices connected for 30 minutes.

BATTERY STATUS

When the Minirig is ON, the colour of the LED will indicate the battery level.

	Green: 75-100%
	Cyan: 50-75%
	Blue: 25-50%
	Purple: 5-25%
	Purple/red: 0-5%

When the Minirig is OFF you can check the battery status by pressing the button once (do not press and hold).

CHARGING

At any time you can charge the Minirig using the supplied power cable.

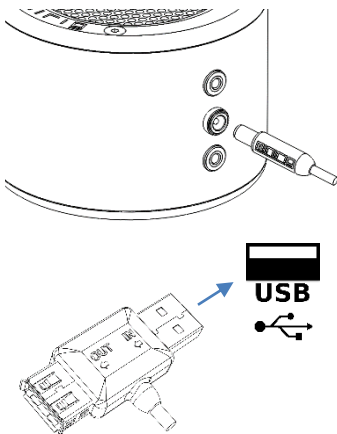

- Plug the round end into the Minirig power socket.
- Next insert the USB plug end marked “IN” into **any** powered USB socket.
- USB sockets can be found on most computers and mobile phone chargers.

When on charge, the LED will fade ON in a repeating 2 second cycle. The colour represents the battery level.

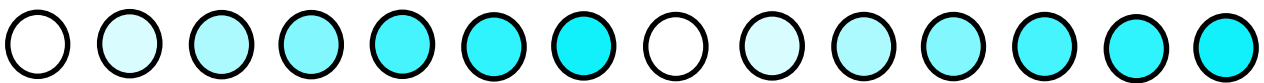

A full charge will take around 6 hours. Once the battery is charged, the LED will stop this repeating cycle.

CHARGE YOUR DEVICES – POWER OUT

Using the supplied power cable, you can take power out of the Minirig to charge or power any device which uses 5V USB power.

The Minirig automatically detects when a device is trying to draw power and activates the power output.

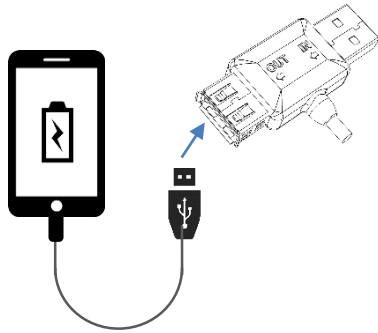
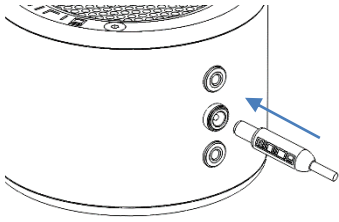

- Connect the round end of the supplied power cable into the power socket of the Minirig
- Plug your device's USB charging cable into the Minirig power cable USB socket – marked "OUT"
- Plug your USB charging cable into your device.
- If the Minirig is off, press the button once to active the power without turning it on
- After a few seconds power will flow and stabilise

If the Minirig is fully charged, there is enough battery power to provide:

- 2 charges for a small smartphone such as an iphone 4S
- 1 charge for a large smartphone such as an iphone 6 plus.

When the power is flowing, the LED will fade OFF in a 2 second repeating cycle.

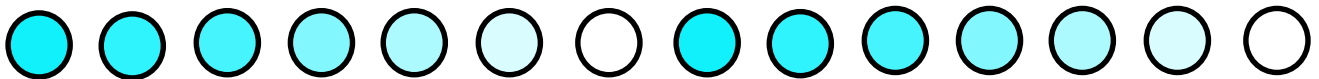

WIRELESS STEREO PAIRING

Two Minirigs can link up together using the wireless Bluetooth connection. This allows you to create an immersive stereo soundstage or to double up the sound in different areas without any cables.

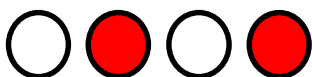
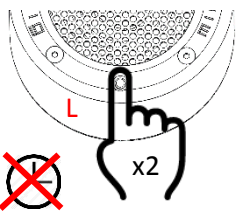
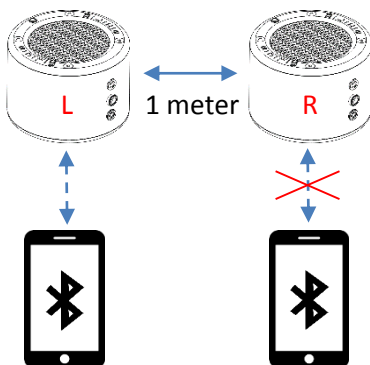

- Turn both Minirigs ON in Bluetooth mode and place them around 1 meter or less apart – they only need to be close for this pairing process.
- Select which one you want to use as the LEFT (master) speaker. You may already be connected and playing music through this Minirig.
- It is **vital** that the other RIGHT (slave) Minirig does not have an audio device connected to it. If it does they will not pair.
- Press the button TWICE on the LEFT (master) Minirig. Just press and release both times, don't hold the button. You will hear a "beep beep" tone.
- The Minirig will disconnect from your audio device and start searching for other Minirigs in the area. The LED will flash white and red.
- At any time you can stop the process by pressing the button.
- When it has found another Minirig, that Minirig will also start flashing white and red.



- After around 10 seconds they should pair. You will hear a “confirmation” tone from both Minirigs and the LEDs will stop flashing.

- If the pairing is unsuccessful or if the search times out, you will hear a different lower “failed” tone. Please try again or see [FAQ](#) for assistance.

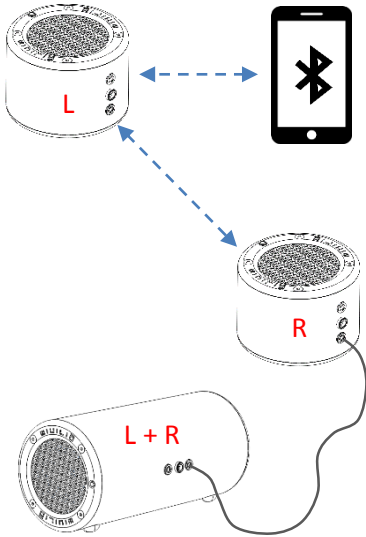

- Once the Minirigs are paired, go ahead and connect your Bluetooth audio device to the LEFT (master) speaker as usual. If you were previously paired and connected, it should automatically reconnect. In wireless stereo you can only connect **one** Bluetooth audio device.

- Go ahead and connect a Minirig subwoofer to **either** Minirig if you have one. It will receive both LEFT and RIGHT signals. This can be re-configured using the Minirig APP. See [demo videos](#) for more information.

- When you turn one of the paired Minirigs OFF, they will both turn OFF. They will automatically un-pair and return back to normal.

- You can lock them together using the Minirig APP, so next time you turn them on, they reconnect automatically in wireless stereo. See [APP instructions](#) for more details.

- At any time you can also un-pair the Minirigs by pressing the button **TWICE** on either Minirig. You will hear a tone to confirm they are un-paired.

TROUBLESHOOTING

We hope that you find the Minirig easy and problem-free to use. However, if you are having any trouble here are a few things you can try which may help:

- Pause/stop the music for 5 seconds and press play again. This can resolve some audio issues.
- Turn the Minirig(s) OFF and ON again. This will re-establish the Bluetooth connection.
- Try a different AUX audio cable or Minirig power cable if you have one.
- Move the Minirig closer to the Bluetooth audio device.
- Turn Bluetooth OFF and ON again on your Bluetooth audio device.

If you are still having trouble, try a full reset of the Minirig – this will restore it to default and un-pair all devices.

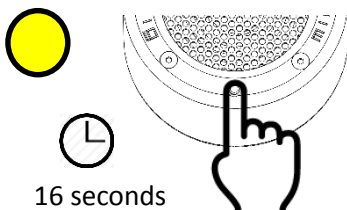

- To reset your Minirig, start with the Minirig OFF and **no cables plugged in**.
- Press and hold the button. Keep holding it for at least 16 seconds.
- Eventually the Minirig will reset and the LED will turn yellow. Please release the button and wait for the LED to turn off.
- Start using the Minirig again as usual. You will have to re-pair your devices.

If you are still having problem you can visit our [support page](#). Please read our [FAQ section](#) and view our [demo videos](#) before contacting us.

WARRANTY AND REPAIRS

We hope that the Minirig will never let you down, however if you believe that there is a fault with your Minirig we have a simple and fair warranty and repair service.

If you have been through our FAQ and troubleshooting section and still believe your Minirig is faulty, please contact us through our [support page](#).

Where possible we prefer to repair any faulty products. Our products are made in the UK, so we are in the unique position of being able to fix and repair any of our products quickly ourselves. This also benefits the environment by re-using as many parts as possible, minimising any harmful or non-recyclable waste going to land-fill.

The Minirig is covered by a full **1 year** warranty service. Please see our [terms and conditions](#) for full details. If your Minirig product is faulty outside of this warranty period please still [contact us](#) as usual. We can still repair your product quickly and easily through our fair non-profit repair service.