

Kanen 卡能®

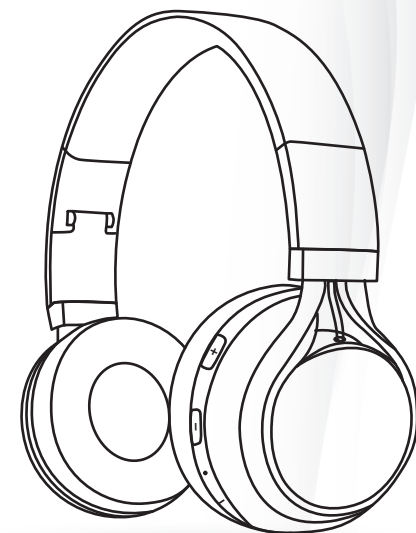

USER GUIDE
BH-2050

1. WELCOME

Thank you for purchasing the Kanen Bluetooth Headset.
We hope you will enjoy it !

Box contents

- Kanen over-ear Bluetooth headphone
- USB to micro USB cable
- 3.5 mm (1/8") audio cable with microphone
- User guide

Specifications

Bluetooth Version: 4.0
 Supported Bluetooth profiles: A2DP v1.2, AVRCP v1.4, HFP v1.6, HSP v1.2, DI v1.3
 Frequency range: 2.4GHz - 2.4835GHz
 Transmission range: up to 10 m (33')
 Power: lithium-ion polymer battery, 4.5 V / 500 mAh (rechargeable)
 Driver size: 40mm
 Frequency response: 20 Hz - 20 kHz
 Sensitivity: 105±3dB

*Design and specifications are subject to change without notice

2. OVERVIEW

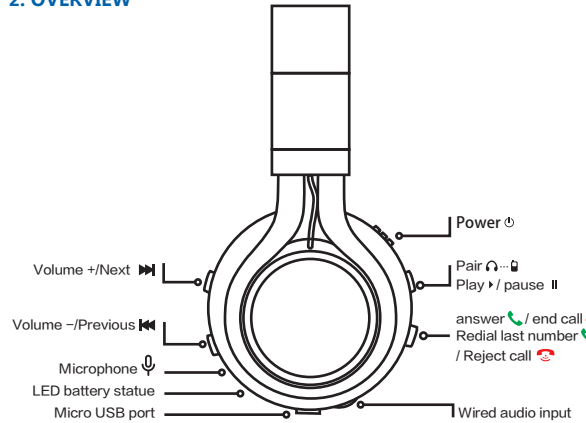

Button functions

Button	Function
Power	Push the button to indicator "I" - power on Push the button to indicator "0" - power off
Play / pause / pair	Long press while off (5 seconds) - pairing Short press (while playing music) - play / pause
Answer / end call	Short press (while calling) - answer / end call
Reject call / Redial last number	Long press (while calling, 3 seconds) - reject call Short press twice - redial last number
Volume up (+) / Next	Press and hold to increase volume (max level indicated by beep sound) Press once to go to next track
Volume down (-) / Previous	Press and hold to decrease volume (min level indicated by beep sound) Press once to go to previous track

Important: Playback, volume, and phone control functionality varies by media device. When using the audio cable, control the playback, volume & phone functions by using the media device controls.

3. CHARGING

3.1 BATTERY STATUS

Plug the headset into any available USB port on your PC using the micro-USB cable

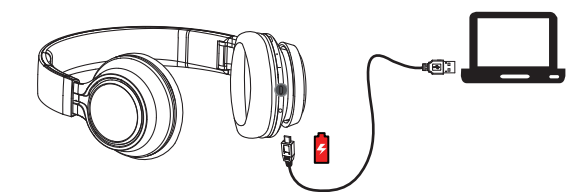

Charge time	About 2 hours
Talk time	Up to 20 hours
Music playback time	Up to 20 hours
Standby time	Up to 100 hours

*Charging the headset before using for the first time is recommended in order to maximize battery life.

3.2 LED STATUS

	LED Activity	Function
CHARGE	Flashing Red	Low battery
	Red (when plugged in)	Charging
	Green (while plugged in)	Fully charged
Bluetooth	Quick Blue/Red Flashing	Pairing mode
	Slow Blue Flashing	Connected
	Blue	Phone conversation

4. CONNECTING

4.1 CONNECT TO A BLUETOOTH DEVICE

1. Hold the Play / pause / pair button in the pairing position for 3 secs.
2. Pairing mode will be announced in the headphones, and the Bluetooth light will flash blue & red.
3. Headset named "BH-2050" shown on your Bluetooth device

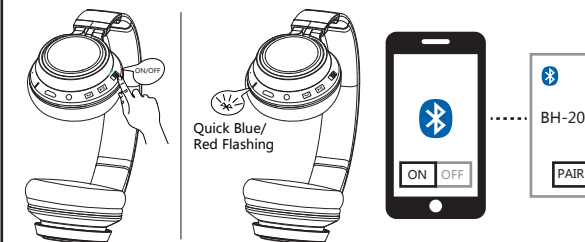

4.2 CONNECT TO 3.5MM JACK CONNECTOR

Connect the headset to most smartphones, tablets or any other 3.5mm device using the supplied audio cable

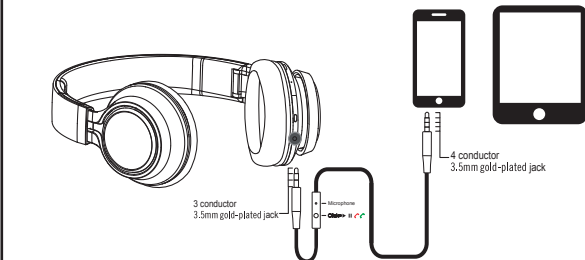

5. SUPPORT

5.1 FAQ

Problem	Solution
I hear crackling noises	-Bluetooth is a radio technology that is sensitive to objects between the headset and the connected devices. Ensure the headset and the connected device are within range (up to 10meters or 30feet)
I cannot hear anything	-Increase the speaker volume -Ensure that the headset is connected to a device
I am having Bluetooth connection problems	-Check your mobile device's Bluetooth menu and delete/forget the headset. Re-connect the headset to your Bluetooth device following the Bluetooth connection instructions
Will the headset support other Bluetooth equipment ?	-The headset is designed to work with Bluetooth mobile devices. It can also support other Bluetooth devices that can support a headset, hands-free and / or advance audio distribution profile.

5.2 HOW TO CARE FOR YOUR HEADSET

- Always store the headset with the power off and safely protected
- Avoid storage at extreme temperatures (above 60°C/140°F or below -40°C/-40°F. This can shorten battery life and may affect operation. High temperatures may also degrade performance.
- Do not expose the headset to rain or other liquids.

Warning: Changes or modifications to this unit not expressly approved by the party responsible for compliance could void the user's authority to operate the equipment.

NOTE: This equipment has been tested and found to comply with the limits for a Class B digital device, pursuant to Part 15 of the FCC Rules. These limits are designed to provide reasonable protection against harmful interference in a residential installation. This equipment generates, uses and can radiate radio frequency energy and, if not installed and used in accordance with the instructions, may cause harmful interference to radio communications.

However, there is no guarantee that interference will not occur in a particular installation. If this equipment does cause harmful interference to radio or television reception, which can be determined by turning the equipment off and on, the user is encouraged to try to correct the interference by one or more of the following measures:

- Reorient or relocate the receiving antenna.
- Increase the separation between the equipment and receiver.
- Connect the equipment into an outlet on a circuit different from that to which the receiver is connected.
- Consult the dealer or an experienced radio/TV technician for help.

This device complies with Part 15 of the FCC Rules. Operation is subject to the following two conditions : (1) this device may not cause harmful interference, and (2) this device must accept any interference received, including interference that may cause undesired operation.

To explore our full selection of products, visit us at www.kanen.net.cn or mail to support@kanen.net.cn for customer support or to obtain specific instructions on how to obtain warranty service for your product.

© 2015 All Rights reserved. All other trademarks and trade names are those of their respective owners.

MADE IN CHINA

尺寸: 85.5*121.5mm

双面印