

User Manual

# URBAN HR

Smart Band PWB-600

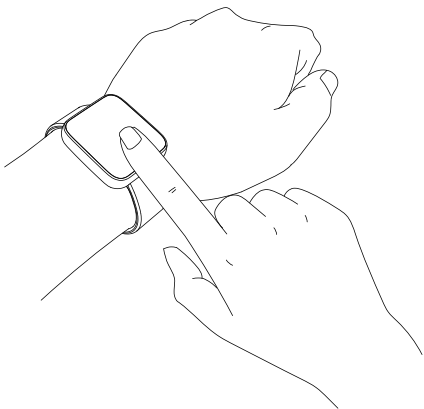

partron

ver. 1.0

## Package



PWB-600

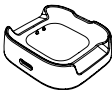

Charging Cradle

Quick Guide

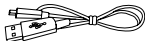

Charging cable

## Product contents

1.3inch  
TFT Display

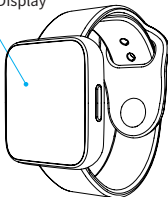

Charging Terminal

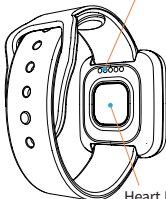

Heart Rate  
sensor

## Battery charging

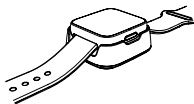
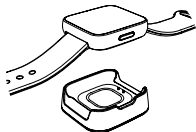

- Attach the band body to the charging cradle according to the direction.  
(If the charging cradle does not match the direction, charging will not be possible.)

## power and Operating Method

### [Power ON/OFF]

When the side button is pressed for more than 3 seconds

### [Select function]

#### Left and right screen slide

Slide the screen left-right to select the desired function

Watch, heart rate, exercise, breathe, Music, messages, exercise records, settings

### [Select snap function]

#### Slide up and down the screen

Slide the screen up-down to check and set the desired snap function

Battery level, automatic exercise mode, APP connection, notification, Power saving mode, stretching mode, water lock mode

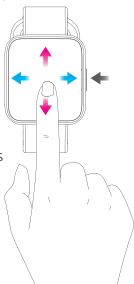

## Start [application downloading]

- Install the 'Urban Fit' app on your smartphone.

(Please search for 'Urban Fit' in the Android Play Store or IOS APP Store.)

## Connecting Urban Fit

### Step 1.

Run the downloaded 'Urban Fit' APP, turn on the Bluetooth of the mobile phone, and turn on the power of the band watch to be connected.

### Step 2.

After selecting the Urban HR product on the APP screen, enter the PIN code displayed on the band screen into the app screen.



Band Screen PIN Code

### Step 3.

- Select 'activity meter' in device settings.

### Step 4.

- If you select PM BMHC from the product list by manufacturer and seller, the Partron band is automatically searched.

### Step 5.

### Step 6.

- After that, a list of nearby activity meters will appear.

Find and select the list that matches your band's PIN cord 6 digits.

EX) PIN cord 000000

List selection number BMHC-000000

- \* When reconfirming the PIN code, you can check the six digits of the PIN code by sliding the screen from bottom to top.
- If it works properly, the message "Pairing Successful" appears on the APP screen.

## Manual exercise mode operation

- Slide the band screen to the right to select 'Exercise' and press Start to proceed to the exercise mode.



## Automatic exercise mode operation

- If 12 or more males/11 females per minute is maintained for 3 minutes, it will switch to automatic exercise mode.
- \* In exercise mode, you can check the screen (heart rate or steps) set by the user in the band.

## Heart rate measurement

- Slide the band screen to the right and touch the screen once in the 'heart rate' menu to start measuring the heart rate.



## Precautions for Safety

1. Do not disassemble or modify the main body. It may cause fire or malfunction.
2. Do not use and store at high or low temperature.
3. Do not use and store in a humid or volatile location, near fire.
4. If you use a car charger, it is allowed for a general passenger car. High-power products may damage the cargo vehicles of 1 ton or more.
5. When using multiple APPs at the same time, the APP may be automatically terminated under the mobile operating system, in which case the Bluetooth connection may be terminated.
6. Contaminated with colored cosmetics (ex-sun cream, BB cream, color cosmetics) If so, it should be cleaned immediately using a wet tissue. If the pollution is left unattended for a long time (30 minutes), the stain may not be removed, and it should be cleaned with a cleaning solution.
7. The 'Urban Fit 600' application obtains relevant information online to accurately measure distance. During this process, data charges may apply when connecting to 3G or 4G.
8. Please note that if there is insufficient cleaning of the charging terminal, corrosion and perforation will not be exchanged or returned.
9. The heart rate measurement function of this product should be used only for physical fitness and health purposes, and

should not be used for the diagnosis or treatment of diseases or other conditions or for the prevention and treatment of diseases.

10. This product supports a certain level of waterproofing, but does not guarantee perfect waterproofing in special matters (swimming, submerging and diving). In addition, manufacturers and distributors are not responsible for failures in these situations.
11. Be careful not to let the terminals of the charging cradle connected to the charging cable contact metal objects. It may cause fire or malfunction.

## Product Warranty Guide

<b>Name</b>	<b>Urban HR</b>		
<b>Date</b>	<b>day</b>	<b>month</b>	<b>Year</b>
<b>Place of Purchase</b>			
<b>Model Name</b>	<b>PWB-600</b>		
<b>Warranty Period</b>	<b>Within 1 years from the purchase date</b> (the warranty period of the battery is 6 months.)		

## Notice on Use of Broadcasting Communication Equipment

Since this radio equipment may have radio interference during operation, it cannot provide services related to human safety.

## Regulatory Information

[ We can see the Certification information in two ways ]

- Confirm with the information attached to the rear of the product

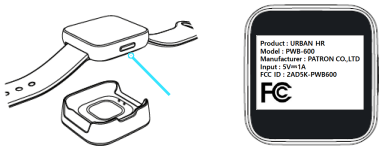

- Confirm with the information electronics display to E-label



1. Touch to the right to move to the 'Setting'.
2. Select 'Certification'.
3. We can see 'FCC ID', 'KC Certification number', Model name, Manufacture and Input rating information.



## Product Inquiry

'Urban Fit 600'

APP usage inquiry

Health Promotion

Development Center

**Bulletin board in APP**

Smart Band Product

Inquiries

Patron Customer Support

Center

**1644-4068**

## FCC Compliance Information

FCC ID : 2AD5K-PWB600

### 1) FCC Compliance Statement

This device complies with part 15 of the FCC rules. Operation is subject to the following two conditions : (1) This device may not cause harmful interference, and (2) this device must accept any interference received, including interference that may cause undesired operation.

### 2) FCC Interference Statement

This equipment has been tested and found to comply with the limits for a Class B digital device, pursuant to part 15 of the FCC Rules. These limits are designed to provide reasonable protection against harmful interference in a residential installation. This equipment generates, uses and can radiate radio frequency energy and, if not installed and used in accordance with the instructions, may cause harmful interference to radio communications. However, there is no guarantee that interference will not occur in a particular installation.

If this equipment does cause harmful interference to radio or television reception, which can be determined by turning the equipment off and on, the user is encouraged to correct the interference by one of the following measures :

Reorient or relocate the receiving antenna.

Increase the separation between the equipment and receiver.

Connect the equipment into an outlet on a circuit different from which the receiver is connected.

Consult the dealer or an experienced radio/TV technician for help.

### **3) FCC Caution**

Any changes or modifications not expressly approved by the party responsible for compliance could void the user's authority to operate this equipment. This transmitter must not be co-located or operating in conjunction with any other antenna or transmitter.

This equipment complies with RF exposure requirements set forth for an uncontrolled environment.