

# Wireless / Wired Keyboard and Mouse Combo

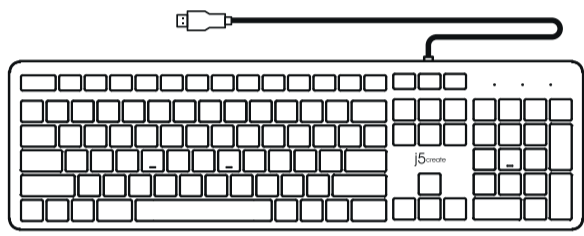
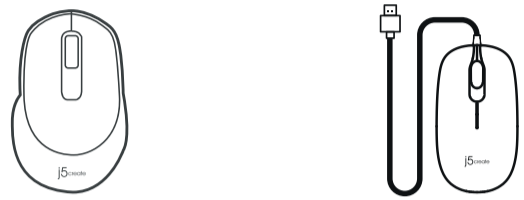
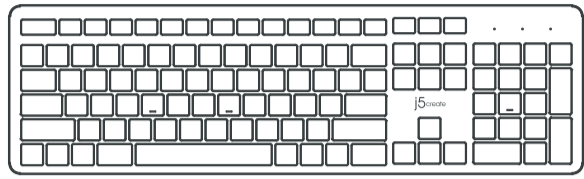

\*\* This installation guide is applicable to more than one model. Please follow the instructions accordingly.

- EN: Quick Installation Guide
- SV: Snabbinstallationsguide
- FR: Guide d'installation rapide
- DE: Kurzeinstellungsanleitung
- IT: Guida rapida all'installazione
- NL: Snelle installatiegids
- PT: Guia de instalação rápida
- ES: Guía de Instalación Rápida
- 繁中文: 快速安裝手冊
- 簡中文: 快速安裝手冊
- 日本語: クイックインストールガイド

## English

### Wireless Keyboard and Mouse

1. Open the battery cover and insert the batteries.

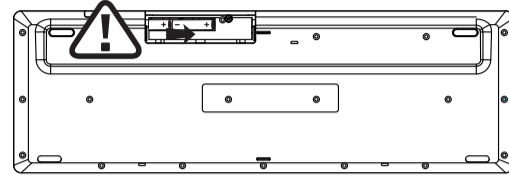
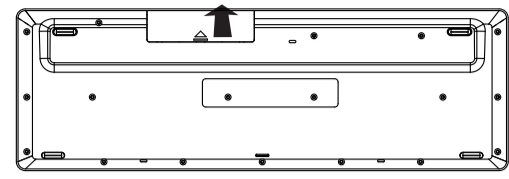

2. When the battery power is low, the battery indicator will flash.

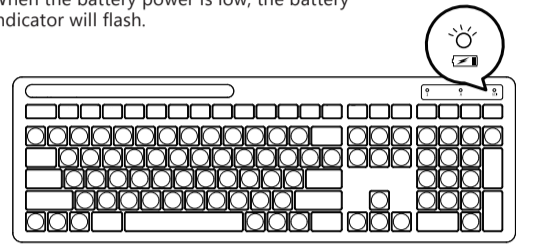

3. Open the battery cover and insert the batteries.
4. Turn on the power switch

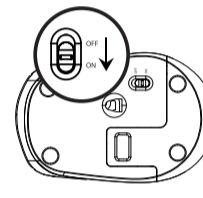
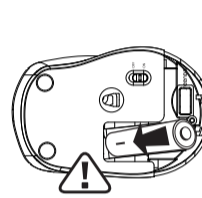

5. Remove the USB™ receiver from the mouse and plug it into your computer. Connect the USB™ receiver to your computer.

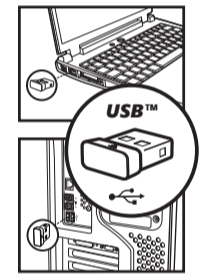
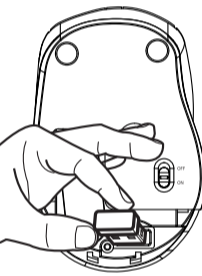

### Wired Keyboard and Mouse

Plug the cable into a USB™ port on your computer.

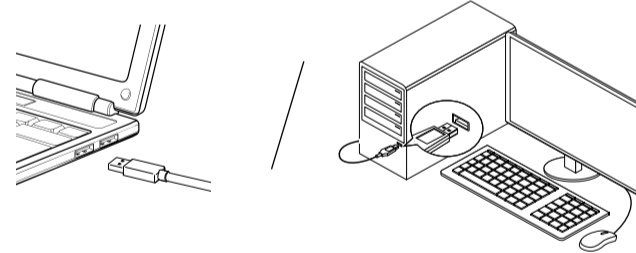

### Product Safety

Our products have been designed with the highest concern for safety. However, any electrical device, if used improperly, has the potential for causing fire, electrical shock, property damage, or personal injury. To help ensure accident-free operation, please follow these guidelines:

- Observe all warnings, precautions, and instructions
- Regularly inspect the device for damage
- Stop use, unplug/disconnect the device immediately, if you notice any damage, or if the device functions in an abnormal manner, produces unusual sounds or smells, or becomes too hot to touch
- For more information on the product and troubleshooting, please go to [en.j5create.com/pages/support](http://en.j5create.com/pages/support)
- Do not operate the device using any vigorous or forceful motions or gestures
- The product packaging may include plastic bags, cable ties, and fasteners. Dispose of these properly and keep them out of reach of children, as they could present a choking hazard
- Do not allow liquid, small particles or other foreign objects to get into the device or accessories
- Do not expose the device or accessories to high temperatures, high humidity, or direct sunlight
- Do not place the device or accessories on the floor or in a place where they may cause someone to trip or stumble
- Do not place anything on top of the device or accessories; it may cause the device to overheat
- Do not attempt to disassemble or repair the device yourself. Disassembling the device may cause damage not covered by the warranty

### ! Warning !



Incorrect use of the battery could cause the battery to overheat, leak, etc. Please be sure to observe the following rules:

1. Do not reverse the connectivity of the positive and negative poles, heat, or throw into fire
2. Do not mix old and new batteries or different types of batteries
3. After the battery is exhausted, please remove it from the machine immediately
4. Do not store with metal products
5. Charging is strictly prohibited! (May cause battery leakage or damage)
6. Do not subject the battery to strong impact or deformation

## Español

### Teclado y mouse inalámbricos

1. Abra la tapa de la batería e inserte las baterías.

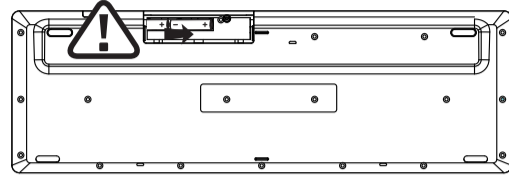
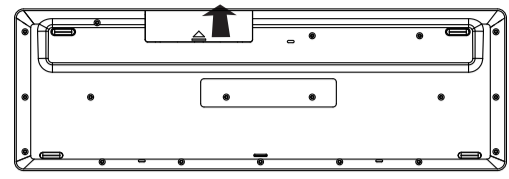

2. Cuando la carga de la batería es baja, el indicador de batería parpadeará

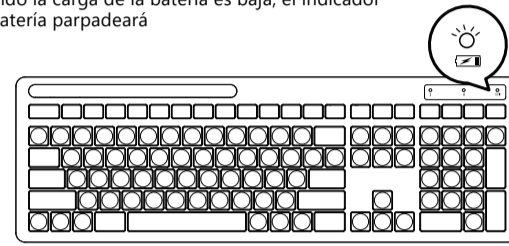

3. Abra la tapa de la batería e inserte las baterías.
4. Enciende el botón de encendido

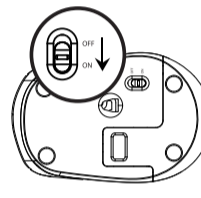
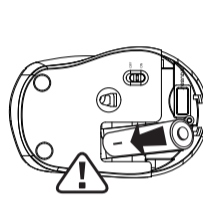

5. Retire el receptor USB™ del mouse y conéctelo a su computadora. Conecte el receptor USB™ a su computadora.

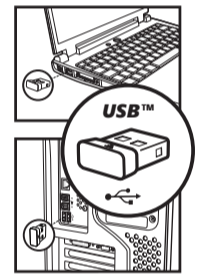
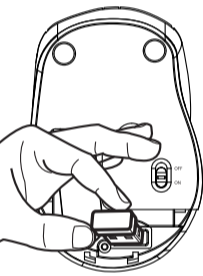

### Teclado y mouse con cable

Conecte el cable a un puerto USB™ de su computadora.

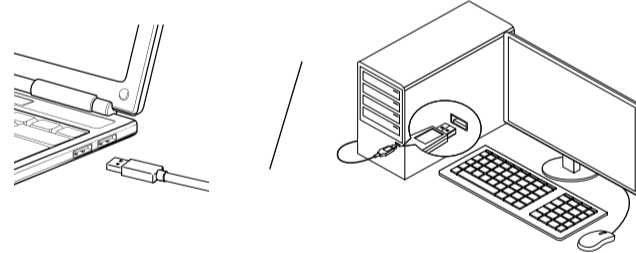

### Seguridad del producto

Nuestros productos han sido diseñados con la mayor preocupación por la seguridad. Sin embargo, cualquier dispositivo eléctrico, si se usa incorrectamente, puede causar incendios, descargas eléctricas, daños a la propiedad o lesiones personales. Para ayudar a garantizar un funcionamiento sin accidentes, siga estas pautas:

- Observe todas las advertencias, precauciones e instrucciones
- Inspeccione periódicamente el dispositivo en busca de daños
- Deje de usarlo, desenchufe / desconecte el dispositivo inmediatamente, si nota algún daño o si el dispositivo funciona de manera anormal, produce sonidos u olores inusuales o se calienta demasiado para tocarlo
- Para obtener más información sobre el producto y la solución de problemas, visite [en.j5create.com/pages/support](http://en.j5create.com/pages/support)
- No opere el dispositivo con movimientos o gestos
- El embalaje del producto puede incluir bolsas de plástico, bridas para cables y sujetadores. Deséchelos correctamente y manténgalos fuera del alcance de los niños, ya que podrían representar un peligro de asfixia.
- No permita que líquidos, partículas pequeñas u otros objetos extraños entren en el dispositivo o los accesorios.
- No exponga el dispositivo o los accesorios a altas temperaturas, alta humedad o luz solar directa
- No coloque el dispositivo o los accesorios en el piso o en un lugar donde puedan hacer que alguien tropiece
- No coloque nada encima del dispositivo o los accesorios; puede hacer que el dispositivo se sobrecaliente
- No intente desmontar ni reparar el dispositivo usted mismo. Desarmar el dispositivo puede causar daños no cubiertos por la garantía.

### ! Advertencia !



El uso incorrecto de la batería provocará que la batería se sobrecaliente, etc. Asegúrese de observar las siguientes reglas:

1. No conecte al revés los polos positivo y negativo, no se desconponga, caliente o arroje al fuego
2. No mezcle baterías nuevas y viejas o diferentes tipos de baterías
3. Después de que la batería se haya agotado, retírela de la máquina inmediatamente
4. No almacene con productos metálicos
5. La carga está estrictamente prohibida! (Puede causar fugas en la batería o daño)
6. No someta la batería a fuertes impactos o deformaciones.

## Français

### Clavier et souris sans fil

1. Ouvrez le couvercle de la batterie et insérez les piles.

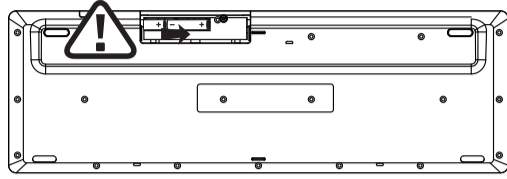
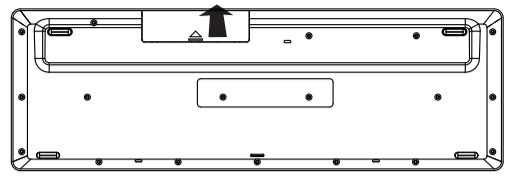

2. Lorsque la batterie est faible, Le voyant lumineux clignotera.

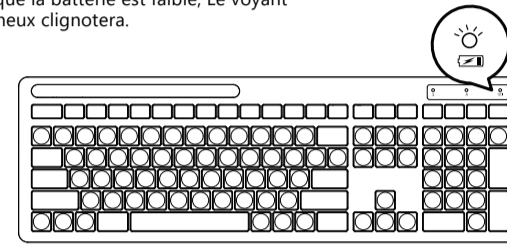

3. Ouvrez le couvercle de la batterie et insérez les piles.
4. Allumez le bouton marche-arrêt

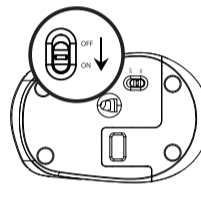
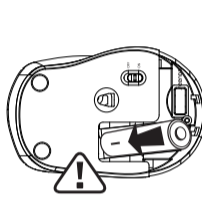

5. Retirez le récepteur USB™ de la souris et branchez-le sur votre ordinateur. Connectez le récepteur USB™ à votre ordinateur.

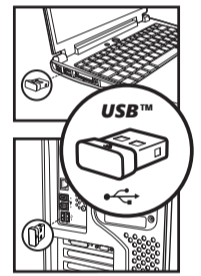
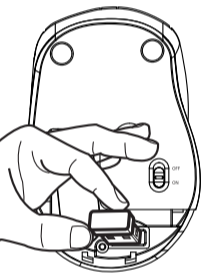

### Clavier et souris à fils

Branchez le câble sur un port USB™ de votre ordinateur.

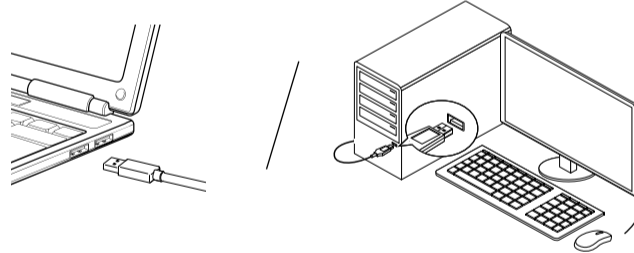

### Sécurité des produit

Nos produits ont été conçus avec le plus grand intérêt pour la sécurité. Toutefois, tout appareil électrique, si mal utilisé, peut causer un incendie, un choc électrique, des dommages matériels ou des blessures corporelles. Pour assurer un fonctionnement sans accident, veuillez suivre ces directives :

- Observez tous les avertissements, précautions et instructions
- Inspectez régulièrement l'appareil pour tout dommage
- Arrêtez l'utilisation, débranchez / déconnectez l'appareil immédiatement, si vous remarquez des dommages, ou si l'appareil fonctionne de manière anormale, produit des sons ou des odeurs inhabituels ou devient trop chaud pour toucher
- Pour plus d'informations sur le produit et le dépannage, veuillez-vous rendre à [en.j5create.com/pages/support](http://en.j5create.com/pages/support)
- Ne pas utiliser avec des mouvements ou des gestes vigoureux ou énergiques
- L'emballage du produit peut inclure des sacs en plastique, des attaches de câble et des fixations. Jetez-les correctement et gardez-les hors de portée des enfants, pour éviter un risque d'étouffement
- Ne laissez pas de liquide, de petites particules ou d'autres objets étrangers pénétrer dans l'appareil ou les accessoires
- N'exposez pas l'appareil ou les accessoires à des températures élevées, à une humidité élevée ou à la lumière directe du soleil
- Ne placez pas l'appareil ou les accessoires sur le sol ou dans un endroit où ils peuvent causer quelqu'un d'autre de trébucher
- Ne placez rien sur l'appareil ou les accessoires; cela peut provoquer une surchauffe de l'appareil
- N'essayez pas de démonter ou de réparer l'appareil vous-même. Le démontage de l'appareil peut causer des dommages non couverts par la garantie

### ! Avertissement !



Une mauvaise utilisation de la batterie provoquera des fuites de chaleur ou des fuites pendant la nuit, etc. S'il vous plaît assurez-vous d'observer les règles suivantes:

1. Ne pas connecter inversement les pôles positifs et négatifs, décomposer, chauffer ou jeter au feu
2. Ne mélangez pas d'anciennes et de nouvelles batteries ou différents types de batteries
3. Une fois la batterie épuisée, veuillez la retirer immédiatement de la machine
4. Ne pas stocker avec des produits métalliques
5. La recharge est strictement interdite! (Peut causer des fuites ou des dommages à la batterie)
6. Ne pas soumettre la batterie à un impact ou à une forte déformation

## Deutsch

### Kabellose Tastatur und Maus

1. Öffnen Sie den Batteriefachdeckel und legen Sie die Batterien ein.

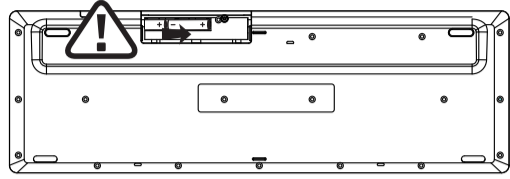
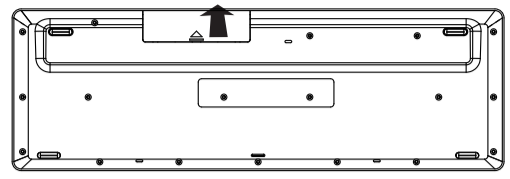

2. Bei geringem Akkustand blinkt die Akkuanzeige.

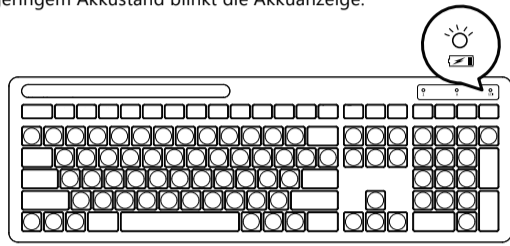

3. Öffnen Sie den Batteriefachdeckel und legen Sie die Batterien ein.
4. Schalten Sie den Stromschalter ein

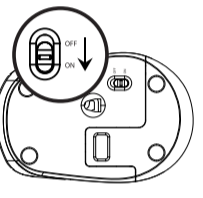
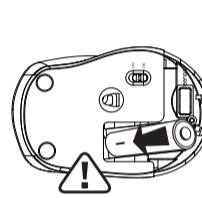

5. Entfernen Sie den USB™-Empfänger von der Maus und schließen Sie ihn an Ihren Computer an. Schließen Sie den USB™-Empfänger an Ihren Computer an.

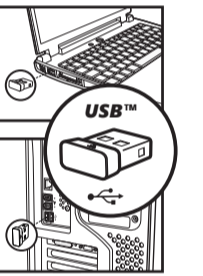
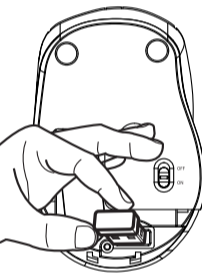

### Verkabelte Tastatur und Maus

Stecken Sie das Kabel in einen USB™-Anschluss an Ihrem Computer.

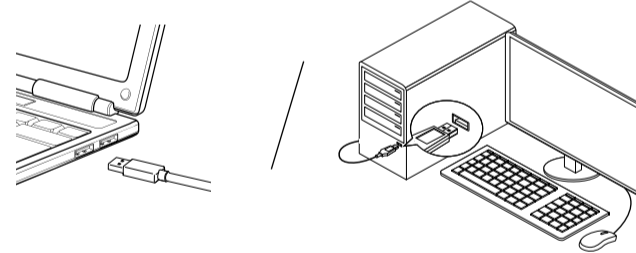

### Produktsicherheit

Unsere Produkte sind in höchstem Maß auf Sicherheit ausgelegt. Allerdings besteht wie bei allen elektrischen Geräten im Falle einer unsachgemäßen Verwendung die Gefahr von Brand, Stromschlag, Sachschäden und Verletzungen. Bitte befolgen Sie zur Gewährleistung eines möglichst Unfallfreien Betriebs diese Richtlinien:

- Halten Sie alle Warnhinweise, Vorichtsmaßnahmen und Anweisungen ein
- Prüfen Sie das Gerät regelmäßig auf Schäden
- Stellen Sie die Benutzung umgehend ein und ziehen Sie den Netzstecker/unterbrechen Sie die Stromversorgung, falls Sie Schäden feststellen oder das Gerät nicht wie gewohnt funktioniert, ungewöhnliche Geräusche oder Gerüche abgibt oder so heiß wird, dass es sich nicht mehr berühren lässt
- Weitere Informationen zum Produkt und zur Fehlerbehebung finden Sie unter [en.j5create.com/pages/support](http://en.j5create.com/pages/support)
- Bedienen Sie das Gerät nicht mit kraftvollen oder gewaltvollen Bewegungen oder Gesten
- Die Verpackung des Produktes kann Plastikbeutel, Kabelbinder und Befestigungs enthalten. Entsorgen Sie diese sachgemäß und halten Sie sie von kleinen Kindern fern, da sie Verschickungsgefahr bergen
- Achten Sie darauf, dass keine Flüssigkeiten, kleinen Partikel oder anderen Fremdkörper in das Gerät oder sein Zubehör gelangen
- Setzen Sie Gerät und Zubehör keinen hohen Temperaturen, hoher Feuchtigkeit oder direktem Sonnenlicht aus
- Platzieren Sie das Gerät oder sein Zubehör nicht auf dem Boden oder an einem Ort, an dem jemand darüber stolpern könnte
- Platzieren Sie nichts auf dem Gerät oder seinem Zubehör; andernfalls könnte das Gerät überhitzen
- Versuchen Sie nicht, das Gerät eigenhändig zu demontieren oder zu reparieren. Die Demontage des Gerätes könnte Schäden verursachen, die nicht durch die Garantie abgedeckt werden
- N'essayez pas de démonter ou de réparer l'appareil vous-même. Le démontage de l'appareil peut causer des dommages non couverts par la garantie

### ! Warning !



Falsche Verwendung des Akkus führt zu Hitze und Nachtleckagen usw. Bitte beachten Sie unbedingt die folgenden Regeln:

1. Plus- und Minuspol nicht vertauscht anschließen, zersetzen, erhitzen oder ins Feuer werfen
2. Nicht mischbare Batterie alte und neue Batterien oder verschiedene Batterietypen
3. Nachdem die Batterie leer ist, entfernen Sie sie bitte sofort aus der Maschine
4. Nicht mit Metallprodukten lagern
5. Das Aufladen ist strengstens verboten! (Kann zum Auslaufen des Akkus oder zu Schäden führen)
6. Setzen Sie den Akku keinen starken Stößen oder Verformungen aus

## Italian

### Tastiera e mouse wireless

1. Aprire il vano batterie e inserire le batterie.

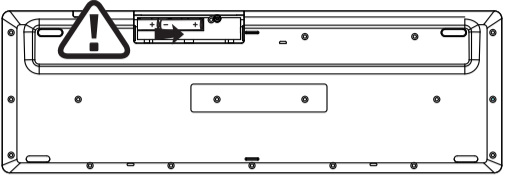
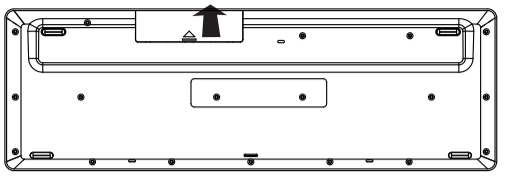

2. Quando il livello di carica della batteria è basso, l'indicatore batteria lampeggia.

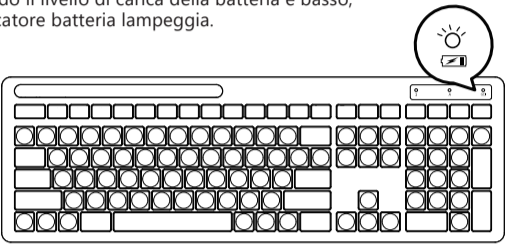

3. Aprire il vano batterie e inserire le batterie.
4. Accendere l'interruttore di alimentazione.

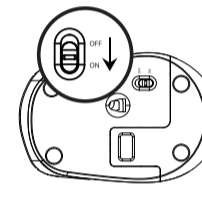
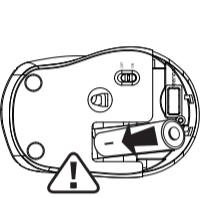

5. Rimuovere il ricevitore USB™ dal mouse e collegarlo al computer. Collegare il ricevitore USB™ al computer.

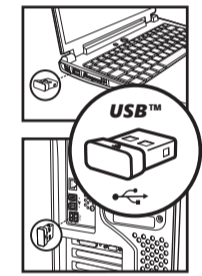
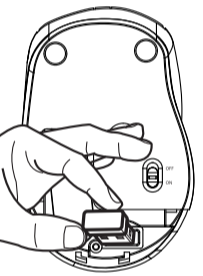

### Tastiera e mouse cablati

Inserire il cavo nella porta USB™ del computer.

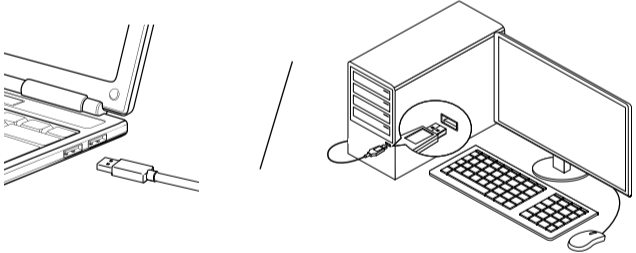

### Sicurezza del prodotto

I nostri prodotti sono stati progettati con la massima attenzione per la sicurezza. Tuttavia, qualsiasi dispositivo elettrico, se utilizzato in modo improprio, può provocare incendi, scosse elettriche, danni materiali o lesioni personali. Per garantire un funzionamento senza incidenti, osservare queste linee guida:

- Rispettare tutte le avvertenze, precauzioni e istruzioni
- Ispezionare periodicamente il dispositivo per rilevare eventuali danni
- Interrompere l'uso, scollegare immediatamente il dispositivo se si notano danni o se il dispositivo funziona in modo anormale, produce rumori o odori insoliti oppure diventa troppo caldo per essere toccato
- Per ulteriori informazioni sul prodotto e sulla risoluzione dei problemi, visitare il sito [en.j5create.com/pages/support](http://en.j5create.com/pages/support)
- Non utilizzare il dispositivo con movimenti o gesti vigorosi o energici
- La confezione del prodotto potrebbe includere sacchetti di plastica, fascette per cavi e dispositivi di fissaggio. Smaltirli correttamente e tenerli lontano dalla portata dei bambini, poiché potrebbero presentare un rischio di soffocamento
- Evitare che liquidi, piccole particelle o altri oggetti estranei penetrino nel dispositivo o negli accessori
- Non esporre il dispositivo o gli accessori a temperature elevate, umidità elevata o luce solare diretta
- Non collocare il dispositivo o gli accessori sul pavimento o in un luogo in cui si potrebbe inciampare
- Non collocare alcun oggetto sopra il dispositivo o gli accessori; potrebbe causare il surriscaldamento del dispositivo
- Non tentare di smontare o riparare da soli il dispositivo. Lo smontaggio del dispositivo potrebbe causare danni non coperti dalla garanzia.

### !Avvertenza!



L'uso scorretto della batteria causa calore e perdite di liquidi, ecc. Assicurarsi di osservare le seguenti regole:

1. Non invertire la connettività dei poli positivo e negativo, non decomporre, riscaldare o gettare nel fuoco
2. Non mischiare batterie vecchie e nuove o diversi tipi di batterie
3. Dopo che la batteria è scarica, rimuoverla immediatamente dalla macchina
4. Non conservare con prodotti in metallo
5. La carica è severamente vietata! (Potrebbe causare perdite o danni alla batteria)
6. Non sottoporre la batteria a forti urti o deformazioni

## Nederlands

### Draadloos toetsenbord en muis

1. Open het batterijklepje en plaats de batterijen.

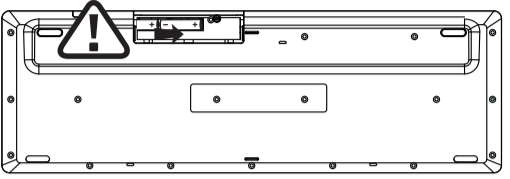
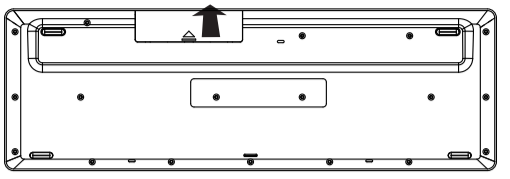

2. Als de batterij bijna leeg is, knippert de batterij-indicator.

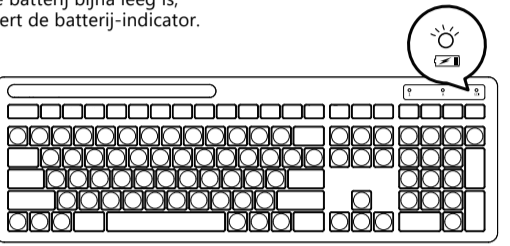

3. Open het batterijklepje en plaats de batterijen.
4. Zet de aan/uit-schakelaar aan.

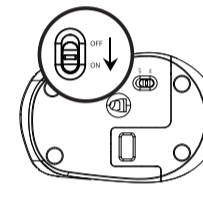
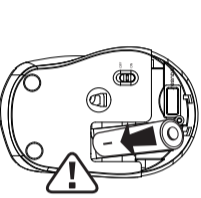

5. Verwijder de USB™-ontvanger uit de muis en steek deze in een vrije USB-poort van uw computer. Sluit de USB™-ontvanger aan op uw computer.

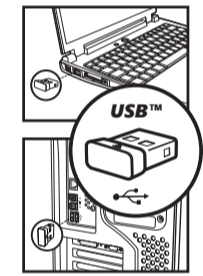
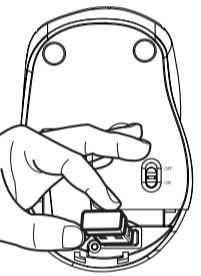

### Bedraad toetsenbord en muis

Sluit de kabel aan op een USB™-poort op uw computer.

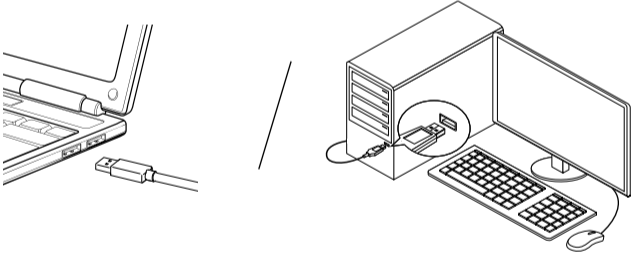

### Productveiligheid

Onze producten zijn met de grootste zorg ontworpen, met oog voor veiligheid. Echter, elk elektrisch apparaat kan, indien bij onjuist gebruik, brand, elektrische schokken, schade aan eigendommen of persoonlijk letsel veroorzaken. Volg deze richtlijnen om ongevaarlijk gebruik te helpen garanderen:

- Neem alle waarschuwingen, voorzorgsmaatregelen en instructies in acht
- Inspecteer het apparaat regelmatig op schade
- Stop met het gebruik, koppel het apparaat onmiddellijk los, als u schade opmerkt, of als het apparaat op een abnormale manier functioneert, ongebruikelijke geluiden of geuren produceert of te heet wordt om aan te raken
- Voor meer informatie over het product en probleemoplossing, ga naar [en.j5create.com/pages/support](http://en.j5create.com/pages/support)
- Bedien het apparaat niet met krachtige of gewelddadige bewegingen of gebaren
- De productverpakking kan plastic zakken, kabelbinders en bevestigings beavten. Gooi deze op de juiste manier weg en bewaar ze buiten het bereik van kinderen, aangezien ze verstikkingsgevaar kunnen opleveren
- Zorg ervoor dat er geen vloeistof/ kleine deeltjes of andere vreemde voorwerpen in het apparaat of de accessoires terechtkomen
- Stel het apparaat of de accessoires niet bloot aan hoge temperaturen, hoge luchtvochtigheid of direct zonlicht
- Plaats het apparaat of de accessoires niet op de grond of op een plek waar iemand erover kan struikelen
- Plaats niets bovenop het apparaat of de accessoires; hierdoor kan het apparaat oververhit raken
- Probeer het apparaat niet zelf te demontieren of te repareren. Het demontieren van het apparaat kan schade veroorzaken die niet wordt gedekt door de garantie.

### ! Waarschuwing !



Onjuist gebruik van de batterij zal oververhitting, lekkage, en etc., veroorzaken. Houd u aan de volgende regels:

1. De plus- en minpool niet omgekeerd aansluiten, ontbinden, verhitten, of in het vuur gooien.
2. Gebruik geen oude en nieuwe batterijen of verschillende soorten batterijen door elkaar.
3. Verwijder de batterij onmiddellijk uit de machine nadat deze leeg is.
4. Bewaar het niet bij metalen producten.
5. Opladen is strikt verboden! (Kan lekkage of beschadiging aan de batterij veroorzaken).
6. Stel de batterij niet bloot aan sterke schokken of vervormingen.

**Teclado e rato sem fios**

- 1 Abra a tampa das pilhas e introduza as pilhas.

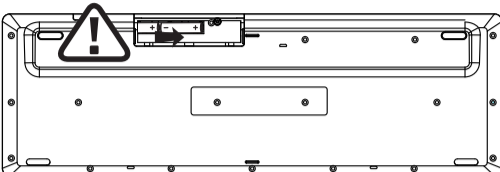
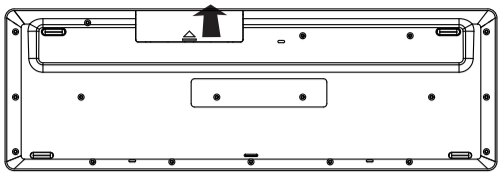

- 2 O indicador de bateria irá piscar quando a bateria estiver fraca.

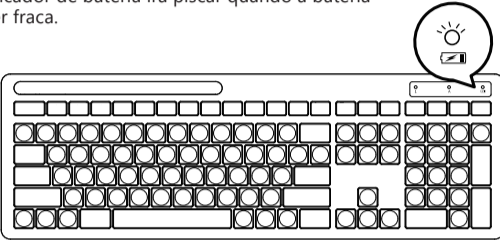

- 3 Abra a tampa das pilhas e introduza as pilhas.
- 4 Ligue o interruptor de energia

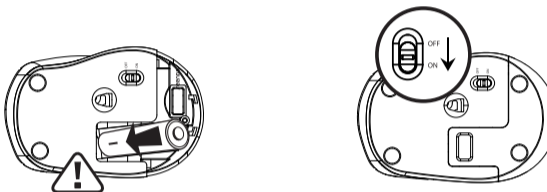

- 5 Remova o recetor USB™ do rato e ligue-o ao computador. Ligue o recetor USB™ ao seu computador.

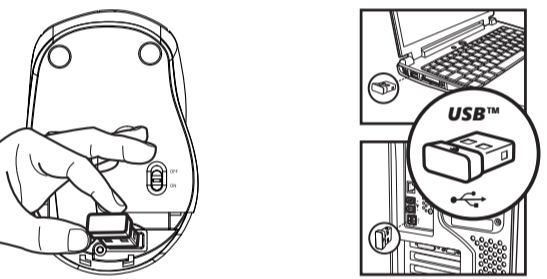

**Teclado e rato com fios**

Ligue o cabo a uma porta USB™ do seu computador.

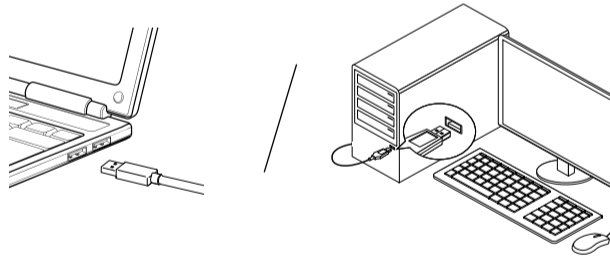

**Segurança do produto**

Os nossos produtos foram concebidos com a maior preocupação pela segurança. Contudo, o detetor dispositivo elétrico, se utilizado incorretamente, pode provocar incêndio, choque elétrico, danos materiais ou ferimentos. Para ajudar a garantir um funcionamento sem acidentes, siga estas orientações:

- Cumpra todos os avisos, precauções e instruções
- Controle a temperatura regularmente se existem danos no dispositivo
- Interrompa a utilização, desligue imediatamente o cabo de alimentação do dispositivo, se detectar quaisquer danos, ou se o dispositivo funcionar de forma anormal, produzir sons ou odores estranhos ou estiver demasiado quente para o tocar
- Para obter mais informações sobre o produto e consultar soluções para resolução de problemas, visite [en.j5create.com/pages/support](http://en.j5create.com/pages/support)
- Não manuseie o dispositivo com movimentos ou gestos energéticos ou violentos
- A embalagem do produto pode incluir sacos de plástico, brachadeiras e fitades. Elimine-os devidamente e mantenha-os afastados do alcance de crianças, pois podem constituir risco de asfixia
- Não permita a infiltração de líquidos, pequenas partículas ou outros objetos no dispositivo ou nos acessórios
- Não exponha o dispositivo ou os acessórios a altas temperaturas, humidade elevada ou luz solar direta
- Não coloque o dispositivo ou acessórios no solo ou num local onde possam fazer troçar alguém
- Não coloque objetos em cima do dispositivo ou dos acessórios, pois poderá provocar o sobreaquecimento do dispositivo
- Não tente desmontar ou reparar o dispositivo por si próprio. A desmontagem do dispositivo pode causar danos não cobertos pela garantia

**Aviso!**



- A utilização incorreta da pilha originará o seu aquecimento e fuga de líquido, etc. Certifique-se de que respeita as regras seguintes.
1. Não reverta a ligação dos polos positivo e negativo, decomponha, aqueça ou atire para o fogo
  2. Não misture pilhas novas e usadas ou diferentes tipos de pilhas
  3. Quando a pilha estiver gasta, remova-a imediatamente da máquina
  4. Não armazene com produtos metálicos
  5. O carregamento é espressamente proibido! (Pode provocar fugas de líquido ou danos)
  6. Não sujeite a pilha a impactos fortes ou deformações

**Trådlöst tangentbord och mus**

- 1 Öppna batteriluckan och sätt i batterierna.

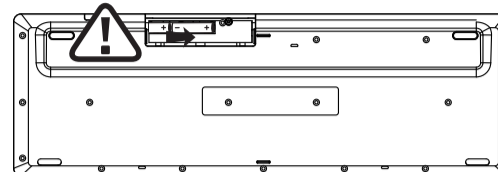
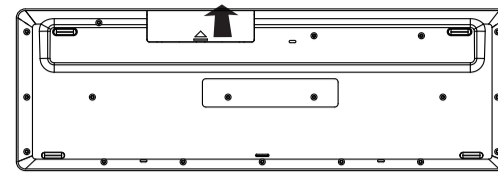

- 2 När batteriet är svagt blinkar batteriindikatorn.

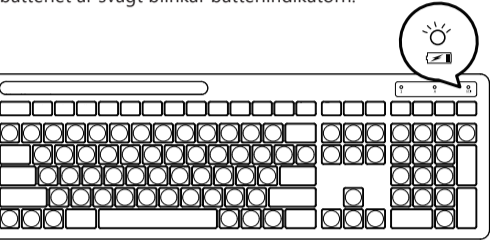

- 3 Öppna batteriluckan och sätt i batterierna.
- 4 Öppna batteriluckan och sätt i batterierna.

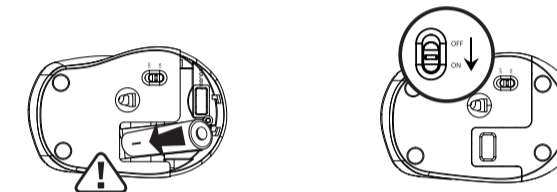

- 5 Ta bort USB™-mottagaren från musen och anslut den till datorn. Anslut USB™-mottagaren till datorn.

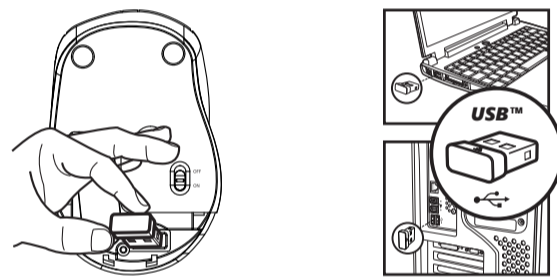

**Trådbundet tangentbord och mus**

Anslut kabeln till en USB™-port på datorn.

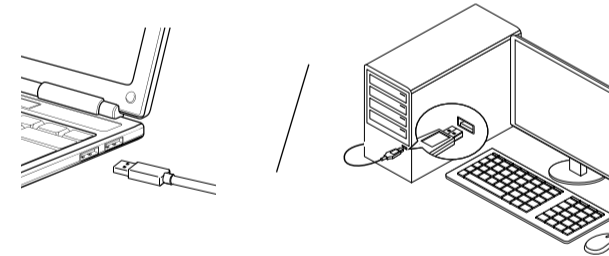

**Produktsäkerhet**

Våra produkter har utformats med största hänsyn till säkerheten. Alla elektriska apparater kan dock, om de används felaktigt, orsaka brand, elektriska stöt, egendomsskador eller personskador. För att säkerställa en olycksfri drift bör du följa dessa riktlinjer:

- Beakta alla varningar, försiktighetsåtgärder och instruktioner
- Kontrollera regelbundet om enheten är skadad
- Sluta använda enheten och dra omedelbart ur kontakten om du märker att den är skadad eller om enheten fungerar onormalt, producerar ovanliga ljud eller lukter eller blir för varm att röra vid
- Mer information om produkten och felsökning finns på [en.j5create.com/pages/support](http://en.j5create.com/pages/support)
- Använd inte enheten med kraftiga rörelser eller gester
- Produktförpackningen kan bestå av glasplåsar, kabelband och fästbandordningar. Släng dessa på rätt sätt och håll dem utom räckhåll för barn, eftersom de kan utgöra en kvävningrisk
- Låt inte vätska, små partiklar eller andra främmande föremål komma in i enheten eller tillbehören
- Utsätt inte enheten eller tillbehören för höga temperaturer, hög luftfuktighet eller direkt solljus
- Placera inte apparaten eller tillbehören på golvet eller på en plats där de kan orsaka att någon snubblar eller ramlar
- Placera inte något ovanpå enheten eller tillbehören då det kan leda till att enheten överhettas
- Försök inte demontera eller reparera enheten själv. Demontering av enheten kan orsaka skador som inte täcks av garantin

**Varning!**



- Felaktig användning av batteriet kan orsaka värme och vätskesläpp etc. Var nog med att följa följande regler
1. Omvänd inte mellan de positiva och negativa polerna och ta inte sönder, värm eller kasta batterierna i eld
  2. Blanda inte gamla och nya batterier eller olika typer av batterier
  3. När batteriet är slut, ta omedelbart bort det från apparaten
  4. Förvara inte tillsammans med metallprodukter
  5. O carregamento é espressamente proibido! (Pode provocar fugas de líquido ou danos)
  6. Utsätt inte batteriet för kraftiga stötter eller deformationer

**ワイヤレスキーボードとマウス**

- 1 電池カバーを開き、電池を挿入します。

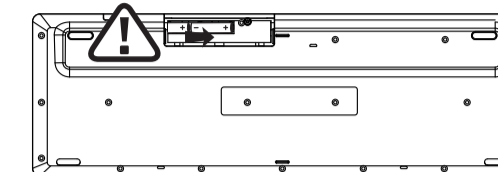
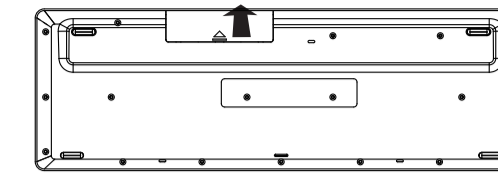

- 2 バッテリー残量が低い場合は、バッテリーのインジケータが点滅します。



- 3 電池カバーを開き、電池を挿入します。
- 4 電源スイッチを入れます。

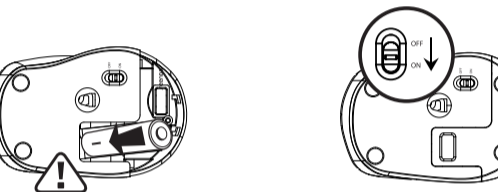

- 5 USB™レシーバーをマウスから取り出して、コンピュータに差し込みます。USB™レシーバーをコンピュータに接続します。

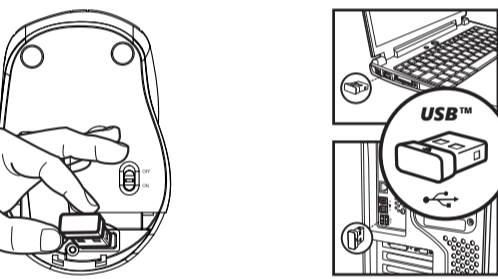

**有線キーボードとマウス**

ケーブルをコンピュータのUSB™ポートに差し込みます。

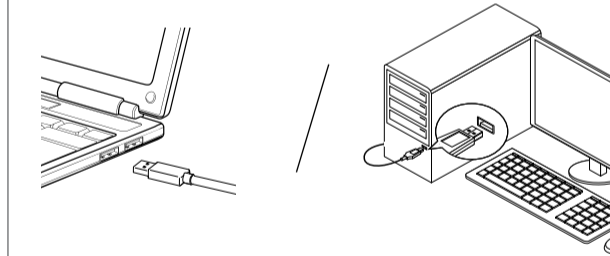

**製品の安全性**

当社の製品は、安全性を最優先に設計されています。ただし、電気機器を不適切に使用すると、火災、感電、物的損害、または怪我を引き起こす可能性があります。事故のない操作を保証するために、次のガイドラインに従ってください。

- すべての警告、注意事項、および指示を遵守すること
- 装置に損傷がないか定期的に検査すること
- 装置に損傷がなかった場合、または装置が異常な方法で機能したり、異常な音や臭いが出たり、熱くなりすぎて触れられなくなったりした場合は、使用を中止し、すぐに装置のプラグを抜くこと
- 製品とケーブルの接続については、[en.j5create.com/pages/support](http://en.j5create.com/pages/support) 或 [jp.j5create.com](http://jp.j5create.com)を確認すること
- 激しいまたは力強い動きやジェスチャーを使用して装置を操作しないでください
- 製品の梱包には、ビニール袋、ケーブルタイ、および留め具が含まれる場合があります。これらは窒息の危険性があるため、適切に廃棄し、子供の手の届かないところに保管してください
- 液体、小さな粒子、その他の異物が装置や付属品に入らないようにしてください
- 装置または付属品を高温、高湿度、または直射日光にさらさないでください
- 装置または付属品を床や、誰かがつまずいたりする可能性がある場所に置かないでください
- 装置または付属品の上に物を置かないでください。装置または付属品が過熱する可能性があります
- 装置をお客様自身で分解または修理しようとしてください。装置を分解すると、保証の対象外の損傷が発生する可能性があります

**! 警告!**



- 誤った使い方をすると、発熱したり液漏れしたりする原因となります。必ず次のルールを守ってください。
1. フラスとマイナス極を逆にしたり、分解したり、加熱したり、火にかけたりしないでください
  2. 古い電池と新しい電池、または異なる種類の電池を混ぜて使用しないでください
  3. 電池が消耗したら、すぐに本体から取り出してください
  4. 金属製品と一緒に保管しないでください
  5. 絶対に充電しないでください(電池の液漏れや破損の原因となります)
  6. 電池に強い衝撃を与えたり、変形させたりしないでください

**無線鍵盤 / 滑鼠 / 2.4G USB Receiver**

- 1 打開電池蓋並插入電池。

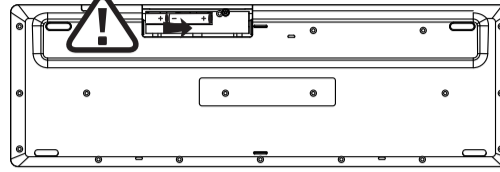
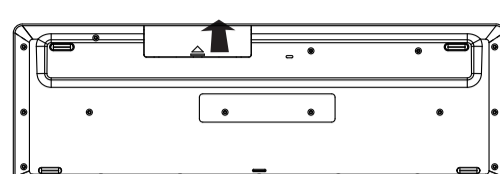

- 2 電池低電量時指示燈會閃爍

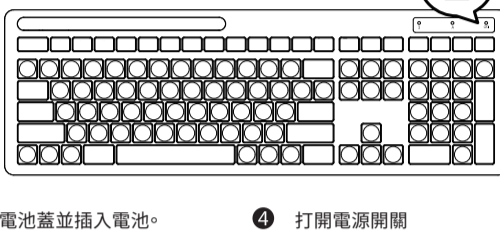

- 3 打開電池蓋並插入電池。
- 4 打開電源開關

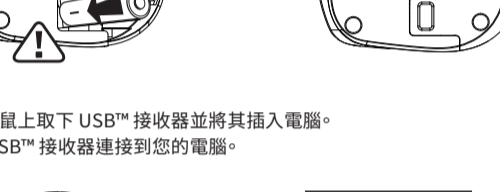

- 5 從滑鼠上取下 USB™ 接收器並將其插入電腦。將 USB™ 接收器連接到您的電腦。



**有線鍵盤和滑鼠**

將電纜插入電腦上的 USB™ 端口。

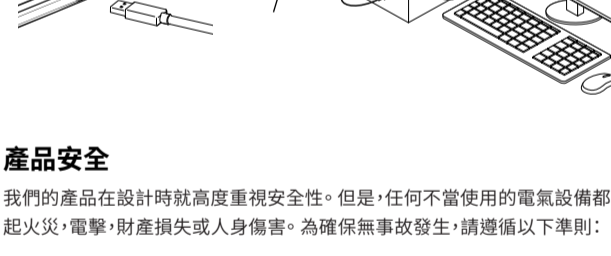

**產品安全**

我們的產品在設計時就高度重視安全性。但是，任何不當使用的電氣設備都可能引起火災、電擊、財產損失或人身傷害。為確保無事故發生，請遵循以下準則：

- 遵守所有警告、注意事項和說明
- 定期檢查設備是否損壞
- 停止使用，如果發現任何損壞，或者設備功能異常，發出異常的噪音、氣味或變得過熱而無法觸摸，請立即拔出設備的電源
- 有關產品和故障排除的更多信息，請訪問 [en.j5create.com/pages/support](http://en.j5create.com/pages/support) 或 [tw.j5create.com](http://tw.j5create.com)
- 請勿使用劇烈或有力的動作或手勢來操作設備
- 產品包裝中可能包括塑料袋、繫線帶和緊固件。妥善安置這些物質，並將其置於兒童接觸不到的地方，因為它們可能會造成窒息危險
- 請勿讓液體、小顆粒或其他異物進入設備或配件。
- 請勿將設備或配件暴露在高溫、高濕或陽光直射的地方
- 請勿將設備或配件放在地板上或可能導致他人絆倒或絆倒的地方。
- 產品包裝中可能包括塑料袋、扎線帶和緊固件。妥善安置這些物質，並將其置於兒童接觸不到的地方，因為它們可能會造成窒息危險
- 請勿讓液體、小顆粒或其他異物進入設備或配件。
- 請勿將設備或配件暴露在高溫、高濕或陽光直射的地方
- 請勿將設備或配件放在地板上或可能導致他人絆倒或絆倒的地方。
- 請勿在設備或配件上方堆放任何東西；可能會導致設備過熱
- 請勿嘗試自行拆卸或維修設備。拆卸設備可能會導致保修範圍之外的損壞

**! 警告!**

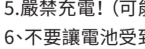

- 電池使用不當會導致發熱、漏液等，請務必遵守以下規則
1. 請勿將正負極接反、分解、加熱或投入火中
  2. 不要混用新舊電池或不同類型的電池
  3. 電池電量耗盡後，請立即將其從機器中取出
  4. 不要與金屬製品一起存放
  5. 嚴禁充電! (可能導致電池漏液或損壞)
  6. 不要讓電池受到強烈撞擊或變形
- 應包含「取得檢驗證明之低功率射頻器材」非經核准，公司、商號或使用 者均不得擅自變更頻率、加大功率或變更原設計之特性及功能。低功率射 頻器材之使用不得影響飛航安全及干擾合法通信；經發現有干擾現象時，應 立即停用，並改善至無干擾時方得繼續使用。前述合法通信，指依電信管理 法規定作業之無線電通信。低功率射頻器材須忍受合法通信或工業、科學及 醫療用電波輻射性電機設備之干擾。」

**无线键盘和鼠标**

- 1 打开电池盖并插入电池。

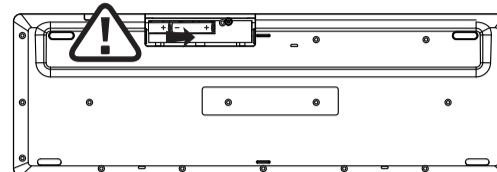
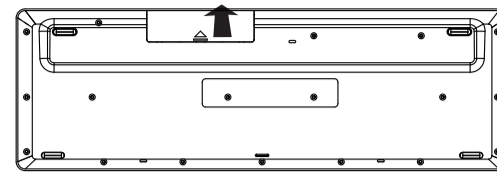

- 2 电池低电量时指示灯会亮

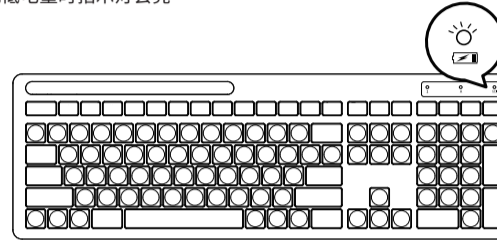

- 3 打开电池盖并插入电池。
- 4 打开电源开关

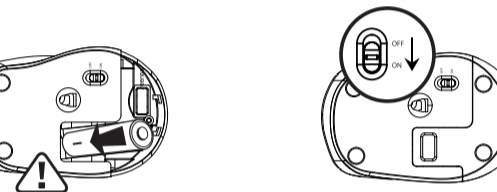

- 5 从鼠标上取下 USB™ 接收器并将其插入计算机。将 USB™ 接收器连接到您的计算机。

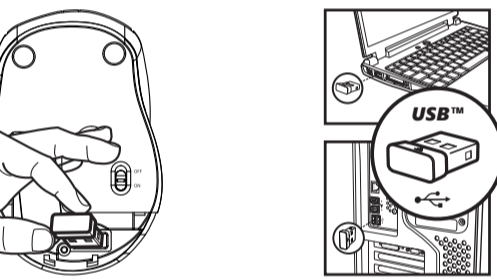

**有线键盘和鼠标**

将电缆插入计算机上的 USB™ 端口。

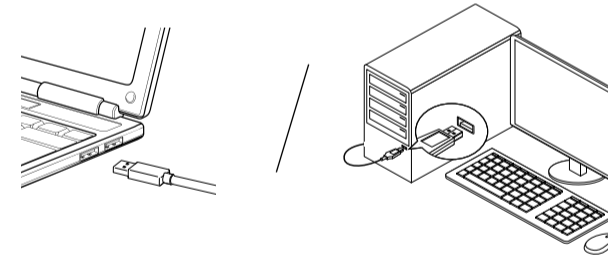

**产品安全**

我们的产品在 设计时就高度重视安全性。但是，任何不当使用的电气设备都可能引起火 灾、电击、财产损失或人身伤害。为确保无事故运行，请遵循以下准则：

- 遵守所有警告、注意事项和说明
- 定期检查设备是否损坏
- 停止使用，如果发现任何损坏，或者设备功能异常，发出异常的声音、气味或变得过热而无法触摸，请立即拔出设备的电源
- 有关产品和故障排除的更多信息，请访问 [en.j5create.com/pages/support](http://en.j5create.com/pages/support) 或 [www.j5create.com.cn](http://www.j5create.com.cn)
- 请勿使用剧烈或有力的动作或手势来操作设备
- 产品包装中可能包括塑料袋、扎线带和紧固件。妥善安置这些物质，并将其置于儿童接触不到的地方，因为它们可能会造成窒息危险
- 请勿让液体、小颗粒或其他异物进入设备或配件。
- 请勿将设备或配件暴露在高温、高湿或阳光直射的地方
- 请勿将设备或配件放在地板上或可能导致他人绊倒或绊倒的地方。
- 请勿在设备或配件上方堆放任何东西；可能会导致设备过热
- 请勿尝试自行拆卸或维修设备。拆卸设备可能会导致保修范围之外的损坏

**! 警告!**



- 电池使用不当会导致发热、漏液等，请务必遵守以下规则
1. 请勿将正负级接反、分解、加热或投入火中
  2. 不要混用新旧电池或不同类型的电池
  3. 电池电量耗尽后，请立即将其从机器中取出
  4. 不要与金属制品一起存放
  5. 严禁充电! (可能导致电池漏液或损坏)
  6. 不要让电池受到强烈撞击或变形

J5create offers a limited 1-year warranty (depending on product purchased and/or location of purchase). User's wear & tear damage is not included. The user shall call or email J5create customer service with the defect information of the product and obtain a return authorization number. Users are responsible for one-way return freight cost and we will take care of one-way freight back. In order to obtain a return authorization number, users should have the following information handy when calling or emailing the service team:

- (i) a copy of the original purchase invoice to verify your warranty
- (ii) a product serial number
- (iii) a description of the problem
- (iv) customer's name, address, and telephone number

J5create does not warrant that the operation of the product will be uninterrupted or error-free. J5create is not responsible for damage arising from failure to follow instructions relating to the product's use. This warranty does not apply to: (a) consumable parts, unless damage has occurred due to a defect in materials or workmanship; (b) cosmetic damage, including but not limited to scratches, dents, and broken plastic on ports; (c) damage caused by use with non-J5create products; (d) damage caused by natural disasters; (e) damage caused by human misuse (lost, accident, abuse, misuse or other external causes); (f) damage caused by operating the product outside the permitted or intended uses described by J5create; (g) damage caused by service (including upgrades and expansions) performed by anyone who is not a representative of J5create or a J5create Authorized Service Provider; (h) a product or part that has been modified to alter functionality or capability without the written permission of J5create; or (i) if any J5create serial number on the product has been removed or defaced. If such a situation occurs, J5create will calculate the cost of materials and repair for your reference. This warranty is given by J5create in lieu of any other warranties expressed or implied.

**LIMITATION OF WARRANTY**

THIS WARRANTY GIVES YOU SPECIFIC LEGAL RIGHTS, AND YOU MAY HAVE OTHER RIGHTS THAT VARY FROM STATE TO STATE (OR BY COUNTRY OR PROVINCE), OTHER THAN AS PERMITTED BY LAW. J5CREATE DOES NOT EXCLUDE, LIMIT OR SUSPEND OTHER RIGHTS YOU MAY HAVE, INCLUDING THOSE THAT MAY ARISE FROM THE NONCONFORMITY OF A SALES CONTRACT. FOR A FULL UNDERSTANDING OF YOUR RIGHTS YOU SHOULD CONSULT THE LAWS OF YOUR COUNTRY, PROVINCE OR STATE, TO THE EXTENT NOT PROHIBITED BY LAW IN YOUR STATE, PROVINCE, JURISDICTION OR COUNTRY. THIS WARRANTY AND THE REMEDIES SET FORTH ARE EXCLUSIVE AND IN LIEU OF ALL OTHER WARRANTIES, REMEDIES AND CONDITIONS, WHETHER ORAL, WRITTEN, STATUTORY, EXPRESS OR IMPLIED.

J5CREATE'S RESPONSIBILITY FOR MALFUNCTIONS AND DEFECTS IN HARDWARE AND/OR SOFTWARE IS LIMITED TO REPAIR OR REPLACEMENT AS SET FORTH IN THIS WARRANTY. J5CREATE'S LIABILITY DOES NOT EXTEND BEYOND THE REMEDIES PROVIDED FOR IN THIS LIMITED WARRANTY, AND J5CREATE DOES NOT ACCEPT LIABILITY FOR CONSEQUENTIAL OR INCIDENTAL DAMAGES, FOR THIRD-PARTY CLAIMS AGAINST YOU FOR DAMAGES, FOR PRODUCTS NOT BEING AVAILABLE FOR USE, OR FOR LOST OR DAMAGED DATA OR SOFTWARE. J5CREATE DOES NOT WARRANT THAT THE OPERATION OF ANY J5CREATE PRODUCT WILL BE UNINTERRUPTED OR ERROR FREE.

J5CREATE'S LIABILITY IN ANY SITUATION WILL BE NO MORE THAN THE AMOUNT YOU PAID FOR THE SPECIFIC PRODUCT THAT IS THE SUBJECT OF A CLAIM. THIS IS THE MAXIMUM AMOUNT FOR WHICH WE ARE RESPONSIBLE. EXCEPT FOR THE EXPRESS WARRANTIES CONTAINED IN THIS WARRANTY AND TO THE EXTENT NOT PROHIBITED BY LAW, J5CREATE DISCLAIMS ALL OTHER WARRANTIES AND CONDITIONS, EXPRESS OR IMPLIED, STATUTORY OR OTHERWISE, INCLUDING WITHOUT LIMITATION, WARRANTIES OF MERCHANTABILITY, MERCHANTABLE QUALITY AND FITNESS FOR A PARTICULAR PURPOSE AND WARRANTIES AND CONDITIONS AGAINST HIDDEN OR LATENT DEFECTS. SOME STATES, PROVINCES, JURISDICTIONS OR COUNTRIES DO NOT ALLOW DISCLAIMERS OF IMPLIED WARRANTIES AND CONDITIONS, SO THIS DISCLAIMER MAY NOT APPLY TO YOU.

TO THE EXTENT SUCH WARRANTIES AND CONDITIONS CANNOT BE DISCLAIMED UNDER THE LAWS OF THE UNITED STATES, CANADA (AND ITS PROVINCES) OR OTHERWISE, J5CREATE LIMITS THE DURATION AND REMEDIES OF SUCH WARRANTIES AND CONDITIONS TO THE DURATION OF THIS EXPRESS LIMITED WARRANTY AND, AT J5CREATE'S OPTION, REPAIR OR REPLACEMENT SERVICES. SOME STATES, PROVINCES, JURISDICTIONS OR COUNTRIES MAY NOT ALLOW LIMITATIONS ON HOW LONG AN IMPLIED WARRANTY OR CONDITION LASTS, SO THIS LIMITATION MAY NOT APPLY TO YOU.

NO WARRANTIES OR CONDITIONS, WHETHER EXPRESS OR IMPLIED, WILL APPLY AFTER THE LIMITED WARRANTY PERIOD HAS EXPIRED. SOME STATES, PROVINCES, JURISDICTIONS OR COUNTRIES DO NOT ALLOW LIMITATIONS ON HOW LONG AN IMPLIED WARRANTY OR CONDITION LASTS, SO THIS LIMITATION MAY NOT APPLY TO YOU.

WARRANTY SUPPORT ONLY APPLIES WHEN THE COVERED PRODUCT IS LOCATED WITHIN THE COUNTRY IN WHICH J5CREATE ORIGINALLY SOLD THE SYSTEM, AS REFLECTED IN J5CREATE'S RECORDS. IF YOU NEED SUPPORT FOR THE PRODUCT OUTSIDE OF THE COUNTRY OF ORIGIN (FOR EXAMPLE, WHILE TRAVELING, OR IF THE SYSTEM HAS BEEN RELOCATED TO A NEW COUNTRY), THEN J5CREATE MAY OFFER YOU OTHER SUPPORT OPTIONS FOR AN ADDITIONAL CHARGE.

For more information please visit our website at <http://www.j5create.com>  
Copyright© 2021 J5create. All rights reserved. All trade names are registered trademarks of their respective owners. Features and specifications are subject to change without notice. Product may not be exactly as shown in the diagrams.

**STOP**

If you have any problems with this product please contact our technical support team for assistance.

**TECHNICAL SUPPORT**

Customer Service: **888-988-0488**  
Technical Support: **888-689-4088**  
Email: [service@j5create.com](mailto:service@j5create.com)

**SOPORTE TÉCNICO**  
Número gratuito: +1-888-988-0488  
Horario de atención:  
Lun-Vie, 10:00 a.m. - 6:00 U.S.A.-E.S.T  
Email: [service@j5create.com](mailto:service@j5create.com)

**TECHNISCHER SUPPORT**  
Kostenlos Anruf bei: +1-888-988-0488  
Sprachstunden:  
Mon-Fri, 10:00 – 18:00 U.S.A.-E.S.T  
E-mail: [service@j5create.com](mailto:service@j5create.com)

**TECHNICKÁ PODPORA**  
Zákaznická linka: 888-988-0488  
Technická podpora: 888-689-4088  
E-mail: [service@j5create.com](mailto:service@j5create.com)

**テクニカルサポート**  
お客様相談センター: 03-5546-9010  
電子メール: [j5\\_support@solinet.jp](mailto:j5_support@solinet.jp)  
お問い合わせ先: 〒100-0001 東京都千代田区千代田1-1-1  
営業時間: 平日 9:30-17:30 (13:30-17:30)

**技術支援資訊**  
美國客服專線: +1-888-988-0488  
台灣客服專線: +886-2-2269-5533#19  
營業時間: 星期一至星期五 9:30 AM-6:00PM (台灣時間)  
Email 信箱: [service.tw@j5create.com](mailto:service.tw@j5create.com)

This equipment has been tested and found to comply with the limits for a Class B digital device, pursuant to Part 15 of the FCC Rules. These limits are designed to provide protection against harmful interference in a residential installation. This equipment generates, uses and can radiate radio frequency energy and, if not installed and used in accordance with the instructions, may cause harmful interference to radio communications. However, there is no guarantee that interference will not occur in a particular installation. If this equipment does cause harmful interference to radio or television reception, which can be determined by turning the equipment off and on, the user is encouraged to try to correct the interference by one or more of the following measures:

- Reorient or relocate the receiving antenna.
- Increase the separation between the equipment and receiver.
- Connect the equipment into an outlet on a circuit different from that to which the receiver is connected.
- Consult the dealer or an experienced radio/TV technician for help.

FCC Caution: Any changes or modifications not expressly approved by the party responsible for compliance could void the user's authority to operate this equipment.

This device complies with Part 15 of the FCC Rules. Operation is subject to the following two conditions: (1) This device may not cause harmful interference, and

(2) This device must accept any interference received, including interference that may cause undesired operation.

This device and its antenna(s) must not be co-located or operating in conjunction with any other antenna or transmitter.

**Federal Communication Commission (FCC) Radiation Exposure Statement**

This equipment complies with FCC radiation exposure limits set forth for an uncontrolled environment. End user must follow the specific operating instructions for satisfying RF exposure compliance.

設備名稱: 無線鍵盤		型號 (型式): JIKMW115-K				
Equipment name		Type designation (Type)				
單元 Unit	限制物質及其化學符號 Restricted substances and its chemical symbols					
	鉛Lead (Pb)	汞Mercury (Hg)	鎘Cadmium (Cd)	六價鉻Hexavalent chromium (Cr+6)	多溴聯苯Polybrominated biphenyls (PBBs)	多溴二苯醚Polybrominated diphenyl ethers (PBDEs)
外殼	○	○	○	○	○	○
電路板	○	○	○	○	○	○
滾輪	○	○	○	○	○	○
線材	○	○	○	○	○	○

備考 1: "超出 0.1 wt %" 及 "超出 0.01 wt %" 係指限制物質之百分比含量超出百分比含量基準值。  
Note 1: "Exceeding 0.1 wt %" and "exceeding 0.01 wt %" indicate that the percentage content of the restricted substance exceeds the reference percentage value of presence condition.  
備考 2: "○" 係指該項限制物質之百分比含量未超出百分比含量基準值。  
Note 2: "○" indicates that the percentage content of the restricted substance does not exceed the percentage of reference value of presence.  
備考 3: "-" 係指該項限制物質為排除項目。  
Note 3: The "-" indicates that the restricted substance corresponds to the exemption.

設備名稱: 無線滑鼠		型號 (型式): JIKMW115-M				
Equipment name		Type designation (Type)				
單元 Unit	限制物質及其化學符號 Restricted substances and its chemical symbols					
	鉛Lead (Pb)	汞Mercury (Hg)	鎘Cadmium (Cd)	六價鉻Hexavalent chromium (Cr+6)	多溴聯苯Polybrominated biphenyls (PBBs)	多溴二苯醚Polybrominated diphenyl ethers (PBDEs)
外殼	○	○	○	○	○	○
電路板	○	○	○	○	○	○
滾輪	○	○	○	○	○	○
線材	○	○				

5EDMW115100101

修改日期:2021-10-20

製作版本:V1-0版

客戶名稱:j5create

產品名稱:鍵盤滑鼠系列

需求內容:QIG

成型尺寸:100X210mm

展開尺寸:700x420mm

材 質:70p模造紙

雙面黑白雙面印十W折後對折