

CONTENTS

Important Safety Instructions	2
Safety Information	3
Preparations	4
What is Included	
Front View	
Rear View	
Installing the Stand	
Removing the Stand for Wall-Mounting	
Wall-Mounting Screws	
Remote Control	
Connecting External Devices	9
Customizing TV Settings	10
Turning On/Off Your TV	
Remote Pairing	
Setup Wizard	
Inputs	
Volume Adjustment	
Get The Most Out Of Your Element Voice Remote With Google Assistant	
Home Page	
TV	
Channels	
TV Options	
Settings	
Network	
Picture	
Sound	
Storage & reset	
Date & time	
Accessibility	
Security & restrictions	
Parental Control	24
Troubleshooting	26
Maintaining	27
Specfication	28
Obtaining Warranty Service	29

IMPORTANT SAFETY INSTRUCTIONS

- **Read these instructions** – All the safety and operating instructions should be read before this product is operated.
- **Keep these instructions** – The safety and operating instructions should be retained for future reference.
- **Heed all warnings** – All warnings on the appliance and in the operating instructions should be adhered to.
- **Follow all instructions** – All operating and use instructions should be followed.
- **Do not use this apparatus near water** – The appliance should not be used near water or moisture – for example, in a wet basement or near a swimming pool, and the like.
- Clean only with dry cloth.
- **Do not block any ventilation openings.** Install in accordance with the manufacturer's instructions.
- **Do not install near any heat sources** such as radiators, heat registers, stoves, or other apparatus (including amplifiers) that produce heat.
- **Do not defeat the safety purpose of the polarized or grounding-type plug.** A polarized plug has two blades with one wider than the other. A grounding-type plug has two blades and a third grounding prong. The wide blade or the third prong are provided for your safety. If the provided plug does not fit into your outlet, consult an electrician for replacement of the obsolete outlet.
- Protect the power cord from being walked on or pinched particularly at plugs, convenience receptacles, and the point where they exit from the apparatus.
- Only use attachments/accessories specified by the manufacturer.
- Use only with the cart, stand, tripod, bracket, or table specified by the manufacturer, or sold with the apparatus. When a cart is used, use caution when moving the cart/apparatus combination to avoid injury from tip-over.



- Unplug this apparatus during lightning storms or when unused for long periods of time.
- Refer all servicing to qualified service personnel. Servicing is required when the apparatus has been damaged in any way, such as the power-supply cord or plug is damaged, liquid has been spilled or objects have fallen into the apparatus, the apparatus has been exposed to rain or moisture, does not operate normally, or has been dropped.
- Please keep the unit in a well-ventilated environment.

WARNING: To reduce the risk of fire or electric shock, do not expose this apparatus to rain or moisture. The apparatus should not be exposed to dripping or splashing. Objects filled with liquids, such as vases should not be placed on apparatus.

WARNING: The batteries shall not be exposed to excessive heat such as sunshine, fire or the like.

WARNING: The main plug is used as disconnect device, the disconnect device shall remain readily operable.

WARNING: To reduce the risk of electric shock, do not remove cover (or back) as there are no user-serviceable parts inside. Refer servicing to qualified personnel.



This lightning flash with arrowhead symbol within an equilateral triangle is intended to alert the user to the presence of non-insulated "dangerous voltage" within the product's enclosure that may be of sufficient magnitude to constitute a risk of electric shock.



The exclamation point within an equilateral triangle is intended to alert the user to the presence of important operating and maintenance instructions in the literature accompanying the appliance.



This equipment is a Class II or double insulated electrical appliance. It has been designed in such a way that it does not require a safety connection to electrical earth.



This product contains electrical or electronic materials. The presence of these materials may, if not disposed of properly, have potential adverse effects on the environment and human health.

Presence of this label on the product means it should not be disposed of as unsorted waste and must be collected separately. As a consumer, you are responsible for ensuring that this product is disposed of properly.



The terms HDMI and HDMI High-Definition Multimedia Interface, and the HDMI Logo are trademarks or registered trademarks of HDMI Licensing Administrator, Inc in the United States and other countries.

Licensing and Patent Information

This WESTINGHOUSE product may be covered by one or more U.S. and foreign patents and patent applications.

SAFETY INFORMATION

To ensure reliable and safe operation of this equipment, please read carefully all the instructions in this user guide, especially the safety information below.

Electrical Safety

- The TV set should only be connected to a main power supply with voltage that matches the label at the rear of the product.
- To prevent overload, do not share the same power supply socket with too many other electronic components.
- Do not place any connecting wires where they may be stepped on or tripped over.
- Do not place heavy items on any connecting wire, which may damage the wire.
- Hold the main plug, not the wires, when removing from a socket.
- During a thunderstorm or when not in using the television for long periods, turn off the power switch on the back of the television.
- Do not allow water or moisture to enter the TV or power adapter. Do NOT use in wet, moist areas, such as bathrooms, steamy kitchens or near swimming pools.
- Pull the plug out immediately, and seek professional help if the main plug or cable is damaged, liquid is spilled onto the set, if the TV set accidentally exposed to water or moisture, if anything accidentally penetrates the ventilation slots or if the TV set does not work normally.
- Do not remove the safety covers. There are no user serviceable parts inside. Trying to service the unit this apparatus.
- To avoid a battery leakage, remove batteries from the remote control, when the remote is not use for long period, or when the batteries are exhausted.
- Do not break open or throw exhausted batteries into a fire.
- For best results, use type AAA (example-alkaline, carbon-zinc, etc.) batteries.
- Install only new batteries of the same type in your product.
- Failure to insert batteries in the correct polarity, as indicated in the battery compartment, may shorten the life of the batteries or cause batteries to leak.
- Do not mix old and new batteries.
- Do not mix Alkaline, Standard (Carbon-Zinc) or Rechargeable (Nickel Cadmium) or (Nickel Metal Hydride) batteries.
- Batteries should be recycled or disposed of as per state and local guidelines.
- Do not attempt to recharge disposable batteries.
- Do not short circuit battery terminals.
- Keep away from children.

Physical Safety

- Do not block ventilation slots in the back cover. You may place the TV in a cabinet, but ensure at least 5cm (2") clearance all around.
- Do not tap or shake the TV screen, or you may damage the internal circuits. Take good care of the remote control.
- To clean the TV use a soft dry cloth. Do not use solvents or petroleum based fluids.
- Do not install near any heat sources such as radiators, heat registers, stoves or other apparatus (including amplifiers) that produce heat.
- Do not defeat the safety purpose of the polarized or grounding-type plug. A polarized plug has two blades with one wider than the other. A grounding type plug has two blades and a third grounding prong, the wide blade, or the third prong is provided for your safety. If the provided plug does not fit into your outlet, consult an electrician for replacement of the obsolete outlet.
- Protect the power cord from being walked on or pinched particularly at plugs.
- Unplug the apparatus during lightning storms or when unused for long periods.
- Refer all servicing to a qualified service personnel. Servicing is required if the apparatus does not operate normally or if the apparatus, including the power supply cord or pulg, has been damaged in any way.
- Servicing is also required if liquid has been spilled, or objects have fallen into the apparatus; when the apparatus has been exposed to rain or moisture; or if the apparatus has been dropped.
- Always connect your television to a power outlet with protective ground connection.
- Minimum 5cm disances around the apparatus for sufficient ventilation.
- The ventilation should not be impeded by covering the ventilation openings with items, such as newspapers, table-cloths, curtains, etc.
- No naked flame sources, such as lighted candles should be placed on the apparatus.
- Attention should be drawn to the environmental aspects of battery disposal.

PREPARATION

What is Included

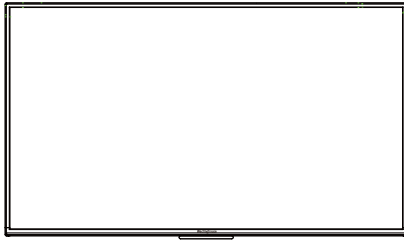

TV Set

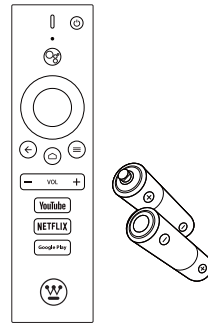

Remote Control with Batteries

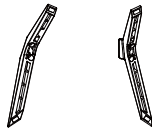

TV Stand



Four Screws

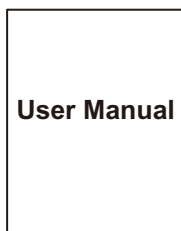

User Manual

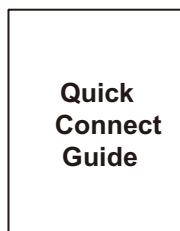

Quick Connect Guide

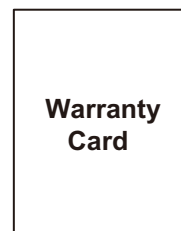

Warranty Card

PREPARATION

Front View

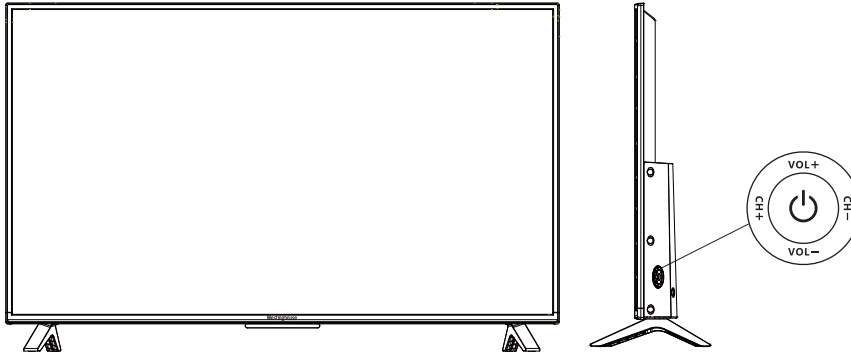

-  Switch the TV between On / Standby mode.
- **CH +/-**
Press to select a channel.
- **VOL +/-**
Press to adjust the volume.
- **POWER Indicator**
Illuminate white when the TV is in standby mode.
- **IR (Infrared Receiver)**
Receive IR signals from the remote control.

PREPARATION

Rear View

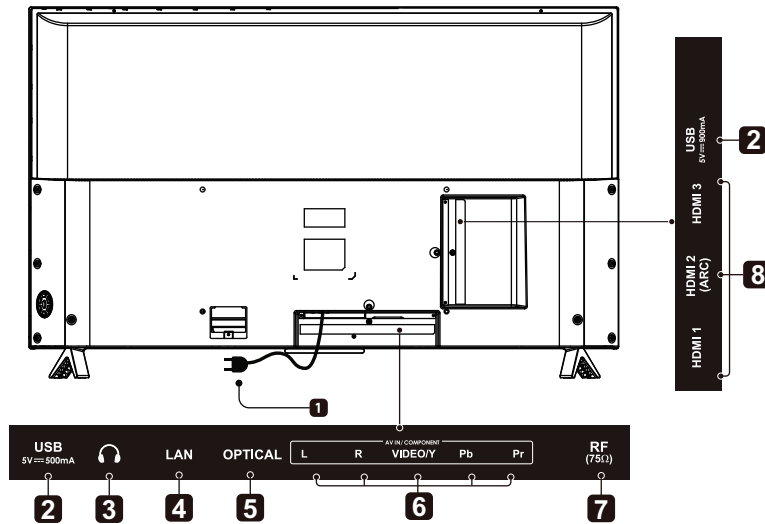

1. Power Cord

Connect to AC power outlet.

2. USB Input

Connect to a USB storage device to play photo files. (USB mode)

3. Headphone output

Connect to the Headphones.

4. LAN

Network connection port.

5. Optical Output

Connect a digital sound system to this jack.

6. COMPONENT/AV Input

Connect to AV devices with composite/ component (Y/Pb/Pr) video and audio output sockets. COMPOSITE VIDEO and COMPONENT(Y/PB/PR) share with AUDIO IN (L/R).

7. Antenna Input (75Ω VHF/UHF)

Connect to the antenna (75Ω VHF/UHF) socket with the RF coaxial cable.

8. HDMI Inputs

Connect to a High-Definition (HD) signal input device.

PREPARATION

Installing the Stand

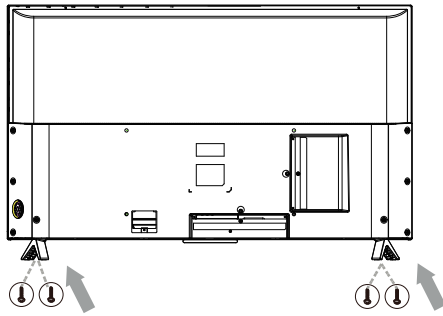

1. Lay the TV face-down on a flat, cushioned surface to avoid damages and scratches.
2. Fix the Left Base Stand to the main unit using 2pcs provided screws.
3. Fix the Right Base Stand to the main unit using 2pcs provided screws.

Removing the Stand for Wall-Mounting

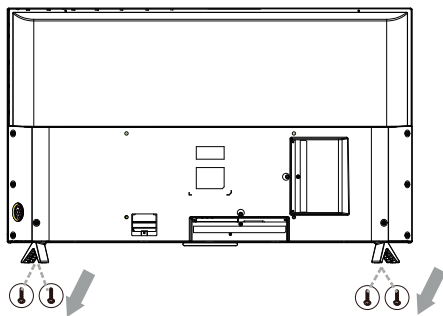

1. Lay the TV face down on a flat, cushioned surface to avoid damages and scratches.
2. Untighten the 4 pcs screws holding the stand assembly and remove them.
3. Attach the wall-mount bracket to the TV using the mounting holes on the back of the TV. Mount this TV according to the instructions included in the wall-mount bracket.

Wall-Mounting Screws

- Mount the VESA bracket using 4*M6*10 isometric threaded screws (not included).
- WARNING: To prevent injury, this apparatus must be securely attached to the floor/wall in accordance with the installation instruction.

WARNING:

Never place a television set in an unstable location. A television set may fall, causing serious personal injury or death. Many injuries, particularly to children, can be avoided by taking simple precautions such as:

- Using cabinets or stands recommended by the manufacturer of the television set.
- Only using furniture that can safely support the television set.
- Ensuring the television set is not overhanging the edge of the supporting furniture.
- Not placing the television set on tall furniture (for example, cupboards or bookcases) without anchoring both the furniture and the television set to a suitable support.
- Not placing the television set on cloth or other materials that may be located between the television set and supporting furniture.
- Attention should be drawn to the environmental aspects of battery disposal.
- Educating children about the dangers of climbing on furniture to reach the television set or its controls.

If your existing television set is being retained and relocated, the same considerations as above should be applied.

PREPARATION

Remote Control

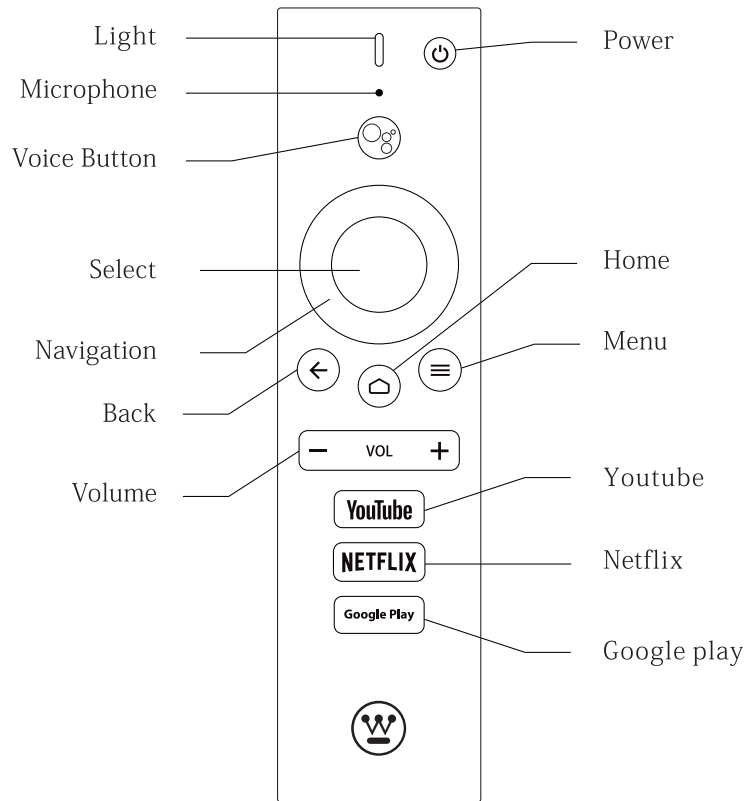

Voice Remote with Google Assistant

CONNECTING EXTERNAL DEVICES

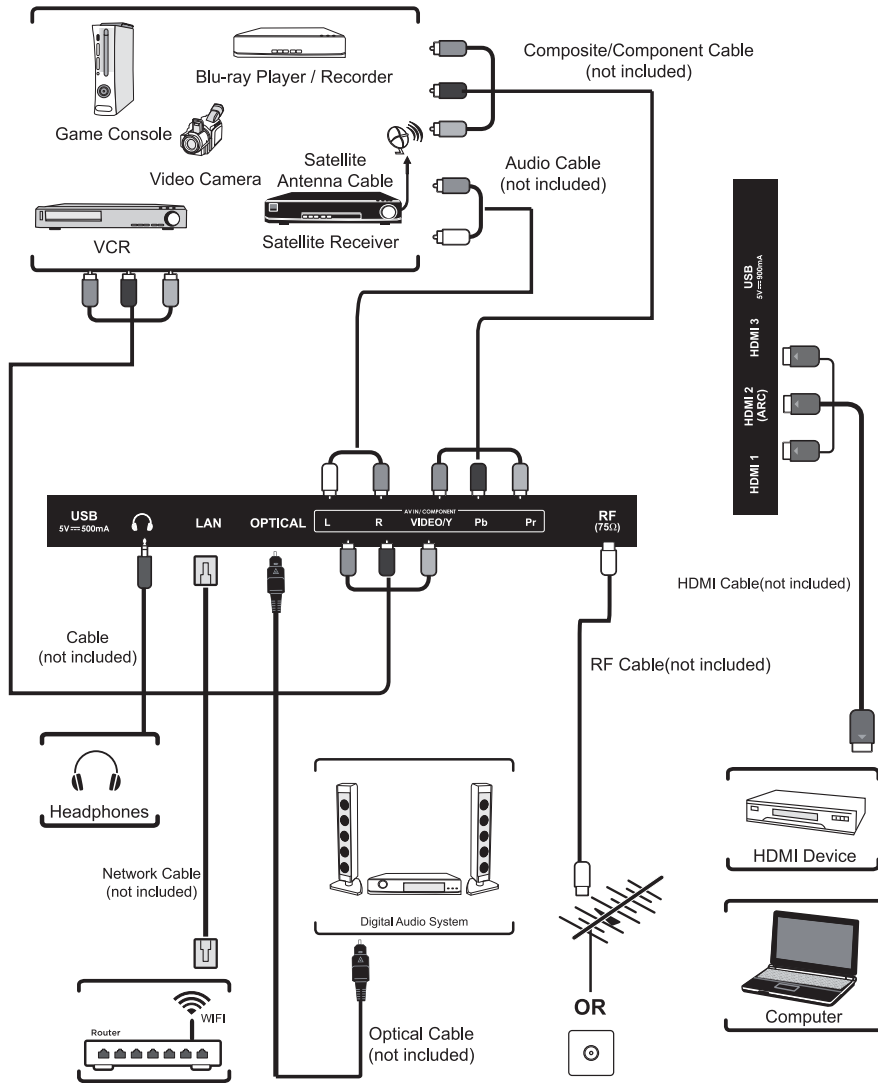

CUSTOMIZING TV SETTINGS

Turning On/Off Your TV

- Connect the power cord to the power socket after you have completed all the physical connections. At this stage, the TV will enter Standby Mode and the white LED indicator will illuminate.
- In Standby Mode, press the **U** button on the main unit or on the remote control to turn the TV on.
- You can control your Android TV using the included remote, the Android TV Remote app, or the directional controller on the back of the TV. Download the Android TV Remote App to your iOS or Android device by visiting the appropriate app store for your device.



The **POWER** button on the main unit or on the remote control can only switch the TV into standby. To completely turn off the TV, please disconnect the power cord from the power socket.

Remote Pairing

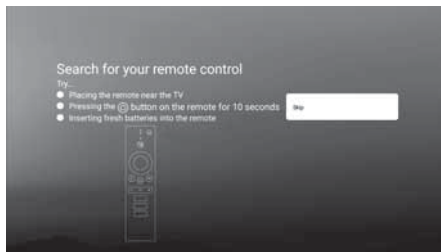

1

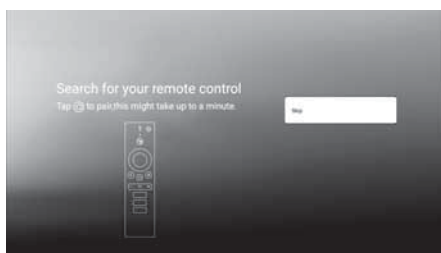

2

- Once you've connected your devices to your television and plugged it in, insert the included AAA batteries into the back of the remote and press the **U** "power" button on the remote. Your television will start and after press and hold the **U** button on your remote for 10 seconds you will be prompted to pair your remote with your television. Pairing your remote to your television is necessary because the remote uses Bluetooth to send most button commands and voice commands to your television.
- If your television doesn't find your remote, remove and reinsert the batteries in your remote. If your remote doesn't pair with your TV press and hold the **U** button on your remote for 10 seconds while your television is searching for your remote.
- Once you've paired your remote, follow the on-screen instructions to set up your TV.

CUSTOMIZING TV SETTINGS

Setup Wizard

- The first time you turn the TV on, it will go into the Setup Wizard after remote pairing. Press the "Navigation" buttons to highlight and select your desired mode and press "Select" to confirm.

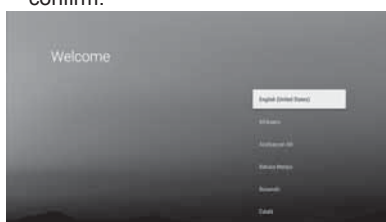

1

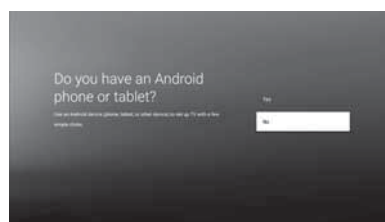

2

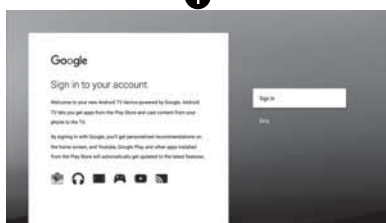

3

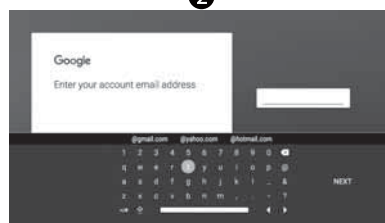

4

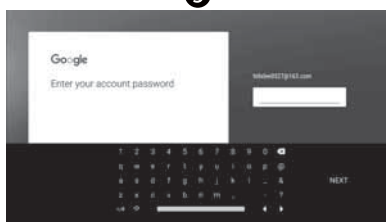

5

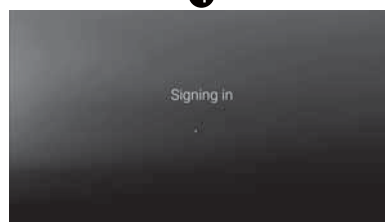

6

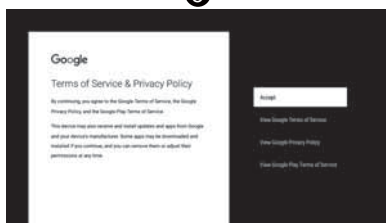

7

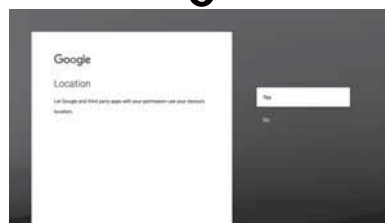

8



9

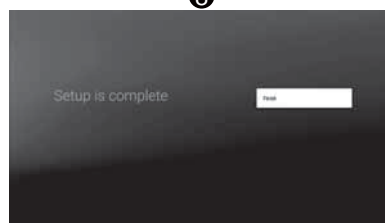

10

CUSTOMIZING TV SETTINGS

Inputs



- Press **Navigation** buttons on the remote control to display the Inputs menu, then use the **Navigation** buttons to cycle among the different inputs: Antenna/HDMI1/HDMI2/HDMI3/Composite/Component/Channels, then use the **Navigation** buttons to highlight the desired the Inputs menu and press **Select** to confirm.

Volume Adjustment

- Press the **VOL+/-** buttons on the main unit or on the remote control to adjust the volume.
- If you wish to switch the sound off, press and hold the **VOL-** button on your remote to 0.

Get The Most Out of Your Element Voice Remote With Google Assistant

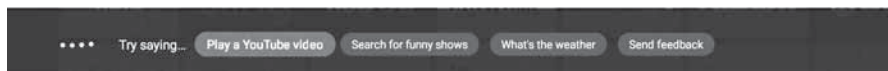

Connect to the Internet and sign in with your Google account

Connect your TV to the Internet and sign in with your Google account to use voice commands with your voice remote and to enjoy thousands of movies, shows, and games from Google Play, You Tube and your favorite apps. Voice search and personalized recommendations mean more time being entertained and less time hunting for something good.

About your Element Voice Remote with Google Assistant

Simply press and hold the Voice button  and speak. Release the button when you are done speaking. You can use your voice to change channels or search for movies, TV shows, actors, directors, apps, games, and more.

Simply say:

- Play Stranger Things
- Show me some popular action movies from 2016
- You Tube
- What is the weather like in New York?

To learn more about voice commands you can use with your Element voice remote with Google Assistant, visit <https://support.google.com/assistant/answer/7540545>.

ANDROID TV REMOTE CONTROL APP

Use your Android phone or tablet as a remote for your Android TV. Easily switch between d-pad and touchpad modes to navigate content and play games on your Android TV device. Tap the mic to start a voice search, or use the keyboard to input text on Android TV.

To learn more about using your phone or tablet as a remote control for Android TV, visit <https://support.google.com/androidtv/answer/6122465?hl=en>.

CUSTOMIZING TV SETTINGS

Home Page



- Press **⏪** button on the remote to display the home page. Then use the **Navigation** buttons to select the home page (Recommended contents/Featured apps/Apps/Inputs/Settings) and press **Select** to enter. Use the **Navigation** buttons to select the desired APP and press **Select** button to view. Or press the hotkey(YouTube/NETFLIX/Google Play) on the remote control to enter the desired APP directly. You could download more apps and games from Google Play Store. For full listing of available Apps, please visit: https://play.google.com/store/apps/collection/promotion_3000e26_androidtv_apps_all?hl=en.

TV



- Press **⏪** button to display the home page, then use the **Navigation** buttons to highlight **TV** under Apps and press **Select** to confirm. Select between Channels and TV options.

CUSTOMIZING TV SETTINGS

□ Channels

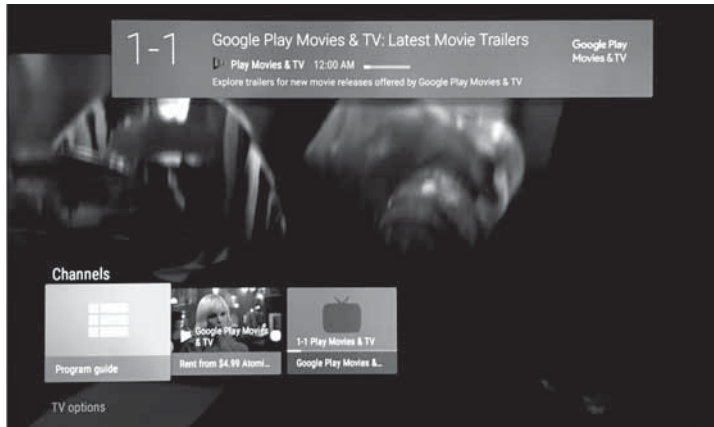

Your TV has an Electronic Programme Guide (EPG) to help you navigate through all your possible viewing options. The EPG supplies information such as programme listings, start and end times for all available. In addition, detailed information about the programme is often available in EPG (the availability and amount of programme information will vary, depending on the particular broadcast). This function can only be used when the information is broadcast by the broadcasting companies. The EPG displays the programme details for the next 7 days.

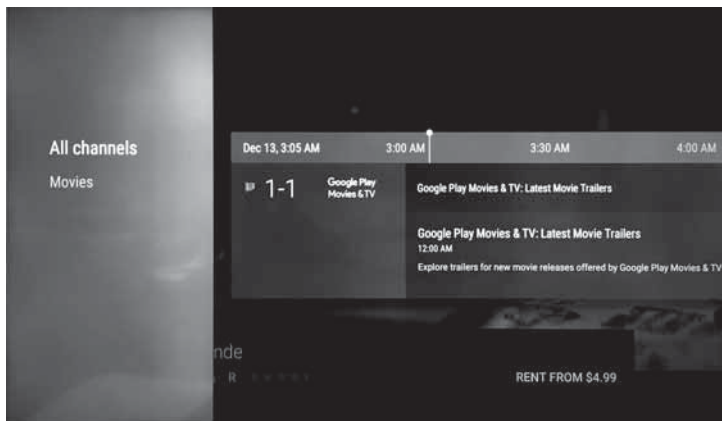

1. Press **Select** button on the remote control to select the Programme Guide.
2. Use the **Navigation** buttons to select the station you wish to watch or listen to, then press the **Select** button to tune to that station.

CUSTOMIZING TV SETTINGS

□ TV Options

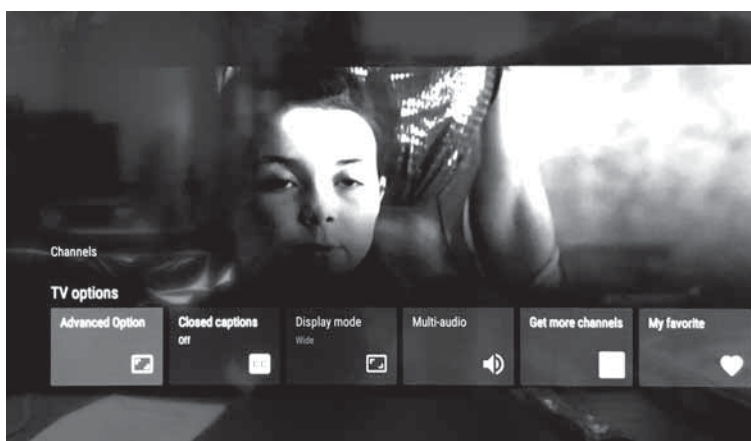

- Press  button to display the home page, then use the **Navigation** buttons to highlight **TV** under Apps and press **Select** to confirm, then use the **Navigation** buttons to highlight the desired TV options and press **Select** to confirm.

Advanced Option	You can also change the advanced option settings,for example Inputs Setting/Time/Misc(at TV mode). Note: With a different input source, the advanced option may differ.
Closed captions	Allows you to turn closed captioning of audio on or off, select analog or digital modes, or personalize the captioning style.
Display mode	Select display mode: Standard/Auto/Wide/Zoom/Just scan
Multi-audio	A variety of voice narration.
Get more channels	Get more channels from Google play
My favorite	Set the selected channel as a favorite channel.
Settings	Setting channel and parental controls

CUSTOMIZING TV SETTINGS

Settings

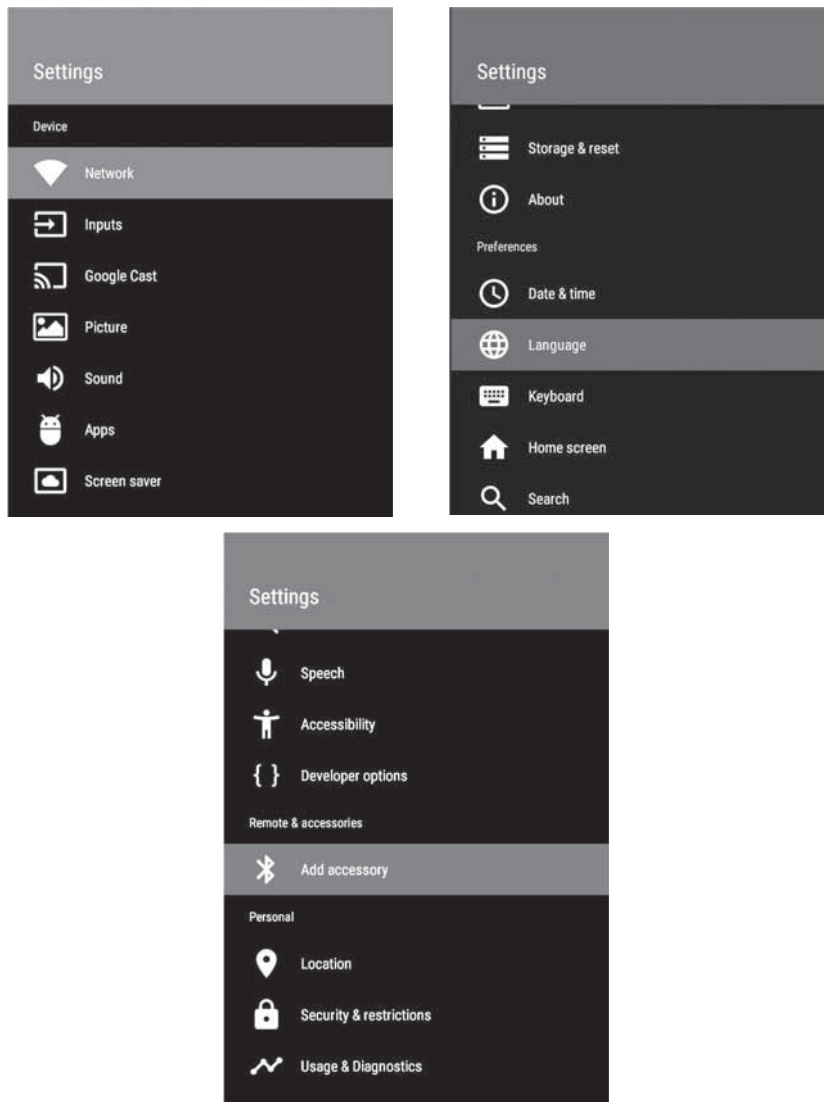

- Press **Navigation** buttons on the remote control to display the settings menu, then use the **Navigation** buttons to highlight the desired settings and press **Select** to confirm.

CUSTOMIZING TV SETTINGS

□ Network

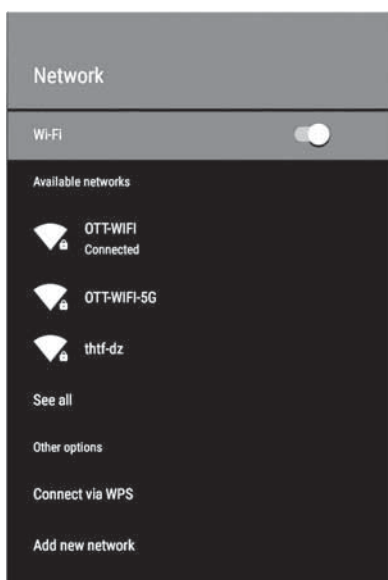



- Press  to display the home page, use the **Navigation** buttons to highlight Settings and press **Select** to confirm. Then Use the **Navigation** buttons to select Network to enter and adjust each option setting.

Wi-Fi	WIFI switch WIFI link
See all	Display all the available networks
Other options	More settings network option.
Connect via WPS	Connect WPS network
Add new network	Add more new networks

CUSTOMIZING TV SETTINGS

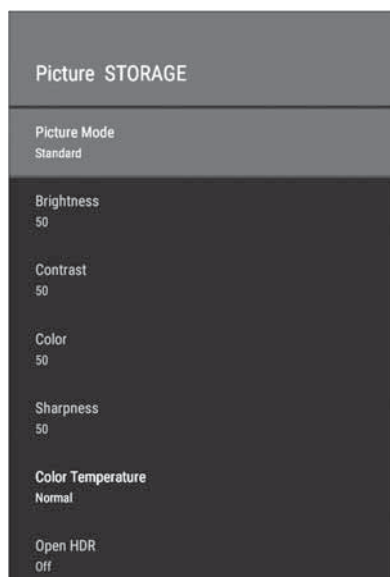
□ Picture





- Press  to display the home page, use the **Navigation** buttons to highlight Settings and press **Select** to confirm. Then Use the **Navigation** buttons to select Picture to enter and adjust each option setting.

Picture Mode	Cycle among picture modes: Dynamic/Standard/Movie/User/PC Mode.
Brightness	Increase or decrease the amount of white in the picture.
Contrast	Adjust the difference between light and dark levels in the pictures.
COLOR	Control the color intensity.
Sharpness	Adjust crispness level in edges between light and dark areas of the picture.
Color Temperature	Cycle among color temperatures: Cool / Normal / Warm / User.
Open HDR	On/Off

CUSTOMIZING TV SETTINGS

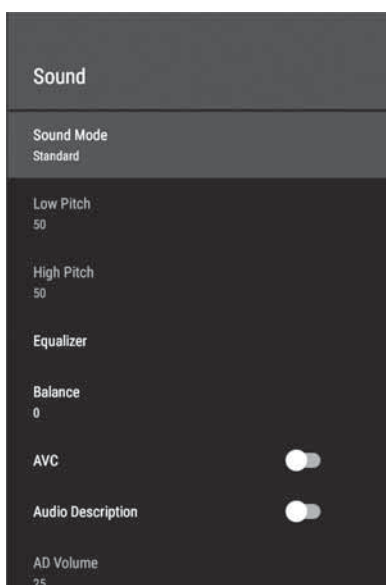
□ Sound





- Press  to display the home page, use the **Navigation** buttons to highlight Settings and press **Select** to confirm. Then Use the **Navigation** buttons to select Sound to enter and adjust each option setting.

Sound mode	Allow the selection of an audio-enhancement technique: Standard/Music/Movie/User.
Low Pitch	Control the relative intensity of lower-pitched sounds.
High Pitch	Control the relative intensity of higher-pitched sounds.
Equalizer	Sound effects
Balance	Adjust the relative volume of the speaker in a multiple speaker system.
AVC	Turn On/Off to automatically control volume levels.
Audio Description	The voice for the blind person tells the motion of the audio
AD Volume	The volume for the sound of a blind person

CUSTOMIZING TV SETTINGS

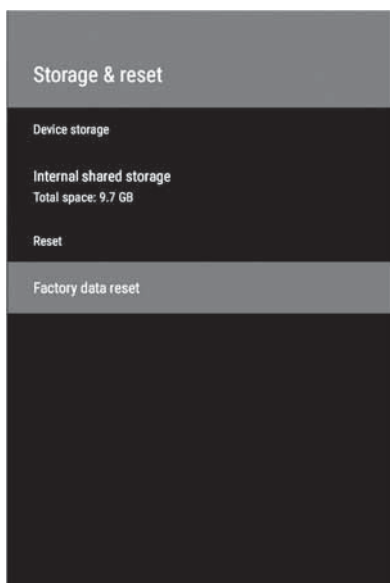
Storage & reset





- Press  to display the home page, use the **Navigation** buttons to highlight Settings and press **Select** to confirm. Then Use the **Navigation** buttons to select Storage & reset to enter and adjust each option setting.

Internal shared storage	Display Internal shared storage
Factory date reset	Select to reset the Factory date setting.

CUSTOMIZING TV SETTINGS

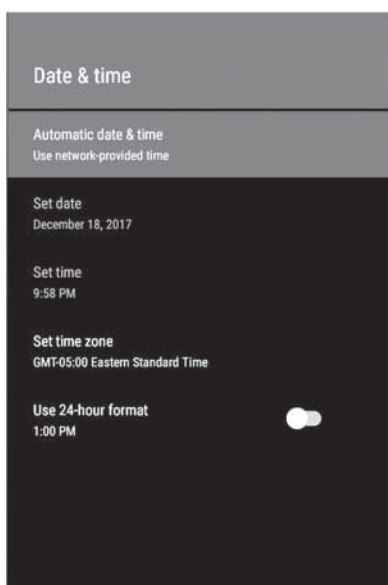
Date & time





- Press  to display the home page, use the **Navigation** buttons to highlight Settings and press **Select** to confirm. Then Use the **Navigation** buttons to select Date & time to enter and adjust each option setting.

Automatic date & time	Automatic date and time.
Set date	Set the system date
Set time	Set the system timer
Set time zone	Select a Time Zone
Use 24-hour format	Select 24-hour format.

CUSTOMIZING TV SETTINGS

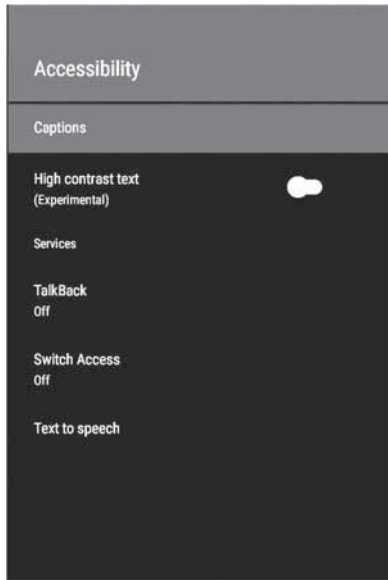
□ Accessibility





- Press  to display the home page, use the **Navigation** buttons to highlight Settings and press **Select** to confirm. Then Use the **Navigation** buttons to select Accessibility to enter and adjust each option setting.

Captions	Display Captions
High contrast text	Display High contrast text
TalkBack	Setting TalkBack On/Off
Switch Access	Switch Access is On/Off
Text to speech	Text change to speech

CUSTOMIZING TV SETTINGS

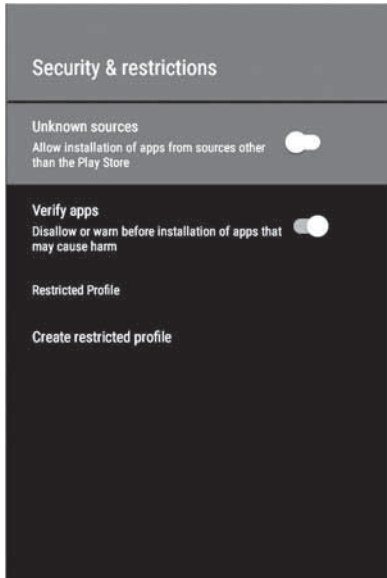
□ Security & restrictions



- Press  to display the home page, use the **Navigation** buttons to highlight Settings and press **Select** to confirm. Then Use the **Navigation** buttons to select Security & restrictions to enter and adjust each option setting.

Unknown sources	Allow installation of apps from sources other than the Google Play Store.
Verify apps	Disallow or warn before installation of apps that may cause harm
Restricted Profile	Keep secret
Create restricted profile	Create keep secret

- NOTE: Other settings also see the actual operation of the TV

PARENTAL CONTROL

Press the **MENU** button on the main unit or press the  on the remote control and then press the **Navigation** buttons to highlight Live TV and press **Select** to confirm (Live TV -> Settings -> Parent Control). Use **Navigation** buttons to select 4-digit password to enter the **LOCK** menu. If used, this option feature can "block" undesirable programming from appearing on the TV. Parental Control offers the user a wide variety of options and settings that restrict or "block" the programming that can appear on the TV. Parental Control allows the user the capability of defining which program rating they consider acceptable to the younger more sensitive viewer. It can be preset and turned either on or off by the user who specifies the secret 4-number code, the password. The number of hours blocked are specified. General audiences and children blocks should be both programmed into the TV's memory. Viewer ratings are specified for both TV and the motion picture Industry; both rating systems should be used, for complete coverage. The ratings are based on the ages of children.

Overview

To ensure complete coverage for all TV programs, (movies and regular TV shows) choose a rating for MPAA, from the selections below, as well as ratings from the TV Parental Guidelines Rating Systems below, using the Age Block option for General Audiences, and for children. In addition to those, you may wish to add additional restrictions from the content block menu, and submenus examples below.

Things to Consider before Setting up Parental Control

Determine which rating you consider acceptable to the viewer. (For example, if you choose TV-PG, more restrictive ratings will be automatically blocked; the viewer will not be able to see: TV-PG, TV-14, or TV-MA rated programming.) Do you want to block the auxiliary video source entirely? (Blocks the signal sent by the equipment, such as VCR, connected to the TV Audio/Video Input Jacks) Or leave unblocked, then choose allowable ratings. Block program "Content" based on individual parameters such as: Strong Dialog, Bad Language, Sex Scenes, Violence Scenes, or Fantasy. Violent Scenes; in Content Blk option. Select a secret password, in the Set Password option, using the numbers keys on the remote control. Do not forget the password, it is the only way you can access the Parental Control menu and change rating selections, or turn Parental Control off. Do you want the Parental Control to be active at all times? If not, you can turn it on or off with the Lock On/Off option.

- You can set different Parental Control viewing restrictions for general audiences and for children, both can be active at the same time.
- Simply specifying one content block such as Sex Scenes, will not automatically restrict the programming that appears from the video sources.
- Even if you choose to leave the AUX Inputs unblocked, the ratings you specify will automatically restrict the programming that appears from the video sources.
- You can not disable Parental Control by disconnecting the TV from power. Block hours will be automatically reset to the original block time setting specified if power is disconnected.

PARENTAL CONTROL

Motion Picture Association of America (MPAA) Rating System

	Grade	Meaning
G	General Audiences	Content not offensive to most viewers.
PG	Parental Guidance Suggested	Content is such that parents may not want their children to view the program.
PG-13	Parents Strongly Cautioned	Program is inappropriate for pre-teens, with a greater degree of offensive material suggested than a PG rated program.
R	Restricted	Not for children under 17, strong element of sex and/or violence.
NC-17	No children under age 17	Not for children under 17 under any circumstances. Strong sexual content.
X	Hard Core Films	Same as NC-17 rating.
No Rating	No Rating	MPAA Not Rated

TV Parental Guideline Rating System

	Grade	Meaning
TV-Y	All Children	Content not offensive to most viewers.
TV-Y7	Directed to Older Children	Considered suitable for children over 7, may contain fantasy violence scenes.
TV-G	General Audience	Considered suitable for all audience; children may watch unattended.
TV-PG	Parental Guidance Suggested	Suggested unsuitable for younger children, may contain suggestive language, bad language, sex and violence scenes.
TV-14	Parents Strongly Cautioned	unsuitable for children under 14, may contain strong language, bad language, sex and violence scenes.
TV-MA	Mature Audience Only	Adults only, may contain strong language, bad language, sex and violence scenes.

- *Canadian English is used throughout all English-speaking Canada (E, C, C8+, G, PG, 14+, 18+).*
- *Canadian French is used in Quebec (E, G, 8 ans+, 13 ans+, 16 ans+, 18 ans+)*
- *The V-Chip will automatically block certain categories that are "more restrictive". If you block TV-Y category, then TV-Y7 will be automatically blocked. Similarly, if you block TV-G category, then all the categories in the "young adult" will be blocked (TV-G, TV-PG, TV-14 and TV-MA).*
- *TV-NO: The channel is not locked.*

TROUBLESHOOTING

If your TV does not operate normally or cannot be turned on, please check the following troubleshooting questions. Remember also to check any other connected electronic device, such as a DVD or Blu-ray player to pinpoint the problem. If the TV still fails to operate normally, please contact technical support.

The TV does not operate properly	
The TV does not respond when pressing any buttons	<ul style="list-style-type: none"> The TV may freeze up during use. Disconnect the power cord from the power socket for a few minutes. Reconnect the power cord and try to operate it again as usual.
TV cannot be switched on	<ul style="list-style-type: none"> Check that the TV is connected to the power supply. Make sure all connected AV devices are switched off before switching on your TV.
The remote control does not work	<ul style="list-style-type: none"> Check to see if there are any objects between the TV and the remote control causing an obstruction. Ensure that you are pointing the remote control directly at the TV. Ensure that the batteries are installed with the correct polarity (+ to +, - to -). Install new batteries.
Power is suddenly turned off	<ul style="list-style-type: none"> Check the power of the TV. The power supply maybe interrupted. Check if the sleep timer is set. Check whether the Auto Standby is activated.
The video function does not work	
No picture & no sound	<ul style="list-style-type: none"> Check whether the TV is switched on. Try another channel. The problem may be caused by the broadcaster.
Picture appears slowly after switching on	<ul style="list-style-type: none"> This is normal; the image is muted during the TV startup process. Please contact your service centre if the picture has not appeared after 5 minutes.
No or poor color or poor picture	<ul style="list-style-type: none"> Adjust the settings in the Picture menu. Try another channel. The problem may be caused by the broadcaster. Check if video cables are connected properly.
Horizontal/Vertical bar or picture shaking	<ul style="list-style-type: none"> Check for local interference such as an electrical appliance or power tool.
Poor reception on some channels	<ul style="list-style-type: none"> The station or cable channel may be experiencing problems; tune to another station. Station signal may be weak, reposition the antenna for better reception. Check for sources of possible interference.
Lines or streaks in pictures	<ul style="list-style-type: none"> Check antenna (change the position of the antenna.)
No pictures when connecting HDMI	<ul style="list-style-type: none"> Check if the input source is HDMI1/HDMI2/HDMI3.
Pictures appear in wrong ratio	<ul style="list-style-type: none"> Adjust the Aspect Ratio settings in the SETUP menu or press the ASPECT button on the remote control.
The audio function does not work	
Picture OK but no sound	<ul style="list-style-type: none"> Press the VOL +/- buttons. Sound muted? Press the MUTE button. Try another channel. The problem may be caused by the broadcaster.
No output from one of the speakers	<ul style="list-style-type: none"> Adjust the Balance settings in the AUDIO menu.
Unusual sound from inside the TV	<ul style="list-style-type: none"> A change in ambient humidity or temperature may result in an unusual noise when the TV is switched on or off and does not indicate a fault with the TV.
No sound when connecting HDMI	<ul style="list-style-type: none"> Check if the input source is HDMI1/HDMI2/HDMI3.
Audio noise	<ul style="list-style-type: none"> Keep the RF coaxial cable away from the other connected cables.

TROUBLESHOOTING

Password	
Lost password	<ul style="list-style-type: none"> Select the SET PASSWORD setting in the LOCK menu, then enter the following master password "8899". The master password clears your previous password and allows you to enter a new password.
There is a problem in PC mode	
The signal is out of range (invalid format)	<ul style="list-style-type: none"> Adjust the resolution, horizontal frequency, or vertical frequency.
Vertical bar or stripe on background & Horizontal Noise & Incorrect position	<ul style="list-style-type: none"> Use Auto configures or adjust clock, phase, or H/V position.
Screen color is unstable or show a single color	<ul style="list-style-type: none"> Check the signal cable. Reinstall the PC video card.
If the WIFI connection fails or APP has connection issue, please check the following troubleshooting questions.	
WIFI connection fails	<ul style="list-style-type: none"> Check signal strength for WIFI connection, the TV may be too far away from WIFI router. Check "authentication" setting. Make sure password is entered with correct upper or lower case letters. Check if TV is connected correctly. Try powering off and unplugging TV to reset TV. Try resetting the WIFI router, and also check for interference or WIFI channel problems.
Problems with video streaming	<ul style="list-style-type: none"> Check if internet connection is fast enough for streaming HD or 4K videos.
Netflix has connection issue	<ul style="list-style-type: none"> Try deactivating Netflix.

Maintaining

- Do not use your TV in areas that are too hot or too cold, because the cabinet may warp or the screen may malfunction. Your TV works best in temperatures that are comfortable to you.
- Storage temperatures are 32° to 122°F(0° to 50°C).
- Working temperatures are 32° to 95°F(0° to 35°C).
- Do not place your TV in direct sunlight or near a heat source.
- Always connect your television to a power outlet with protective ground connection.
- Minimum 5cm distances around the apparatus for sufficient ventilation.
- The ventilation should not be impeded by covering the ventilation openings with items, such as newspapers, table-cloths, curtains, etc.
- No naked flame sources, such as lighted candles, should be placed on the apparatus.
- Attention should be drawn to the environmental aspects of battery disposal.

SPECIFICATION

Panel Size	42.5 inch diagonally
Display Type	LED
Panel Technology	TFT
Panel 60 Hz Vs. 120 Hz	60 Hz
Display Resolution	2160P
HDMI Support	Up to 4K
Panel Resolution	3840 x 2160
Aspect Ratio	16:9
Channel Range	UHF: 14~69
Contrast Ratio-Panel	3200~4000:1
Brightness(Centre Typ.) Cd/M ²	220~270
Response Time (G To G)	8 ms
Lamp Life (Typ. Hours)	>30,000 hours
Horizontal Viewing Angle (At CR≥10)	178
Vertical Viewing Angle (At CR≥10)	178
TV System	ATSC/NTSC
Channel Range	VHF: 2~13
Channel Range	CAVT: 1~135
Tuner Type	Frequency synthesized
Storage Space	16 GB 2 GB memory
Wall-mount(LxW-mm)	400*200 VESA(mm)

The FCC Wants You to Know



FCC STATEMENT

This device complies with Part 15 of the FCC Rules. Operation is subject to the following two conditions:

1. This device may not cause harmful interference, and
2. This device must accept any interference received, including interference that may cause undesired operation. Changes or modifications not expressly approved by the party responsible for compliance could void the user's authority to operate the equipment.

NOTE: This equipment has been tested and found to comply with the limits for a Class B digital device, pursuant to Part 15 of the FCC Rules. These limits are designed to provide reasonable protection against harmful interference in a residential installation. This equipment generates uses and can radiate radio frequency energy and, if not installed and used in accordance with the instructions, may cause harmful interference to radio communications. However, there is no guarantee that interference will not occur in a particular installation. If this equipment does cause harmful interference to radio or television reception, which can be determined by turning the equipment off and on, the user is encouraged to try to correct the interference by one or more of the following measures:

1. Reorient or relocate the receiving antenna.
2. Increase the separation between the equipment and receiver.
3. Connect the equipment into an outlet on a circuit different from that to which the receiver is connected.
4. Consult the dealer or an experienced radio/TV technician for help.

FCC Radiation Exposure Statement

This equipment complies with FCC radiation exposure limits set forth for an uncontrolled environment. This equipment should be installed and operated with minimum distance 20cm between the radiator & your body.

Operations in the 5.15-5.25GHz band are restricted to indoors usage only.
The product integrates a transmitting antenna and does not allow replacement

OBTAINING WARRANTY SERVICE

Please call Westinghouse Electronics at (800) 701-0680 for the locations of the nearest Westinghouse Electronics service center or to obtain in-home services.