

Optoma remote control operating manual

Product Name: Remoter

Model: BT16063

SAFETY

FCC

This device complies with Part 15 of the FCC Rules. Operation is subject to the following two conditions: (1) this device may not cause harmful interference, and (2) this device must accept any interference received, including interference that may cause undesired operation.

changes or modifications not expressly approved by the party responsible for compliance could void the user's authority to operate the equipment.

This device has been tested and found to comply with the limits for a Class B digital device pursuant to Part 15 of the FCC rules. These limits are designed to provide reasonable protection against harmful interference in a residential installation. This device generates, uses and can radiate radio frequency energy and, if not installed and used in accordance with the instructions, may cause harmful interference to radio communications. However, there is no guarantee that interference will not occur in a particular installation. If this device does cause harmful interference to radio or television reception, which can be determined by turning the device off and on is encouraged to try to correct the interference by one or more of the following measures:

- . Reorient or relocate the receiving antenna.
- . Increase the separation between the device and receiver.
- . Connect the device into an outlet on a circuit different from that to which the receiver is connected.
- . Consult the dealer or an experienced radio/television technician for help.

Declaration of Conformity for EU countries

- . EMC Directive 2014/30/EU (including amendments)
- . Low Voltage Directive 2014/35/EU
- . RED Directive 2014/53/EU (if product has RF function)

WEEE

Disposal instructions

Do not throw this electronic device into the trash when discarding. To minimize pollution and ensure utmost protection of the global environment, please recycle it.

INTRODUCTION

IR Remote control

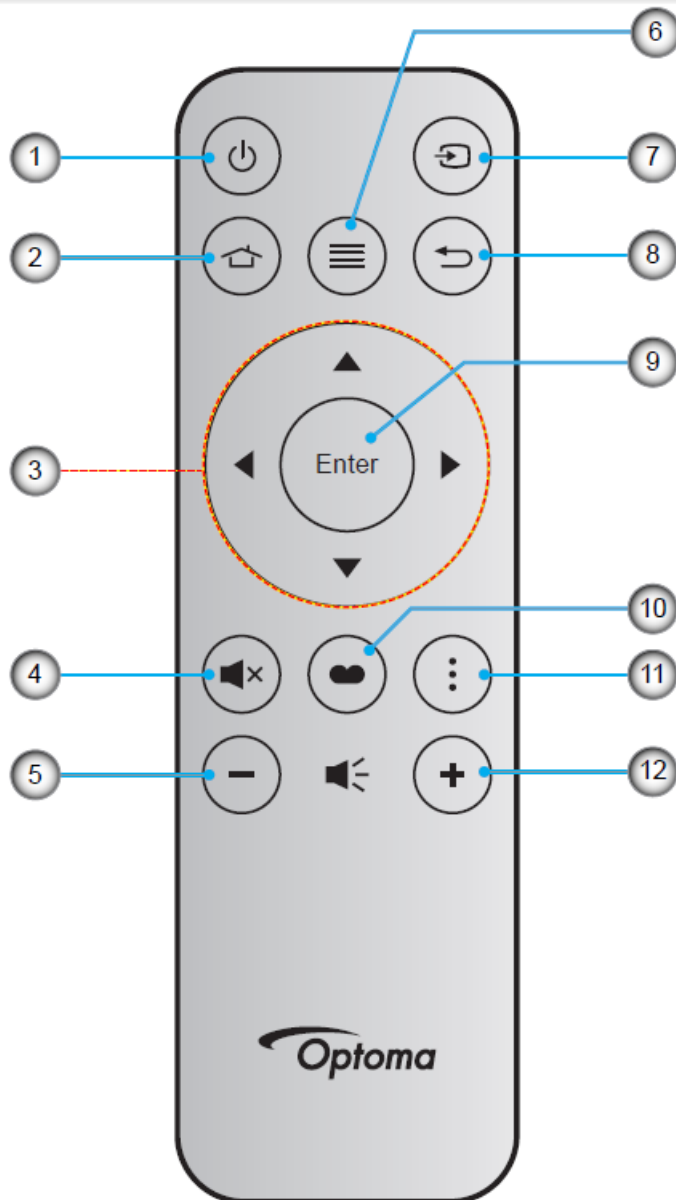

No	Item	No	Item
1.	Power On / Off	7.	Source
2.	Home	8.	Return
3.	Four Directional Select Keys	9.	Enter
4.	Mute	10.	Display Mode
5.	Volume -	11.	Option
6.	Menu	12.	Volume +

INTRODUCTION

BT Remote control

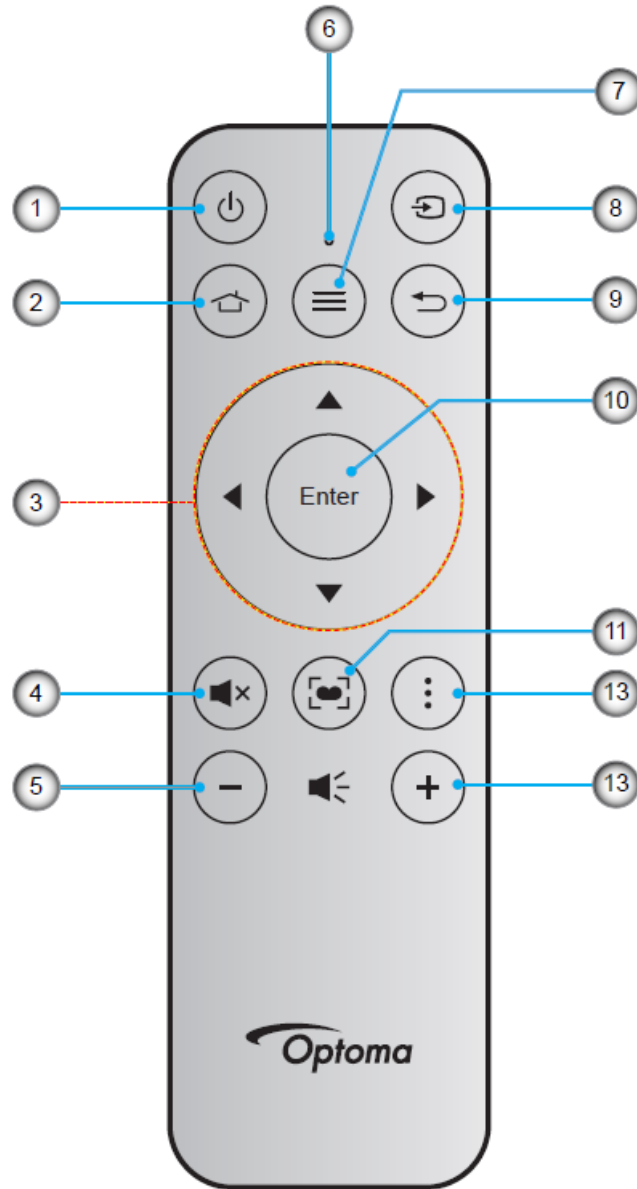

No	Item	No	Item
1.	Power On / Off	8.	Source
2.	Home	9.	Return
3.	Four Directional Select Keys	10.	Enter
4.	Mute	11.	Display Mode
5.	Volume -	12.	Smart TV Source Setting
6.	Status LED	13.	Volume +
7.	Menu		

INTRODUCTION

Pairing your BT remote control with the projector

Press the [HOME] and [BACK] buttons simultaneously for 2 seconds. The status LED on the BT remote control will flash, indicating the device is in pairing mode.

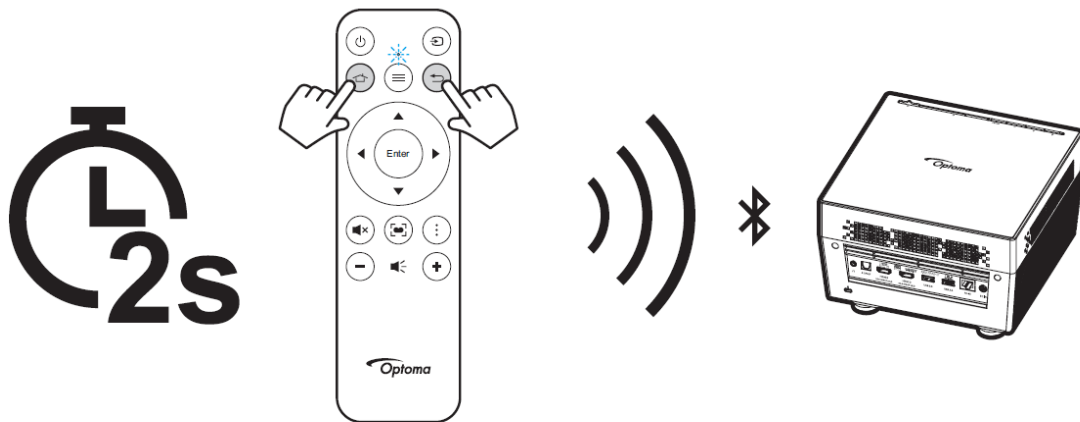

The pairing process will take approximately 20 seconds. If the pairing is successful, the status LED on the BT remote control will turn solid blue. Otherwise, the status LED on the BT remote control will turn solid red. If the BT remote control is left idle for 10 minutes, it will automatically enter Sleep mode and the Bluetooth is disconnected.

Note:

- . The actual remote control may vary depending on the region.
- . Some keys may have no function for models that do not support these features.
- . Before using the remote control for the first time, remove the transparent insulation tape..

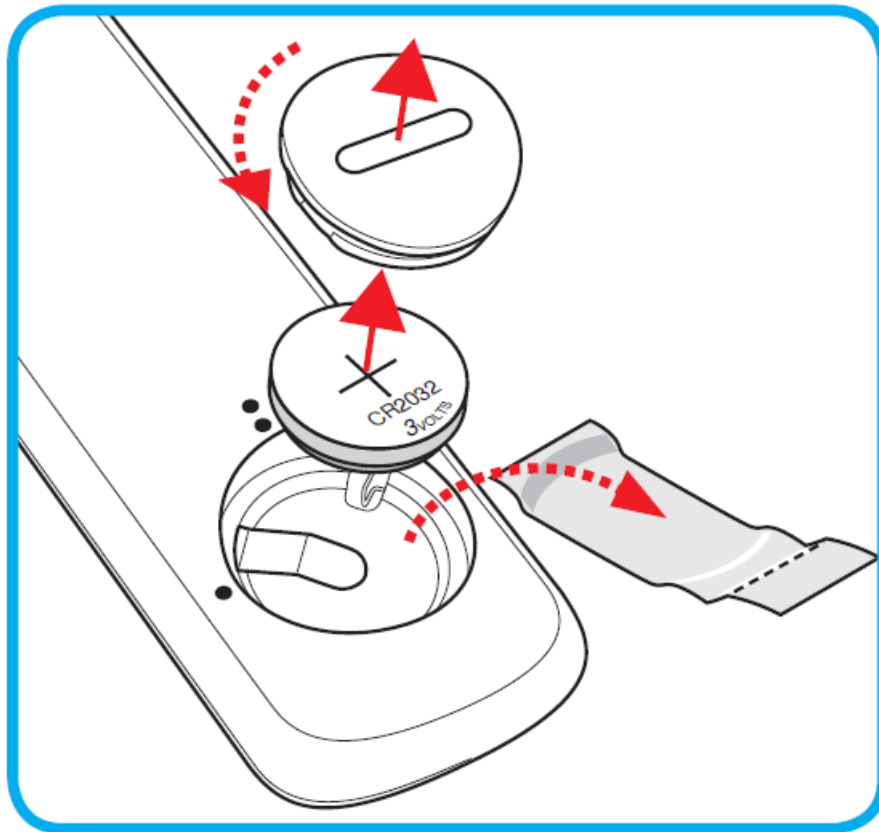

SETUP AND INSTALLATION

Remote setup

Installing / replacing the battery

1. Use a coin to turn the battery cover counterclockwise until the cover opens.
2. Install new battery into the compartment.

Remove the old battery and install new one (CR2032). Ensure that the side with a “+” is facing up.

3. Put the cover back. Then use a coin to turn the battery cover clockwise to lock it in place.

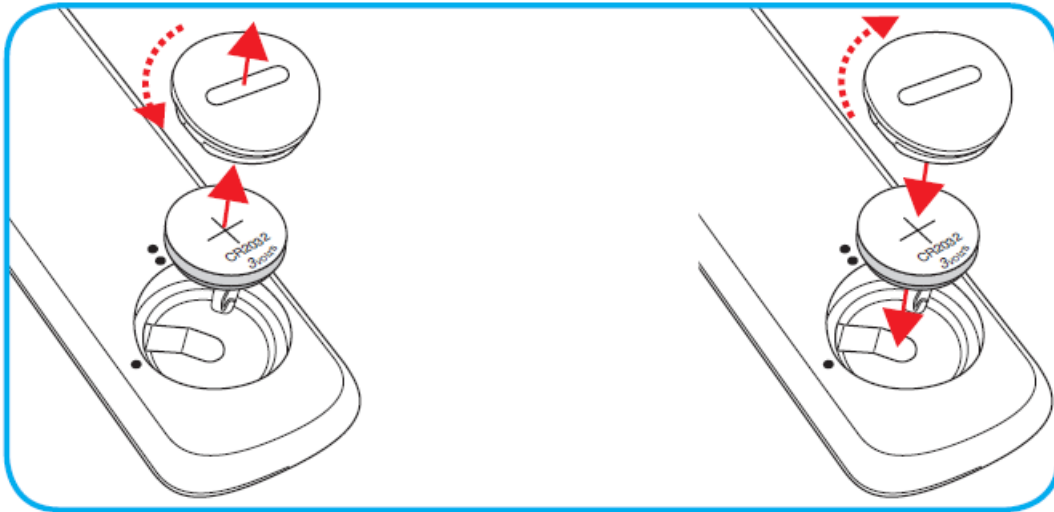

CAUTION:

To ensure safe operation, please observe the following precautions:

- . Use CR2032 type battery.
- . Avoid contact with water or liquid.
- . Do not expose the remote control to moisture or heat.
- . Do not drop the remote control.
- . If the battery has leaked in the remote control, carefully wipe the case clean and install new battery.
- . Risk of an explosion if battery is replaced by an incorrect type.
- . Dispose of used battery according to the instructions.

Effective range

Infra-Red (IR) remote control sensor is located on the rear of the projector. Ensure to hold the remote control at an angle within 30° (horizontally) or 20° (vertically) perpendicular to the projector’s IR remote control sensor to function correctly. The distance between the remote control and the sensor should not be longer than 7 meters (~22 feet).

You can also operate the remote control by pointing it to the projected image.

Note: When pointing the remote control directly (0 degrees angle) on the IR sensor, the distance between the remote control and the sensor should not be longer than 10 meters (~32 feet).

- . Make sure that there are no obstacles between the remote control and the IR sensor on the projector that might obstruct the infra-red beam.
- . Make sure the IR transmitter of the remote control is not being shined by sunlight or fluorescent lamps directly.
- . Please keep the remote controller away from fluorescent lamps for over 2 meters or the remote controller might become malfunction.
- . If the remote control is close to Inverter-Type fluorescent lamps, it might become ineffective from time to time.
- . If the remote control and the projector are within a very short distance, the remote control might become ineffective.
- . When you aim at the screen, the effective distance is less than 7 meters from the remote control to the screen and reflecting the IR beams back to the projector. However, the effective range might change according to screens.

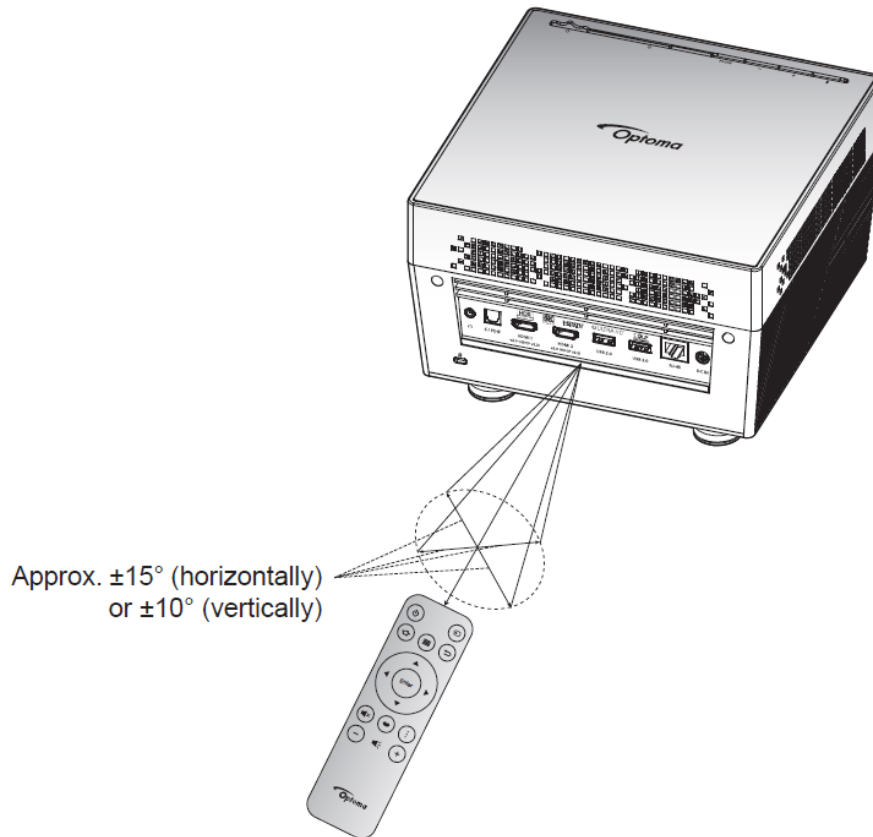

Optoma global offices

For service or support, please contact your local office.

USA

47697 Westinghouse Drive, 888-289-6786
Fremont, CA 94539, USA 510-897-8601
www.optomausa.com services@optoma.com

Canada

47697 Westinghouse Drive, 888-289-6786
Fremont, CA 94539, USA 510-897-8601
www.optomausa.com services@optoma.com

Latin America

47697 Westinghouse Drive, 888-289-6786
Fremont, CA 94539, USA 510-897-8601
www.optomausa.com services@optoma.com

Europe

Unit 1, Network 41, Bourne End Mills,
Hemel Hempstead, Herts,
HP1 2UJ, United Kingdom +44 (0) 1923 691 800
www.optoma.eu +44 (0) 1923 691 888
Service Tel : +44 (0)1923 691865 service@tsc-europe.com

Benelux BV

Randstad 22-123 +31 (0) 36 820 0252
1316 BW Almere +31 (0) 36 548 9052

The Netherlands
www.optoma.nl

France

Batiment E +33 1 41 46 12 20
81-83 avenue Edouard Vaillant +33 1 41 46 94 35
92100 Boulogne Billancourt, France savoptoma@optoma.fr

Spain

C/ José Hierro,36 Of. 1C +34 91 499 06 06
28522 Rivas VaciaMadrid, +34 91 670 08 32
Spain

Deutschland

Wiesenstrasse 21 W +49 (0) 211 506 6670
D40549 Düsseldorf, +49 (0) 211 506 66799
Germany info@optoma.de

Scandinavia

Lerpeveien 25 +47 32 98 89 90
3040 Drammen +47 32 98 89 99
Norway info@optoma.no
PO.BOX 9515
3038 Drammen
Norway

Korea

WOOMI TECH.CO.,LTD. +82+2+34430004
4F, Minu Bldg.33-14, Kangnam-Ku, +82+2+34430005
Seoul,135-815, KOREA
korea.optoma.com

Japan

東京都足立区綾瀬3-25-18
株式会社オーエス info@os-worldwide.com
コンタクトセンター:0120-380-495 www.os-worldwide.com

Taiwan

12F., No.213, Sec. 3, Beixin Rd., +886-2-8911-8600
Xindian Dist., New Taipei City 231, +886-2-8911-6550
Taiwan, R.O.C. services@optoma.com.tw
www.optoma.com.tw asia.optoma.com

Hong Kong

Unit A, 27/F Dragon Centre,
79 Wing Hong Street, +852-2396-8968
Cheung Sha Wan, +852-2370-1222
Kowloon, Hong Kong www.optoma.com.hk

China

5F, No. 1205, Kaixuan Rd., +86-21-62947376
Changning District +86-21-62947375
Shanghai, 200052, China www.optoma.com.cn