

**Spare Parts**

See your local hobby shop or place of purchase first. If unavailable, parts can be ordered direct at [www.ragerc.com](http://www.ragerc.com) or call 1-800-622-7223 M-F 9:00-5:00PM Mountain Time

Item Number	Description
RGR4120	HoverJet VTOL RTF Aircraft
RGR4125	Propeller Set (4); HoverJet
RGR4126	1S 3.7V 530mAh Lipo Battery; HoverJet
RGR4127	4.2V 500mA USB Charger; HoverJet
RGR4128	Transmitter; HoverJet



Look for these other great products from Rage RC at your local hobby retailer or online at [ragerc.com](http://ragerc.com)



RGRB1100 Aqua Dart RTR Boat White/Green  
RGRB1101 Aqua Dart RTR Boat White/Black



RGRA1105 X-Fly VTOL RTF Aircraft



RGR4500 Jetpack Commander RTF Quad-White  
RGR4501 Jetpack Commander RTF Quad-Red



RGR1800 R1BMT Monster Truck RTR

4

**Getting Ready to Fly**

1. Press the On/Off button until the LED flashes.
2. Place the HoverJet on a level surface.
3. Press the On/Off button of transmitter, the LED should flash and the transmitter should beep.
4. Move the throttle all the way up then back to middle position to pair the airplane and transmitter. If pairing is successful, the transmitter will beep 2 times and the LED on both transmitter and airplane stop flashing and remain on. Note: If pairing fails, turn off airplane and transmitter, repeat above steps, or move to another place to avoid electromagnetic interference.

**Flying Your HoverJet**

1. After pairing, press the rates button to switch between high rates (3 beeps) normal rates (2 beeps) and low rates (1 beep). First flights should be in normal or low rates before advancing to high rates.
2. Press the button with the One Button Take-Off symbol . The HoverJet will take off and hover at about 3' above the floor.
3. Move the throttle (left stick) upward and downward to control the ascent or descent, move the steering (right stick) to control the flight direction.
4. Move the throttle (left stick) left or right and the HoverJet will rotate (yaw) left/right accordingly.
5. Press the One Button Take-Off button again or move the throttle stick down gradually to land.
6. When your finished flying, turn off the HoverJet and the transmitter.

Caution: To avoid injury to the pilot or damage to the drone, move the throttle smoothly and not too fast.

**Completing Flips**

1. Press button, the transmitter will beep constantly.
  2. Move the steering (right stick) to perform flips.
    - Front Flip: Move the steering forward (up).
    - Back Flip: Move the steering backward (down).
    - Left Flip: Move the steering left.
    - Right Flip: Move the steering right.
  3. After completing a flip, the HoverJet will exit flip stunt mode. If you want to exit flip stunt mode after pressing the button, push in the throttle control stick.
- Note: \* To avoid hitting people or other objects, please ensure there is enough space before performing flips.

**Replacing Damaged Propellers**

The 4 propellers are not identical. Each propeller is labeled with an A or B. When installing replacement propellers, be certain to install the A/B in the correct location. If needed, use pliers to gently pull the damaged propeller off the shaft.

Warning: To avoid damage to people or aircraft, check propellers for damage before each flight. Also, ensure that the propellers are firmly pressed on to the shaft. Replace any propeller that shows damage and use only the provided propellers or identical replacements. Do not modify the provided propellers.



**Calibrating Your HoverJet**

1. After pairing, put the HoverJet on a level surface. Move the throttle stick down and the steering stick up at the same time and hold them in place, the LED's should then flash on and off for about three seconds.
2. When LED's stop flashing the calibration is complete. The HoverJet should now maintain a steady hover and fly smoothly. If not, the controls need to be adjusted using the trim buttons- see that section for instructions.



**Trimming Your HoverJet**

- Push the throttle forward and observe how the aircraft reacts.
  - Trim forward/backward: If the aircraft tends to drift forward, press until aircraft hovers; if it tends to drift backward, press until aircraft hovers.
  - Trim left/right: If the aircraft tends to drift left, press until aircraft hovers; if it tends to drift right, press until aircraft hovers.
- Note: The transmitter beeps when you press a trim control but stops beeping when you reach maximum trim adjustment.

**Warnings**

- Do not dispose of the Li-Po battery into a fire.
- Never place the product on a hot surface.
- Keep the product in dry and cool environment.
- Use only provided USB cable for charging.
- Charge the battery per the manual instructions.
- Do not use type of sharp object to insert the Li-Po battery to avoid puncture.
- Charge the Li-Po battery every 6 months if not in regular use.
- Turn off the power when the product is not in use.



2

# HOVERJET<sup>VTOL</sup>

## INSTRUCTION MANUAL

Please read before use and retain for reference



**Safety Warning**

- To ensure safety, parents should read this User's Manual with children before use.
- To avoid injury, do not touch the product while flying or while the propellers are spinning.
- Be careful to keep your body and loose clothing away from the propellers and motors.

Do not modify or change this product without authorization.

**Install batteries in the transmitter**

1. Use a screwdriver to open the battery compartment
2. Insert three AAA batteries, matching the polarities marked inside
3. Use a screwdriver to close the battery compartment.



**Charge the Li-Po battery:**

1. Connect the included USB charging cable to the 3.7V 530mAh Li-Po battery and a USB power source, such as a laptop. The USB connector indicator red LED remains lit when charging and turns off once battery is full charged. Charging time is about 60 minutes.
2. Disconnect the USB charging cable when fully charged, do not attempt to over charge.

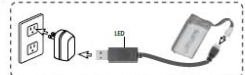

**Caution:**

- Use only the included charging cable to charge the flight battery, other cable may damage the airplane
- Let the Li-Po battery flight battery cool down before re-charging.

**Install the flight battery**

1. Open the battery compartment and pull out the battery.
2. Insert the plug and install battery inside.
3. Close battery compartment.

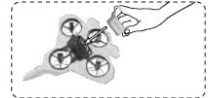

**Transmitter operation:**



## Warranty

Warranty Period: Rage R/C warrants that the Hover Jet ("Product") will be free from original factory defects in materials and workmanship upon purchase ("Warranty Period"). What is Not Covered - This warranty is not transferable and does not cover (a) cosmetic damage, (b) damage due to acts of God, accident, misuse, abuse, negligence, commercial use, or due to improper use, installation, operation or maintenance, (c) modification to any part of the Product, (d) attempted service by anyone other than a Rage R/C authorized service center, or (e) Product not purchased from an authorized Rage R/C dealer.

OTHER THAN THE EXPRESS WARRANTY ABOVE, RAGE R/C MAKES NO OTHER WARRANTY OR REPRESENTATION, AND THEREFORE DISCLAIMS ANY AND ALL IMPLIED WARRANTIES, INCLUDING, WITHOUT LIMITATION, THE IMPLIED WARRANTIES OF NON-INFRINGEMENT, MERCHANTABILITY AND SUITABILITY FOR A PARTICULAR PURPOSE. THE PURCHASER ACKNOWLEDGES THAT THEY ALONE HAVE DETERMINED THAT THE PRODUCT WILL MEET THE REQUIREMENTS OF THEIR INTENDED USE.

Purchaser's Remedy - Rage R/C's sole obligation and purchaser's sole and exclusive remedy shall be that Rage R/C will, at its option, either (a) service, or (b) replace, any Product determined by Rage R/C to be defective. Rage R/C reserves the right to inspect any and all Product(s) involved in a warranty claim. Service or replacement decisions are at the sole discretion of Rage R/C. Proof of Purchase is required for all warranty claims. SERVICE OR REPLACEMENT AS PROVIDED UNDER THIS WARRANTY IS THE PURCHASER'S SOLE AND EXCLUSIVE REMEDY.

Limitation of Liability - RAGE R/C SHALL NOT BE LIABLE FOR SPECIAL, INDIRECT, INCIDENTAL OR CONSEQUENTIAL DAMAGES, LOSS OF PROFITS OR PRODUCTION OR COMMERCIAL LOSS IN ANY WAY, REGARDLESS OF WHETHER SUCH CLAIM IS BASED IN CONTRACT, WARRANTY, TORT, NEGLIGENCE, STRICT LIABILITY OR ANY OTHER THEORY OF LIABILITY, EVEN IF RAGE R/C HAS BEEN ADVISED OF THE POSSIBILITY OF SUCH DAMAGES.

Further, in no event shall the liability of Rage R/C exceed the individual price of the Product on which liability is asserted. As Rage R/C has no control over use, setup, final assembly, modification or misuse, no liability shall be assumed nor accepted for any resulting damage or injury. By the act of use, setup or assembly, the user accepts all resulting liability. If you, as the purchaser or user, are not prepared to accept the liability associated with the use of the Product, purchaser is advised to return the Product immediately in new and unused condition to the place of purchase.

Law - These terms are governed by Utah law (without regard to conflict of law principals). This warranty gives you specific legal rights, and you may also have other rights which vary from state to state. Rage R/C reserves the right to change or modify this warranty at any time without notice.

Rage R/C, an exclusive brand of:  
HRP Distributing, Inc.  
2034 South 3850 West  
Salt Lake City, Utah 84104

© HRP Distributing Inc.  
Printed in China

3

## FCC STATEMENT

1. This device complies with Part 15 of the FCC Rules. Operation is subject to the following two conditions:

- (1) This device may not cause harmful interference, and
- (2) This device must accept any interference received, including interference that may cause undesired operation.

2. Changes or modifications not expressly approved by the party responsible for compliance could void the user's authority to operate the equipment.

This equipment has been tested and found to comply with the limits for a Class B digital device, pursuant to part 15 of the FCC Rules. These limits are designed to provide reasonable protection against harmful interference in a residential installation. This equipment generates, uses and can radiate radio frequency energy and, if not installed and used in accordance with the instructions, may cause harmful interference to radio communications. However, there is no guarantee that interference will not occur in a particular installation. If this equipment does cause harmful interference to radio or television reception, which can be determined by turning the equipment off and on, the user is encouraged to try to correct the interference by one or more of the following measures:

- Reorient or relocate the receiving antenna.
- Increase the separation between the equipment and receiver.
- Connect the equipment into an outlet on a circuit different from that to which the receiver is connected.
- Consult the dealer or an experienced radio/ TV technician for help.