

Aircraft

Product Name: Mantis Q

Model Name: YUNMQA

- 01 Propellers
- 02 Motors
- 03 Power Button
- 04 Battery
- 05 Battery Locking Button
- 06 Camera
- 07 Camera Micro SD Card Slot
- 08 Type-C Port
- 09 LED Status Indicators
- 10 Downward Sonar
- 11 Downward Optical Flow Module

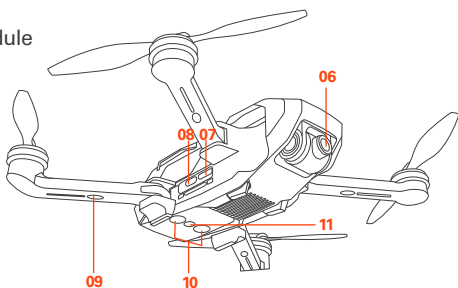
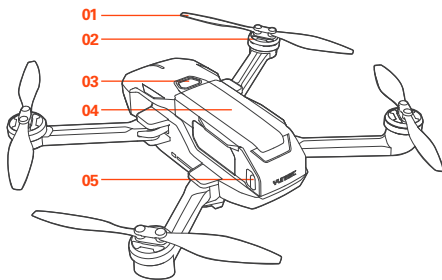

Controller

Product Name: Mantis Q Remote Controller

Model Name: YUNMQRC

- 01 Phone Holder
- 02 Antennas
- 03 Control Sticks
- 04 WiFi Status LEDs
- 05 Sport Switch
- 06 Power Button
- 07 Battery Level LEDs
- 08 RTH Button
- 09 Custom Dial
- 10 Photo Button
- 11 Micro USB Port
- 12 Standard USB Port
- 13 Video Recording Button
- 14 Camera Control

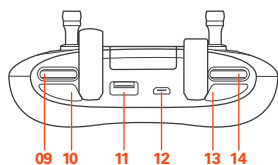
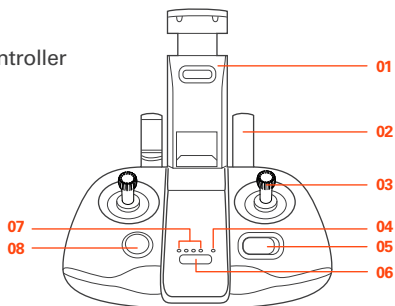

Before Flight

- Download Yuneec Pilot App in the App Store or Google Play, or scan the QR code to install the app on your smart device.
- Scan the below QR code to download the tutorial videos and learn more instructions.

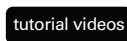

- It is recommend that first-time pilot to activate Angle Mode. After getting used to the flight characteristics of the V18S, and try the different mode flight experience.

Preparing the Aircraft

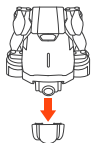

1.Remove the camera protector

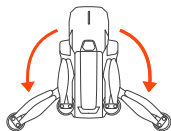

2.Unfold the rear arms

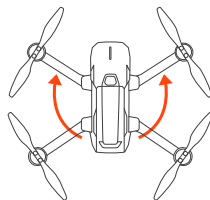

3.Unfold the front armst

NOTICE

- All arms and propellers must be unfolded before powering on the aircraft.
- Folding in reverse order.

Charging the Flight Battery

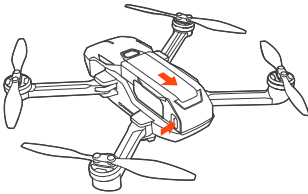

- Press the battery locking button and remove the battery

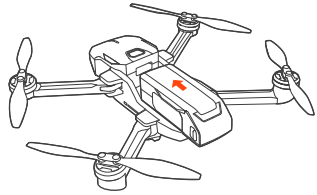

- Push the flight battery into the aircraft until hearing a 'click'

- Plug the flight battery to the supplied charger as shown below.
Flight battery charging time: 1.5 hour

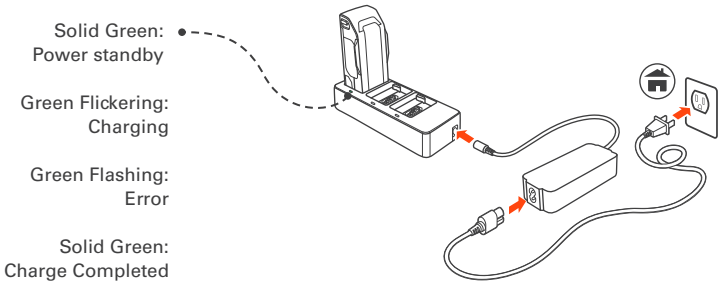

Charging the Remote Controller

Charging the remote controller using Micro USB.

Remote controller Charging time: 1 hour

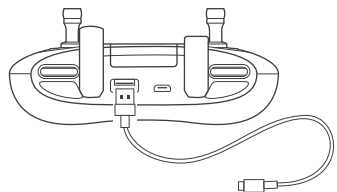

Installing the Smart Device

- Pull out the smart phone holder from the remote controller.
- Put the smart phone on the holder.
- Plug one end of the connecting cable to the standard USB port in the remote controller, and the other end to the data port of your smart phone.

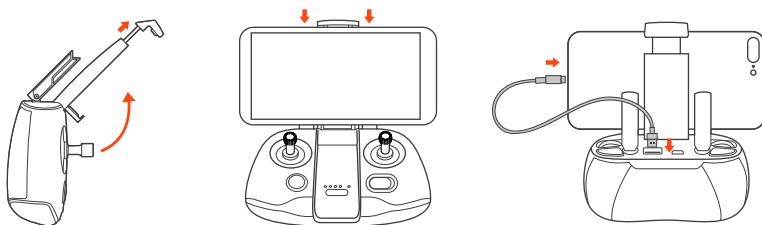

Power On/Off

Press the power button show as below and hold for two seconds to power on/off.

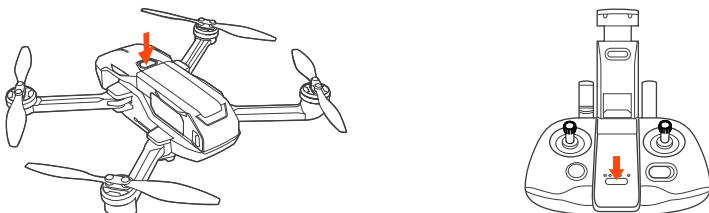

Takeoff / Landing

Option 1

Tap the icon as below and slide on the App to take off / landing.



Auto take off



Auto landing

Option 2

• Move the sticks as shown below to start the motors.

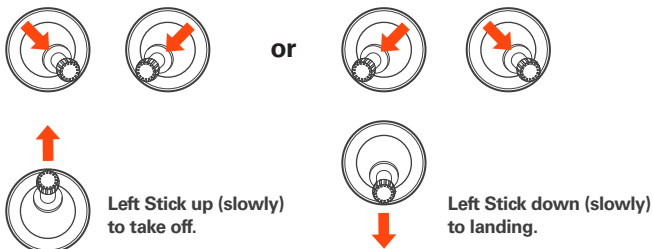

Direction Control

When the aircraft lifts off the ground surface, move the sticks slightly on the remote controller as described below to explore the different movements of the Mantis Q. The default flight control is known as Mode 2.

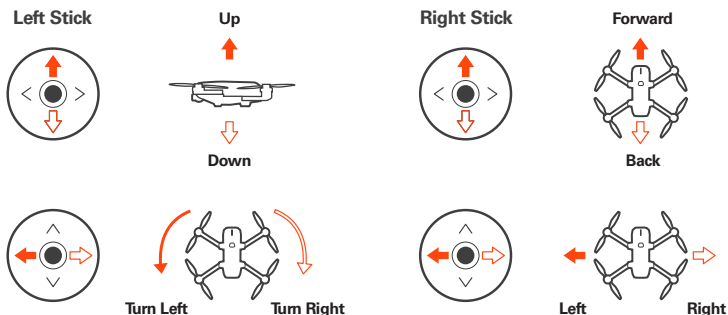

Flight Modes

Angle Mode

When in Angle Mode and GPS is available, the aircraft will respond according to the remote controller.

Sport Mode

The aircraft has high reaction sensitivity in sport mode. The maximum flight speed of the aircraft is increased to 33.55mph (54km/h).

RTL Mode

When in RTL Mode, the aircraft will return to the home point and automatically land.

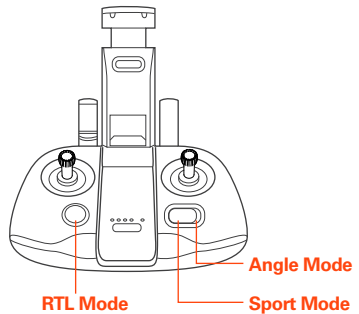

Voice Control

The Voice Control function allows the aircraft to execute a series of simple maneuvers.

One-Tap Movie

One-Tap Movie function enables the pilot to record an automatically generated 15-seconds video by selecting one shooting mode in the App.

Instant Social Sharing

The Instant Social Sharing function allows the pilot to capture the 4K HD video and simultaneously share it to the social media.