



# Installation and Use Instructions

# Philips Motion Effect Lights

Table of Contents **Page**

- IMPORTANT SAFETY INSTRUCTIONS..... 3
- Downloading App..... 4
- Getting Started..... 5
- Assembling Light String ..... 5
- Connecting to Philips Motion Effects App..... 1
- Controlling a Single Light String ..... 1
- Creating a new Group ..... 5
- Controlling Grouped Light Strings ..... 5
- Using Philips Motion Effects lights ..... 6
  - Function Screen ..... 6
  - Music Screen..... 7
  - Microphone Screen..... 8
- Setting Timer ..... 9
- Troubleshooting ..... 11

# IMPORTANT SAFETY INSTRUCTIONS

When using electrical products, basic precautions should always be followed including the following:

- a) **READ AND FOLLOW ALL SAFETY INSTRUCTIONS.**
- b) Do not use seasonal products outdoors unless marked suitable for indoor and outdoor use. When products are used in outdoor applications, connect the product to a Ground Fault Circuit Interrupting (GFCI) outlet. If one is not provided, contact a qualified electrician for proper installation.
- c) This seasonal use product is not intended for permanent installation or use.
- d) Do not mount or place near gas or electric heaters, fireplaces, candles or other similar sources of heat.
- e) Do not secure the wiring of the product with staples or nails, or place on sharp hooks or nails.
- f) Do not let lamps rest on the supply cord or on any wire.
- g) Unplug the product when leaving the house, when retiring for the night, or if left unattended.
- h) This is an electric product-not a toy! To avoid risk of fire, burns, personal injury and electric shock it should not be played with or placed where small children can reach it.
- i) Do not use this product for other than its intended use.
- j) Do not hang ornaments or other objects from cord, wire, or light string.
- k) Do not close doors or windows on the product or extension cords as this may damage the wire insulation.
- l) Do not cover the product with cloth, paper or any material not part of the product when in use.
- m) This product is equipped with non-replaceable type lamps. Do not attempt to replace the lamps.
- n) Use only with the Class 2 adaptor provided with this product.
- o) Read and follow all instructions that are on the product or provided with the product.

p) **SAVE THESE INSTRUCTIONS**

---

## **WARNING:** Risk of Fire, shock, or personal injury.

- 1) Use only with the included Class 2 adaptor.
- 2) Not for use on outlets controlled by a dimmer.
- 3) Use only on timer controlled outlets where the timer is rated for use with compact fluorescent bulbs (CFL) or LED bulbs.
- 4) Do not attempt to replace bulbs, they are not replaceable.
- 5) Do not use power adaptor if enclosure is broken or cracked, discard unit.
- 6) Do not use with a voltage converter.
- 7) The product and the adaptor shall not be installed within 10 feet of a pool, spa, fountain, or other areas of standing water.

### **Use and Care Instructions**

- a) Before using or reusing, inspect product carefully. Discard any products that have cut, damaged, or frayed wire insulation or cords, cracks in the lampholders or enclosures, loose connections, or exposed copper wire.
- b) When storing the product, carefully remove the product from wherever it is placed, including trees, branches, or bushes, to avoid any undue strain or stress on the product conductors, connections and wires.
- c) When not used, store neatly in a cool, dry location protected from sunlight.
- d) Do not impact or drop the adaptor, if enclosure is broken or cracked, discard product.

### **FCC Notice:**

This device complies with Part 15 of the FCC Rules. Operation is subject to the following two conditions:

- (1) This device may not cause harmful interference, and
- (2) This device must accept any interference received, including interference that may cause undesired

Any Changes or modifications not expressly approved by the party responsible for compliance could void the user's authority to operate the equipment.

NOTE: This equipment has been tested and found to comply with the limits for a Class B digital device, pursuant to part 15 of the FCC Rules. These limits are designed to provide reasonable protection against harmful interference in a residential installation. This equipment generates, uses and can radiate radio frequency energy and, if not installed and used in accordance with the instructions, may cause harmful interference to radio communications. However, there is no guarantee that interference will not occur in a particular installation. If this equipment does cause harmful interference to radio or television reception, which can be determined by turning the equipment off and on, the user is encouraged to try to correct the interference by one or more of the following measures:

- Reorient or relocate the receiving antenna.
- Increase the separation between the equipment and receiver.
- Connect the equipment into an outlet on a circuit different from that to which the receiver is connected.
- Consult the dealer or an experienced radio/TV technician for help.

**RF exposure warning**

This equipment must be installed and operated in accordance with provided instructions and the antenna(s) used for this transmitter must be installed to provide a separation distance of at least 20 cm from all persons and must not be co-located or operating in conjunction with any other antenna or transmitter. End-users and installers must be provide with antenna installation instructions and transmitter operating conditions for satisfying RF exposure compliance.

## Downloading App

Download the Philips Motion Effects lights app from the iTunes App Store or Google Play by searching for “Philips Motion Effects Lights”, or scan the appropriate QR code below.

**App Icon:**



This app only works on devices that are running Bluetooth 4.0 or higher and Android 4.3 or higher for Android devices. For iOS devices, it should be running iOS 9.0 or higher, it will work if you are using an iPhone 5S, 6, 6C, 6S, 7 or newer, or an iPad3, iPad air or newer device. Please note that this product will not work on windows based devices.

## Getting Started

- 1) Read and follow all enclosed Safety instructions and cord tags before starting.
- 2) Follow the instructions below on how to install Philips Motion Effects App and control light set.

## Assembling Light String

- 1) Carefully remove product and adaptor from packaging, be sure not to cut any wires.
- 2) Decorate your home with Philips Motion Effects Lights.

## Connecting to Philips Motion Effects App

The lights are controlled by using the Philips Motion Effects App on your iOS or Android smart device. To download the free app, use the QR code located on the top of this Instruction Manual, Philips Quick Start Guide, or search for “Philips Motion Effects” on the iTunes App Store or Google Play Store.

- 1) Plug the power adaptor into a 110-125V wall outlet.
- 2) Open Philips Motion Effects app. The app will ask to enable Bluetooth if not already enabled. Then app will automatically search for any available Philips Motion Effect Light strings.
- 3) All available Philips Motion Effect Light strings will be displayed on the App’s home screen. (See Figure 1)
- 4) Tap “Add Device” to pair new light string to app.



Figure 1

## Controlling a Single Light String

- 1) Tap displayed devices to connect to or add to a group to control multiple light strings. (see Figure 2)

*Note: You can long press on connected device to change device name.*

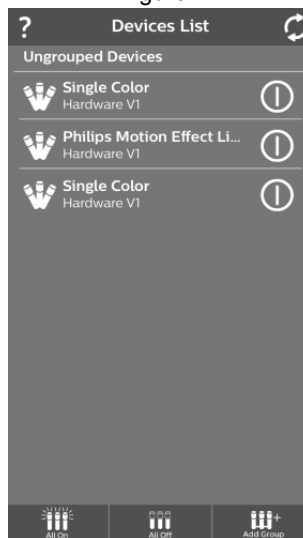

Figure 2

## Creating a new Group

- 1) To create a new group, tap “Add Group” tab in the lower right hand corner.
- 2) Enter desired name of group. The group name can be renamed by long pressing on group.
- 3) Long press on connected light strings to add to group.

*Note: If multiple groups are created, each connected light string can only be grouped to one group.*

## Controlling Grouped Light Strings

- 1) After desired light strings are grouped together. Tap selected Group to control all grouped lights.
  - a. *Note: You can tap “On/Off” button next to group name to quickly turn grouped light strings on or off.*
- 2) Long press on group to rename group.

## Using Philips Motion Effects lights

This section details each main screen of the Philips Motion Effects App.

- Note: Philips Motion Effects lights will remember your last command when you:
  - Turn them off by unplugging them or turn off power to the outlet controlling them (if turned off in the app and unplugged, the next time the lights are plugged in, they will turn on in steady on mode, this is normal).
  - Or you turn off the lights with your smart device.

## Function Screen

From this function screen, you can choose from 16 included effects.

*Note: only some functions have the ability to adjust the brightness*

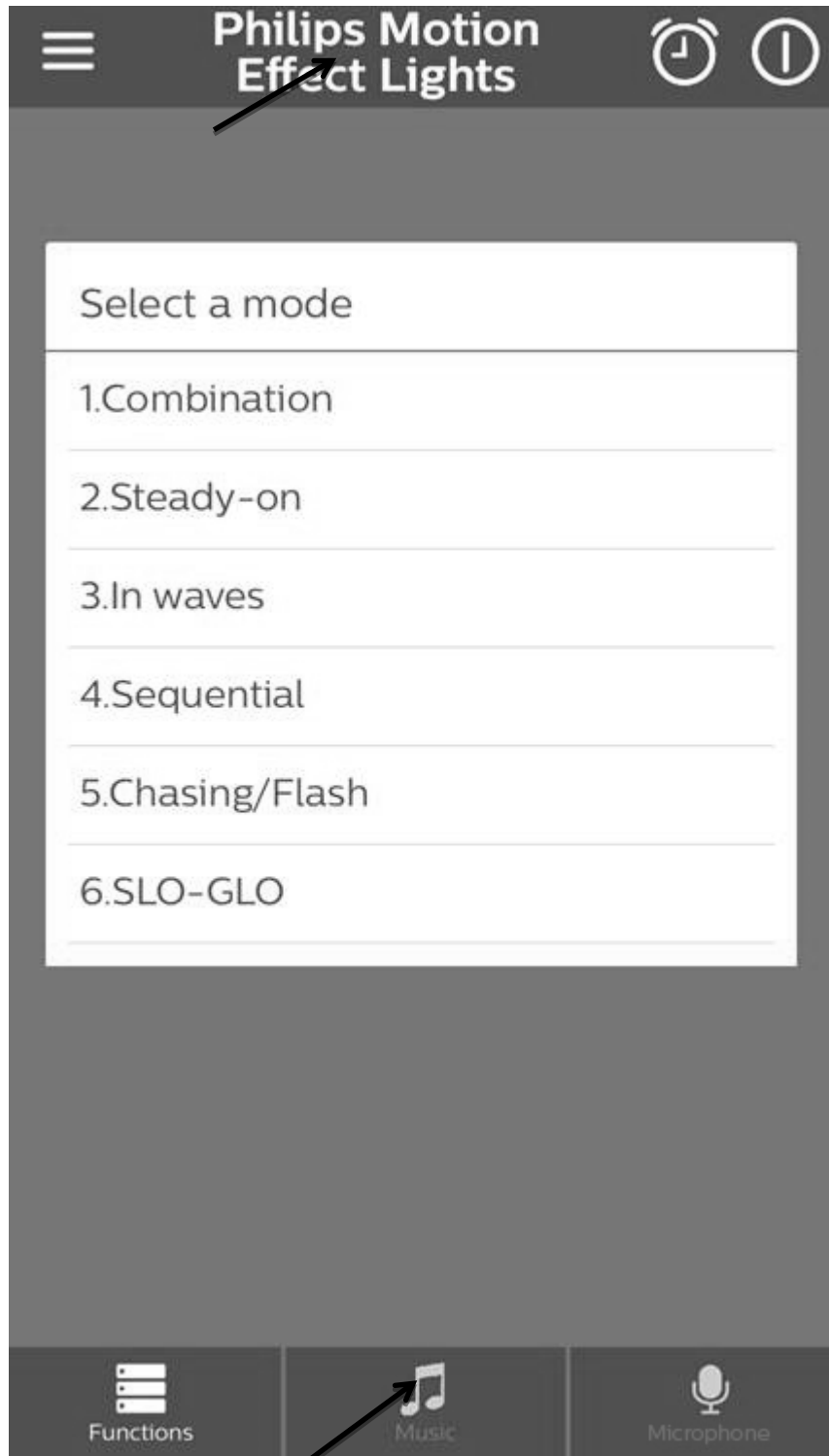

**On/Off:** Turn selected light string on and

**Timer:** Enable/Disable light string (see below)

**Light Functions:**

- 1) Combination
- 2) Steady-on\*
- 3) In waves
- 4) Sequential\*
- 5) Chasing/Flash\*
- 6) Slo-Glo
- 7) Step on
- 8) Slow fade
- 9) One light chasing\*
- 10) Triple in wave
- 11) Mixed chasing
- 12) Forward on/Reverse off\*
- 13) Twinkle/Flash\*
- 14) Four light flash\*
- 15) Twin light flash\*
- 16) Step on/Slow Fade

\* You are able adjust the brightness on these functions.

**Function List:** Tap a function to select it, hold and drag up or down to see and select all 16 functions.

**Mode Selection:** Tap a tab above to select it. (Note: selected mode will be highlighted)

**Music Screen**

Philips Motion Effects will create a light show that flashes lights to your own music on your device.

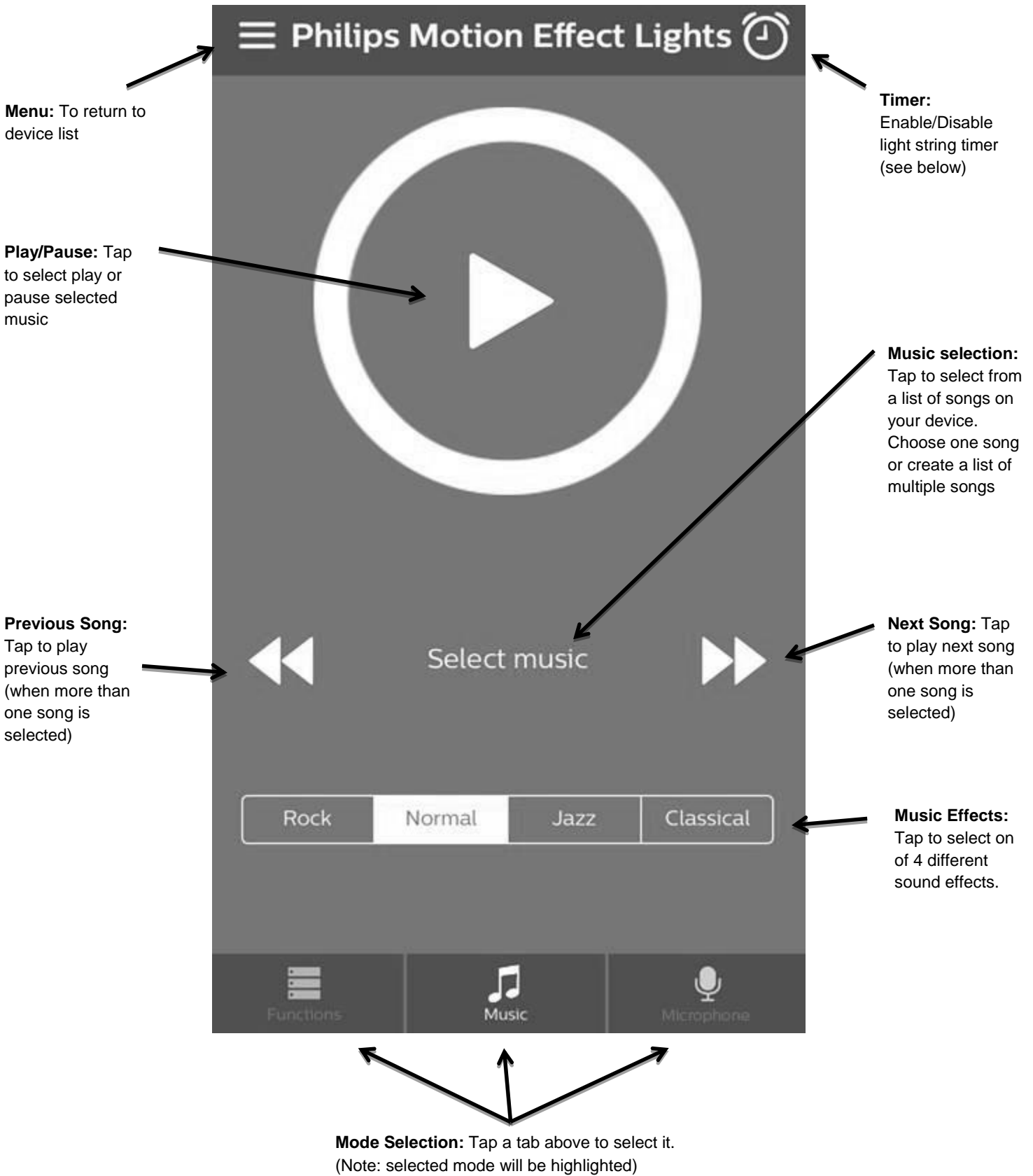

## Microphone Screen

Philips Motion Effects Lights will react to any sounds being made while microphone icon is active.



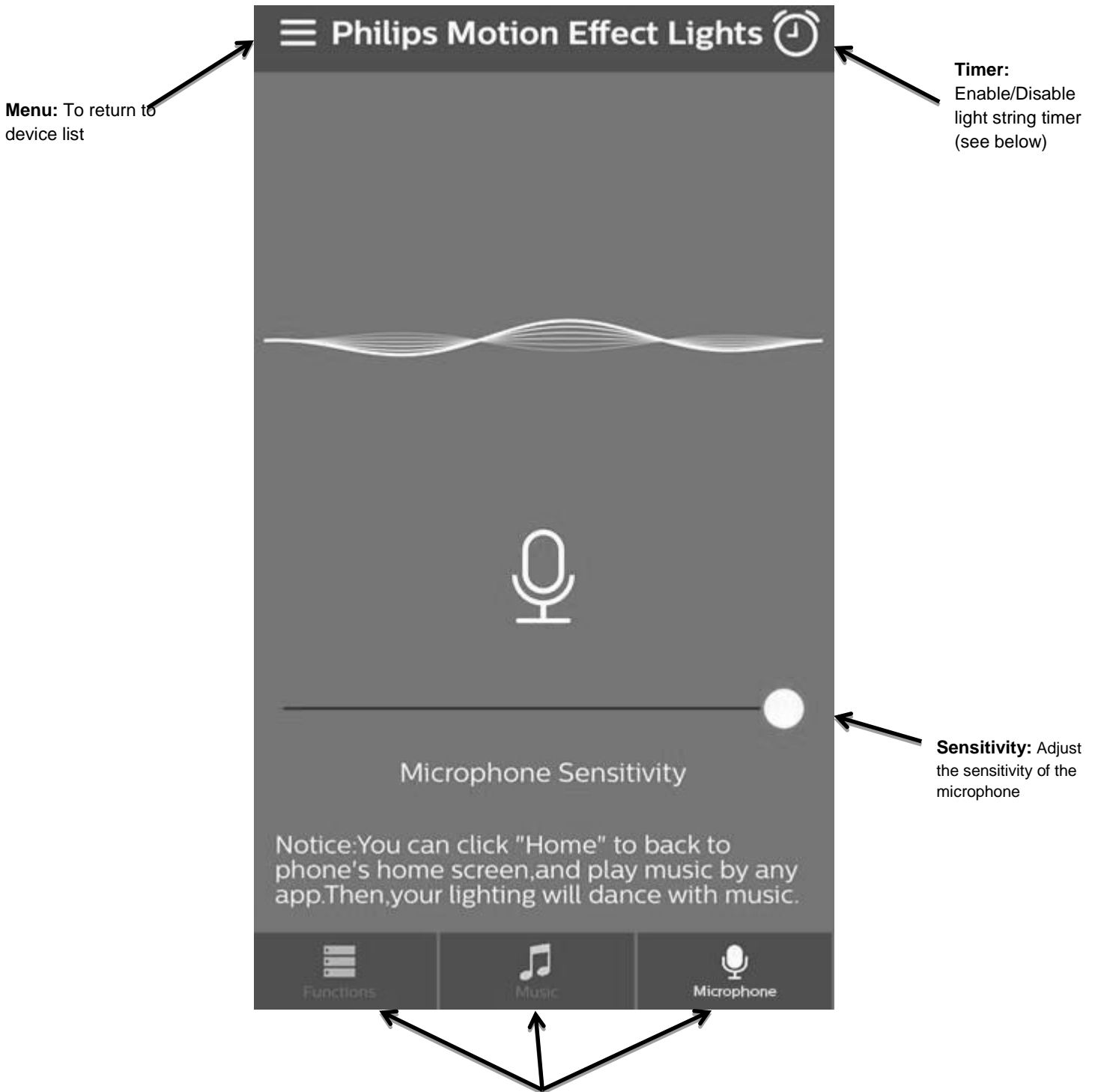

**Menu:** To return to device list

**Timer:** Enable/Disable light string timer (see below)

**Sensitivity:** Adjust the sensitivity of the microphone

**Mode Selection:** Tap a tab above to select it.  
(Note: selected mode will be highlighted)

**Tip:** Use this mode to pick up music in the room from other sources such as a stereo or the smart device speakers, and use it to change the lights to music from streaming music sources when playing through your smart device speakers or from a Bluetooth speaker located near your smart device. Smart device speaker will still function if app is closed.

## Setting Timer

This item includes a timer to automatically turn on and off the light string. Use the steps listed below to enable, disable or edit timers.



- 1) Tap the Clock icon in the upper right hand corner of app.
- 2) Timer screen will appear (see figure 3). The current time and date will be displayed.
- 3) To add a new timer function tap “Add Timer” button.
- 4) Edit timer screen will appear (see Figure 4).
- 5) Set time, day to repeat set timer and whether the timer is to turn on the lights or to turn off the lights by tapping on  
*Note: Separate timers need to be set for both the On and Off functions.*
- 6) When timer is created, it will be listed on the Timer Screen (see Figure 5).



**Note:** If power is removed from the light string after programming timer, all timer settings will be lost. To maintain the timer settings, do not remove the light string from power (it requires a constant connection to 110V-125V power). Please use the on/off function in the app instead to maintain the timer settings.

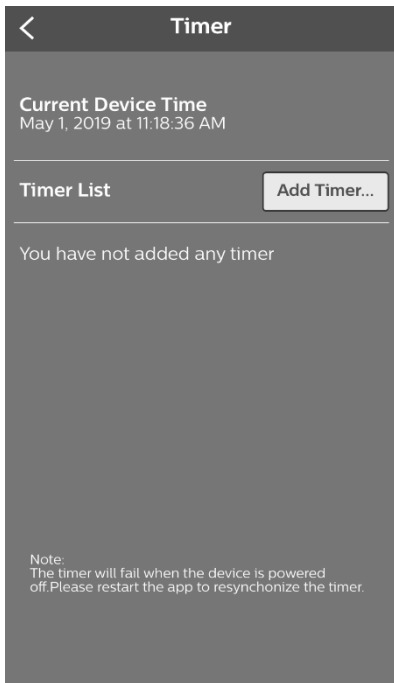

Figure 3

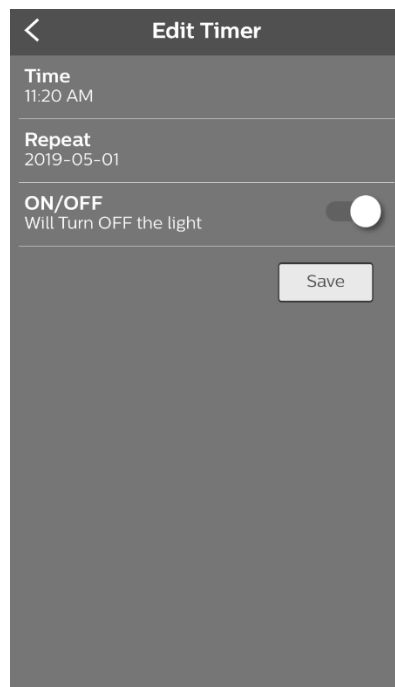

Figure 4

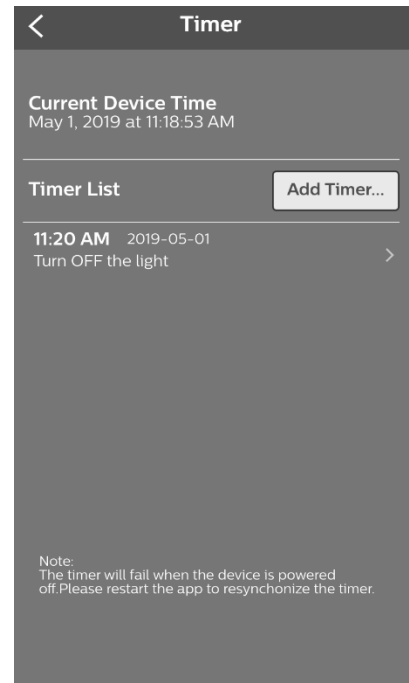

Figure 5

# Troubleshooting

## If lights do not work:

- 1) Make sure lights are connected to the adaptor.
- 2) Make sure the adaptor is plugged into a 110V-125V AC outlet.
- 3) Make sure the outlet has power (check to see if any switches or timers control the outlet), and is not connected to a dimmer switch.
- 4) If used on a timer controlled outlet, make sure timer is rated for use with compact fluorescent bulbs (CFL bulbs) or LED bulbs. If not, use on a different circuit/outlet.
- 5) When used on a GFCI controlled outlet, reset the GFCI outlet in case it is activated.
- 6) Open app and toggle On/Off button within the app.
- 7) Disconnect lights and adaptor from the 110-125V power source for 2 minutes and plug back in.

## If app stops working:

- 1) Restart app by closing and reopening app.

## If App cannot connect to light string(s):

- 1) Make sure your Bluetooth is active/turned on, on your device. App will automatically ask to enable Bluetooth on your device when you open App.
- 2) Make sure your device is running Bluetooth 4.0 or higher. App will not connect to light string if the device does not have Bluetooth 4.0 or higher. If your device does not have Bluetooth 4.0 or higher, please use a different device.
- 3) Make sure your Apple or Android operating system is running iOS 9.0 or Android 4.3 or higher. App will not work if your devices operating system is lower than iOS 9.0 or Android 4.3.

## If asked to enter PIN while connecting to light string:

- 1) Philips Motion Effect Lights do not require a PIN to connect. If you are being asked for a PIN then do not connect to this device with the Philips Motion Effect Lights app.

## For additional troubleshooting and user information:

- 1) Within the app please select the  icon in the upper left hand corner of the devices list screen.

## If timer settings do not work correctly:

- 1) Power may have been removed from light string. Connect to light string and re-enable timer setting by following the steps shown on previous page.
- 2) If power is removed from light string all timer setting will be lost.

Call Customer Service at 1-800-763-6177 Monday-Friday 9:00am – 5:00pm CST or visit our website at [www.seasonalspecialties.com](http://www.seasonalspecialties.com)

## FCC Information

**Note:** This equipment has been tested and found to comply with the limits for a Class B digital device, pursuant to part 15 of the FCC Rules. These limits are designed to provide reasonable protection against harmful interference in a residential installation. This equipment generates, uses and can radiate radio frequency energy and, if not installed and used in accordance with the instructions, may cause harmful interference to radio communications. However, there is no guarantee that interference will not occur in a particular installation. If this equipment does cause harmful interference to radio or television reception, which can be determined by turning the equipment off and on, the user is encouraged to try to correct the interference by one or more of the following measures:

--Reorient or relocate the receiving antenna.

--Increase the separation between the equipment and receiver.

--Connect the equipment into an outlet on a circuit different from that to which the receiver is connected.

--Consult the dealer or an experienced radio/TV technician for help.

**Caution:** Changes or modifications not expressly approved by the party responsible for compliance could void the user's authority to operate the equipment.

Seasonal Specialties, LLC, 11455 Valley View Rd, Eden Prairie, MN 55344, 1-800-763-6177



The Philips trademark and the Philips Shield Emblem are registered trademarks of Koninklijke Philips N.V. used under license.

This product has been manufactured by and is sold under the responsibility of Seasonal Specialties LLC, and Seasonal Specialties LLC is the warrantor in relation to this product.