

Bowers & Wilkins

# P5 Wireless Headphones

## Welcome to Bowers & Wilkins and the MH-W Wireless Headphones

Thank you for choosing Bowers & Wilkins. When John Bowers first established our company he did so in the belief that imaginative design, innovative engineering and advanced technology were keys that could unlock the enjoyment of audio in the home. His belief is one that we continue to share and it inspires every product we design.

MH-W is a high performance on-ear headphone that provides the highest quality personal audio experience combined with the convenience of wireless operation based on the latest Bluetooth audio standards. This manual will tell you everything you need to know to get the most from your MH-W Headphones.

MH-W headphones can be used either wirelessly, to play music streamed from your mobile phone, tablet or computer using Bluetooth wireless technology, or conventionally in “passive” mode connected by a cable to a suitable headphone output. The MH-W can also be used for wireless telephony.

For wireless use, MH-W headphones incorporate a lithium-ion rechargeable battery pack. When fully charged, the battery pack can provide up to 7.5 hours use at average volume levels. Battery power is not consumed when the MH-W is used passively.

## 1. MH-W Carton Contents

- i. MH-W Headphones
- ii. USB charging cable
- iii. Universal cable
- iv. Quilted pouch
- i. Literature pack

## Environmental Information

This product complies with international directives, including but not limited to the Restriction of Hazardous Substances (RoHS) in electrical and electronic equipment, the Registration, Evaluation, Authorisation and restriction of Chemicals (REACH) and the disposal of Waste Electrical and Electronic Equipment (WEEE). Consult your local waste disposal authority for guidance on how properly to recycle or dispose of this product.

## 2. Getting to know MH-W

Once switched on via the Power slide-switch on its right hand ear piece, the MH-W is controlled via Bluetooth, Play/Pause, Volume + and Volume - buttons. An indicator alongside the Bluetooth button displays Bluetooth connection state and battery charge level. The MH-W also provides audible feedback for some control commands and events.

A USB charging socket is fitted to the right hand ear piece with a pin-hole reboot button beneath the ear pad. Beneath the left hand ear pad is a connection socket for the universal cable that enables the MH-W to be used as a passive headphone. Connecting the universal cable is covered in Section 9.

## 3. MH-W Battery Charging

MH-W headphones are shipped with some battery power available and can be used immediately, however, it is good practice to charge the battery fully before first use. It will take approximately ?? minutes for the MH-W battery to reach full charge however it is possible to use the MH-W while the battery is charging.

Note: The MH-W indicator initially displays battery charge when the MH-W is switched on. Green means that the battery is above 20% charged. Yellow means that the battery is between 20% and 10% charged. Red means that the battery is below 10% charged. If the indicator blinks red, the battery charge is too low for the MH-W to operate.

Note when the LED blinks red MH-W will not power on.

To charge the MH-W battery follow the steps described below.

Using the supplied USB charging cable, connect the headphones to a powered USB socket; either a computer USB socket, a mains plug USB charger or an in-car charger.

While switched off and charging, the MH-W indicator will blink green. As the level of charge increases the illuminated period of the blink will get longer. When the battery is between 80% and 100% charged, the indicator will illuminate for 1.5 seconds in every 4 seconds.

Note: No damage will result if the MH-W is left connected to a battery charger beyond the point where it is 100% charged. Low level "trickle" charging will continue with the indicator illuminating for 1 second in every 4 seconds.

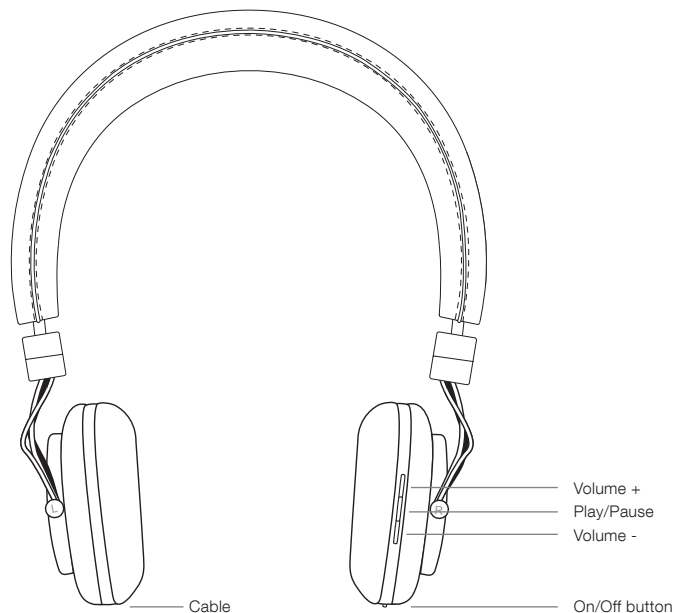

Diagram 1  
Main features

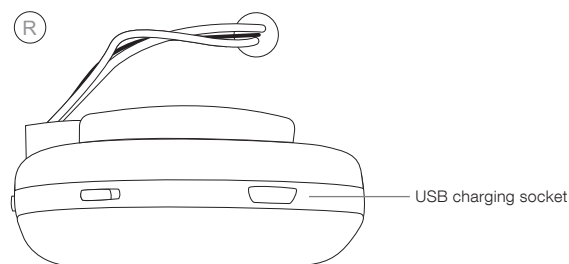

Diagram 2  
Rear view headphones - USB charging socket

#### 4. Switching On and Off

To switch MH-W on or off slide the power switch. MH-W will provide audible feedback as it switches on.

Note: If an MH-W is left switched on but inactive for more than 20 minutes it will automatically enter sleep mode to save battery power. It can be woken by starting a Bluetooth audio stream from a paired device, by sliding the power switch, or pressing the Bluetooth button.

#### 5. Wearing your MH-W Headphones

Using your headphones correctly will help ensure that their performance reaches its full potential. First, identify the left and right ear pieces. Identification legends are engraved on the metal hinge below the headband.

This is illustrated in Diagram 3.

Now unfold the headphones and slide them on to your head with the headband adjusted so that each ear piece sits comfortably over the ear.

This is illustrated in Diagram 4.

It is recommended that you fold and return your headphones to their pouch when not in use.

#### 6. Bluetooth Pairing your MH-W

To connect your MH-W to a Bluetooth enabled audio device it must first be "paired" with the device. Once paired, a Bluetooth device and the MH-W will "remember" each other and be able to connect when within range.

MH-W can remember up to eight paired Bluetooth devices. The first paired device is automatically designated as the "primary" device. Additional devices are designated as "secondary" devices.

The primary device will automatically connect when MH-W is powered on and within range. Secondary devices will not connect automatically when in range but must be connected using their Bluetooth settings menu. When a secondary device is connected, any other existing secondary connection will be ended.

At any time, a press of the Bluetooth button will force MH-W to disconnect all current devices and connect to the primary device, if it is within range.

It is possible for two devices to be connected to MH-W simultaneously, however, audio will only be streamed from one device at any one time.

To pair a Bluetooth device with MH-W follow the steps described below.

With MH-W switched on, press and hold the Bluetooth button for 2 seconds. The MH-W indicator will flash blue and MH-W will provide audible feedback as it enters "pairing" mode.

Note: MH-W will automatically exit from Bluetooth pairing mode if no device is paired within 5 minutes.

Open the Bluetooth settings on the source device and ensure Bluetooth is switched on. Once discovered, P5 Bowers & Wilkins will appear as an available Bluetooth device. Select P5 Bowers & Wilkins and close the Bluetooth settings. The MH-W Bluetooth indicator will flash continuously

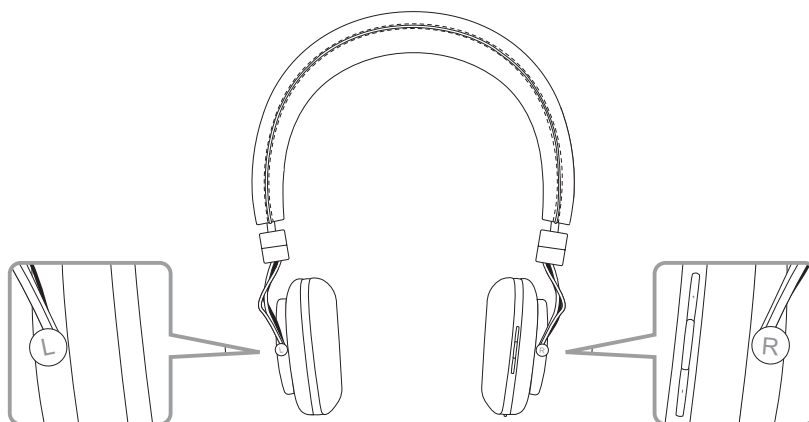

Diagram 3  
Identifying left and right

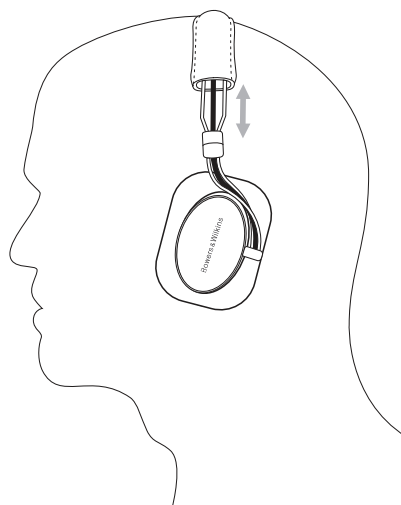

Diagram 4  
Adjusting the earpiece.

while pairing is underway and blink once in every 4 seconds when pairing is established. MH-W will also provide audible feedback when pairing is established.

Note: If your Bluetooth audio source device does not support "simple" pairing and requests a four digit code, enter '0000'.

Once a connection has been established, ensure that MH-W is selected as the speaker output for the Bluetooth source device. Audio will then be heard through MH-W.

Note: If pairing fails the MH-W indicator will flash in 2 second bursts. The most common reasons for pairing failure are signal interference and distance between the two devices. It is good practice to have the two devices relatively close to each other when pairing.

To disconnect a Bluetooth source device from MH-W press the MH-W Bluetooth button twice in quick succession. This will disconnect all Bluetooth connected devices. MH-W will provide audible feedback when Bluetooth is disconnected.

The MH-W paired device memory can be cleared by pressing and holding Volume – and Bluetooth button for 2 seconds. The indicator will flash and MH-W will restart once its memory has been cleared.

## 7. Controlling Bluetooth Audio

The MH-W Play/Pause, Volume + and Volume – buttons can be used to control Bluetooth audio:

Note: The buttons are not operational when the MH-W is used in passive mode with a wired connection.

To increase volume press and hold the Vol + button.

To decrease volume press and hold the Vol – button.

To play audio press and release the Play/ Pause button.

To pause audio press and release the Play/ Pause button.

To select the next track press the Play/ Pause button twice in quick succession.

To select the previous track press the Play/ Pause button three times in quick succession.

## 8. Using a mobile phone with your MH-W

To answer a call press and release the MH-W Play/ Pause button.

To reject a call press the MH-W Play/Pause button for 2 seconds.

To end a call press and release the MH-W Play/ Pause button.

A Bluetooth stream playing while a telephone call is taken will be paused. It will resume when the call is ended.

## 9. MH-W wired connection

In addition to operating wirelessly, your MH-W can be connected to a music source using the supplied universal cable. Cable connection is useful if the MH-W battery is low or if the MH-W is to be used with a non-Bluetooth audio source device.

To connect the supplied cable to your MH-W proceed as described in the following steps and illustrated in Diagram 3.

Carefully pull the left ear pad away from the body of the ear piece. The ear pad is held magnetically and will detach with little effort.

Take one end of the connection cable and carefully insert it into the socket beneath the ear pad. Dress the cable as illustrated in Diagram 3.

Replace the ear pad.

The universal cable must be disconnected for the MH-W to switch on and connect via Bluetooth, however its battery can be charged while the universal cable is connected.

Note: Connecting the universal cable will automatically switch off the Bluetooth and powered elements of the MH-W. The MH-W will not however switch on automatically when the universal cable is disconnected.

## 10. Reboot

To perform a reboot use a straightened paper-clip to press and hold the Reboot button for two seconds. The headphones will turn off, press Power on and reboot will be complete.

Note: performing a reboot will not clear the paired device memory.

## 11. Cleaning your headphones

Clean your headphones by using a damp cloth and dabbing the leather until clean, do not rub the cloth on the leather. Do not use cleaning detergents or leather polish, doing so may cause damage to the product.

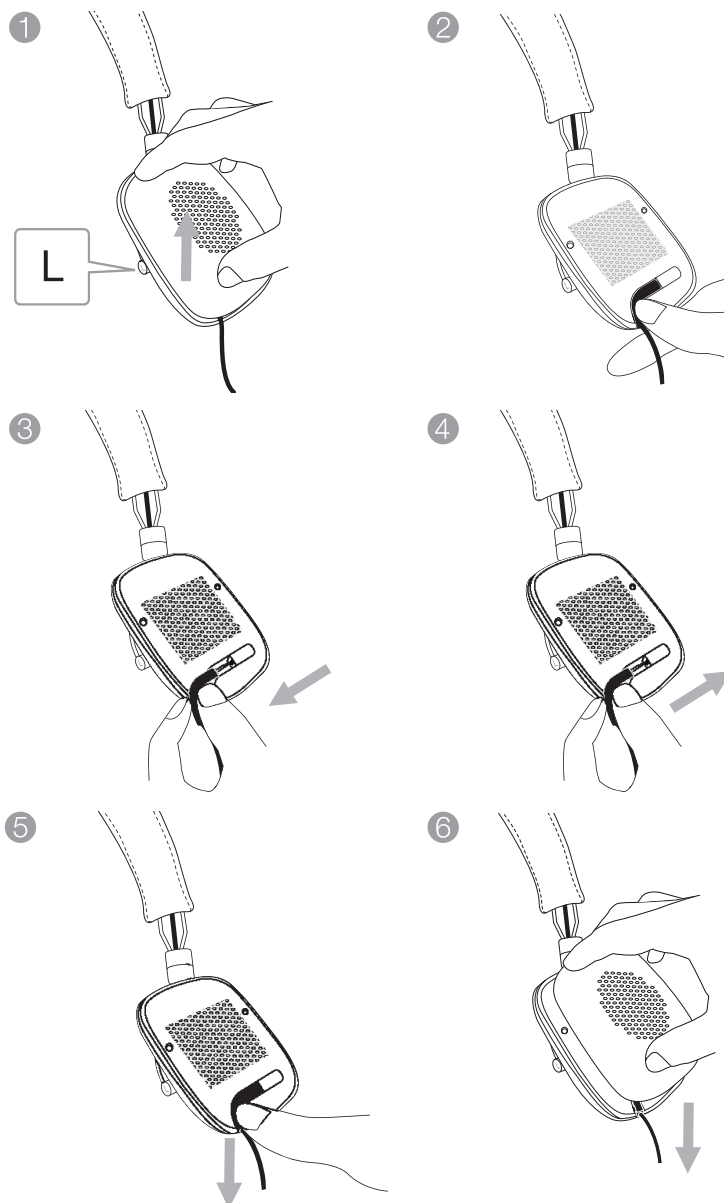

Diagram 3  
Changing the cable