

Bowers & Wilkins PX7 Manual

1. Carton Contents

Please ensure the following items are included in carton:

PX7 Headphones
USB-C Charging Cable
3.5mm Audio Cable
Literature Pack

2. Getting to Know Your Headphones

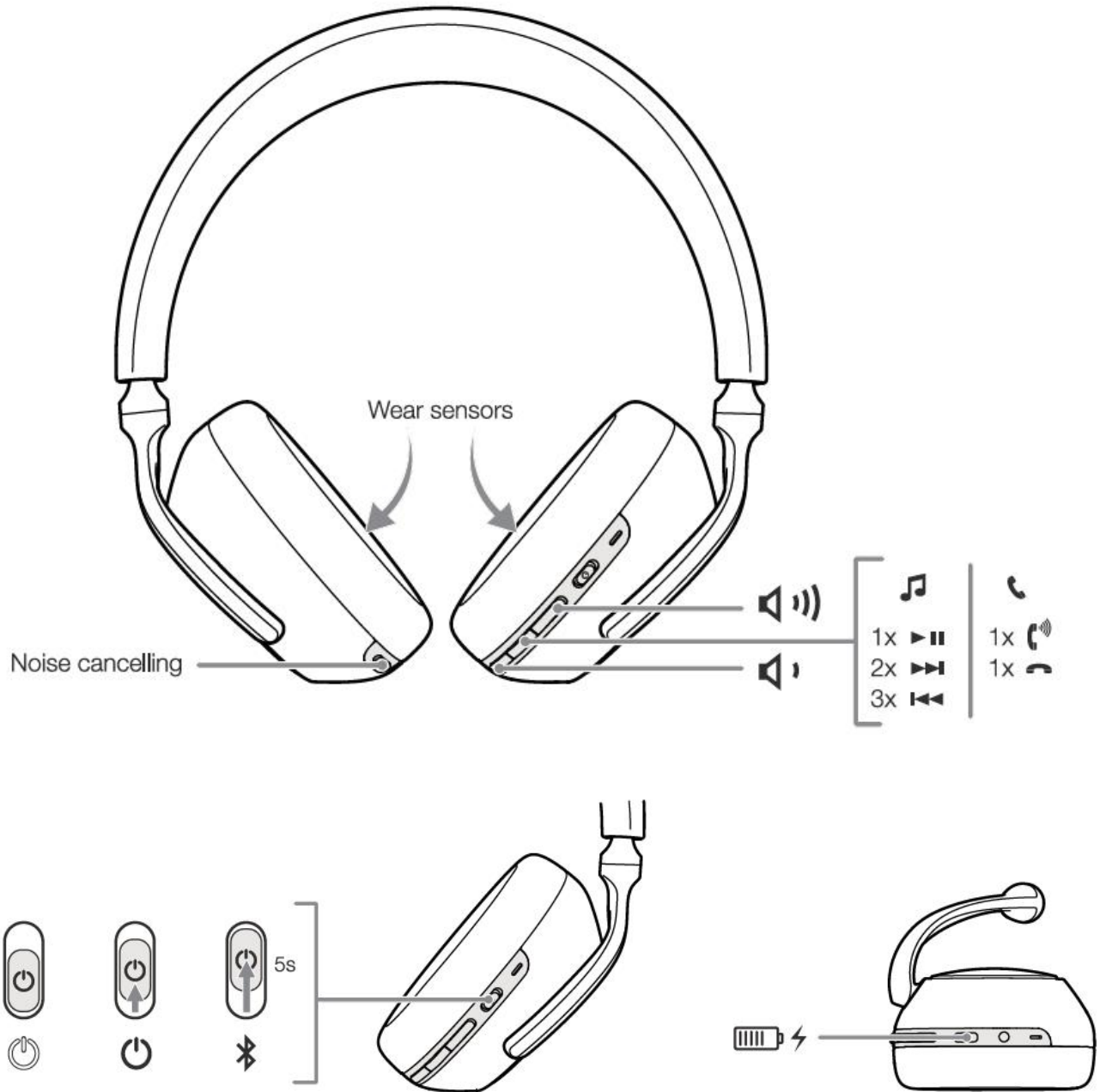

2.1 Switch Headphones On/Off

Switching On

Slide the Power Switch up to the middle position. An audible cue will be presented & the headphone indicator will light in a color (green, amber, red) displaying the current charge level.

Switching Off

Slide the Power Switch to the bottom position. An audible cue will be presented & the headphones power down when the indicator is no longer lit.

2.2 Headphone Controls

The following buttons on the right ear piece to control media playback

Function	Action
Play or pause	Press the Multi-function button once
Play to next track	Press the Multi-function button twice in quick succession
Play previous track	Press the Multi-function button three times in quick succession
Increase Volume	Press the Volume Up button
Lower Volume	Press the Volume Down button

The following buttons on the right ear piece to control phone call functionality:

Function	Action
Answer or end call	Press the Multi-function button once
Answer an incoming call	When incoming call occurs, press the Multi-function button once
Decline an incoming	When incoming call occurs, hold the Multi-function for 2 seconds
Switch between two calls	With two calls active, press the Multi-function button twice
Merge two calls	With two calls active, hold the Multi-function button for 1 second
Toggle Mute	While on a call, press the Multi-function button three times

2.3 Noise Cancellation & Ambient Listening

PX7 headphones features our next generation adaptive noise cancellation technology. The Noise Cancellation button on the left ear piece control this feature.

Mode	What is it
High	Noise cancellation & playback tuning suitable for noisy environments
Low	Noise cancellation & playback tuning suitable for low noise environments
Auto	Headphone senses the surrounding environment & automatically adjusts the level of Noise cancellation & tuning for best experience
Off	Noise cancellation turned off

Function	Action
Enable/Disable Noise Cancellation	Hold the Noise Cancellation button for 2 seconds
Adjust Noise Cancellation Modes	Single press the Noise Cancellation button to cycle between

2.4 Ambient Listening

PX7 headphones also features our second generation ambient listening technology. When enabled, this feature lets external sounds such as conversations or safety announcements to be heard without requiring the user to remove the headphone or disturb the wear.

The Noise Cancellation button on the left ear piece also controls this feature.

Function	Action
Enable/Disable Ambient Listening	Press the Noise Cancellation button twice
Disable Both Noise Cancellation & Ambient Listening	When Ambient listening enabled, hold down the Noise Cancellation button for 2 seconds

2.5 Wear Sensors

PX7 also incorporates proximity sensors in both left and right ear pieces, allowing the headphones to sense if it is worn on the head. This will enable the headphones to intelligently conserve battery by disconnecting Bluetooth and enter stand by ten minutes after taking off, and wake when placed back on your head.

When playing media, the headphone will automatically pause the content when you take them off. If worn again within ten minutes, content playback will resume.

Note: Take special care when wearing your headphones, hair or accessories trapped between your ears and the ear pieces may interfere with proximity sensing.

3. Battery Charging

Your Bowers & Wilkins headphones ships with the battery partially charged & may be used immediately. For best practice we recommend to fully charge the headphones before first use. Please allow up to 3 hours for full charge. The headphones can be used while charging.

To charge:

1. Please use the supplied USB charging cable and connect the USB plug to a USB wall charger or a powered computer USB socket.
2. Then connect the USB-C end to the headphones USB-C socket

Note: During charging, the headphone indicator will blink green. When fully charged, the indicator will remain illuminated.

3.1 Status Indicator

The status indicator is located on the right ear piece next to the USB-C socket.

Illumination	Indication
White (after power on)	Battery charge > 50%
Amber (after power on)	Battery charge > 30%
Red (after power on)	Battery charge < 10%
Red flashing (after power on)	Battery charge insufficient for headphone operation
Blue & Red blinking	Pairing Mode Enabled
Blue (2 sec solid)	Pairing successful
Flash Blue	Incoming call
Green blinking	Rapid charging
Green solid	Battery charge full, trickle charging
White flash (every 4 sec)	Sleep mode, battery charge > 50%
Amber flash (every 4 sec)	Sleep mode, battery charge > 30%
Red flash (every 4 sec)	Sleep mode, battery charge < 10%

4. Wearing Your Headphones

Wearing your headphones correctly will help ensure the best possible experience.

1. Identify the left and right ear pieces by finding the identification legends located on either side of headband.
2. Place the headphones on your head with the headband adjusted so that the headband & earpieces sit comfortably.

Note: Wearing glasses that distort the profile of your ears may interfere with headphone performance. Similarly, hair trapped between your ears and the headphone ear-pieces may interfere with the wear sensor performance

5. Bluetooth Connectivity

5.1 Pairing

Your Bowers & Wilkins PX 7 headphones are designed to stream music wirelessly from Bluetooth audio devices, such as smartphones, tablets, or computers. To do so, the headphones & device must first be paired.

1. The first time you switch on your headphones, Bluetooth pairing mode will be enabled, the indicator will blink blue.
2. If pairing mode is not enabled, please slide & hold the power switch to the (BT Icon) position for 5 seconds, let go when the indicator blinks blue & when an audible cue is presented.
3. Ensure the Bluetooth feature is enabled on the device, your Bowers & Wilkins headphones will appear in the discovery list, select it to start pairing.
4. The indicator will blink blue & red while pairing is in progress and will change to continuous blue & an audible cue presented when successfully paired.

Your headphones can remember up to eight paired Bluetooth Devices. Repeat the above steps to pair more devices.

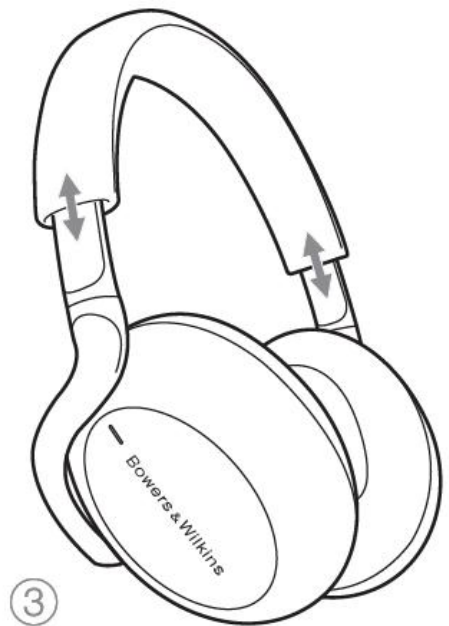
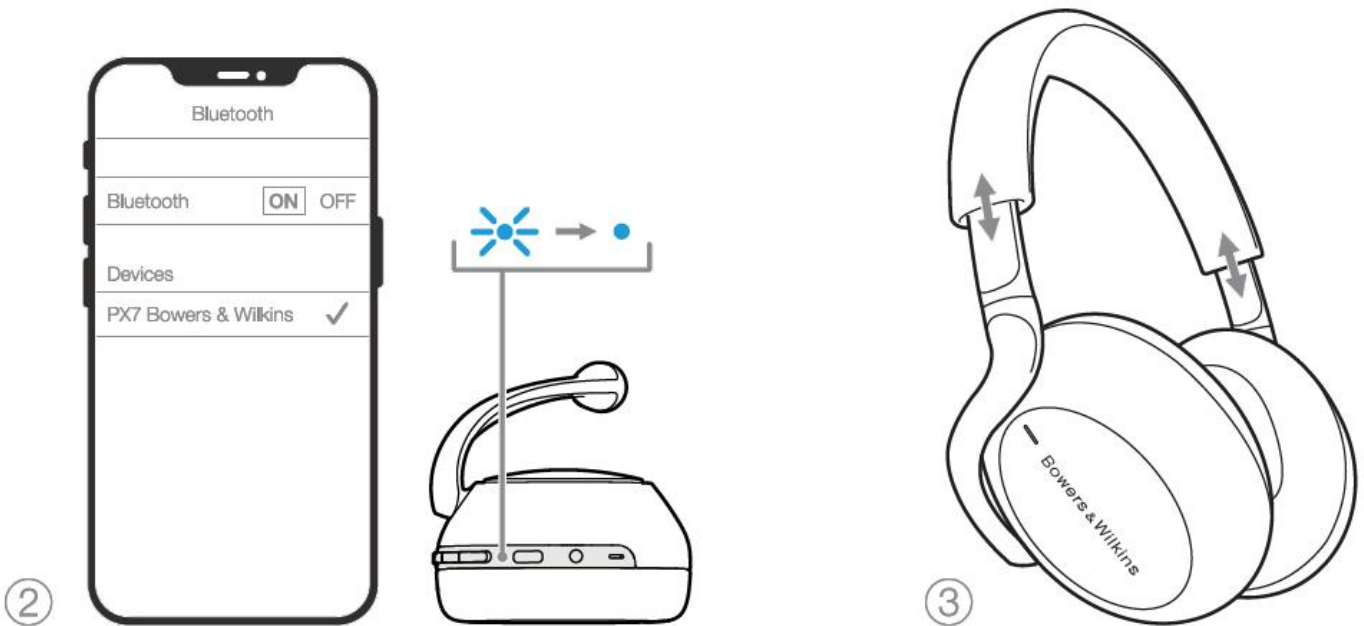
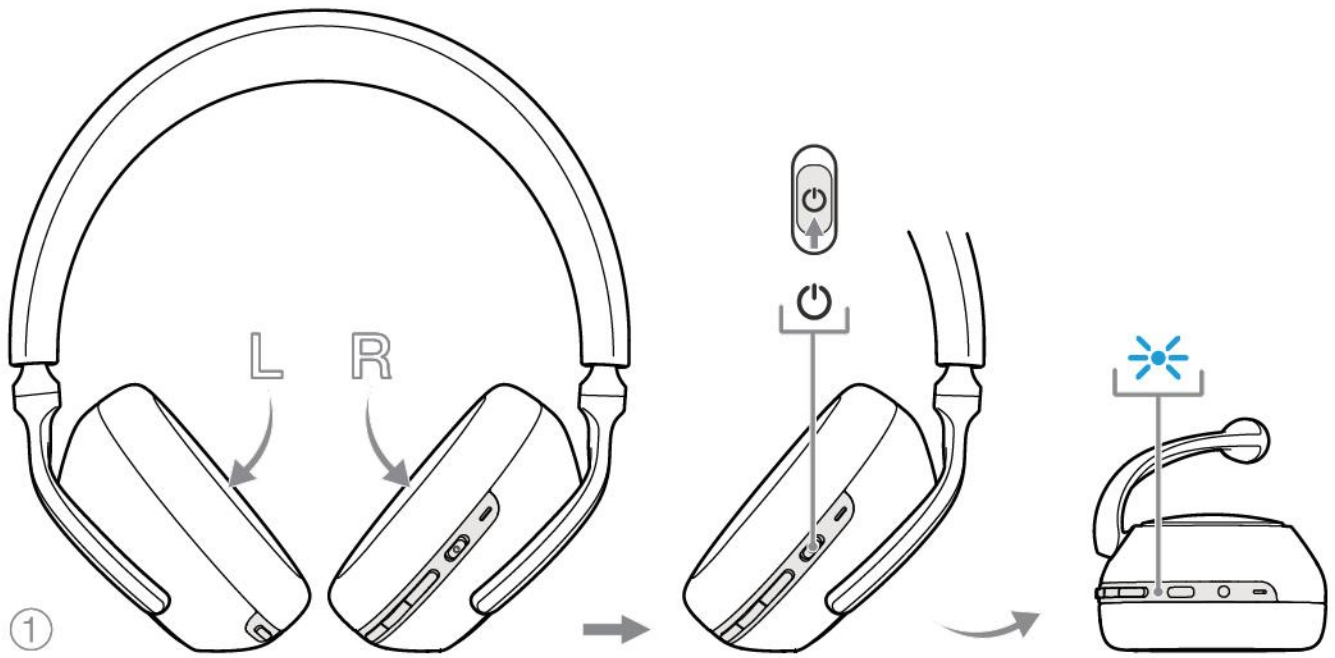

Note: Your headphones will automatically exit Bluetooth pairing mode if no device is paired within 5 minutes. If pairing fails, the indicator will rapid flash blue, please try pairing again

5.2 Switching Between Two Connected Devices

Your headphones can connect up to two devices at the same time. However, you can only play audio or take calls from one device at a time.

To switch between two devices:

1. Pause audio on the first device, or use the headphone's play/pause button.
2. Play audio from the second device and the headphone will switch over.

When streaming audio, receiving a call on the second device will automatically pause playback and the call will be routed automatically to your headphones. Ending the call will automatically resume playback from the first device.

6. Wired Connectivity

In addition to Bluetooth, your Bowers & Wilkins headphones can also connect to audio sources using the supplied 3.5mm audio or USB cables.

6.1 Connecting with the 3.5mm audio cable

The 3.5mm audio cable enables your headphones to be used with a device supporting analog sound output such as a smartphone or tablet 3.5mm headphone socket, a traditional hi-fi system, or on board an aircraft.

1. Insert the 3.5mm audio cable into the headphone 3.5mm socket on the left ear piece.
2. Take the other end and insert into the appropriate socket on your device.
3. Your headphone will automatically disconnect from any Bluetooth devices.

Note: Your headphones must have sufficient charge and switched on to play audio from an analog source device. The volume and play/pause buttons will not function when using the 3.5mm audio connection.

6.2 Connecting with the USB cable

USB connection enables your headphones to function as a USB sound output device when connected to a capable computer.

1. Insert the USB-C end into the headphone's USB-C socket on the right ear piece.
2. Take the USB end and insert into the appropriate socket on your computer.
3. Your headphone will automatically disconnect from any Bluetooth devices.
4. Find and select your headphones from the computer's audio output control panel.

Note: When connected to an capable computer USB port, the headphone battery will also charge.

7. Headphone Reset

Your headphones can be reset to factory settings. When powered on, simultaneously hold down the Volume + and Noise Cancellation Button for 10 seconds until the indicator light turns off, let go when the indicator lights up again.

8. Caring For Your Headphones

Your headphones can be cleaned by a damp cloth and gently dabbing until clean. Do not rub the cloth on the fabric or leather. Do not use cleaning detergents or leather polish, doing so may damage your headphones.

9. Specifications

Technical Features	Adaptive Noise Cancellation Intelligent Auto Noise Cancellation Voice Pass-Through Smart Wear Sensor Bluetooth 5.0 with AptX-Adaptive technology USB-C charging & audio interface 3.5mm auxliary audio interface
Bluetooth Codec	AptX-Adaptive AptX-Classic AptX-HD AAC SBC
Bluetooth Profiles	A2DP v1.3.1 AVRCP v1.6.1 HFP v1.7.1 HSP v1.2 BLE GATT (Generic Attribute Profile)
Drive Units	43.6mm
Frequency Range	10Hz to 20kHz
Input Impedance	22 Ohms
Distortion (THD)	<0.3% (1kHz/10mW)
Max output power	2402MHz to 2480MHz RF Power: 6dBm (include antenna gain)
Ratings	3.8VDC, 600mAh (Supplied by rechargeable Li-ion battery) 5VDC, 0.5A (charged by USB port)
Battery Life	30 hrs Bluetooth with ANC
Charging	15min charge = 5hrs Bluetooth with ANC
Charging temperature:	5°C to 40°C
Operating temperature:	-5°C to 40°C
Inputs	Bluetooth, 3.5mm stereo jack, USB-C audio
Boxed Accessories	1.2m stereo jack audio cable, 1.2m USB-A to USB-C cable, Storage Case
Weight	298 grams