

GETTING STARTED IS EASY!



amazon alexa

1. Download the Amazon Alexa app and sign in or create a free account



SMART PILLAR™

2. Download the Stellé app and create a free account



3. Turn on Smart Plug™ and wait for the "hello" prompt



4. Follow setup instructions in Stellé app

For more information visit: stelleaudio.com/support

For more information visit:
stelleaudio.com/support

stellé

SMART PILLAR™
Quick Start Guide

PACKAGING AND PRODUCT DISPOSAL

Dispose of the packaging and this product in accordance with the latest provisions.

Model No.: ST1007

FCC ID: 2ACGV-CA1300

To locate the FCC identification number, please look on the underside of the stellé smart pillar™ speaker. Please only use with the power supply adapter provided. All return must be made to the original place of purchase.

©2017 STELLÉ SMART PILLAR™. ALL RIGHTS RESERVED.



YOM100734-1001

SMART PILLAR™

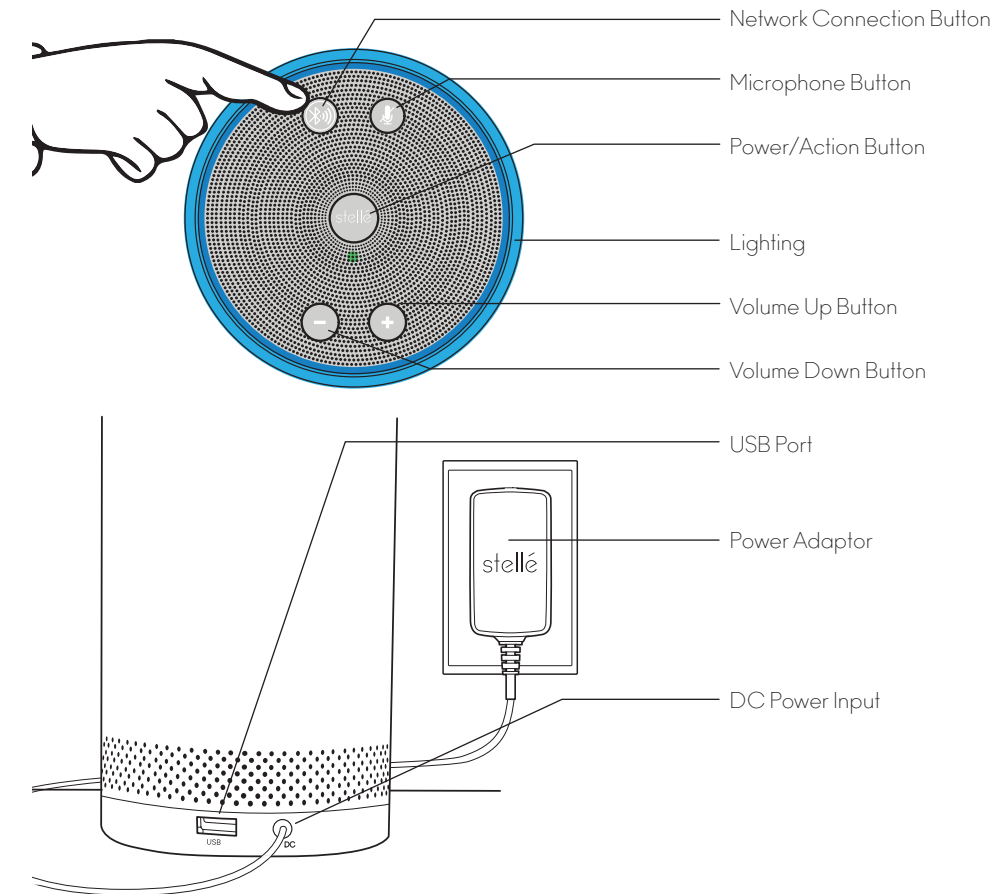

WARNING

Please read these safety warnings and cautions carefully to ensure your personal safety and prevent property damage.

When disposing of used batteries, please comply with governmental regulations or environmental public institution's rules that apply in your country/area.

- To prevent a fire hazard, do not place any naked flame sources (such as a lighted candle) on the equipment
- the use of apparatus in tropical or moderate climates.
- When installing this unit, make sure to open spaces around the unit for ventilation to improve heat radiation.
- the ventilation should not be impeded by covering the ventilation openings with items, such as newspapers, table-cloths, curtains, etc.

FIRE AND ELECTRIC SHOCK HAZARD

Battery/Charger Hazard

- Do not dispose of your stellé smart pillar™ speaker in a fire. The battery could explode causing injury or death.
 - Only charge the battery in accordance with the user instructions supplied with the stellé smart pillar™ speaker.
 - Do not attempt to disassemble stellé smart pillar™ speaker charger or force open the built-in battery because this may result in electric shock.
 - Do not charge the stellé smart pillar™ speaker in damp areas or in extremely high or low temperatures because this could result in electric shock.
 - Do not clean the stellé smart pillar™ speaker when it is being charged. Always unplug the charger first before cleaning the stellé smart pillar™ speaker.
- Danger of explosion if battery is incorrectly replaced. Replace only with the same or equivalent type. The battery (battery or batteries or battery pack) shall not be exposed to excessive heat such as sunshine, fire or the like.*

Automobile Accident Hazard

- Do not leave or store the stellé smart pillar™ speaker or any of its accessories near or over your automobile's air bag because serious injury may result when an air bag deploys.

CAUTION

- Do not use abrasive cleaners to clean your stellé smart pillar™ speaker because this could cause scratches and damage.
 - Do not bring your stellé smart pillar™ speaker in to contact with any sharp objects because this could cause scratches and damage.
 - Do not insert anything into your stellé smart pillar™ unless otherwise specified in the user instructions. This may damage the internal components.
 - Do not attempt to repair, modify, or disassemble your stellé smart pillar™ speaker yourself, it does not contain any user-serviceable components.
 - Do not attempt to replace your stellé smart pillar™ speaker battery, it is built-in and is not changeable.
 - Use only the manufacturer supplied charger to charge your stellé smart pillar™ speaker. Other chargers may look similar, but using them could result in electric shock and could damage the stellé smart pillar™ speaker.
 - Dispose of the stellé smart pillar™ speaker and the stellé smart pillar™ speaker's battery in accordance with local regulations. Do not dispose of the battery with regular household waste.
 - Do not expose your stellé smart pillar™ speaker to liquid, moisture, humidity, or rain. Do not use the stellé smart pillar™ speaker near a bathtub, sink, sauna, pool, or steam room. Exposure of the stellé smart pillar™ speaker to moisture could result in electric shock.
- These servicing instructions are for use by qualified service personnel only. To reduce the risk of electric shock, do not perform any servicing other than that contained in the operating instructions unless you are qualified to do so. The direct plug-in adapter is used as disconnect device, the disconnect device shall remain readily operable.*

IMPORTANT SAFETY INSTRUCTIONS

- Read these instructions
- Keep these instructions.
- Heed all warnings.
- Follow all instructions.
- Do not use this apparatus near water.
- Clean only with dry cloth.
- Do not block any ventilation openings. Install in accordance with the manufacture's instructions.
- Do not install near any heat sources such as radiators, heat registers, stoves, or other apparatus (including amplifiers) that produce heat.
- Do not defeat the safety purpose of the polarized or grounding plug. A polarized plug has two blades with one wider than the other. A grounding plug has two blades and a third grounding prong. The wide blade or the third prong is provided for your safety. If the provided plug does not fit into your outlet, consult an electrician for replacement of the obsolete outlet.
- Protect the power cord from being walked on or pinched particularly at the plugs, convenience receptacles, and at the point where they exit from the apparatus.
- Only use attachments/accessories specified by the manufacturer.
- Use only with the cart, stand, tripod, bracket, or table specified by the manufacturer, or sold with the apparatus. When a cart or rack is used, use caution when moving the cart/apparatus combination to avoid injury from tip-over.
- Unplug the apparatus during lightning storms or when unused for long periods of time.
- Refer all servicing to qualified personnel. Servicing is required when the apparatus has been damaged in any way, such as power supply cord or plug is damaged, liquid has been spilled or objects have fallen into the apparatus has been exposed to rain or moisture, does not operate normally, or has been dropped.

FCC STATEMENT

This equipment has been tested and found to comply with the limits for a Class B digital device, pursuant to Part 15 of the FCC Rules. These limits are designed to provide reasonable protection against harmful interference in a residential installation. This equipment generates, uses, and can radiate radio frequency energy and, if not installed and used in accordance with the instructions, may cause harmful interference to radio communications. However, there is no guarantee that interference will not occur in a particular installation. If this equipment does cause harmful interference to radio or television reception, which can be determined by turning the equipment off and on, the user is encouraged to try to correct the interference by one of the following measures: Reorient or relocate the receiving antenna. Increase the separation between the equipment and receiver. Connect the equipment into an outlet on a circuit different from that to which the receiver is connected. Consult the dealer or an experienced radio/TV technician for help.

FCC NOTICE

This device complies with Part 15 of the FCC Rules. Operation is subject to the following two conditions: 1. This device may not cause harmful interference, and 2. This device must accept any interference received, including interference that may cause undesired operation.

FCC CAUTION

Any changes or modifications not expressly approved by the party responsible for compliance could void the user's authority to operate this equipment. This device and its antenna(s) must not be co-located or operating in conjunction with any other antenna or transmitter.

This equipment must be installed and operated in accordance with provided instructions and the antenna(s) used for this transmitter must be installed to provide a separation distance of at least 30 mm from all persons.

©2017 STELLÉ SMART PILLAR™. ALL RIGHTS RESERVED.