



gekogear[®]



USER MANUAL

Orbit C110

7" Infotainment Display
with Dash Cam and Backup Cam

LIMITED WARRANTY

GekoGear provides a one year limited warranty for all of its products against defects in materials and workmanship. During this period, GekoGear will repair or replace any product which proves to be defective. However, GekoGear will not warrant any product which has been subject to improper handling, abuse, negligence, improper installation or unauthorized repair. The warranty will not cover products installed with components not approved by GekoGear and products where the sealed assembly trace has been broken. If you discover a defect, GekoGear will, at its option, repair or replace the product free of charge, provided you return it during the warranty period with freight charges pre-paid to GekoGear. Before returning any product, you must obtain a Return Merchandise Authorization number (RMA). This RMA # must be clearly marked on the outside of the package you are returning for warranty service. Be certain to also include your name, shipping address (no PO Boxes), telephone number, and a copy of the invoice showing proof of purchase in the package.

Disclaimer: Please note that we strongly recommend professional installation of the hardwiring cable. You are free to attempt the installation yourself, however GekoGear and our affiliates will not be held liable for any product and vehicle damage, or personal injuries sustained by you or others during this installation.

SUPPORT

FAQ's: <https://www.gekogear.com/faq>

Email Support: support@gekogear.com

Telephone Support:

Toll Free: (800) 795-6788

9:00AM to 5:00PM PST Monday - Friday

DISCLAIMER

1. Please follow the set-up and usage instructions in the print material that came with this Display product.
2. You should not set/install this display at a place that would obstruct or reduce a driver's view; make sure your usage complies with pertinent vehicle codes of your state, province, territory or country.
3. You should post the required notices of recordation to occupants inside the vehicle, if voices or other information/signal pertaining to in-vehicle activities will be recorded.
4. You should not change the infotainment settings or mode of operation or when the vehicle is in motion.
- EN 5. The optional driving warning signals, including any visual or audible reminding signals, should not replace your decision-making and judgment that are needed for the proper operation of the vehicle.
6. You should not leave the monitor in a visible spot when no one is inside the vehicle, to avoid attracting break-ins to steal the unit, or other property.
7. You should examine, check and/or verify the infotainment system at least every six (6) months, including the associated memory cards, to ensure the video reception and recording are working properly. For each use, you should verify that the infotainment unit, the visible lights and the audible sounds are working normally. If there are signs of non-operation or mal-function, you should immediately seek to replace the product and check to see if the product is covered under any applicable warranty.

8. The Orbit C110 unit may have additional functionality, such as transmission and recording of audible or GPS signal or other identification information. If you have privacy concerns about these functions, make sure you follow the instruction to disable these functions.

9. You should use the infotainment system unit in the way it is intended. You should not use the system unit in a way that would be illegal or that tends to physically damage the unit, or tends to cause danger to the safe operation of the vehicle or the occupants.

Thank You!

Thank you for purchasing the Orbit C110.

This user manual contains technical specifications and instructions for use, operate, and install. Please read this manual carefully before using.

Product Overview

This product is a high-definition display, with high-quality digital audio, Front and Rear Cameras and USB-C charging function.

EN

PACKAGE CONTENTS



Orbit C110 Display



Rear Camera



Suction Cup



64GB
MicroSD



Car Charger

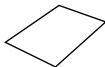

User Manual

Product Features

1. 7" IPS Touch Screen 600*1024
2. 2.4G/5G WIFI
3. Bluetooth 5.0
4. Support Apple Car Play
5. Support Android Auto
6. Built-in Mic/Speaker
7. Support MICRO SD card up to 128GB
8. Voice Control
9. Front Camera
10. Backup Camera
11. FM Transmission

Product Button Function Instruction

EN



1. AUX Port

2. Micro SD Slot

3. AV (Rear camera port)

4. USB-C Power Port

5. Power Button

Where to Install Your Infotainment Display

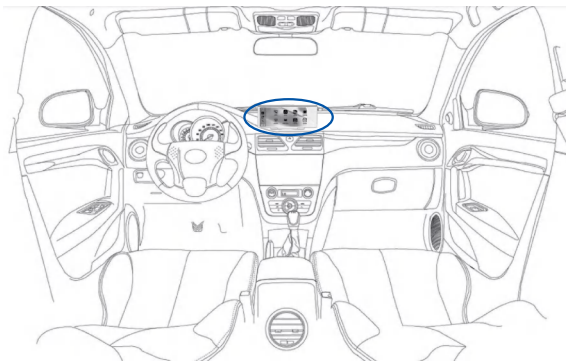

EN

Connecting to a Car

The Orbit C110 can be connected to a by using the supplied 12V charger that connects to the 12V port in your car.

Basic Operation

- 1. Wireless connection:** Tap to enter the connection interface, you will find the instructions on how to connect to wireless Apple carplay, Android Auto, Airplay and Mirror.
- 2. DVR:** Tap to enter Dashcam recording interface.
- 3. Audio:** Tap to enter the Audio interface, you can play the Native Audio, AUX Audio, FM Audio and BT Audio.

- 4. Setup:** Click to enter the setup interface.
- 5. Volume:** Click to adjust the volume, slide the volume bar to adjust it
- 6. BT:** Click to enter BT phone dial interface.
- 7. Menu:** Direct return to the main menu page.
- 8. Brightness:** tap to adjust screen brightness, slide the bar to adjust it.



Using Apple CarPlay

1. Tap on the CarPlay feature and follow your iPhone's Bluetooth pairing steps and search for Orbit C110, select it and it will pair.
2. If the pairing sequence does not work, tap on the setting icon and restart or unpair a previous connection.
3. Make calls using CarPlay by utilizing Siri or using your vehicle's built-in controls to make the call.
4. Navigate and receive traffic information using Maps mirrored from your phone onto the monitor.
5. Listen to your favorite music and podcasts using the most popular streaming services.

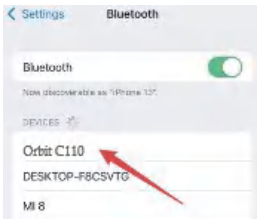

EN

Using Android Auto

1. Tap on the Android Auto feature and follow your phone's Bluetooth pairing steps and search for Orbit C110, select it and it will pair.
2. If the pairing sequence does not work, tap on the setting icon and restart or unpair a previous connection.
3. Make calls using Android Auto by utilizing Google assistant or using your vehicle's built-in controls to make the call.

4. Navigate and receive traffic information using Maps mirrored from your phone onto the monitor.
5. Listen to your favorite music and podcasts using the most popular streaming services.

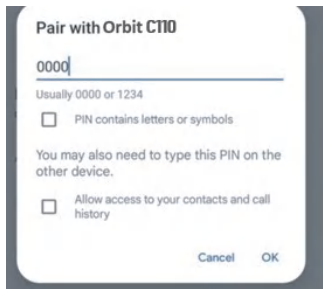
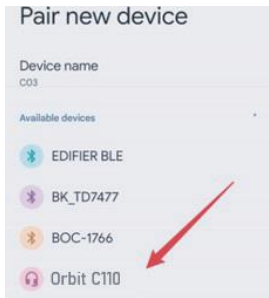

General Usage

Wireless CarPlay uses Bluetooth to set up the connection between the phone and the vehicle and then it switches to using WIFI for the actual functionality.

After the Bluetooth pairing is successful, the phone's WIFI will automatically connect to the device's WIFI, and then disconnect the Bluetooth connection by default.

When the car stereo is powered on, it will try to automatically connect to the last connected phone.

Based on the working principle of the Car Play device, please pay attention to the following:

1. When enjoying the wireless CarPlay/Android Auto function, the phone's WIFI will be occupied by the device, other WIFI connections cannot be used during this period. If there is a conflict between other WIFI connections and the device's WIFI, you may need to manually disconnect the connection of other WIFI to keep the wireless CarPlay/Android Auto in use.
2. The auto-connection function of the car stereo requires you to keep the WIFI and Bluetooth of the mobile phone available. In addition, please set the WIFI network of the car stereo to "Auto-Connect".
3. Since the car stereo will disconnect the Bluetooth connection after pairing, your phone's Bluetooth may automatically connect to other devices, which may cause the car stereo mic input or sound playing to be unavailable. You may need to manually disconnect your phone from the other Bluetooth connections or switch off the Bluetooth directly to fix it. (Bluetooth plays a pairing role in the setup of the car player. When the pairing is completed, it only needs WIFI to keep working, you can then choose to turn off the Bluetooth or keep it on. However, when you use it again the next time, you still need to turn on Bluetooth, so that the car stereo can be automatically paired and connected.)

Note: In the drop-down menu of the mobile phone, you need to turn off Bluetooth first, and then turn off the WIFI connection to disconnect. If you only turn off the WIFI, and keep the Bluetooth on the car will keep trying to reconnect.

Camera Installation

1. Locate the appropriate installation position in the license plate attachment.
2. Depending on the vehicle you may need to drill holes or use double sided tape to mount the rear camera and pass through the cables.
3. Fix the camera to the rear of the vehicle using the screws or double sided tape, and splice the red reversing trigger wire to the positive wire of the reverse light (professional installation is recommended).
4. Finally, you can run the extension cable of the rear camera to the front of the vehicle onto the infotainment system.

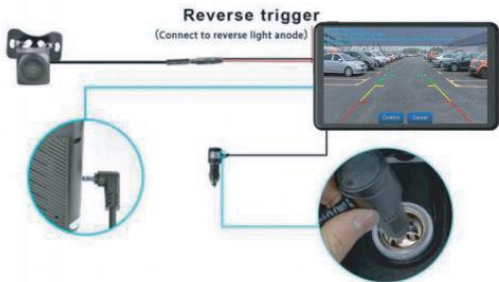

DVR

1. Click to enter the DVR function to view the real time front and rear cameras.
2. Switch between showing both cameras or choose between the front or rear camera.



FM Transmission Feature

1. When turned on, the device will transmit the sound through the car's speakers.
2. You must tune both the device and your car's radio into the same station.

EN



Bluetooth Music

1. Click to enter the Bluetooth interface and you will see the Bluetooth name of your phone.
2. Search for Orbit C110 on your phone's Bluetooth settings and click to complete the pairing connection.
3. Once paired successfully, you will be able to play music and have phone calls.

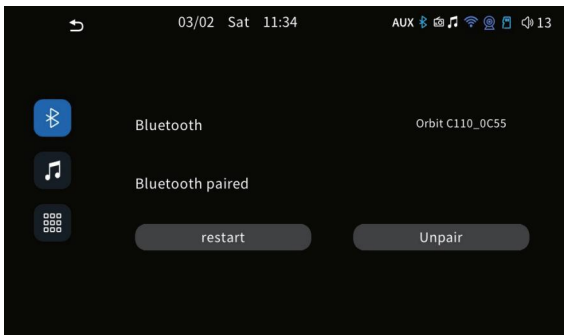

EN

Video Playback

1. Once you click on this function you will be able to view the stored videos and images from the SD card.

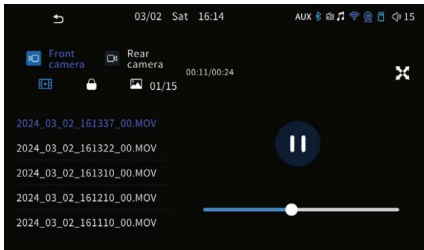

Settings

1. Click on the settings icon to be able to view and change the devices settings such as video recording settings, display settings, time and date, detection settings, storage settings, WIFI settings, system and system information settings.



Note: Format the memory card for first time usage.

Troubleshooting

1. The device is not powering on

Check whether the power cable is inserted properly both on the 12V cigarette lighter port and the devices USB-C port. If there is still no power, please try connecting a different device to see if the cigarette lighter is not functioning.

2. Touchscreen does not work

Once the device has powered on and the touchscreen is not working, please wait a few seconds in case the device is still loading. If the touchscreen does not work still, please check for any damage or cracks on the screen itself.

3. Rear camera image is not displaying

Check the cable to see if there is a loose connection or not seated properly, remove the cable and plug it back in.

4. Carplay/Android Auto won't connect

You must use a phone that supports Carplay or Android Auto, the first time connecting can take a longer time. Make sure your phone's Bluetooth and WIFI settings are turned on. If the phone was previously connected but no longer connects, please remove the previous connection and attempt to pair again.

5. Bluetooth music doesn't work

Make sure your phone is paired to the infotainment system through Bluetooth.

Maintenance and Care

- Use a soft, lint-free cloth to clean the monitor screen.
- You should avoid extended exposure of the monitor to direct sunlight or extreme temperatures (either high or low temperature) which tend to degrade or damage the unit and its normal functionality.
- Store the monitor in a cool, dry place when not in use.

Specifications

LCD Screen	7" IPS touch screen
Video Resolution	600*1024
Memory	DDR3 256MB
WIFI	2.4G/5G
Bluetooth	5.0
Speaker	8 Ohms / 1.5W
Microphone	Supported
Video Player	Supported
Audio Player	Supported
Camera Resolution	Front 1080P, Rear 1080P
Power Interface	USB-C
Language	English/French/Spanish
Operating Temperature	-20°C~70°C / -4°F~150°F
Memory card	Micro SD card up to 128GB

Need more information? Visit our website via www.gekogear.com

Feel free to contact our service team at support@gekogear.com if you have any additional questions.

FCC Caution.

This device complies with part 15 of the FCC Rules. Operation is subject to the following two conditions: (1) This device may not cause harmful interference, and (2) this device must accept any interference received, including interference that may cause undesired operation.

Any Changes or modifications not expressly approved by the party responsible for compliance could void the user's authority to operate the equipment.

Note: This equipment has been tested and found to comply with the limits for a Class B digital device, pursuant to part 15 of the FCC Rules. These limits are designed to provide reasonable protection against harmful interference in a residential installation. This equipment generates uses and can radiate radio frequency energy and, if not installed and used in accordance with the instructions, may cause harmful interference to radio communications. However, there is no guarantee that interference will not occur in a particular installation. If this equipment does cause harmful interference to radio or television reception, which can be determined by turning the equipment off and on, the user is encouraged to try to correct the interference by one or more of the following measures:

- Reorient or relocate the receiving antenna.
- Increase the separation between the equipment and receiver.
- Connect the equipment into an outlet on a circuit different from that to which the receiver is connected.
- Consult the dealer or an experienced radio/TV technician for help.

This equipment complies with FCC radiation exposure limits set forth for an uncontrolled environment. This equipment should be installed and operated with minimum distance 20cm between the radiator & your body.