



**gekogear**<sup>®</sup>



# **QUICK USER MANUAL**

**Wireless USB Dongle Compatible with Apple Carplay**

**ORBIT A100**

**English**

## LIMITED WARRANTY

GekoGear provides a one year limited warranty for all of its products against defects in materials and workmanship. During this period, GekoGear will repair or replace any product which proves to be defective. However, GekoGear will not warrant any product which has been subject to improper handling, abuse, negligence, improper installation or unauthorized repair. The warranty will not cover products installed with components not approved by GekoGear and products where the sealed assembly trace has been broken. If you discover a defect, GekoGear will, at its option, repair or replace the product free of charge, provided you return it during the warranty period with freight charges pre-paid to GekoGear. Before returning any product, you must obtain a Return Merchandise Authorization number (RMA). This RMA # must be clearly marked on the outside of the package you are returning for warranty service. Be certain to also include your name, shipping address (no PO Boxes), telephone number, and a copy of the invoice showing proof of purchase in the package.

Disclaimer: Please note that we strongly recommend professional installation of the hardwiring cable. You are free to attempt the installation yourself, however GekoGear and our affiliates will not be held liable for any product and vehicle damage, or personal injuries sustained by you or others during this installation.

## SUPPORT

**FAQ's:** <https://www.mygekogear.com/frequently-asked-questions/>

**Email Support:** [service@mygekogear.com](mailto:service@mygekogear.com)

**Telephone Support:**

Toll Free: (800) 795-6788

9:00AM to 5:00PM PST Monday - Friday

## **INTRODUCTION**

Introducing the Gekogear Orbit A100, a cutting-edge wireless CarPlay USB adapter designed to enhance your in car connectivity experience. This sleek and compact device seamlessly integrates with your vehicle, transforming your infotainment system into a smart hub. The Gekogear Orbit A100 eliminates the need for cumbersome cables, providing a wireless connection between your smartphone and the car's display. Effortlessly enjoy the convenience of CarPlay functionalities, allowing you to access navigation, music, calls, and messaging with unparalleled ease and safety.

## **SPECIFICATIONS**

- Connectivity: USB-A or USB-C
- Color: Black
- Compatibility: Apple Car Play
- Bluetooth: 5.0
- Dimensions: 3 "x 1.5 "x 0.5 "
- Weight: 10 g

## **CONTENTS**

1x Orbit A100

1x USB-A to USB-C Adapter

1x Quick Start Guide

## REQUIREMENTS

1. Supports iPhone 6 and later iPhone models.
2. The iPhone system version needs to be iOS 10 and above.
3. Only for cars with wired Apple CarPlay

## OVERVIEW

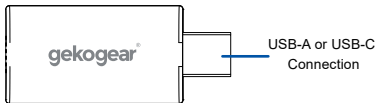

## GETTING STARTED

1. Start your vehicle.
2. Plug in the Orbit A100 into the USB port of your vehicle. Connect the wireless CarPlay adapter to your vehicle's USB or USB C port. Note if your car has several ports, please be sure to plug the adapter into the port that is for wired Apple CarPlay.
3. Your vehicle will then prompt you for a connection. Turn on your iPhone's WiFi, then the adapter "Orbit A100 " will appear in the list. Please do not connect to it or to any other WiFi list at this time, just keep Wi-Fi on and not be occupied.
4. Using your iPhone's Bluetooth, search for Orbit A100 and select to pair. After a few seconds, the phone will prompt "Use Carplay", click the prompt and wait for 5-15 seconds to connect successfully.

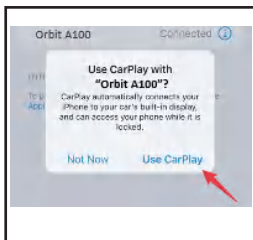
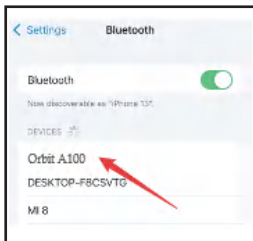
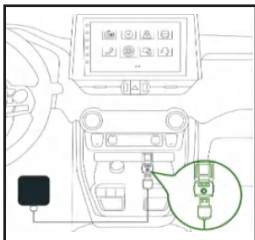

## GENERAL INFORMATION

- Your vehicle must have a compatible Car Play radio in order to use the Orbit A100 as this product only eliminates the need for a cable.
- Before Bluetooth pairing, Make sure your iPhone is not connected to your vehicle's radio through Bluetooth or WIFI as it can cause interference.
- You should not change any settings or mode of operation when the vehicle is in motion.

- The Orbit A100 can be paired with multiple iPhones, but it can't connect with them at the same time. Before pairing to a new iPhone, please disconnect the WiFi and Bluetooth of the currently connecte phone.

- You should only use the Car Play USB adapter in the way it was intended. You should not use the unit in a way that would be illegal or that tends to physically damage the unit.

## **FAQ**

Q: What is the password to connect to WiFi?

A:What we need to connect is Bluetooth, not WiFi. No password is required for connecting to Bluetooth. Make sure your WiFi is turned on and unoccupied when pairing.

Q: Audio input or output issues: calls rejected or forwarded to voicemail/no play sound/ microphone not working/music playback interrupted or paused/voice functioning abnormally...

A:1) Please check your phone's Bluetooth to see if it is connected to another device. If so, please ignore other auto-connected Bluetooth devices or turn off the Bluetooth directly.

2) Clear the programs running in the background of your phone when using the adapter.

3) When on a call, check that your "Audio" output option is CarPlay.

\* Note: Bluetooth plays a pairing role in the work of the adapter. When the pairing is completed, it only needs wifi to keep working, so it doesn't matter to turn off Bluetooth. But when you use it next time, you still need to turn on Bluetooth, so that the dongle can be automatically paired and connected.

Q: Can the adapter be paired with multiple phones?

A:The adapter can be paired with multiple iPhones, but only one device can be connected at a time. If you would like to pair it with a new iPhone, please cancel the current connection first. Please note, by Bluetooth function default, the adapter's system will only auto-connect back to the last used iPhone.

### FCC Caution.

This device complies with part 15 of the FCC Rules. Operation is subject to the following two conditions: (1) This device may not cause harmful interference, and (2) this device must accept any interference received, including interference that may cause undesired operation.

Any Changes or modifications not expressly approved by the party responsible for compliance could void the user's authority to operate the equipment.

**Note:** This equipment has been tested and found to comply with the limits for a Class B digital device, pursuant to part 15 of the FCC Rules. These limits are designed to provide reasonable protection against harmful interference in a residential installation. This equipment generates uses and can radiate radio frequency energy and, if not installed and used in accordance with the instructions, may cause harmful interference to radio communications. However, there is no guarantee that interference will not occur in a particular installation. If this equipment does cause harmful interference to radio or television reception, which can be determined by turning the equipment off and on, the user is encouraged to try to correct the interference by one or more of the following measures:

- Reorient or relocate the receiving antenna.
- Increase the separation between the equipment and receiver.
- Connect the equipment into an outlet on a circuit different from that to which the receiver is connected.
- Consult the dealer or an experienced radio/TV technician for help.

This equipment complies with FCC radiation exposure limits set forth for an uncontrolled environment. This equipment should be installed and operated with minimum distance 20cm between the radiator and your body.