

折后正面

折后背面

ADESSO

# Tru-Form Media™ 1500 Wireless Ergonomic Keyboard & Laser Mouse



Model: WKB-1500GB

## QuickGuide English

www.adesso.com

### LIMITED WARRANTY

Adesso provides a one year limited warranty for all of its products against defects in material and workmanship.

During this period, Adesso will repair or replace any product which proves to be defective. However, Adesso will not warranty any product which has been subject to improper freight handling, shipping abuse, neglect, improper installation or unauthorized repair. The warranty will not cover products installed with components not approved by Adesso and products where the sealed assembly trace has been broken.

If you discover a defect, Adesso will, at its option, repair or replace the product at no charge to you provided you return it during the warranty period with freight charges pre-paid to Adesso. Before returning any product, you must obtain a Return Merchandise Authorization number (RMA). This RMA # must be clearly marked on the outside of the package you are returning for warranty service. Be certain to also include your name, shipping address (no PO Boxes), telephone number, and a copy of the invoice showing proof of purchase in the package.

### SUPPORT

We have listed most of our FAQ's (Frequently Asked Questions) at: <http://www.adesso.com/faqs.asp>. Please visit our FAQ Service & Support pages before you contact our E-mail or Telephone Support.

**Email Support:** If our FAQ's do not help you resolve your issues, please email [support@adesso.com](mailto:support@adesso.com)

**Telephone Support:**  
Toll Free: (800) 795-6788  
9:00AM to 5:00PM PST Monday - Friday

### INTRODUCTION

The Adesso 2.4GHz Wireless Ergonomic Keyboard & Laser Mouse offer users two advanced input devices with ergonomic design, multifunctional features and a wireless range of up to 30 feet. The design of this keyboard with splitted key zones and gently sloped encourages natural position of hands, wrists, and forearm in maximum comfort for long use. The included wireless laser mouse not just provides comfortable ergonomic design but also equips with a DPI switch for changing resolution (800/1200/1600) and two Internet navigation buttons.

### SPECIFICATIONS

- Keyboard & Mouse Wireless Technology: 2.4GHz RF Wireless Technology
- Keyboard & Mouse Working Range: Up to 30 feet (10m)
- Keyboard & Mouse Battery Type: (2) AAA Batteries per device
- Keyboard Layout: 105-Key US
- Key Type: Membrane
- Keyboard Hotkeys: 20 Hotkeys (Windows, Internet and Multimedia)
- Keyboard Indicators: Battery Low, Num Lock & Caps Lock
- Keyboard Dimensions: 20.5" x 9.3" x 1.5" (521 x 236 x 41 mm)
- Mouse Tracking Method: Laser Sensor
- Mouse DPI: 3 Levels - 800, 1200 & 1600
- Mouse Dimensions: 3.3" x 5.0" x 1.7" (85 x 127 x 44 mm)

### REQUIREMENTS

- Operating System: Windows® 10/8/ 7/ Vista/ XP
- Connectivity: USB for Wireless Receiver

### CONTENTS

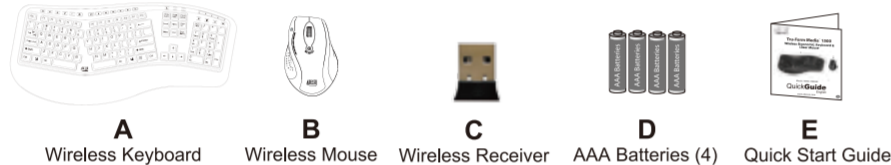

### MOUSE DESCRIPTION

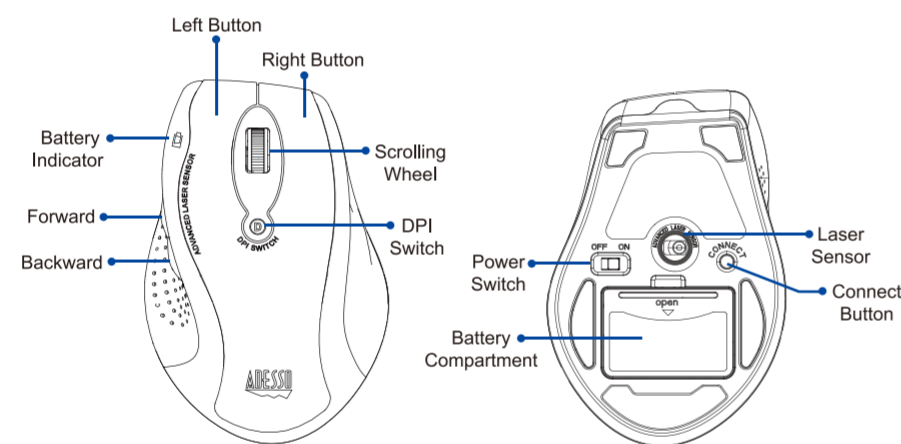

### KEYBOARD DESCRIPTION

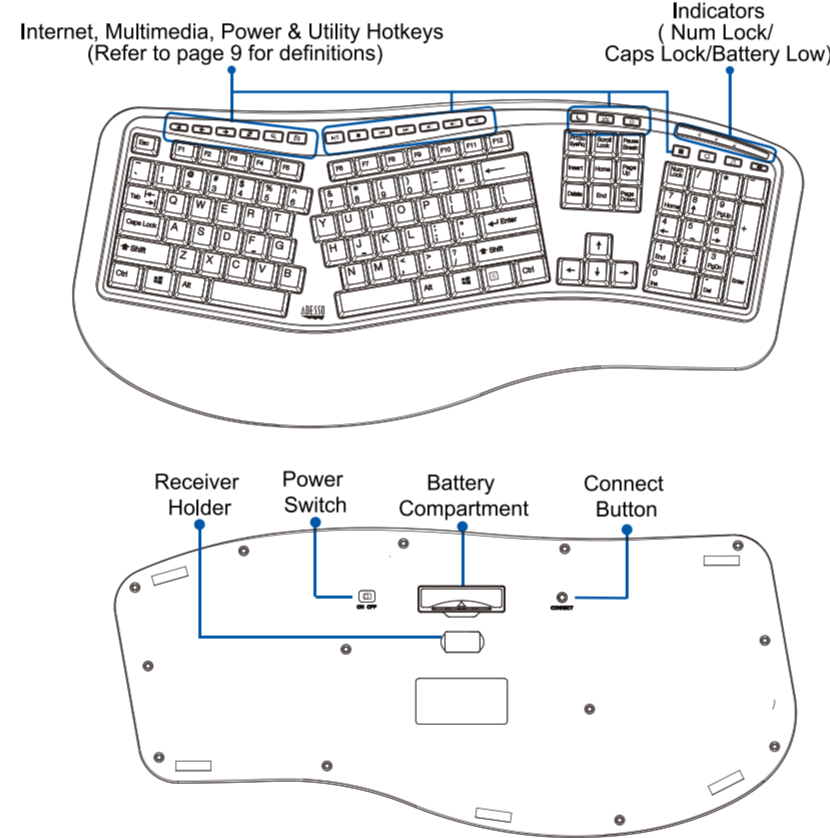

### INSTALLATION

1. Procedure of changing your batteries:
  - a) Remove battery cover from mouse battery compartment
  - b) Insert (2) AAA batteries into device.
  - c) Close the battery compartment cover.

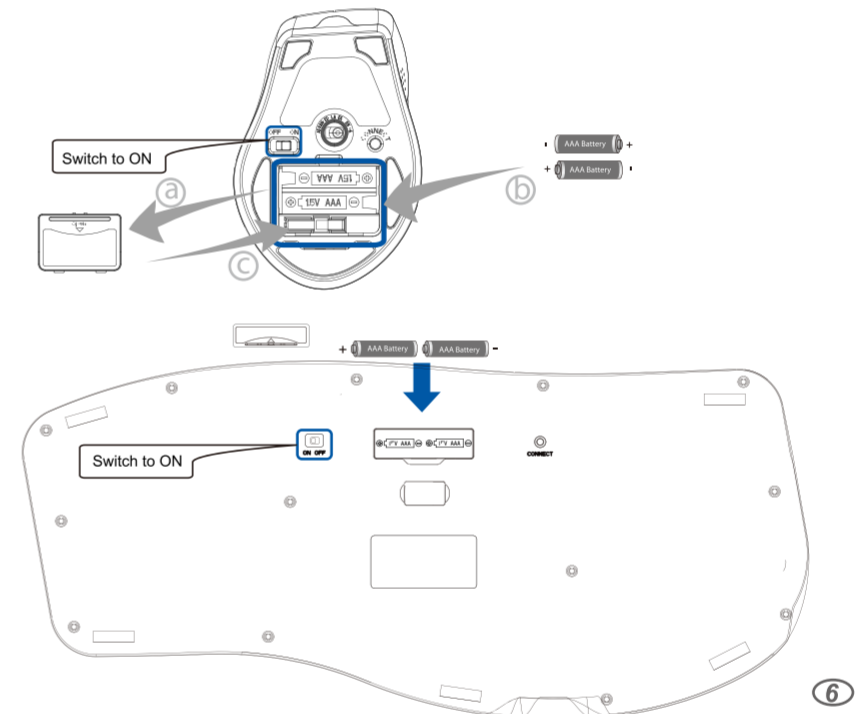

2. Turn ON your computer and let Windows load completely.
3. Plug the USB Wireless Receiver into the USB port of your computer

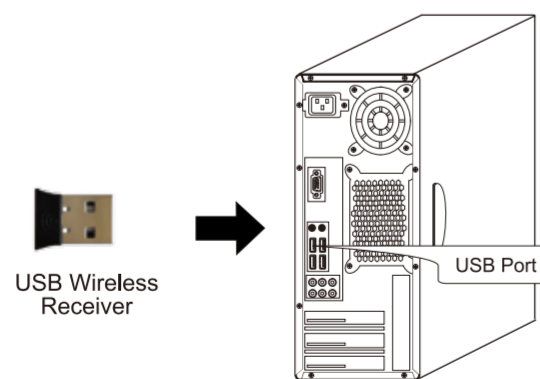

4. Receiver will automatically connect with wireless keyboard and mouse. Now, they are ready to be used.

### NOTE:

Windows will detect the driver automatically. No driver required.

### TIPS:

- When the Battery Low LED is ON, it means that the device requires to change the batteries.
- We suggest to turn "OFF" the devices when leaving your desk for more than an hour to save battery life for longer lasting use.

### TROUBLESHOOTING

If wireless keyboard/ mouse cannot be operated, please try the following:

1. Make sure you have inserted two AAA batteries inside the battery compartment correctly. Switch the device to ON.
2. Make sure you have connected the USB receiver correctly to the computer's USB ports. Move the devices 1 foot away from the receiver in order to avoid interference while pairing connection.
3. Press CONNECT once on the bottom of devices within 15 seconds after plugging USB receiver to computer.

**Note:** Wireless phone, routers and other devices that uses 2.4GHz frequency, might cause interference with wireless keyboard and mouse. Please relocate such wireless appliances away from your keyboard and mouse.

### FCC Caution.

This device complies with part 15 of the FCC Rules. Operation is subject to the following two conditions: (1) This device may not cause harmful interference, and (2) this device must accept any interference received, including interference that may cause undesired operation.

Any Changes or modifications not expressly approved by the party responsible for compliance could void the user's authority to operate the equipment.

**Note:** This equipment has been tested and found to comply with the limits for a Class B digital device, pursuant to part 15 of the FCC Rules. These limits are designed to provide reasonable protection against harmful interference in a residential installation. This equipment generates uses and can radiate radio frequency energy and, if not installed and used in accordance with the instructions, may cause harmful interference to radio communications. However, there is no guarantee that interference will not occur in a particular installation. If this equipment does cause harmful interference to radio or television reception, which can be determined by turning the equipment off and on, the user is encouraged to try to correct the interference by one or more of the following measures:

- Reorient or relocate the receiving antenna.
- Increase the separation between the equipment and receiver.
- Connect the equipment into an outlet on a circuit different from that to which the receiver is connected.
- Consult the dealer or an experienced radio/TV technician for help.

\* RF warning for Portable device:

The device has been evaluated to meet general RF exposure requirement. The device can be used in portable exposure condition without restriction.

WKB-1500GB-QG-English-090512-V1

英文