

# WAG KIT QUICK GUIDE

This Quick guide contains information regarding these devices.

1. Portable radio
2. Gateway
3. Wireless FingerPTT
4. Headset

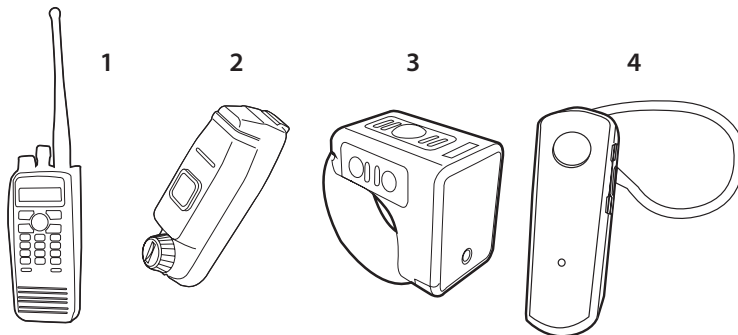

Turn off your radio.

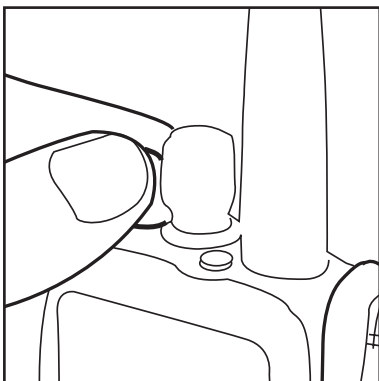

Take the Gateway and place the hook on the on top right side of the radio.

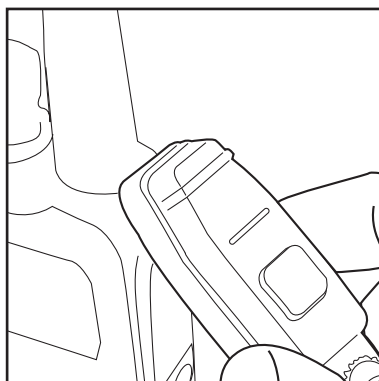

Place a screwdriver and turn clockwise to tighten the Gateway.

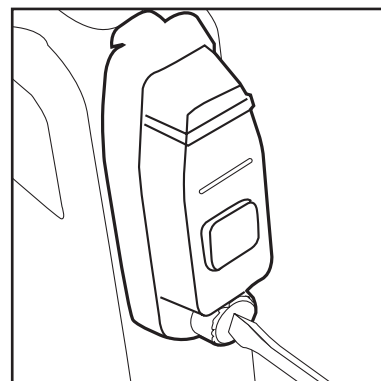

Push and hold the PTT button on the Gateway and then turn on your radio simultaneously.

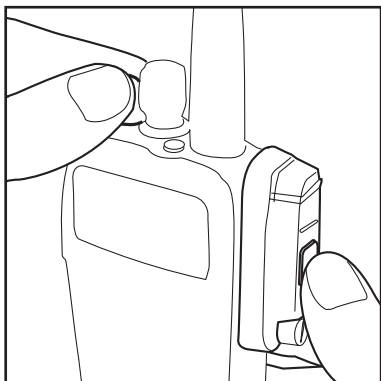

The LED indicator will light constant, when the LED flashes, its paired with your radio.

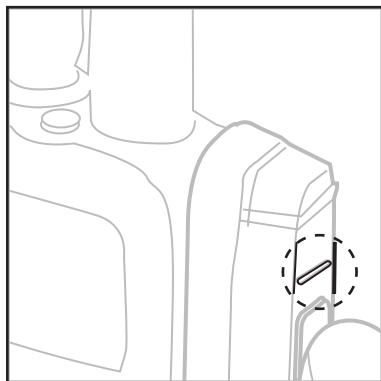

Take your Wireless FingerPTT and press and hold down both volume buttons for 5 seconds, until the LED flashes red 2 times.

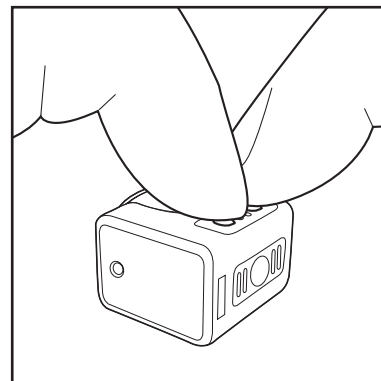

The LED on the FingerPTT is located on the inside.

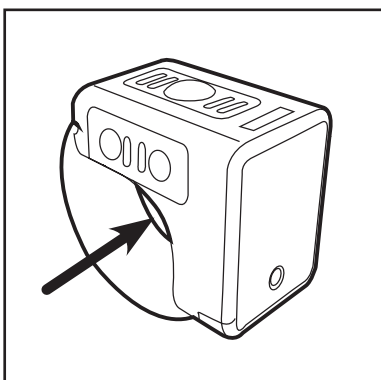

Press and hold the answer key for 6 seconds on your headset until the blue and red light flashes.

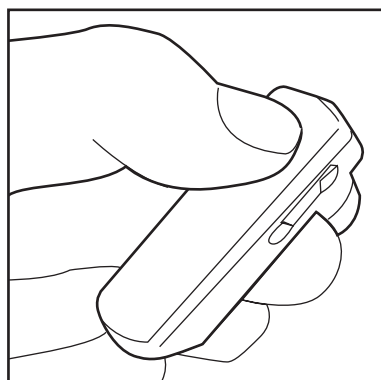

Turn your radio off and then on again, and now all the devices are paired.

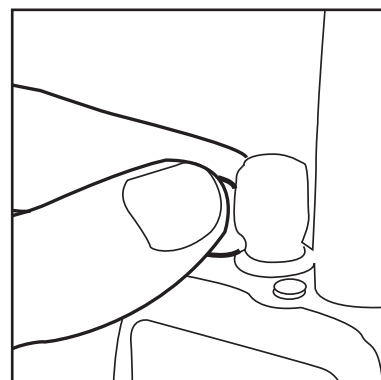

## **FCC WARNING**

This device complies with Part 15 of the FCC Rules. Operation is subject to the following two conditions:

- (1) This device may not cause harmful interference, and
- (2) this device must accept any interference received, including interference that may cause undesired operation.

NOTE 1: Any changes or modifications to this unit not expressly approved by the party responsible for compliance could void the user's authority to operate the equipment.