

TCL FLIP2

Quick Start Guide



At a glance

Let's get started. We'll guide you through startup and tell you where to find more information about your phone and its great features.

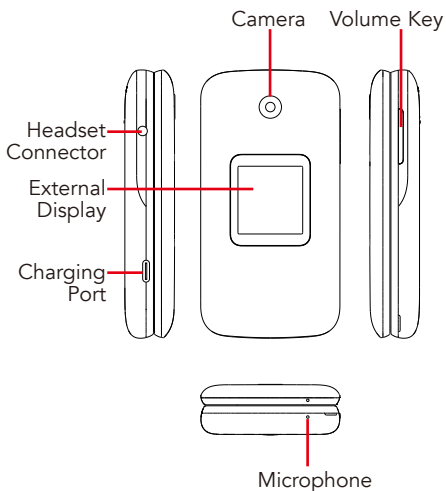

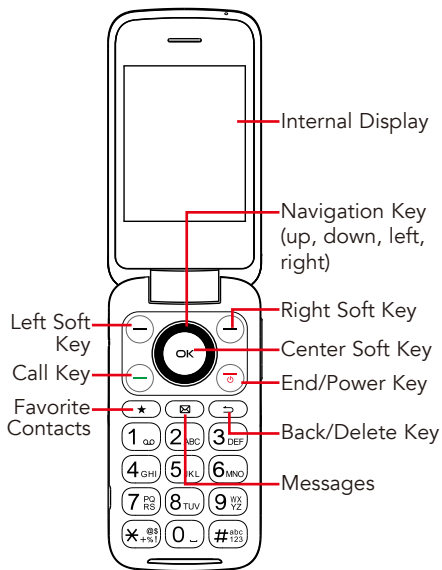

Left Soft Key

- Press: access Notifications



Right Soft Key

- Press: access Contacts



Center Soft Key

- Press: access app list (from the Home screen)
- Confirm an option from the middle of the bottom of the screen



Navigation Key

- Menu selection moves up, down, right, and left
- Press Left: access Applications
- Press Right: access Camera
- Press Up: access Ringtones & Alerts settings



Call Key

- Answer / make a call
- Press: enter call log (from the Home screen)



End/Power Key

- Press: end a call, return to the Home screen
- Press and hold: Restart or Power on/off



Back/Delete Key

- Move backwards through Menus
- Delete entered number or letter



Volume Keys

- In call mode, adjusts the earpiece or headset volume
- In Music/Video/Streaming mode, adjusts the media volume
- In general mode, adjusts the ringtone volume
- Mutes the ringtone of an incoming call

Set up your SIM/microSD card

The SIM (Subscriber Identity Module) card identifies your device to the wireless network. You can't make or receive phone calls without a properly installed SIM card unless it's an emergency call (911).

Power off the device before opening the back cover to install a Nano SIM card or a microSD card.

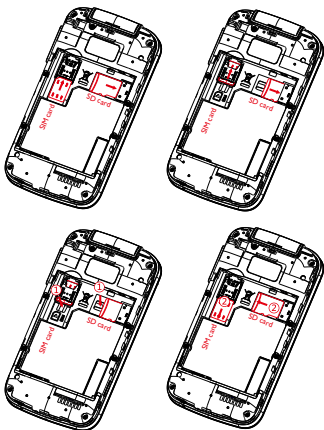

To remove the SIM card or microSD card, press down on the small plastic tab (①), then slide out the card(②). Do not use force or any sharp objects.



Your device only supports Nano SIM cards. To avoid damage to your device, do not attempt to insert any other SIM types.

Battery

To optimize battery performance, be sure to fully charge your device before using it for the first time.

Charging the device

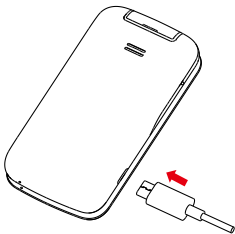







Insert the small end of the charging cable into the charge port as shown and connect the charger to a power outlet.



To reduce power consumption and energy waste, disconnect your charger when the battery is fully charged, and switch off Wi-Fi, Bluetooth and other wireless connections when they are not in use.

Optimize Battery Life

To optimize battery life, adjust your screen brightness and display timeout.

- 1. Adjusting brightness level:** Lowering your screen brightness level can optimize your battery level. To adjust the brightness level, from the Home screen, press the **Center Soft Key** , select **Settings**  > **Personalization** > **Display** > **Brightness**. To lower the brightness level, move the wheel to the left.
- 2. Power saving mode:** Power saving mode minimizes battery usage to extend battery life. To explore power management options, from the Home screen, press the **Center Soft Key** , select **Settings**  > **Device** > **Battery** > **Power saving mode**. Then select **ON** to activate.
- 3. Adjust screen timeout:** Sleep mode is a low power mode function and it significantly saves your battery power. Lower the amount of time your device stays on after you stop using it to optimize your battery level. To do so, from the Home screen, press the **Center Soft Key** , select **Settings**  > **Personalization** > **Display** > **Screen timeout** and select screen timeout duration.

Security & convenience

To protect your phone and privacy, you can lock the phone screen by creating a password.

- From the Home screen, press the **Center Soft Key** (OK) , select **Settings** (gear icon) , and then press the **Navigation Key** to select **Privacy & Security**.
- Press the **Center Soft Key** (OK) and select **On** to enable screen lock in the **Screen Lock** screen.
- Enter the passcode twice and press the **Right Soft Key** (Done) to create and enable password protection.

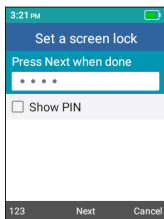

Useful apps

When you're up and running, try these apps to see what you can do with your new phone.

Find it: From the Home screen, press the **Center Soft Key**  to see all your apps.



Camera

Your phone is equipped with a camera and a camcorder for taking photos and shooting videos.



Browser

Using the Browser, you can enjoy surfing the Web.



E-Mail

With E-Mail, you can send and receive emails, manage emails by labels, archive them, etc.



Messages

You can create, edit, and receive SMS and MMS with this phone.



Settings

To access this function, press the **Center Soft Key**  from the Home screen and then touch Settings.

Note: Software updates happen frequently, so your phone may not have all listed apps or features.

Approved firmware versions

This device will only operate with firmware versions that have been approved for use by your wireless carrier and the device manufacturer. If unauthorized firmware is placed on the device it will not function.

Information about safeguarding handsets

We encourage customers to take appropriate measures to secure their devices and invite them to take advantage of the features available on this device to help secure it from theft and/or other unauthorized access and use. This device has a locking function (e.g., Security PINs) that can serve as a first line of defense against unauthorized use or access to stored information. Preloaded security applications that allow customers to track or locate misplaced devices can be found on several devices. Lost or stolen devices should be immediately reported to your wireless carrier so that proper measures can be taken to protect accounts. For additional information, visit your wireless carrier's Privacy Policy.

Emergency call

If your phone has network coverage, dial the emergency number and press the **Call Key**  to make an emergency call. This works even without a SIM card and without typing the PIN code.

Although all phones are equipped with 9-1-1 emergency calling, this phone may or may not permit its location to be approximated during a 9-1-1 call. Be prepared to report your location when dialing 911*.

* Availability of this feature depends on upgrades to the (a) wireless network and (b) 9-1-1 calling system that are required to be installed by the local 9-1-1 response agency or public safety answering point (PSAP); these upgrades may not be available everywhere within our wireless coverage area or your roaming area. This approximation of the phone's location and the transmittal of location information are subject to emergency situations, transmission limits, network problems/limitations, interconnecting carrier problems, your phone, buildings/tunnels, signal strength and atmospheric/topographical conditions, and may be curtailed, interrupted, dropped, or refused. The phone's approximate location is transmitted to the local 9-1-1 response agency or PSAP while the call is in progress;

this approximation is intended solely to aid the PSAP in dispatching emergency assistance or to limit the search area for emergency services personnel.

You should not rely solely on a mobile phone for essential communications (such as a medical or other emergency). Please see your wireless carrier's Terms and Conditions, and Privacy Policy for additional service restrictions and details.

Additional information

Use of some content or features may require qualifying service, or access to a Wi-Fi connection.

TCL Communication Technology Holdings Limited reserves the right to alter material or technical specification without prior notice.

TCL is a registered trademark of TCL Technology Group Corporation ©2022
TCL Technology Group Corporation.

English - CJB69C0TBAAA

Printed in China