

alcatel 1v

QUICK START GUIDE

SAVE
PAPER
SAVE
TREES

PLEASE CONSIDER THE
ENVIRONMENT BEFORE PRINTING
us.alcatelmob.com



English - CJB2EN0ALAAA
Printed in China

5007A

Your Mobile

Keys and connectors



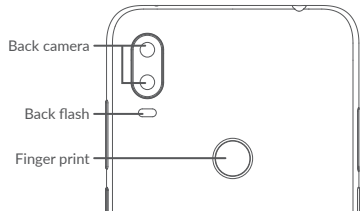

Getting started

- ① Charge the battery
- ② Insert or remove the microSD card.
- ③ Insert or remove the SIM card.

Single-SIM

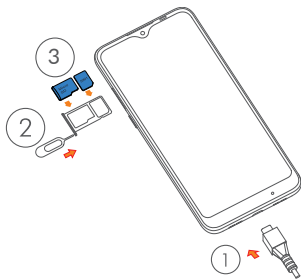

2

Dual-SIM

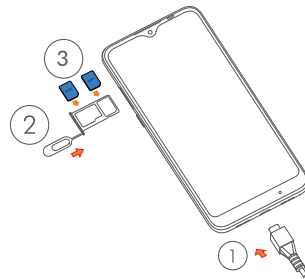

3

Home screen

You can bring all of the items (applications, shortcuts, folders) that you use most frequently to your Home screen for quick access.

Touching the **Home** button always takes you back to the main Home screen.

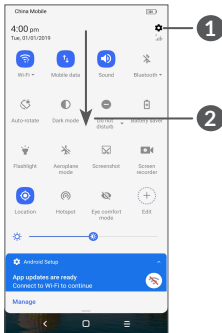

- 1: Tap to access the complete Settings menu.
- 2: With the notification panel open, tap the top of the screen again and drag down to see the Quick Settings menu.

Phone call

Making a call

Enter the desired number from the keyboard and touch  to make a call.

Answering a call

When you receive a call, swipe right  to answer or swipe left  to reject:

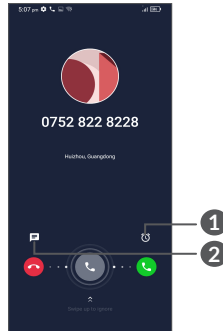

- 1: Reject by Alarm
- 2: Reject by SMS

Contacts

You can view and create contacts on your phone and synchronize these with your Gmail contacts or other applications on the web or on your phone.

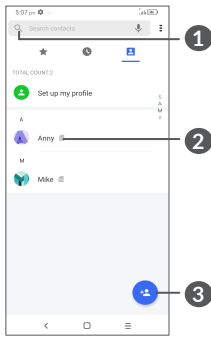

- 1 : Search in **Contacts**
- 2 : Open the Quick contact panel
Long press to select contact(s) to delete
- 3 : Add new contact

Messaging

You can create, edit, and receive SMS and MMS.

An SMS will be converted to MMS automatically when media files (image, video, audio, slides, etc.) are attached or subject or email addresses are added.

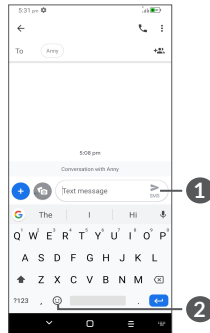

- 1 : Send the text message
- 2 : Insert emoticons

Gmail

The first time you set up your phone, you can select to use an existing Gmail account or to create a new one.

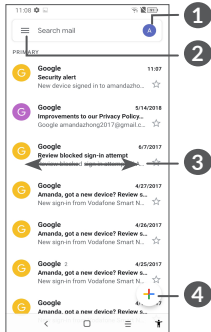

- 1 : Account information
- 2 : See options and settings
- 3 : Swipe left or right to archive the email
- 4 : Create an email

Help

To get help:

- **View user manual and FAQ**
www.alcatelmobile.com
- **Update your phone's software**
Go to **Settings > System > System updates** to check software updates.
- **Back up your personal data**
Go to **Settings > System > Backup > Backup up to Google Drive** and turn it on.
- **Reset your phone**
Go to **Settings > System > Reset > Factory data reset**, and then touch to reset your phone.

Support

1. Enter from your Smartphone / Tablet to the application: Support Center
2. Check our frequently asked questions or chat with us through <https://www.alcatelmobile.com> in the Support section.
3. Call the Call Center Locate your number, below:

Argentina: 8004447361

Australia: 1800218730

Canada: 8558446058

Chile: 12300209025

Colombia: 18005183882

Ecuador: 800000635

Mexico: 8001124682

New Zealand: 0800451708

Peru: 80055639

Rep. Dominicana: 18002039552

Uruguay: 40190752

USA: 18553680829

Venezuela: 8001362017