

Hi! Let's get started.

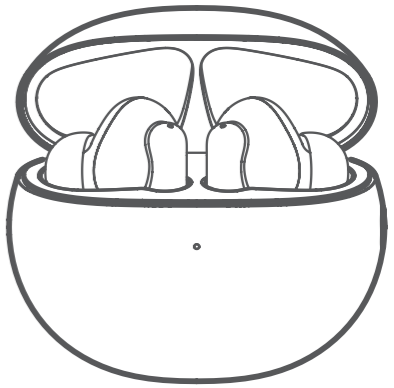

TCL MOVEAUDIO S600 TW30  
Quick start guide  
Guide de démarrage rapide  
Guía rápida

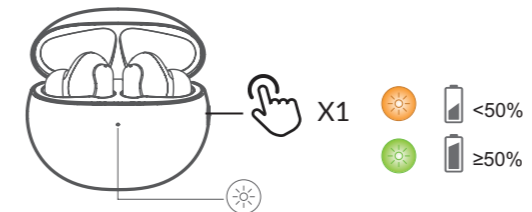

9. Reset  
Réinitialiser  
Restablecer

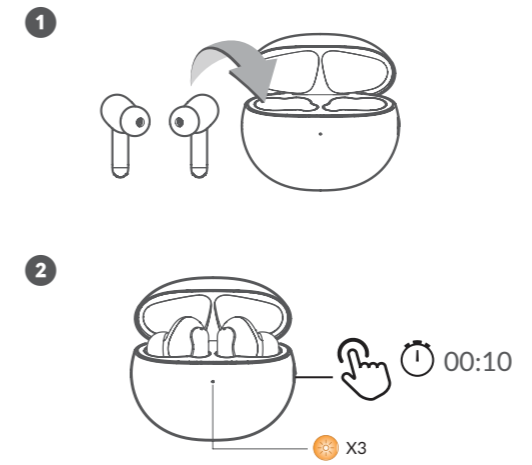

8. LED Lights Indications  
Indications des lumières LED  
Indicaciones de luces LED

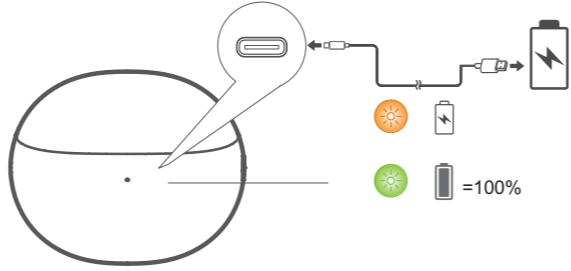

The LED light indicates the charge of the earbuds when you put in or take out the buds. When pressing the button or opening/closing the lid will indicate charge remaining in the case  
Le voyant LED indique la charge des écouteurs lorsque vous insérez ou retirez les écouteurs. En appuyant sur le bouton ou en ouvrant / fermant le couvercle indiquera la charge restante dans le boîtier  
La luz LED indica la carga de los auriculares cuando los coloca o los saca. Al presionar el botón o abrir / cerrar la tapa indicará carga restante en el estuche

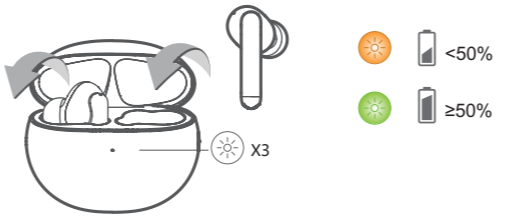

7. Charging  
Batterie en charge  
Cargando

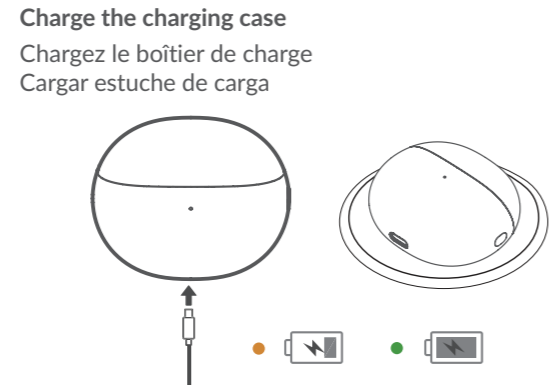
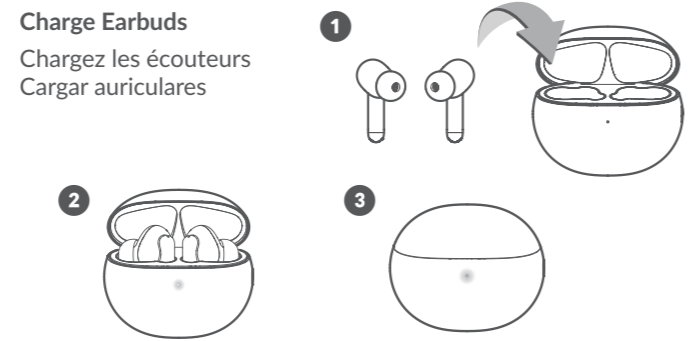

To charge the charging case, use a Type-C charger, or place it on a compatible wireless charger with the bottom facing up.  
Pour charger le boîtier de chargement, utilisez un chargeur de type C ou placez-le sur un chargeur sans fil compatible, le bas vers le haut.  
Para cargar la caja de carga, utilice un cargador tipo C o colóquela en un cargador inalámbrico compatible con la parte inferior apuntando hacia arriba.

5. Default gestures  
Gestes par défaut  
Gestor predeterminados

- Google assistant**  
Assistant Google  
Asistente de Google
- Say "Hey Google" to activate Google assistant  
Dites « Hey Google » pour activer l'assistant Google  
Diga "Hola Google" para activar el Asistente de Google.
- X1 **Stop google assistant**  
Arrêtez l'assistant Google  
Detenga el Asistente de Google.
- X2 **Listen to notification**  
Écoutez la notification  
Escuche la notificación.
- Press and hold to talk to your Google assistant**  
Maintenez la touche enfoncée pour parler à votre assistant Google  
Pulse y mantenga pulsado para hablar al Asistente de Google.

6. Wearing Instruction  
Instruction de port  
Instrucciones de uso

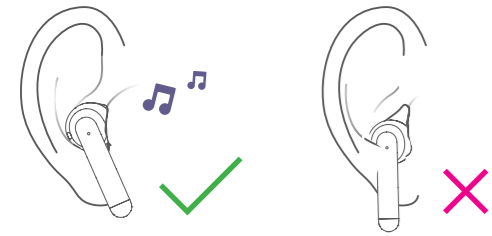

## 1. What's in the box

Contenu de l'emballage  
Elementos incluidos

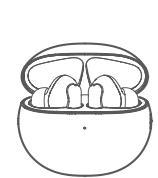

**Charging Case & Earbuds**  
Boîtier de charge et écouteurs  
Estuche de carga y auriculares

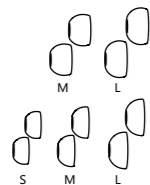

**Ear tips**  
Bouts d'oreille  
Consejos para los oídos



**Quick start guide**  
Guide de démarrage rapide  
Guía rápida

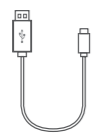

**USB cable**  
Câble de connexion USB  
Cable USB

## 2. Changing the ear tips

Changer les embouts auriculaires  
Cargar los auriculares

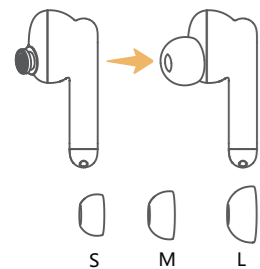

**Switch ear tips based on desired noise cancellation effects and comfort level.**

Changez d'embout en fonction des effets de suppression du bruit et du niveau de confort souhaités.

Intercambie los cabezales en función de los efectos de cancelación de ruido y el nivel de comodidad que desee.

## 3. Pairing

Couplage  
Sincronización

### Google Fast Pair

Couplage rapide Google Fast Pair  
Google Fast Pair

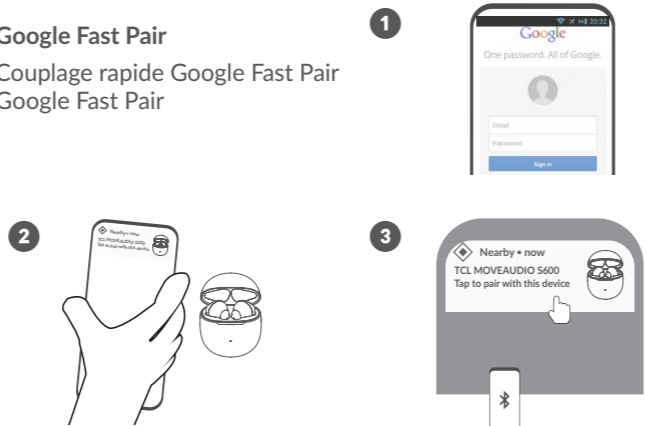

### Manual Pairing

Couplage manuel  
Sincronización manual

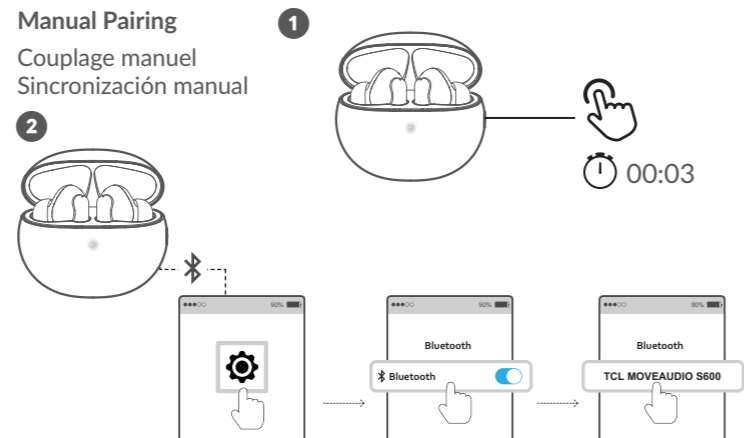

## 4. Download and install app

Télécharger et installer l'application  
Descargar e instalar la aplicación

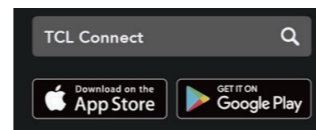

Android 5.0 and above  
iOS 10.0 and above

To adjust the noise control features, customize earphone functions, or perform a firmware update, please scan the QR code or search "TCL Connect" to download the app and add TW30 to the device list in the app.

Pour régler les fonctions de contrôle du bruit, personnaliser les fonctions des écouteurs ou effectuer une mise à jour du micrologiciel, scannez le code QR ou cherchez "TCL Connect" pour télécharger l'application et ajouter le TW30 à la liste des appareils dans l'application.

Para ajustar las funciones de control de ruido, personalice las funciones de los auriculares o realice una actualización del firmware, escanee el código QR o busque "TCL Connect" para descargar la aplicación y añadir TW30 a la lista de dispositivos de la aplicación.

## 5. Default gestures

Gestes par défaut  
Gestor predeterminados

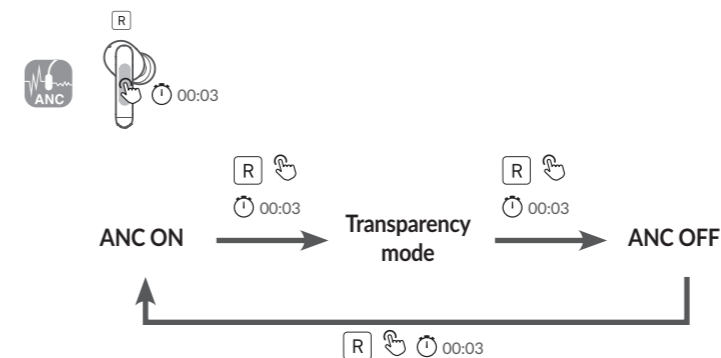
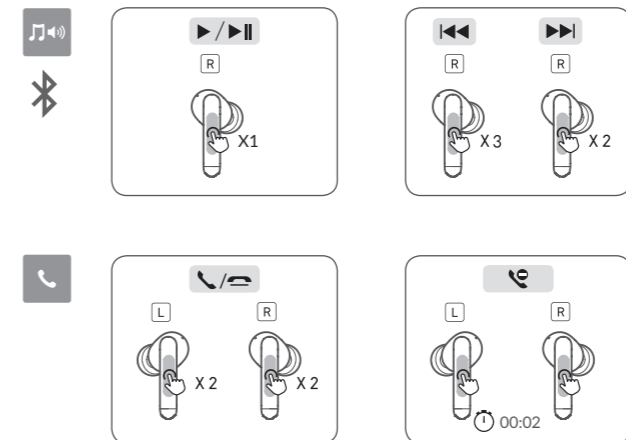

For the full user manual in all languages or for help visit: [www.tcl.com](http://www.tcl.com)  
2020 © TCL Communication Ltd. All rights reserved.  
Bluetooth headset works with any Bluetooth enabled phone or device.  
The Bluetooth word mark and logos are registered trademarks owned by Bluetooth SIG, Inc. and any use of such marks by TCL Communication Ltd. is under license. Other trademarks and trade names are those of their respective owners.

**FCC Supplier's Declaration of Conformity**  
Brand name / model number: TCL/TW30  
This device complies with part 15 of the FCC Rules. Operation is subject to the following two conditions:  
(1) This device may not cause harmful interference, and (2) this device must accept any interference received, including interference that may cause undesired operation.  
Suppliers Name: TCT Mobile, Inc.  
Suppliers Address (USA): TCT Mobile, Inc., 25 Edelman Suite #200, Irvine, CA 92618  
Website: [www.tcl.com](http://www.tcl.com)

**FCC rule**  
This equipment has been tested and found to comply with the limits for a Class B digital device pursuant to part 15 of the FCC Rules. These limits are designed to provide reasonable protection against harmful interference in a residential installation. This equipment generates, uses and can radiate radio frequency energy and, if not installed and used in accordance with the instructions, may cause harmful interference to radio communications. However, there is no guarantee that interference to radio or television reception, which can be determined by turning the equipment off and on, the user is encouraged to try to correct the interference by one or more of the following measures:

- Reorient or relocate the receiving antenna.
- Increase the separation between the equipment and receiver.
- Connect the equipment into an outlet on a circuit different from that to which the receiver is connected.
- Consult the dealer or an experienced radio/ TV technician for help.

Caution: The user is cautioned that changes or modifications not expressly approved by the party responsible for compliance could void the user's authority to operate the equipment.  
The earbuds may be damaged if not charged for 2 months.

**WARNING: Cancer and Reproductive Harm - [www.P65Warnings.ca.gov](http://www.P65Warnings.ca.gov)**

Pour obtenir le manuel d'utilisation complet dans toutes les langues ou pour obtenir de l'aide, consultez le site [www.tcl.com](http://www.tcl.com)  
2020 © TCL Communication Ltd. Tous droits réservés.  
Casque Bluetooth fonctionnant avec tout téléphone ou appareil Bluetooth.  
Les écouteurs peuvent être endommagés s'ils ne sont pas chargés pendant 2 mois.

**ADVERTENCIA: cáncer y daños reproductivos - [www.P65Warnings.ca.gov](http://www.P65Warnings.ca.gov)**

Para consultar el manual de usuario completo en todos los idiomas o para obtener ayuda, visite [www.tcl.com](http://www.tcl.com)  
2020 © TCL Communication Ltd. Todos los derechos reservados.  
Los auriculares podrían dañarse si no se cargan en 2 meses.

**AVERTISSEMENT: Cancer et troubles de la reproduction - [www.P65Warnings.ca.gov](http://www.P65Warnings.ca.gov)**

Left earphone: FCC ID: 2ACCJB144  
IC: 9238A-0108  
HVIN: TW30L  
Right earphone: FCC ID: 2ACCJB145  
IC: 9238A-0109  
HVIN: TW30R

CAN ICES-3(B)/NMB-3(B)

