

Hi! Let's get started.

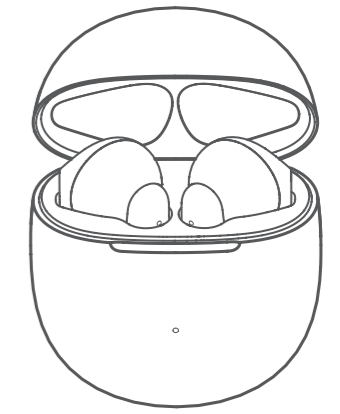

TCL MOVEAUDIO S200 TW20

Quick start guide
Guide de démarrage rapide
Guía rápida



9. Reset
Réinitialiser
Restablecer

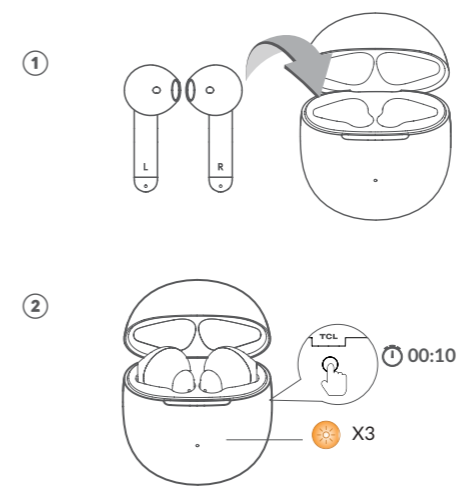

8. LED Lights Indications
Indications des lumières LED
Indicaciones de luces LED

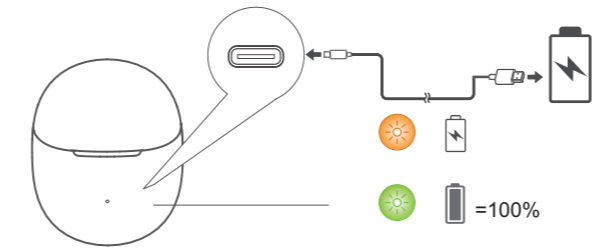

The LED light indicates the charge of the earbuds when you put in or take out the buds. When pressing the button or opening/closing the lid will indicate charge remaining in the case

Le voyant LED indique la charge des écouteurs lorsque vous insérez ou retirez les écouteurs. En appuyant sur le bouton ou en ouvrant / fermant le couvercle indiquera la charge restante dans le boîtier

La luz LED indica la carga de los auriculares cuando los coloca o los saca. Al presionar el botón o abrir / cerrar la tapa indicará carga restante en el estuche

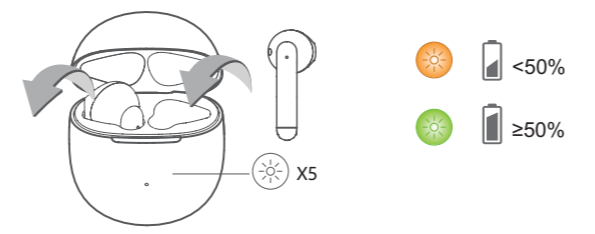

7. Touch Control
Contrôle tactile
Control táctil

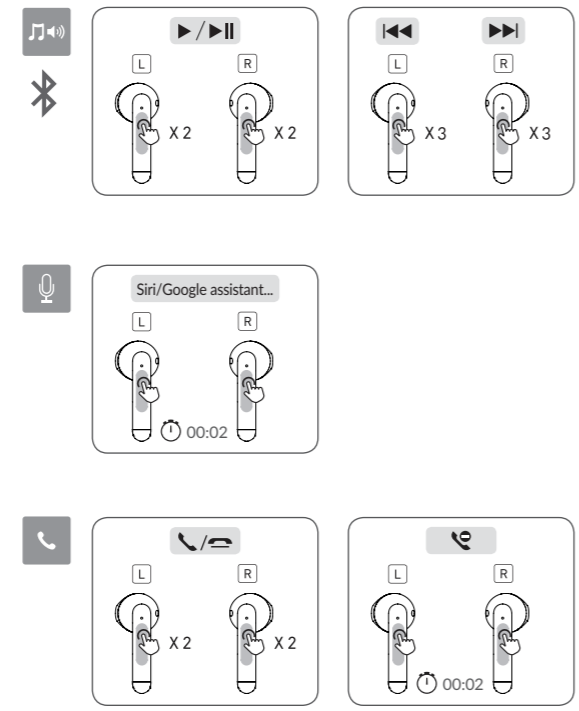

6. Charging
Batterie en charge
Cargando

Charge Earbuds
Chargez les écouteurs
Cargar auriculares

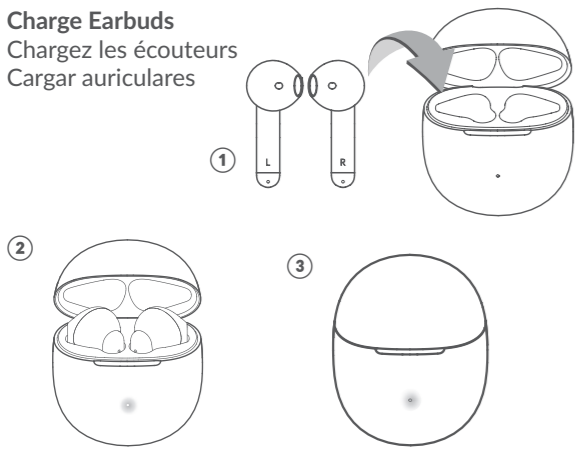

Charge Charging Case
Chargez le boîtier
Cargando el estuche

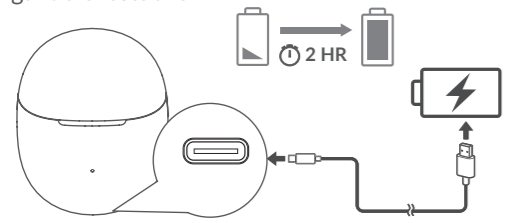

1. What's in the box

Contenu de l'emballage
Elementos incluidos

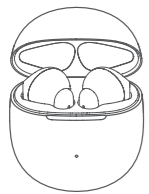

Charging Case & Earbuds

Boîtier de charge et écouteurs
Estuche de carga y auriculares



Quick start guide

Guide de démarrage rapide
Instructivo de uso

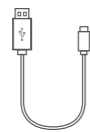

USB cable

Câble de connexion USB
Cable USB

2. Activation

Activation
Activación

①

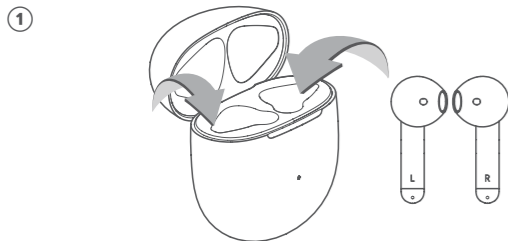

2. Activation

Activation
Activación

②

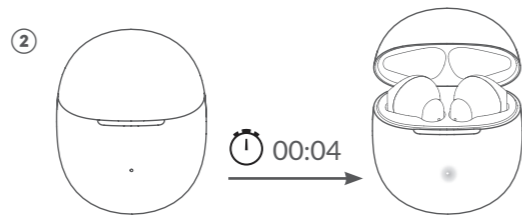

If earbuds cannot be activated successfully. Please charge it for a while and then repeat the activation process again.

Si les écouteurs ne peuvent pas être activés correctement. Veuillez le charger pendant un certain temps, puis recommencez le processus d'activation.

En caso de no poder activar los auriculares. Carguelos durante unos minutos y vuelva a repetir el proceso de activación.

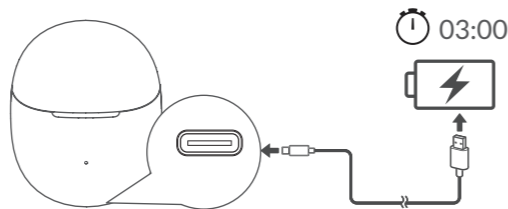

3. Pairing

Couplage
Sincronización

Google Fast Pair

Couplage rapide Google
Emparejamiento rápido de Google

①



②



Manual Pairing

Couplage manuel
Sincronización manual



4. Wearing Instruction

Instruction de port
Instrucciones de uso

Place the earbuds in a forward and down position.

Placez les écouteurs en position avant et vers le bas.

Coloque los auriculares en la posición hacia adelante y hacia abajo.

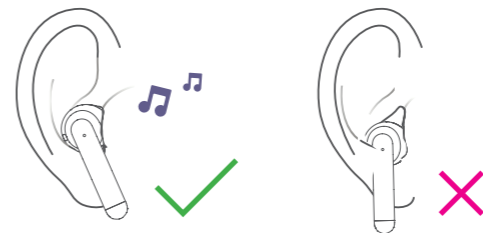

5. Connect to other devices

Établir une connexion avec autres appareils
Conexión a otros dispositivos

①



②

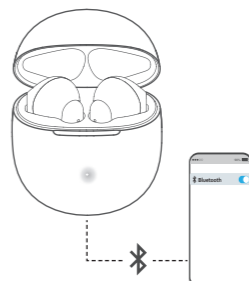

For the full user manual in all languages or for help visit: www.tcl.com

2020 © TCL Communication Ltd. All rights reserved.

Bluetooth headset works with any Bluetooth enabled phone or device.

The Bluetooth word mark and logos are registered trademarks owned by Bluetooth SIG, Inc. and any use of such marks by TCL Communication Ltd. is under license.

Other trademarks and trade names are those of their respective owners.

Other trademarks and trade names are those of their respective owners.

FCC Supplier's Declaration of Conformity

Brand name / model number: TCL/TW20

This device complies with part 15 of the FCC Rules. Operation is subject to the following two conditions: (1) This device may not cause harmful interference, and (2) this device must accept any interference received, including interference that may cause undesired operation.

Suppliers Name: TCT Mobile, Inc.

Suppliers Address (USA): TCT Mobile, Inc., 25 Edelman Suite #200, Irvine, CA 92618

Website: www.tcl.com

FCC rule

This equipment has been tested and found to comply with the limits for a Class B digital device pursuant to part 15 of the FCC Rules. These limits are designed to provide reasonable protection against harmful interference in a residential installation. This equipment generates, uses and can radiate radio frequency energy and, if not installed and used in accordance with the instructions, may cause harmful interference to radio communications. However, there is no guarantee that interference to radio or television reception, which can be determined by turning the equipment off and on, the user is encouraged to try to correct the interference by one or more of the following measures:

- Reorient or relocate the receiving antenna.
 - Increase the separation between the equipment and receiver.
 - Connect the equipment into an outlet on a circuit different from that to which the receiver is connected.
 - Consult the dealer or an experienced radio/ TV technician for help.
- Caution: The user is cautioned that changes or modifications not expressly approved by the party responsible for compliance could void the user's authority to operate the equipment.

The earbuds may be damaged if not charged for 2 months.

Pour obtenir le manuel d'utilisation complet dans toutes les langues ou pour obtenir de l'aide, consultez le site www.tcl.com

2020 © TCL Communication Ltd. Tous droits réservés.

Casque Bluetooth fonctionnant avec tout téléphone ou appareil Bluetooth.

Les écouteurs peuvent être endommagés s'ils ne sont pas chargés pendant 2 mois.

Para consultar el manual de usuario completo en todos los idiomas o para obtener ayuda, visite www.tcl.com

2020 © TCL Communication Ltd. Todos los derechos reservados.

Los auriculares podrían dañarse si no se cargan en 2 meses.

Left earphone:
FCC ID: 2ACCB136
IC: 9238A-0103
HVIN: TW20L

Right earphone:
FCC ID: 2ACCB137
IC: 9238A-0104
HVIN: TW20R

CAN ICES-3(B)/NMB-3(B)

