7.85" Rugged Android™ Handheld Device with Quad-core Processor

User Manual 使用手冊



Federal Communications Commission (FCC) Statement

15.21

You are cautioned that changes or modifications not expressly approved by the part responsible for compliance could void the user's authority to operate the equipment.

15.105(b)

This equipment has been tested and found to comply with the limits for a Class B digital device, pursuant to part 15 of the FCC rules. These limits are designed to provide reasonable protection against harmful interference in a residential installation. This equipment generates, uses and can radiate radio frequency energy and, if not installed and used in accordance with the instructions, may cause harmful interference to radio communications. However, there is no guarantee that interference will not occur in a particular installation. If this equipment does cause harmful interference to radio or television reception, which can be determined by turning the equipment off and on, the user is encouraged to try to correct the interference by one or more of the following measures:

- Reorient or relocate the receiving antenna.
- Increase the separation between the equipment and receiver.
- Connect the equipment into an outlet on a circuit different from that to which the receiver is connected.
- Consult the dealer or an experienced radio/TV technician for help.

This device complies with Part 15 of the FCC Rules. Operation is subject to the following two conditions:

- 1) this device may not cause harmful interference and
- 2) this device must accept any interference received, including interference that may cause undesired operation of the device.

This transmitter must not be co-located or operating in conjunction with any other antenna or transmitter.

Radiation Exposure Statement:

This device meets the government's requirements for exposure to radio waves.

This device is designed and manufactured not to exceed the emission limits for exposure to radio frequency (RF) energy set by the Federal Communications Commission of the U.S. Government.

The exposure standard for wireless device employs a unit of measurement known as the Specific Absorption Rate, or SAR. The SAR limit set by the FCC is 1.6W/kg. *Tests for SAR are conducted using standard operating positions accepted by the FCC with the device transmitting at its highest certified power level in all tested frequency bands.

Note: The country code selection is for non-US model only and is not available to all US model. Per FCC regulation, all WiFi product marketed

Copyright Notice

This document contains proprietary information protected by copyright. All rights are reserved. No part of this manual may be reproduced by any mechanical, electronic, or other means in any form without prior written permission of the manufacturer.

Disclaimer

The information in this document is subject to change without prior notice in order to improve the reliability, design and function. It does not represent a commitment on the part of the manufacturer.

Under no circumstances will the manufacturer be liable for any direct, indirect, special, incidental, or consequential damages arising from the use or inability to use the product or documentation, even if advised of the possibility of such damages.

Open Your Box

- ▶ Rugged Android™ Handheld Device
- ▶ Rechargeable Li-ion Battery Pack (Pre-installed)
- ▶ Standard USB Cable
- ▶ Universal Power Adapter
- ▶ Earphone
- ▶ User Manual

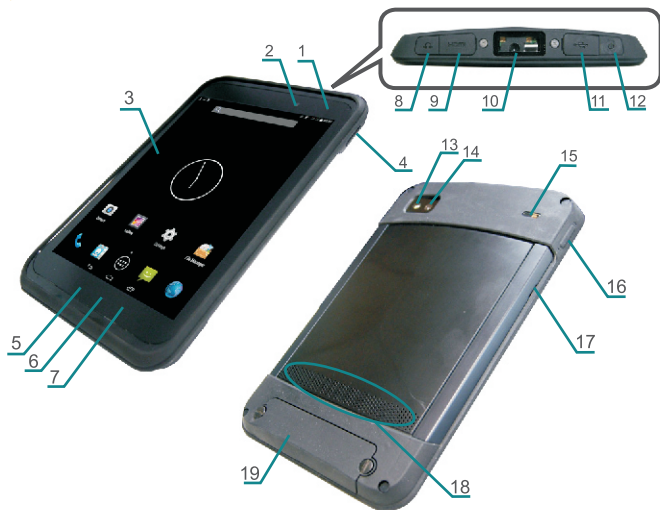

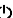
- | | | | |
|----|--------------------------------|----|---|
| 1 | Light sensor | 11 | USB connector with rubber cover |
| 2 | Front camera | 12 | Power key  |
| 3 | Touch screen | | * Press-and-hold this key to power on/off the device. |
| 4 | Scan key | | * Press this key to turn on/off the display. |
| 5 | (OS) Back button | 13 | LED flash |
| 6 | (OS) Home button | 14 | Rear camera |
| 7 | (OS) Menu button | 15 | IR (option) |
| 8 | Headset jack with rubber cover | 16 | Volume rocker |
| 9 | HDMI jack with rubber cover | 17 | Dual-SIM and microSD Card slot chamber |
| 10 | Barcode Scanner (option) | 18 | Speaker |
| | | 19 | Battery chamber |

Access Battery Chamber

Retaining screws

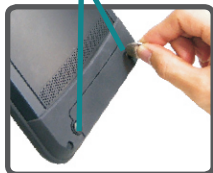

Step 1:
Loosen the retaining screws on the battery cover with a coin.



Battery cover notch

Step 2:
Remove the battery cover using the notch located on the bottom edge.

Protective lid



Step 3:
The battery is in a compartment inside. Its opening is covered by a protective lid. Insert the tip of your finger onto the top of the cover and remove it.



Step 4:
Then you can remove the battery from the chamber.



Install Main Battery

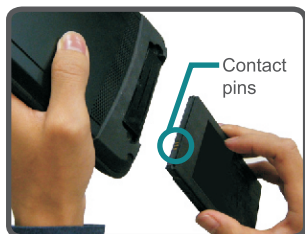

Step 1:

To install the battery, orient the battery so that the contact pins faces towards the compartment opening.



Step 2:

Slide the battery into the battery chamber.



Step 3:

To restore the protective lid, make sure the lid is oriented as shown above.



Step 4:

Align the top edge of the lid with the top of the opening.

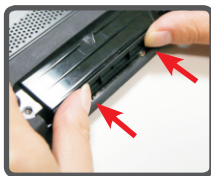

Step 5:

Press the lid firmly into place to ensure it is firmly secured.



Step 6:

Replace the battery cover and secure the retaining screws with a coin.

Install SIM & microSD Cards



Step 1:
Locate the notch on the Dual-SIM & microSD card slot cover.



Step 2:
Insert the tip of your finger into the notch on cover to lift and remove the cover.



Step 3:
Remove the lids to expose the Dual-SIM & microSD card slots.

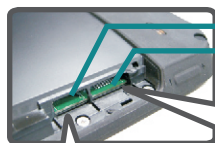

microSD card slot
Double-stacked SIM card slots

This symbol indicates the orientation of the of the microSD card.

This symbol indicates the orientation of the SIM Card.

Step 4: Orient the SIM cards and microSD card as indicated.

Step 5: Insert the SIM cards and microSD Card into the slots.

Step 6: Restore the SIM & microSD card lids and slot cover.

Charging & Data Connection

Step 1:

Connect the USB cable to the device.



Charging

Data Connection

Step 2:

Plug the power adapter to a power outlet.

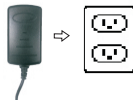

Step 2:

Plug the USB connector to a USB port on another computer.



打開包裝盒

- ▶ 強固式Android™手持裝置
- ▶ 抽換式鋰電池
- ▶ 標準USB傳輸/充電線
- ▶ 充電器
- ▶ 耳機
- ▶ 使用手冊

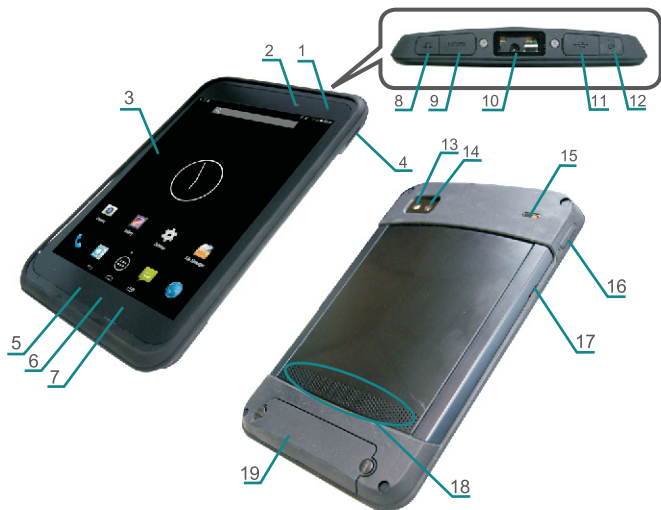

- | | |
|-----------------|--|
| 1 亮度感測器 | 11 USB插孔 (含保護蓋) |
| 2 前置相機 | 12 電源鍵  |
| 3 觸控螢幕 | * 長按關閉/開啟裝置 |
| 4 條碼掃描鍵 | * 按一下關閉/開啟螢幕 |
| 5 (系統) 返回鍵 | 13 LED 閃光燈 |
| 6 (系統) 主螢幕鍵 | 14 後置相機 |
| 7 (系統) 功能鍵 | 15 紅外線 (選配) |
| 8 耳麥插孔 (含保護蓋) | 16 音量鍵 |
| 9 HDMI插孔 (含保護蓋) | 17 雙SIM卡及microSD卡插槽 (外蓋內) |
| 10 條碼掃描器 (選配) | 18 喇叭 |
| | 19 電池盒外蓋 |

電池蓋開啟方式

電池外蓋螺絲



步驟 1:
用硬幣來旋鬆螺絲。



步驟 2:
利用電池盒外蓋底部的小凹槽，將外蓋撥開。

護蓋



步驟 3:
電池安裝於電池盒中，電池盒開口有一個護蓋，以手指插入護蓋上方，將蓋子撥開。



步驟 4:
將電池取出。



安裝電池

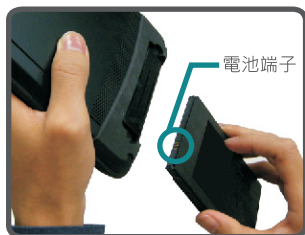

步驟 1:
安裝電池前，依上圖所示，將電池端子朝向電池盒開口。



步驟 2:
將電池妥善置入。

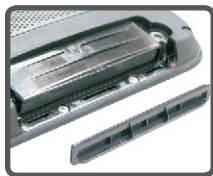

步驟 3:
裝回電池盒護蓋前，確定護蓋的方向如上圖所示。



步驟 4:
將護蓋上緣先對齊開口上緣。



步驟 5:
略為施力將護蓋裝回，確認護蓋已密合蓋上。



步驟 6:
裝回電池盒外蓋，然後用硬幣旋緊螺絲。

安裝SIM卡及microSD記憶卡



步驟 1:
找到SIM/microSD卡外蓋
上的凹槽。



步驟 2:
用手指插入凹槽，將外蓋
扳起後拆開。



步驟 3:
打開SIM/microSD卡的保
護蓋。

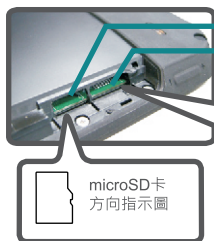

microSD卡插槽
雙SIM卡插槽



步驟 4: 依照所指示方向將
SIM/microSD卡對準插槽。

步驟 5: 將SIM/microSD卡
插入。

步驟 6: 裝回SIM/microSD卡的保護蓋，然後裝上外
蓋。

充電及資料傳輸

步驟 1:
將USB線插入裝置
的USB插孔。



充電

資料傳輸

步驟 2:
將充電器插入
電源插座。

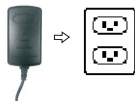

步驟 2:
將USB線插入電腦
的USB插槽。



NCC警語：

根據NCC低功率電波輻射性電機管理辦法 規定：第十二條 經型式認證合格之低功率射頻電機，非經許可，公司、商號或使用者均不得擅自變更頻率、加大功率或變更原設計之特性及功能。

第十四條 低功率射頻電機之使用不得影響飛航安全及干擾合法通信；經發現有干擾現象時，應立即停用，並改善至無干擾時方得繼續使用。

前項合法通信，指依電信法規定作業之無線電通信。低功率射頻電機須忍受合法通信或工業、科學及醫療用電波輻射性電機設備之干擾。

「減少電磁波影響，請妥適使用」。

「EMC品質符合CNS13438限制值，充電線組限用原廠含鐵粉芯、1米長之隔離線_USB Cable」。

本手冊適用產品型號：

GT78XX

產品規格

產品額定電壓 / Rating Voltage: D.C. 5V

產品額定電流 / Rating Current: 2A

充電溫度範圍 / Charge temp.: 0~45°C

維修及保固：

- 1.產品序號及IMEI碼在打開電池蓋位置，電池蓋開啟請參考第2頁
- 2.產品固障維修請連絡當地經銷商，私自拆裝機台造成產品損壞將不予保固

請注意以下要求!!

- 1.請更換相同型號之電池以免產生爆炸的風險
- 2.使用過之廢電池請依當地政府單位要求處理
- 3.不得拆解、開啟、短路或撕裂二次單電池或電池組
- 4.不得使單電池或電池組曝露於熱或火源。避免存放在陽光直射處。
- 5.當單電池發生洩漏時，不得使液態電解質接觸皮膚或眼睛。
不慎接觸時請以大量清水清洗換部並尋求醫療協助。
- 6.不得使用任何非設計搭配設備使用支單電池或電池組。
- 7.二次單電池與電池組需於使用前充電。務必使用正確之充電器並依設備之使用

CAUTION:

1. RISK OF EXPLOSION IF BATTERY IS REPLACED BY AN INCORRECT TYPE.
2. DISPOSE OF USED BATTERIES ACCORDING TO THE INSTRUCTIONS

To prevent possible hearing damage, do not listen at high volume levels for long periods.

