

Part no.	#D80549003(SC) IM	Prepared by	Wendy Kwok
Packaging Dimension	148(L) x 210(H) mm (A5) single-sided print	Checked by	
Coating	N/A	Approved by	
Packaging Color	K	Remarks	DI-Std (new remote version)
Language	English		
Date	2020/12/03		

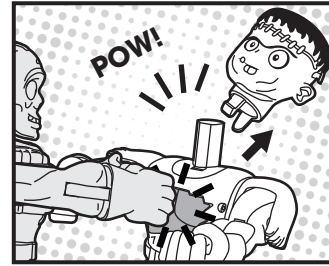

3+
YEARS

Activate your fighter(s):

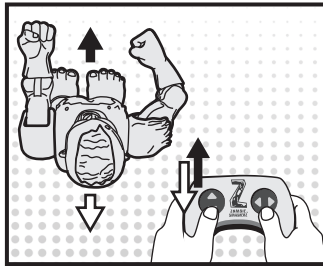
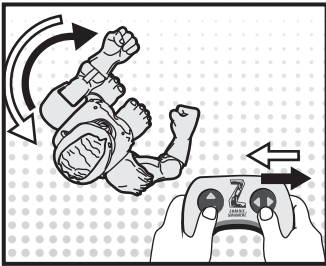
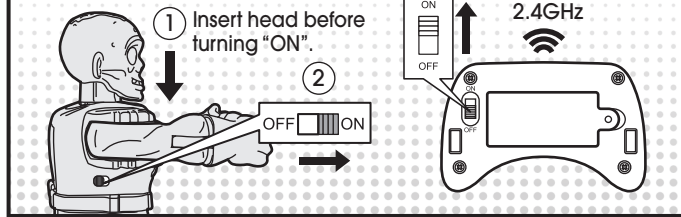

Single Player Mode: Activate the 2nd fighter to play alone.

① Turn "ON" before inserting head. ③ Fighter will move and fight on it's own!

② Then insert the head to activate.

**** It will stop automatically after 3 minutes. To start again, repeat the above procedure.**

NOTE:

- Adjust the fighters before use to make sure both feet have good contact with the ground. Play on a hard, flat surface for best performance.
- This product will automatically shut down if not played with for 3 minutes. To reset the product, flip the switch to the OFF position and then back to the ON position.**
- Maximum operated distance is appx. 26.3 feet / 8 m with new alkaline batteries.

IMPORTANT: Use alkaline batteries for best performance. Always make sure batteries are fresh. When batteries are low, the unit may not function properly.

Product & colors may vary from those pictured. Assembly required, adult supervision is recommended.

Keep packaging and instruction manual for reference as these contain important information.

MADE IN CHINA, ZHONGSHAN - GUANGDONG

FREE APP FOR EXTRA FUN!



Caution: changes or modification not expressly approved by the party responsible for compliance could void the user's authority to operate the equipment.

NOTE: This equipment has been tested and found to comply with the limits for a Class B digital device, pursuant to Part 15 of the FCC Rules. These limits are designed to provide reasonable protection against harmful interference in a residential installation. This equipment generates, uses and can radiate radio frequency energy and, if not installed and used in accordance with the instructions, may cause harmful interference to radio communications. However, there is no guarantee that interference will not occur in a particular installation. If this equipment does cause harmful interference to radio or television reception, which can be determined by turning the equipment off and on, the user is encouraged to try to correct the interference by one or more of the following measures:

- Reorient or relocate the receiving antenna.
- Increase the separation between the equipment and receiver.
- Connect the equipment into an outlet on a circuit different from that to which the receiver is connected.
- Consult the dealer or an experienced radio/TV technician for help.

This device complies with Part 15 of the FCC Rules. Operation is subject to the following two conditions:

- 1) this device may not cause harmful interference, and
- 2) this device must accept any interference received, including interference that may cause undesired operation.

Environmental Protection
Discarded electric appliances are recyclable and should not be discarded in the domestic waste! Please actively support us in conserving resources and protecting the environment by returning this appliance to the collection centres (if available).



Dragon-i Toys Ltd.
contact@dragon-itoy.com
Please retain for future reference

USA Office:
371 W. Tullock Street,
Rialto, CA 92376, U.S.A.

UK Office:
G2 Frodsham Business Centre
Bridg Lane Frodsham
Cheshire WA6 7FZ

Europe Office:
4 Rue de Bercy
75012, Paris
France

D80549003(SC)