

**TABLE OF CONTENT**

1 INTRODUCTION	4	9. 5 Operation Mode for case When a Party Receives a Call During Group Intercom	14
1. 1 Main Functions	4	9. 6 Connected with Multiple Devices	15
2 PACKAGE CONTENT	5	10 PRIORITY OF FUNCTIONS	15
3 INSTALLATION PROCEDURE	6	11 TECHNICAL PARAMETERS OF PRODUCT	16
3. 1 Installation Method for Helmet Applications	6	12 INDICATION OF BATTERY VOLUME	16
3. 2 Installation Method for Non-helmet Applications	7	13 WARRANTY CLAUSE	16
4 DISASSEMBLY OF BLUETOOTH DEVICE	7	13.1 Limited Warranty	16
5 FUNCTION ILLUSTRATION	8	13.2 Warranty Period	16
6 INTRODUCTION OF OPERATION PANEL	10	13.3 Termination	16
7 FUNCTIONS AND INTRODUCTION OF BUTTONS	10	13.4 Notice and Waiver	16
7. 1 On/Off Button and Intercom Button	10	13.5 Warranty Exclusions	17
7. 2 Multi-functional Button	11	13.6 Limitation of Liability	17
8 USE OF ANTENNA	12	13.7 Liabilities Disclaimer	18
9 PAIRING PROCEDURE	12	13.8 Warranty Service	18
9. 1 Pairing with Mobile Phone, Mp3 and GPS	12	13.9 Free-of-charge Service	18
9. 2 Pairing with (FreedConn) L2 Adaptor	13	13.10 Return for Full Refund	18
9. 3 Pairing between two T-Rexes	13		
9. 4 Group Intercom Settings (Take a group of 6 people as example)	14		

## T-Rex

### 1. INTRODUCTION

Thank you for choosing FreedConn T-Rex Motorcycle Bluetooth Communication System.

T-Rex is a Full Duplex Group Intercom Bluetooth System, applying humanized design, integrating the cutting edge technology of all similar products and becoming a perfect motorcycle communication system. It can satisfy all kinds of needs in your journey, such as wireless dialling, receiving calls, listening to Mp3 music, receiving GPS voice prompt and connecting with two way radio. The most important is that it can realize group Intercom among motorcycles, providing you with convenient communication with your teammates throughout the ride.











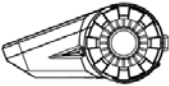



#### 1. 1 Main Functions

- ① 8-way 1500m conference Intercom
- ② Multiple devices connected simultaneously
- ③ Can be used with FreedConn handle remote control L3
- ④ Wired/wireless connection with two way radio
- ⑤ Built-in FM radio
- ⑥  $\varnothing$  3.5mm headphone jack
- ⑦ 2.5 converted to 3.5mm stereo audio cable
- ⑧ Voice prompt
- ⑨ Music sharing
- ⑩ Usable during recharging

FCC ID: 2ACB3T-REX

**2. PACKAGE CONTENT**

- Bluetooth Device 
- Universal Clamp 
- 2.5 Converted to 3.5mm stereo Audio Cable 
- Manual 
- Screw Driver 
- Microphone & Speakers 
- USB Cable 
- Power adaptor   
(Different chargers for different Countries)
- Headphone Velcro 
- Mini Microphone 
- Mini Microphone Clamp 
- Two-Way Radio Control Cable 
- PTT Button Velcro Tape 

English

### 3. INSTALLATION PROCEDURE

#### 3.1 Installation Method for Helmet Applications

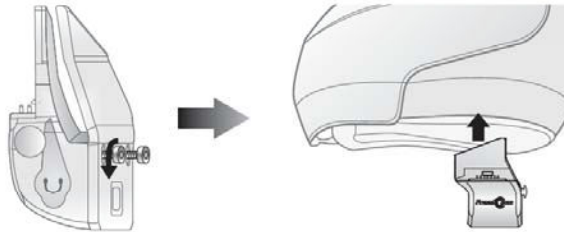

1 Loosen the screw on the back of universal helmet clamp with the provided screw driver

2 Open the lining of helmet, insert the universal clamp in the proper position on the left of helmet and fasten the screw (overly fastened screw can damage the clamp)

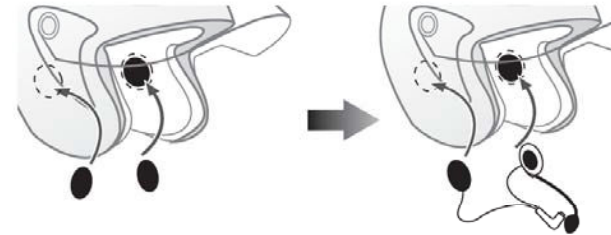

4 Open the lining of helmet (at ear's position), clean the EPS surface and affix the VELCRO on with the rough surface

5 Affix the hook surface of speaker to the rough surface of VELCRO and properly tidy the helmet lining

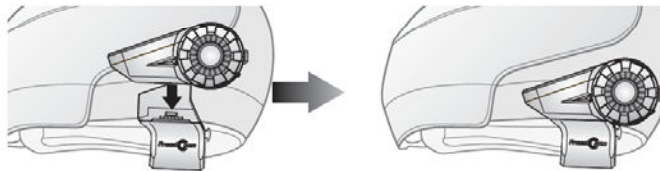

3 Insert the pin header of the corresponding clamp of Bluetooth device (as shown in figure) and make sure the device is installed properly and firmly

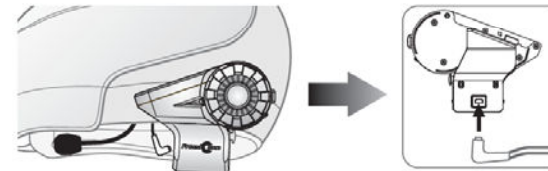

6 Insert the headphone plug into the corresponding headphone jack of Bluetooth device (on the back of clamp) to finish the installation

### 3.2 Installation Method for Non-helmet Applications

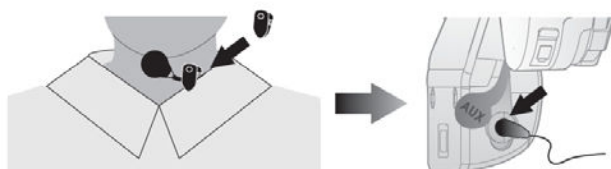

- 1 Fix the mini microphone on the collar near mouth with the microphone clamp
- 2 Insert the USB plug of mini microphone into the AUX port

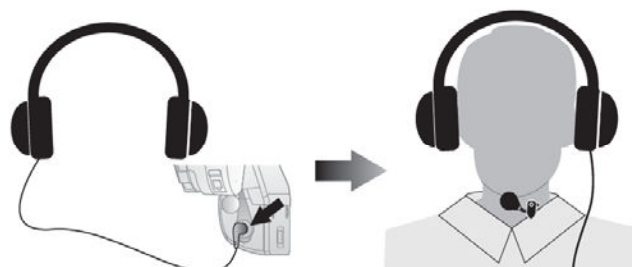

- 3 Insert the normal Ø3.5mm headphone plug into the Ø3.5mm jack on universal clamp
- 4 Put on the headphone and put the Bluetooth device in your pocket, installation finished.

### 4. DISSEMBLY OF BLUETOOTH DEVICE

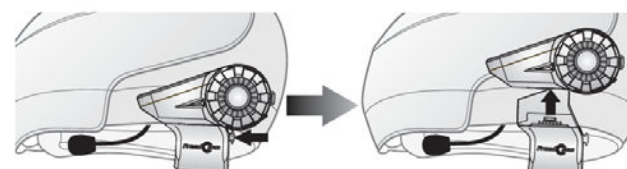

- 1 Press the Quick Disassembly button
- 2 Remove the Bluetooth device from the clamp (along the arrow direction in figure)

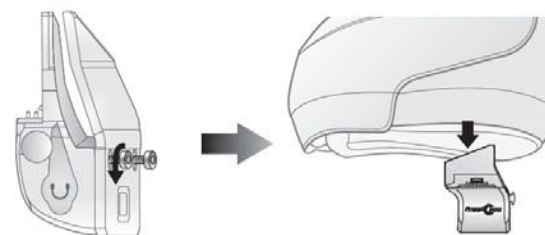

- 3 Loosen the screw on the back of universal clamp with the provided screw driver
- 4 Remove the clamp from helmet (along the arrow direction in figure)

English

**5. FUNCTION ILLUSTRATION**

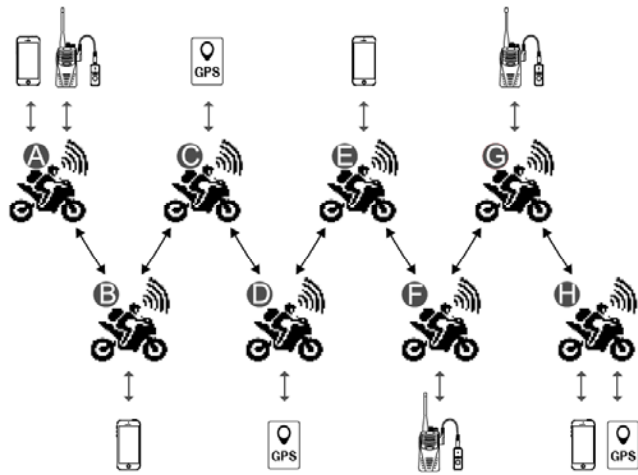

1 1500 m intercom range, chain-shaped connection with unlimited links, preferably 8 links; can be connected with multiple devices (mobile phones, GPS and adaptors).

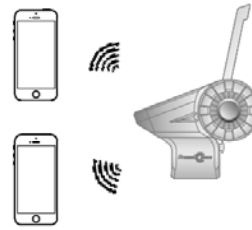

2 Can be connected simultaneously with 2 mobile phones to call out, answer calls, reject calls, hang up, make voice dial and play music

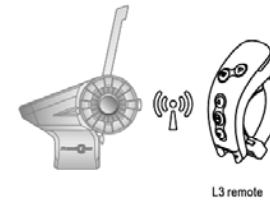

3 Can be used together with L3 remote control

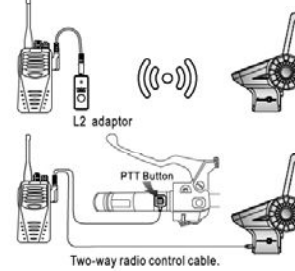

4 Can be connected with two-way radio through Bluetooth adaptor or handheld two-way radio control cable.

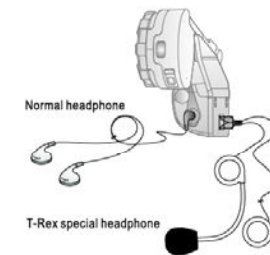

5 T-Rex special headphone and Ø3.5mm normal headphone can be plugged in at the same time to share your music with your friends.

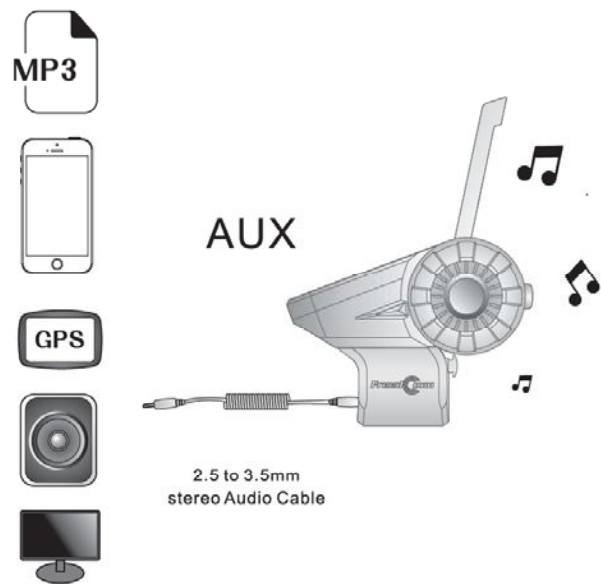

6 Audio in Mp3, mobile phone, GPS, stereo and PC that are without Bluetooth can be imported into the Bluetooth device through stereo audio cable. (usable when the Bluetooth device has no power)



Rechargeable Battery  
(Usable During Recharging)



FM Radio Function

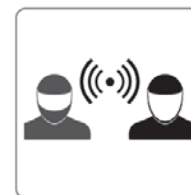

Universal Intercom



Voice Prompt

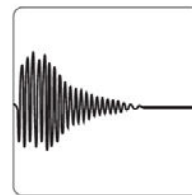

Advanced Noise  
Control



Water-proof

## T-Rex

### 6. INTRODUCTION OF OPERATION PANEL

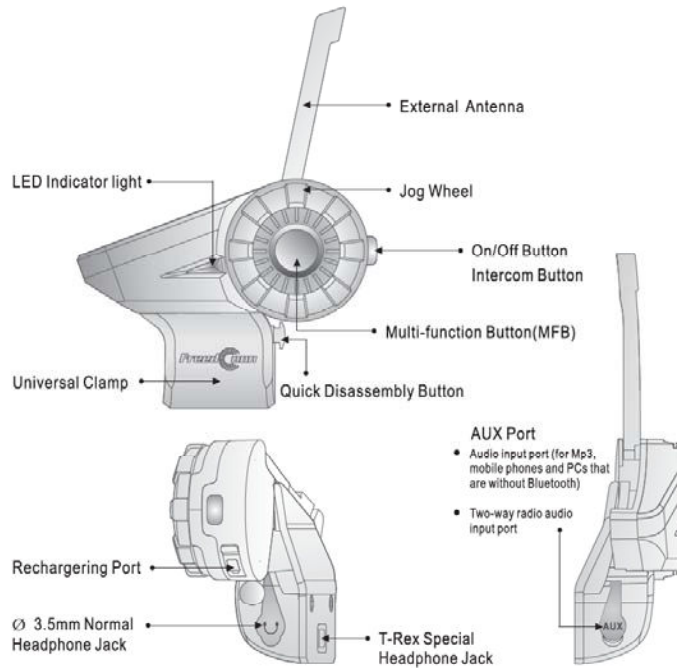

### 7. FUNCTIONS AND OPERATION OF BUTTONS

#### 7.1 On/Off button and intercom button



- ① ON
- ② OFF
- ③ Bluetooth Intercom on
- ④ Bluetooth Intercom off
- ⑤ Intercom/music switch
- ⑥ Clear the pairing record

①	Press down for 3 seconds until hear "Welcome to use FreedConn product" voice prompt. The blue light will flash 3 times swiftly and then turn into regular flashing.
②	Press down for 5 seconds until hear "Power off" voice prompt. The red light will be on for a while and then die out.
③	Shortly press the button on either one of the two paired T-Rexes and a voice prompt will be heard after completing the intercom connection.
④	Shortly press the button and intercom closes after a "bee" prompt tone.
⑤	Shortly press the button and a "bee" prompt tone can be heard.
⑥	When pressing down the button to start the device, hold the button down for another 3 seconds after the red light flashes until the red light quickly flashes 3 times and a "toot" prompt tone can be heard, which means clearing is successful and the device is started. (Pressing down for 5 seconds when shutting down the device does not clear record) Note: the clearing will clear all memories; Press down for 8 seconds to enter pairing status if pairing record is not cleared and press down for 5 seconds to automatically enter pairing status if pairing record is cleared.



## 7.2 Multi-functional Button



- ① Answer calls
- ② Reject calls
- ③ Switch between cell phone and T-Rex headset
- ④ End the call
- ⑤ Voice dialling
- ⑥ Play/Pause music
- ⑦ Play/Pause FM radio
- ⑧ Switch between phones
- ⑨ Switch between phone and intercom
- ⑩ Switch between intercom and phone



- ① FM radio
- ② Music play control
- ③ Volume control

①	Press the MFB button once, a "Call answer" voice prompt can be heard. Incoming call will be answered automatically when no operation is conducted after 15 seconds of ringing.
②	Press down for 2 seconds until you hear "Call reject".
③	Press down for 2 seconds until you hear "bee".
④	Press the MFB button once or use mobile phone to end the call as usual.
⑤	Press down for MFB button 2 seconds until you hear "Voice dial".
⑥	Press the MFB button once when playing music on mobile phone.
⑦	Double press the MFB button when there is no call or intercom.
⑧	Phone A and B both being connected, if phone B receives a call when phone A is in talk, press the multi-functional button to end phone A's talk and press another time to answer phone B's incoming call.
⑨	When you receive a call during intercom, press down the button for 2 seconds to end intercom, press once more to answer the incoming call and intercom will be resumed after the call.
⑩	When you receive a intercom invitation during a call, press the button to end the call and intercom will be switched in automatically.

①	Turn the knob clockwise to switch to next channel. Turn the knob counter clockwise to return to the previous channel.
②	Turn the knob clockwise to switch to next song. Turn the knob counter clockwise to return to the previous song.
③	Turn the knob clockwise and hold it to increase volume until it reaches the level you want. A "toot" prompt will be heard when it reaches Max volume; Turn the knob counter clockwise and hold it to decrease volume until it reaches the level you want. A "toot" prompt will also be heard when it reaches Min volume.

## T-Rex

### 8. USE OF ANTENNA

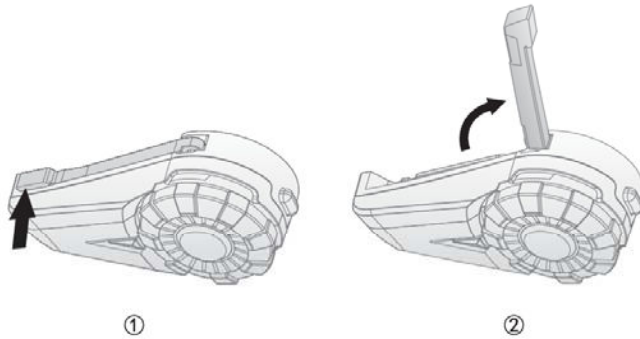

Push the antenna slightly along the arrow direction in figure① and it will open automatically along the arrow direction in figure②

### 9. PAIRING METHODS

#### 9.1 Pairing with Mobile Phone, Mp3 and GPS

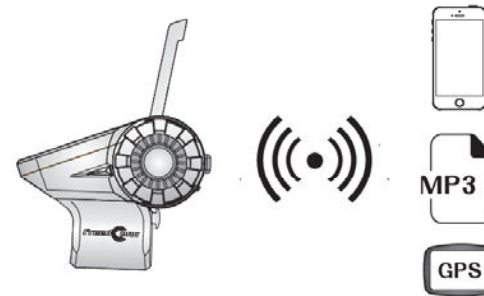

**Step 1:** Ensure T-Rex is off and within 1 m visible range of the device to be paired.

**Step 2:** Press down the T-Rex On/Off button/Intercom button for 8 seconds until you hear "Pairing" prompt, when the red light and blue light flash alternatively, T-Rex enters pairing status.

**Step 3:** Start the Bluetooth device to be paired, search and choose T-Rex to pair. When you hear "Your phone is connected" prompt and the blue light flashes regularly, pairing is successful.

### 9.2 Pair with (FreedConn) L2 Adaptor

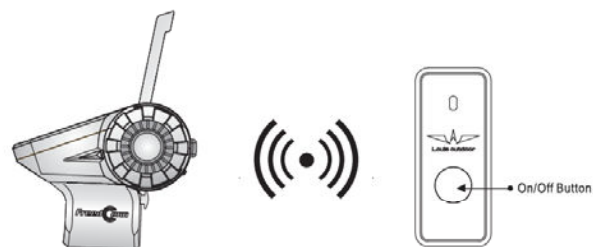

**Step 1:** Ensure T-Rex is off and within 1 m visible range of the device to be paired.

**Step 2:** Press down the T-Rex On/Off button/Intercom button for 8 seconds until you hear "Pairing" prompt, when the red light and blue light flash alternatively, T-Rex enters pairing status.

**Step 3:** Press down the On/Off button of L2 adaptor for 6 seconds to enter pairing status and automatically search for pairing. Pairing is successful when the indicator lights of T-Rex and L2 all flash blue regularly.

### 9.3 Pairing between Two T-Rexes

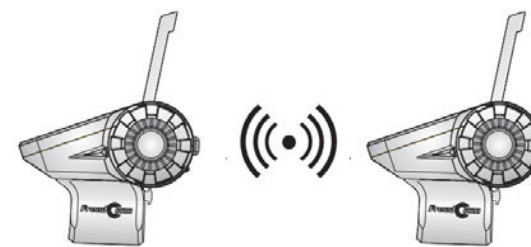

**Step 1:** Ensure both T-Rex are off and within 1 m visible range of each other.

**Step 2:** Press down both T-Rex On/Off button /Intercom button for 8 seconds until you hear "Pairing" prompt from both T-Rexes, when the red light and blue light flash alternatively, both T-Rexes enter pairing status.

**Step 3:** Press down the On/Off button on either T-Rex until you hear a intercom voice prompt. Then the blue light flashes regularly which means pairing is successful.

## T-Rex

### 9.4 Group Intercom Settings (Take a group of 6 people as example)

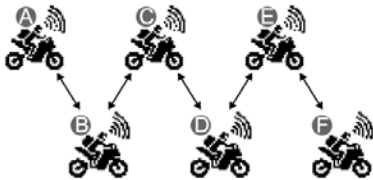

**Note:** The frontmost and backmost cyclers (shown as A and F in figure) are not allowed to be paired.



**Step 1:** First start the device of A and F, then press down the On/Off buttons on both devices for 8 seconds to clear pairing memories (press down for another 3 seconds after hearing close prompt tone or close red light is on), in case A and F were paired before.

**Step 2:** A pairs with B, B closed, A not closed; B pairs with C, C closed, B not closed; C pairs with D, D closed, C not closed; D pairs with E, E closed, D not closed; E pairs with F. (ABCDEF all open).

**Step 3:** Press the On/Off button to connect. Press A's button to connect with B, press B's button to connect with C, press C's button to connect with D, press D's button to connect with E, press E's button to connect with F. Now any one of the 6 people speaks, other 5 can hear.

### 9.5 Operations Mode for Cases When Someone Receives a Call during Group Intercom

During 6 people group intercom, if C receives a call, he or she will be disconnected from other group members (A pairs with B to form a group, C forms its own group, D, E and F form a group).



After C's call is over, he or she will be automatically reconnected into the group intercom and the 6 people group intercom resumes.

### 9.6 Connecting with Multiple Devices

The group members can connect to multiple devices (mobile phones, GPS and adaptors) when connecting with the group

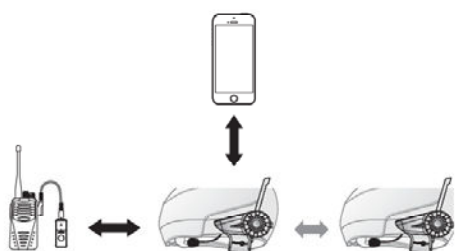

① Frontmost and backmost members of the group (A and F) can connect with any two devices of mobile phones, GPS or adaptors apart from connecting with one group member.

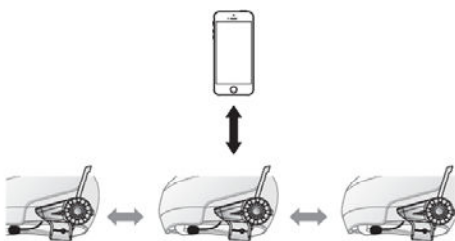

② Members in the middle of group (B, C, D, E) can connect with any one device of mobile GPS or adaptors apart from connecting with 2 group members.

### 10. PRIORITY OF FUNCTIONS

**Level 1:** Phone Call(two-way radio audio introduced by adaptor)

**Level 2:** Bluetooth intercom

**Level 3:** Music (FM radio)

#### Analysis:

1. During a call, two-way radio intercom, Bluetooth intercom, music, FM radio introduced by adaptor are all not operable. But upon the coming of two-way radio intercom invitation and Bluetooth intercom invitation, there will be a prompt tone.
2. During an two-way radio intercom, Bluetooth intercom, music and FM radio are all not operable. But there will be a prompt tone upon the coming of Bluetooth intercom.
3. During Bluetooth intercom, music and FM radio are not operable.

(Intercom introduced by two-way radio control cable will not be affected by priority. It can be carried out simultaneously with call, music and FM radio.)

### 11. TECHNICAL PARAMETERS OF PRODUCT

**Frequency:** 2.4GHz

**Weight:** 110.2g

**Size:** 100.8 x 77.2 x 42.7 mm

**Battery Type:** 470mAh

**Stand by:** 1 week

**Talking Time:**

7 h of Mobile Phone

6 h of Bluetooth Intrecom

**Charging Time:** About 3 hours

**Travel Adaptor:** DC 5V 500mA

## T-Rex

### 12. INDICATION OF BATTERY VOLUME

Polymer Batteries are used in this product, so please put it in dry places. Recharge the battery after more than 1 month of storage to achieve the service life of product.

1. If the battery volume is full, the blue light will flash one time every 2 seconds when starting the device is starting.
2. Alarm will be intrigued when the battery is running low. Alarm will be prompted every 15 seconds (the voice of prompt is "Battery low" and red light flashes every 15 seconds). Continual use will lead to auto-shutdown.
3. Red light will be on during recharging and die out when the battery is full.
4. The product is available for use during charging.

### 13. WARRANTY CLAUSE

#### 13.1 Limited Warranty

FreedConn guarantees the product quality based on the technical specification stated in the product manual, and data regarding product warranty. Here, product warranty extends to the product only. FreedConn will not be liable for any loss, which may result from using the product beyond defective parts or flaws that occur due to problems in manufacture.

#### 13.2 Warranty Period

FreedConn guarantees free-of-charge replacement s of defective parts of the product of flaws that may have occurred due to problems in manufacture for a period of 2 years from the date of initial purchase.

#### 13.3 Termination

Quality warranty of the product becomes effective on the date of initial purchase. In addition, the quality warranty of the product expires when the warranty period expires. However, in the following cases, the warranty will be terminated prematurely.

- In the event the manufacturer's name, serial number, product label, or other markings have been modified or removed.
- In the event any unauthorized person has tried to disassemble, repair, or modify the product.

#### 13.4 Notice and Waiver

Be certain to read and understand the following terms and conditions before using the product. Use of this product will constitute consent to all the terms and conditions of this agreement return the product for a refund. (Refer to the section "Return for Full Refund".)

- ① You agree t that you, your descendants, legal proxies, successors, or transferees will not ralise permanent volitional request for any suit, claim, implementation, redemption or similar action from FreedConn with regard to any occasion such as difficulty, pain, suffering, inconvenience, loss, injury, or death which may occur to



you or a third party during the use of this product.

- ② You must completely understand and accept all risks ( including those occurring due to any careless behavior of yours or others) which may occur during the use of this product.
- ③ You are responsible for ensuring that your medical condition permits usage of the product and that you are in sufficient physical condition for using any device which can be used with it. In addition, you must ensure that the product does not limit your abilities and that you are able to use it safely.
- ④ You must be an adult who can take responsibilities for using the product.
- ⑤ You must read and understand the following warnings and alerts:
  - FreedConn, together with employees, managers, partners, subsidiaries, representatives, agents, supporting firms and suppliers, sole sellers of FreedConn (collectively referred to as "the company") recommend that, before using the product and similar devices of any brands including its derivative e models, you collect any relevant information in advance and be entirely prepared in terms of weather, traffic situation, and road conditions.
  - When you use the product while you operating any vehicle or equipment such as motorcycles, scooters, mopeds, ATVs, or quad-bikes(hereinafter called as "transportation means"), you must take complete caution regardless of the location of such operation.
  - When you use the product, use good judgment; never use it under the influence of alcohol.

⑥ You must read and completely understand all terms and conditions of legal rights and warnings that are involved in using the product. In addition, usage of the product constitutes acceptance of all terms and conditions regarding waiver of rights.

### 13.5 Warranty Exclusions

#### Reasons for limited liabilities

FreedConn will not be liable for physical injury, death, or any loss or damage of transportation means, possessions, or assets which belong to you or third parties that may have occurred while you use the product. Further, Freedconn will not be liable for any substantial damage that related to the condition, environment, or malfunction of the product.

Use of this product may violate local or national laws. In addition, be aware once again that correct and safe use of the product is entirely your responsibility.

### 13.6 Limitation of Liability

TO THE FULL EXTENT ALLOWED BY LAW, FREEDCONN EXCLUDES FOR ITSELF AND ITS SUPPLIERS ANY LIABILITY, WHETHER BASED IN CONTRACT OR TORT (INCLUDING NEGLIGENCE), FOR INCIDENTAL, CONSEQUENTIAL, INDIRECT, SPECIAL, OR PUNITIVE DAMAGES OF ANY KIND, OR FOR LOSS OF REVENUE OF PROFITS, LOSS OF BUSINESS, LOSS OF INFORMATION OR DATA, OR OTHER FINANCIAL LOSS ARISING OUT OF OR IN CONNECTION WITH THE SALE, INSTALLATION, MAINTENANCE, USE, PERFORMANCE, FAILURE, OR

## T-Rex

INTERRUPTION OF ITS PRODUCTS, EVEN IF FREEDCONN OR ITS AUTHORIZED RESELLER HAS BEEN ADVISED OF THE POSSIBILITY OF SUCH DAMAGES, AND LIMITS ITS LIABILITY TO REPAIR, REPLACEMENT, OR REFUND OF THE PURCHASE PRICE PAID, AT FREEDCONN'S OPTION. THIS DISCLAIMER OF LIABILITY FOR DAMAGES WILL NOT BE AFFECTED IF ANY REMEDY PROVIDED HEREIN SHALL FAIL OF ITS ESSENTIAL PURPOSE. IN ANY CASE, THE TALTAL COMPENSATION LIABILITIES OF FREEDCONN OR ITS SALES AGENTS SHALL NOT EXCEED THE PRICE PAID FOR THE PRODUCT BY THE PURCHASER.

### 13.7 Liabilities Disclaimer

In addition to damages which may occur due to the use of the product, FreedConn will not be liable for damages of the product which occur due to the following events:

- In the event the product is misused or used for purposes other than its intended purposes.
- In the event the product is damaged because the user does not follow the content of the product manual.
- In the event the product is damaged because it has been left unattended or has undergone any other accident.
- In the event the product is damaged because the user has used any parts of software which are not provided by the manufacturer.
- In the event the product is damaged because the user has disassembled, repaired, or modified it in such way as is not explained in the product manual.

- In the event the product is damaged by the third party.
- In the event the product is damaged due to Acts of God (including fire, flood, earthquake, storm, hurricane or other natural disaster).
- In the event the surface of the product is damaged by use.

### 13.8 Warranty Service

To obtain product warranty service, send the defective product, at your expense, to the manufacturer or the seller along with proof of purchase (a receipt that shows the purchase date, a product registration certificate of the website, and other relevant information). Take necessary measures to protect the product. In order to get a refund or replacement, you must include the whole package as it was purchased.

### 13.9 Free-of-charge Service

FreedConn will provide free-of-charge repair or replacement service for the product when product defects occur within the scope of the product warranty during the warranty period.

### 13.10 Return for Full Refund

Should you not agree to the terms and conditions explained above, you may return the product for a full refund. To get a refund, within 14 days from the purchase date you must return the product to the seller in such a condition as it was purchased. Unless you return the product within 14 days from the purchase date, you will have read and agreed to all the terms and conditions explained above, and FreedConn will not be liable for any claim for damages related with the product.



NOTE: This equipment has been tested and found to comply with the limits for a Class B digital device, pursuant to part 15 of the FCC Rules. These limits are designed to provide reasonable protection against harmful interference in a residential installation. This equipment generates, uses and can radiate radio frequency energy and, if not installed and used in accordance with the instructions, may cause harmful interference to radio communications. However, there is no guarantee that interference will not occur in a particular installation. If this equipment does cause harmful interference to radio or television reception, which can be determined by turning the equipment off and on, the user is encouraged to try to correct the interference by one or more of the following measures:

- Reorient or relocate the receiving antenna.
- Increase the separation between the equipment and receiver.
- Connect the equipment into an outlet on a circuit different from that to which the receiver is connected.
- Consult the dealer or an experienced radio/TV technician for help.

This device complies with part 15 of the FCC rules. Operation is subject to the following two conditions:

- (1) this device may not cause harmful interference, and
- (2) this device must accept any interference received, including interference that may cause undesired operation.

Changes or modifications to this unit not expressly approved by the party responsible for compliance could void the user's authority to operate the equipment.

#### RF Exposure Information

This equipment complies with FCC radiation exposure limits set forth for an uncontrolled environment and can be used/operated in portable operating conditions without any restrictions.

For detailed SAR information, please check the FCC ID:2ACB3T-REX on fcc website.