

# Instructions for use

ConnectClip



2.4 GHz

**oticon**  
PEOPLE FIRST

## **Introduction to this booklet**

This booklet guides you on how to use and maintain your new ConnectClip. Please read the booklet carefully, including the Warning section. This will help you get the most out of your new ConnectClip. If you have additional questions about the use of your ConnectClip, please contact your hearing care professional.

For your convenience, this booklet contains a navigation bar to help you navigate easily through the different sections.

## Intended use

The ConnectClip is intended as a wireless receiver and transmitter of sound between hearing aids and the surrounding environment, including speech and wireless electronic audio devices. The ConnectClip also assists users of wireless hearing aids to control the functionality provided by their hearing solution.

The ConnectClip is intended to be used by children (> 36 months) and adults together with their hearing solution.

### IMPORTANT

Please familiarise yourself with the entire contents of this booklet before using your ConnectClip. It contains instructions and important information about the use and handling of your ConnectClip.

## Introduction

The ConnectClip can be used both as a wireless headset for mobile phones and as a remote microphone/partner microphone.

### 1. Headset with mobile phone

Sounds from your phone will be streamed to your hearing aids through the ConnectClip (A). Your voice is picked up by the ConnectClip and sent to the mobile phone (B).

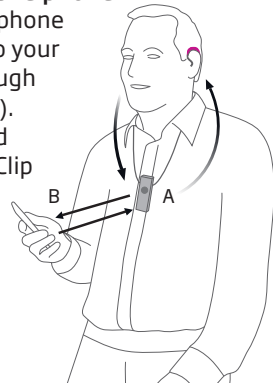

### 2. Remote/partner -microphone

The voice of a chosen speaker will be transmitted wirelessly FROM the ConnectClip TO your hearing aids.

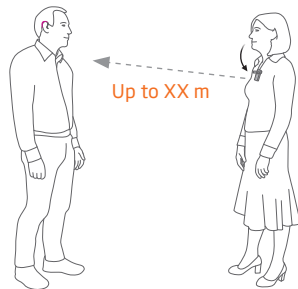

## Contents

Package content	9
ConnectClip overview - main functions	10
■ First time use - initial setup - only needed once!	14
■ Pairing mobile phone with the ConnectClip	16
■ Daily use: On/Off	18
■ Daily use: Charging	19
■ Using ConnectClip with mobile phone	20
■ Ensuring ConnectClip is connected to the phone	21
■ Receiving calls	22
■ Making calls	24
■ Advanced headset features	25
■ Listening to music	26
■ Using ConnectClip as remote microphone	28

■ Selecting microphone mode	29
■ Starting/stopping sound from remote microphone	30
■ Regulating level from remote microphone	31
■ Starting/stopping sound from remote microphone using your hearing aids	32
■ Using ConnectClip as remote control for hearing aids	34
■ Landline phone - Phone Adapter 2.0	35
■ PC/Laptop - BT-D800 Bluetooth dongle	36
■ Other features and functions	37
■ Overview of product statuses	38
Warnings	40
Technical information	46
International warranty	49
Index	52

## Package content

The ConnectClip box consists of the following elements:



ConnectClip



Lanyard - long



Lanyard - regular



Pouch



This guide  
(Instructions for use)



Wall charger  
(will vary from country to country)



USB charger cable

## ConnectClip overview - main functions

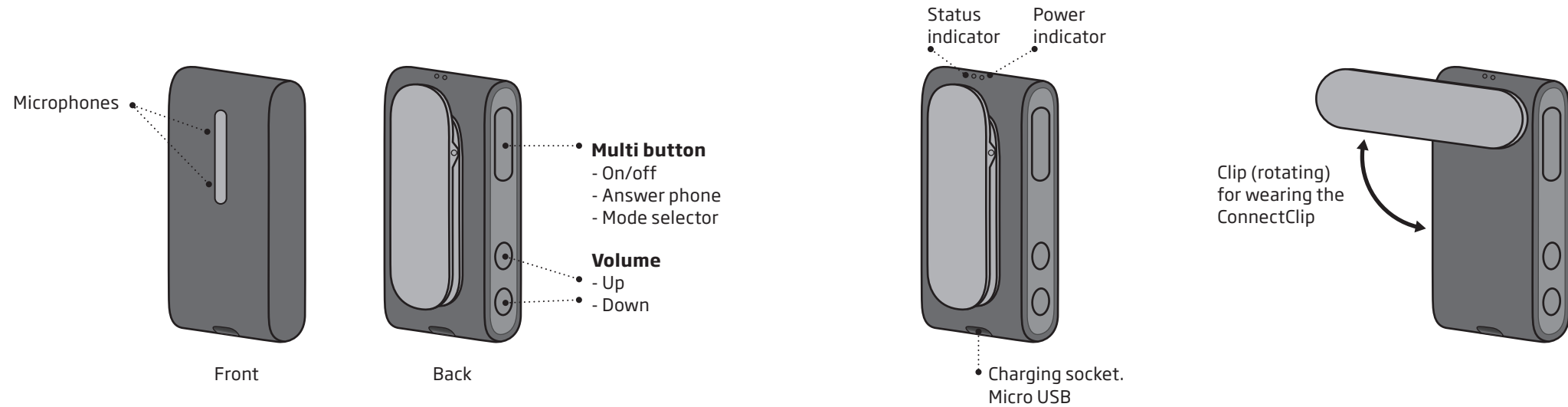

## Getting started

Before you can use the ConnectClip with your hearing aids, both the hearing aids and the ConnectClip need to be paired/connected. Using the ConnectClip with a mobile phone also requires the ConnectClip to be paired with/connected to your mobile phone.

### 1. Pairing hearing aid and ConnectClip

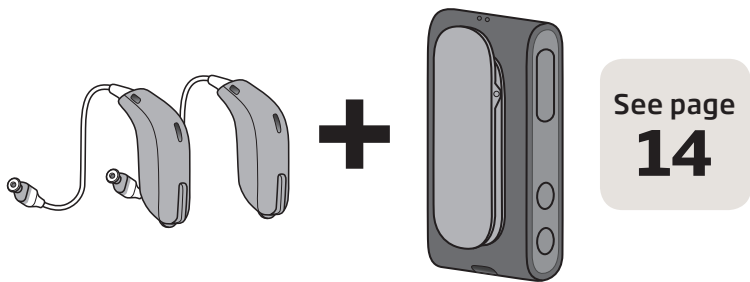

12

### 2. Pairing ConnectClip and mobile

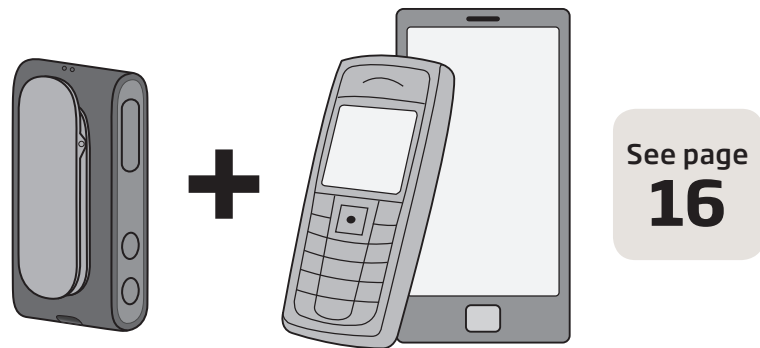

13

## First time use - initial setup - only needed once!

### 1. Ensure ConnectClip is powered off

Press and hold multi-button for approx. 6 seconds until **power indicator OFF** ●

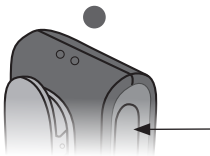

### 2. Turn both hearing aids OFF

(open battery drawer)

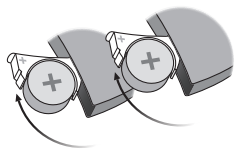

### 3. Turn both hearing aids ON

(close battery drawer)

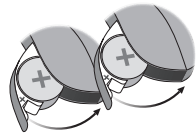

### 4. The hearing aids will now be ready

for first time connection with the ConnectClip.  
This will take about 3 minutes.

### 5. Turn ON ConnectClip

Press and hold multi-button for approx. 3 seconds until power indicator shows **STEADY GREEN** ●

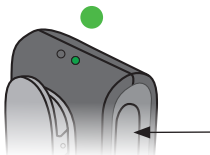

### 6. ConnectClip will now search for your hearing aids.

Status indicator **BLINKING YELLOW** ●



### 7. Place ConnectClip and both hearing aids close to each other

(max distance 20cms)

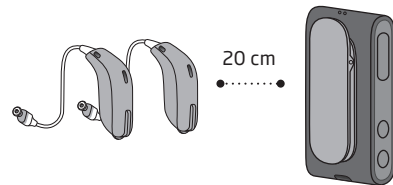

### 8. Connection established with hearing aid(s) is indicated by status indicator **STEADY YELLOW** ●





## Pairing mobile phone with the ConnectClip

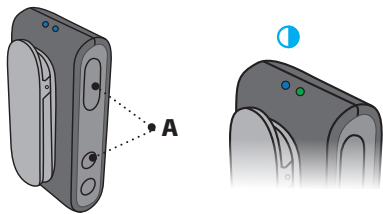

### Place ConnectClip in pairing mode

Press and hold the multi button AND volume up button for about 6 seconds (A) until status BLINKS BLUE 

The ConnectClip will be in pairing mode for about 3 minutes.

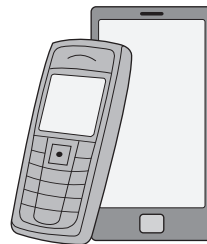

### Enable pairing on mobile phone

Turn on Bluetooth. Search for and connect to/pair with ConnectClip.

This is normally in the settings/Bluetooth section of your phone.

### Enter pin code

If your phone requests a pin code enter 0000 (four zeros).



### Pairing complete

Pairing complete with mobile phone is indicated by status STEADY BLUE 

## Daily use: On/Off



**ON** ●

Press and hold multi-button for approx. 3 seconds until power indicator shows **STEADY GREEN**.

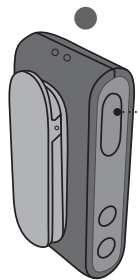

**OFF** ●

Press and hold multi-button for approx. 6 seconds until power indicator **OFF**.

## Daily use: Charging



**Battery low** ●

With about 30 mins remaining streaming time, the power indicator turns **RED**.



**Charging** ●

Connect the enclosed charger through the micro USB connector at the bottom of the ConnectClip. The power indicator **BLINKS GREEN** or **ORANGE**.

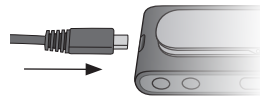

Charging indicators (power LED)	
Charging (ConnectClip on)	
Charging complete (ConnectClip on)	
Charging (ConnectClip off)	
Charging complete (ConnectClip off)	

## Using ConnectClip with a mobile phone

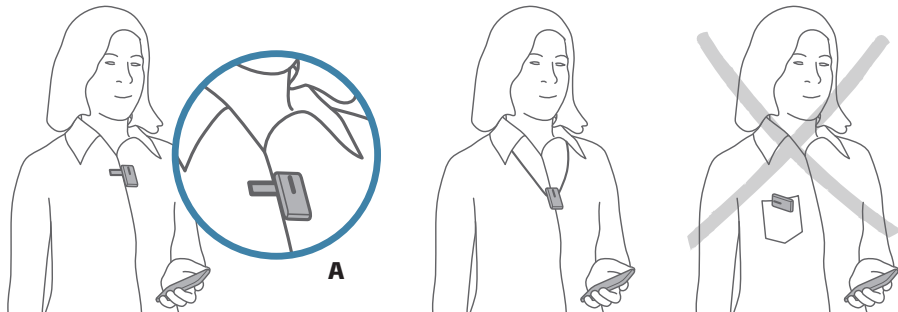

### IMPORTANT

The ConnectClip should be worn as indicated for best possible performance. It is important that the microphone in the ConnectClip is pointing towards your mouth (A), and that the ConnectClip is not covered by clothes etc. Maximum distance between ConnectClip and mobile phone 10 metres.

## Ensuring ConnectClip is connected to the phone

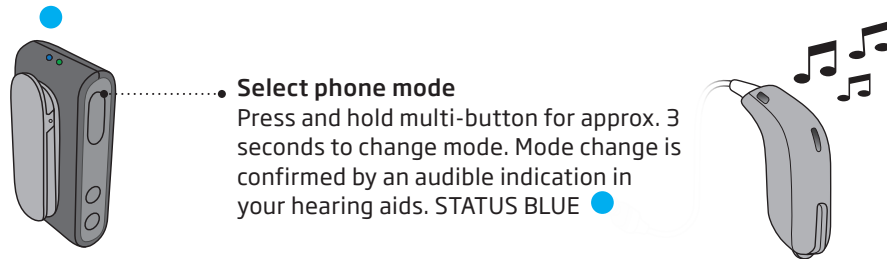

### Select phone mode

Press and hold multi-button for approx. 3 seconds to change mode. Mode change is confirmed by an audible indication in your hearing aids. STATUS BLUE ●

Status	Mode
●	Idle Connected to hearing aids. Not connected to a mobile phone.
●	Connected to mobile phone.
●	Remote/partner microphone mode.

## Receiving calls

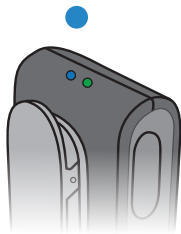

### Phone connected

When the ConnectClip is turned on and is in range of your mobile phone it will automatically connect to the mobile phone.

The status indicator is STEADY BLUE ●

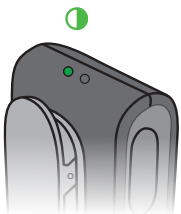

### Phone ringing

When the phone rings you will hear a ring indicator and, if available, the ring-tone from your phone) in your hearing aids.

The status indicator will BLINK GREEN ●



**A**

### Answer call

Either click the multi-button shortly (A) -or answer the call from your mobile phone.

Once the call is connected status will change to STEADY GREEN ●



**A**

### End call

Either click the multi button shortly (A) -or hang up the call from your mobile phone.

Status STEADY BLUE ●

## Making calls

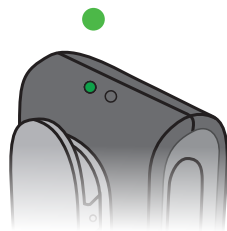
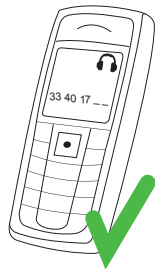

To make a call you only have to use the mobile phone. The call will automatically be connected to the ConnectClip.

Once the call is connected the status LED will change to STEADY GREEN ●

## Advanced headset features

### Voice dialling

When connected to a mobile phone, a short press on the multi button activates voice dialling if supported by the phone.

### Reject call

A long press on the volume down button, while the phone is ringing, rejects the call.

### Mute hearing aid microphones

Press and hold volume down for about 3 seconds to mute the hearing aid microphones.

Short press volume up or down will unmute hearing aids

## Listening to music

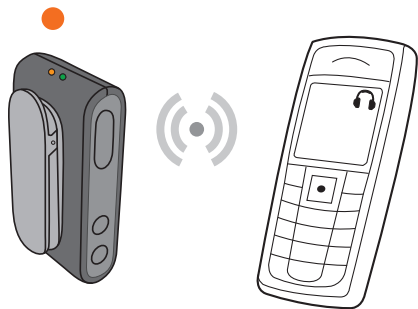

### Wireless audio (A2DP)

If connected to a mobile phone, or other device, through Bluetooth, the music played on the phone/device will automatically be played in your hearing aids.

Status LED ORANGE ●

**You do not need to operate anything on the ConnectClip.**

Status	Description
●	The ConnectClip is turned on - and streaming music from the phone

### Adjusting volume

While listening to music, the level of the streamed signal can be adjusted using the volume up/down buttons.

### Stopping sound from phone

Use the controls on the phone to stop the sound.

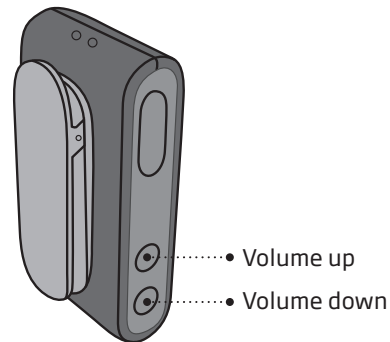

## Using ConnectClip as a remote microphone

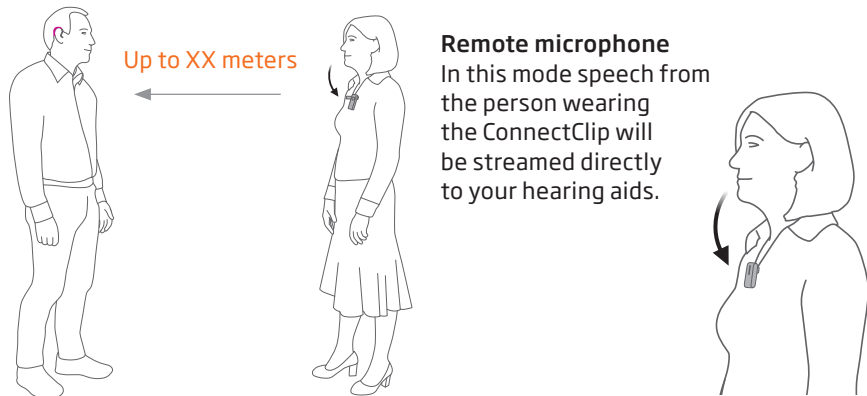

### Remote microphone

In this mode speech from the person wearing the ConnectClip will be streamed directly to your hearing aids.

### IMPORTANT

Ensure that the microphone is pointing to the speaker's mouth and that it is not covered by clothes etc.

## Selecting microphone mode

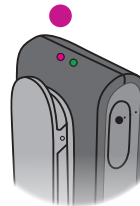

### Select mic. mode

Press and hold multi-button for approx. 3 seconds to change mode. Mode change is confirmed by an audible indication in your hearing aids. Status STEADY MAGENTA ●



Status	Description
●	The ConnectClip is turned on. In idle mode i.e. not connected to a phone
●	The ConnectClip is turned on. In idle mode i.e. not connected to a phone
●	The ConnectClip is turned on - and in remote microphone mode

## Starting/stopping sound from remote microphone

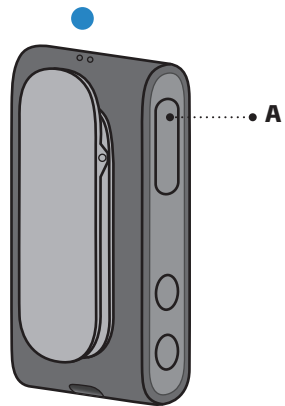

### Stop sound from Microphone

Press and hold multi-button (A) for approx. 3 seconds to stop the signal from the microphone to the hearing aids and switch the hearing aids back to their normal program.

The status indicator will change to YELLOW ● or BLUE ●

## Regulating level from remote microphone

### Volume up or volume down

The streamed signal can be adjusted using the volume up/down buttons.

### Mute Hearing aid microphones (only sound from the remote microphone).

Press and hold volume down for about 3 seconds to mute the hearing aid microphones.

Short press volume up or down will unmute hearing aids.

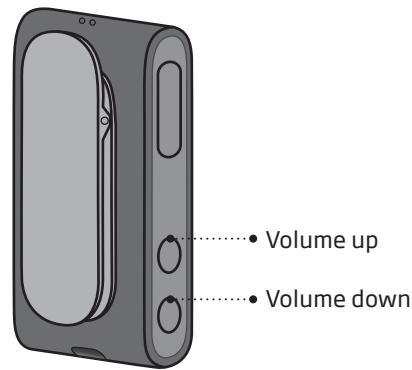



## Starting/stopping sound from remote microphone using your hearing aids



### P1 --> P2 --> TV --> Microphone

A long press on the hearing aid button will toggle to the next program in the hearing aids.

Once you reach the remote microphone program you will hear the remote microphone program indicator.

To stop remote microphone sound simply toggle to back to the hearing aid program.

#### IMPORTANT

Please refer to your hearing aid's instructions for details on the functionality of your specific hearing aid solution.

## Cleaning the ConnectClip

#### IMPORTANT

Use a soft, dry cloth to clean the ConnectClip. It must never be washed or immersed in water or other liquids.

## Using ConnectClip as a remote control for hearing aids

When ConnectClip is not streaming sound it doubles as a remote control for your hearing aids.

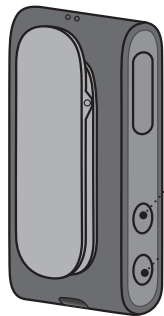

- Volume up  
- short press
- **Volume down**  
- short press

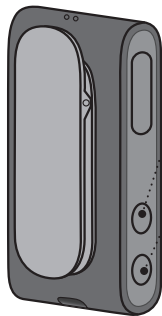

- **Next Program**  
- Press and hold for 3 secs for next program
- **Mute hearing aid microphones - long press**  
short press volume up or down will unmute

### IMPORTANT

Maximum distance between ConnectClip and hearing aids 2 metres.

## Landline phone - Phone Adapter 2.0

The ConnectClip and your hearing aids can also be used with domestic/landline phones through the ConnectLine Phone Adapter 2.0.

Please refer to information available on [www.oticom.global](http://www.oticom.global)



## PC/Laptop - BT-D800 Bluetooth dongle

The ConnectClip and your hearing aids can also be used with PCs and laptops through the BT-D800 dongle.

Please refer to information available on [www.oticom.global](http://www.oticom.global)

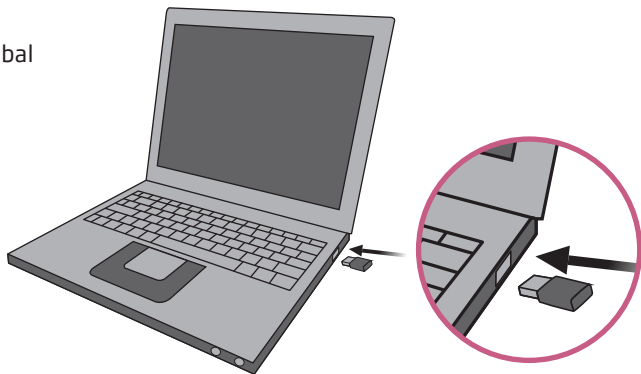

## Other features and functions

### One connection at a time

When paired with several devices (up to eight), the ConnectClip will only connect to the first phone available/in range.

### No calls when used as microphone

When using the ConnectClip as Partner/Remote -microphone - there will be no connection to the mobile phone.











### Timeout (out of range) when in microphone mode





If the ConnectClip is out of range of the hearing aids - the hearing aids will return to their initial program after 90 seconds.

### Clear Bluetooth pairings

Press and hold multi-button, volume up and volume down for 3 seconds to clear all Bluetooth pairings. Indicated by status LED BLINKING RED.

## Overview of product statuses

Status LED	Description	
	Blinking yellow	Searching for hearing aids
	Steady yellow	Idle. Hearing aids connected, Not connected to a phone
	Blinking blue	Searching for a mobile phone (pairing)
	Steady blue	Connected to a Mobile Phone
	Steady green	In a call. Headset (HFP); Mobile, PA2 or BTDB800
	Blinking green	Incoming call
	Steady orange	Music; Mobile Phone, Cable or BTDB800
	Steady magenta	Remote microphone mode
	Blinking mag.	Remote microphone reconnecting
	Steady grey	Connected to a PA20
	Steady white	Connected to BTDB800

Power LED	Description	
	Steady red	Battery low
	Blinking green	Turned on - charging
	Steady green	Turned on - charging complete
	Blinking orange	Turned off - charging
	Steady orange	Turned off - charging complete

## Warnings

You should familiarise yourself fully with the following general warnings and the entire contents of this booklet before using your ConnectClip to ensure personal safety and correct use. Consult your hearing care professional if you experience unexpected operations or events with your ConnectClip.

### **Choking hazards and risk of swallowing small parts**

ConnectClip and its parts should be kept out of reach of children and anyone who might swallow these items or otherwise cause injury to themselves. If a small part is swallowed, see a doctor immediately.

### **Explosives**

The power source in your ConnectClip has insufficient energy to cause fire in normal usage conditions. The ConnectClip has not been tested for compliance with international standards concerning explosive environments. We recommend you do not use your ConnectClip in areas where there is a danger of explosion.

## Warnings

### **X-ray/CT/MR/PET scanning, electrotherapy and surgery**

Remove your ConnectClip before X-ray/CT/MR/PET scans, electrotherapy, surgery, etc. as your ConnectClip may be damaged when exposed to strong fields.

### **Heat and chemicals**

The ConnectClip must never be exposed to extreme heat e.g. left inside a parked car in the sun. The ConnectClip must not be dried in microwave ovens or other ovens. The chemicals in cosmetics, hairspray, perfume, aftershave lotion, suntan lotion and insect repellent can damage the ConnectClip. Always remove your ConnectClip before applying such products and allow time to dry before use.

### **Interference**

The ConnectClip has been thoroughly tested for interference according to the most stringent international standards. However, interference between the ConnectClip and other devices (e.g. some mobile telephones, citizens band devices, shop alarm systems and other wireless devices) may occur. If this occurs, increase the distance between the ConnectClip and the interfering device.

## **Warnings**

### **Use in traffic**

Using the ConnectClip can distract you. Be aware of your surroundings while using the ConnectClip. Please refer to national traffic laws regarding the use of communication devices while in traffic.

### **Use on aircraft**

Your ConnectClip contains Bluetooth. The ConnectClip should not be used on board an aircraft, unless specifically permitted by the flight personnel.

### **Active implants**

Caution must be taken with active implants. If you have an active brain implant, please contact the manufacturer of your implanted device for information about the risk of disturbance.

## **Warnings**

### **Rechargeable battery**

Do not attempt to open the ConnectClip, as this may damage the battery.

Never attempt to replace the battery. If battery replacement is needed, please return your device to the supplier. The service guarantee is void if there are signs of tampering.

The safety of recharging batteries using a USB connector is determined by the external equipment. When the USB connector is connected to equipment plugged into a wall outlet, this equipment should be UL approved or comply with IEC-60065, IEC-60950 or other equivalent safety standards.

### **Connection to external equipment**

The safety of the use ConnectClip when connected to external equipment (via auxiliary input cable, via USB cable, or directly), is determined by the external equipment. When connected to external equipment plugged into a wall outlet, this equipment must comply with IEC-60065, IEC-60950 or equivalent safety standards.

## Warnings

### **Cross control**

Your ConnectClip should be kept out of reach of children or anyone who might take control of the functionality, to ensure your personal safety and avoid incorrect use.

### **Use of lanyard**

If by accident the lanyard is caught on something while wearing it, the lanyard is designed to break automatically. Therefore, never try to shorten or modify the lanyard in an unauthorised way. The lanyard should not be used by children under 36 months of age.

### **Possible side effects**

The otherwise non-allergenic materials used in your ConnectClip may in rare cases cause a skin irritation or other side effects. Please consult a doctor if these conditions occur.

## Warnings

### **Mobile phone compatibility**

Please refer to [www.oticon.global](http://www.oticon.global) for a list of mobile phones that have been tested comprehensively by Oticon, and have been found to fulfil the minimum requirements for compatibility at the time of testing. However, Oticon takes no responsibility for such compatibility in general. Specifically, Oticon shall not be responsible for incompatibility resulting from future updates of the mobile phones, nor from events of incompatibility not covered by and/or found in these tests. Oticon takes no financial responsibility in terms of reimbursements of mobile phones that do not work as expected.

Before purchasing a new mobile phone, you are advised to consult the list mentioned above.

## Technical information

### Conditions of Use:

Operating humidity: 15% to 93% relative humidity, non-condensing.

Operating temperature: 5-40 °C

Storage and transportation: -25-70 °C

The ConnectClip contains a radio transceiver using Bluetooth EDR, Bluetooth Low Energy (BLE) and a proprietary short range radio technology all working at 2.4 GHz. The 2.4 GHz radio transmitter is weak and always below 17 dBm e.i.r.p. in total radiated power.

The ConnectClip complies with international standards concerning radio transmitters, electro-magnetic compatibility and human exposure.

Due to the limited space available on the ConnectClip, relevant approval markings can be found in this booklet.

### USA and Canada

This device contains a radio module with the following certification ID numbers:

FCC ID: ZACAHAC01

IC: 11936A-AC01

The device complies with Part 15 of the FCC Rules and with Industry Canada's licence-exempt RSSs.

### Operation is subject to the following two conditions:

- (1) this device may not cause harmful interference, and
- (2) this device must accept any interference received, including interference that may cause undesired operation.

Changes or modifications not expressly approved by the party responsible for compliance could void the user's authority to operate the equipment.

This Class B digital apparatus complies with Canadian ICES-003.



**Note:** *This equipment has been tested and found to comply with the limits for a Class B digital device, pursuant to part 15 of the FCC Rules. These limits are designed to provide reasonable protection against harmful interference in a residential installation. This equipment generates, uses and can radiate radio frequency energy and, if not installed and used in accordance with the instructions, may cause harmful interference to radio communications. However, there is no guarantee that interference will not occur in a particular installation. If this equipment does cause harmful interference to radio or television reception, which can be determined by turning the equipment off and on, the user is encouraged to try to correct the interference by one or more of the following measures:*

- Redirect or relocate the receiving antenna.
- Increase the separation between the equipment and receiver.
- Connect the equipment into an outlet on a circuit different from that to which the receiver is connected.
- Consult the manufacturer or an experienced radio/TV technician for help.

## **International warranty**

Your ConnectClip is covered by an international limited warranty issued by the manufacturer for a period of 12 months from the date of delivery. This limited warranty covers manufacturing and material defects in the device itself, but not in accessories such as e.g. batteries, cables, power supplies, etc. Problems arising from improper/incorrect handling or care, excessive use, accidents, repairs made by an unauthorised party, exposure to corrosive conditions, damage due to foreign objects entering the device or incorrect adjustments are NOT covered by the limited warranty and may void it. The above warranty does not affect any legal rights that you might have under applicable national legislation governing sale of consumer goods. Your hearing care professional may have issued a warranty that goes beyond the clauses of this limited warranty. Please consult him/her for further information.

### **If you need service**

Take your ConnectClip to your hearing care professional, who may be able to sort out minor problems and adjustments immediately.

The manufacturer declares that this ConnectClip is in compliance with the essential requirements and other relevant provisions of Directive 2014/53/EC. The declaration of Conformity is available from the manufacturer.



SBO Hearing A/S  
Kongebakken 9  
DK-2765 Smørum  
Denmark  
[www.oticon.global](http://www.oticon.global)



Waste from electronic  
equipment must be  
handled according to  
local regulations.



## Index

### A

- A2DP device. *See* Music wireless
- Accessories 64
- Aircraft, use on 14
- Android 48
- Answer a call 36
- Antenna 16
- App 48
- Audio (music) 50
  - Cable 50
  - Listen to music 50
  - Wireless 54

### B

- Battery 26
  - Capacity 26
  - Charge time 26
  - Life 26

- Low 24
  - Rechargeable 22
- Belt clip 18
- Bluetooth 54

### C

- Call
  - Answer 36
  - End 36, 38
  - Make 38
  - Reject 40
  - Transfer 41
- Cars, use in 14
- Changing programs 28
- Charger 22
- Charging 22
- Chemicals 62
- Cleaning 62, 63
- Clear pairing 32

### Computer

- Headset cable 52
  - Music/audio cable 50
  - Music/audio wireless 54
- ### ConnectLine
- Microphone 44
  - Phone 42
  - TV 46

### E

- Earphones. *See* Headset
- End the call 38
- Euro pin socket. *See* FM

### F

- First-time use 16
- FM 60

### H

- Headphone. *See* Headset
- Headset 9
  - Cable 52
  - Mobile phone 35
  - Splitter cable 52
  - Wireless 54, 56
- Headset cable 52
- Headset splitter cable 52
- Heat 62
- Humidity 62

### I

- Indication for use 3
- Instrument view 11
- Interference 13, 68
- iPhone 48

**L**

- Landline phone 42
- Last number redial 40
- Listen to audio 50
- Listen to music 50

**M**

- Maintenance 63
- Make a call 38
- Microphone 44
- Microphone inlet 11
- Mini jack 11
- Mini jack cable 50, 52
- Mobile phone 35
- Mobile phone compatibility 15
- MP3 player 54
- Music 54
  - Cable 50
  - Listen to music 50
  - Wireless 54

**Mute 28**

- Muting the hearing instruments 28

**N**

- Neck loop 16

**P**

- Pairing 30
  - Clearing 32
  - Mode 30
- PC. See Computer
- Personalising 40
- Phone solution 42
- Pin code 31
- Power off/on 20
- Protective skin 64

**R**

- Rechargeable battery 22
- Reject call 40
- Remote control 28

**S**

- Sound. See music
- Spare parts 64
- Splitter 9
- Splitter cable 52

**T**

- Talking on the phone 43
- T-coil 58
- Technical information 67
- Tele loop 58
- Transfer call 41
- TV 46

**V**

- Voice dial 40
- Volume up/down 28

**W**

- Warnings 12, 13, 14, 15
- Wireless 54, 56
- Without the neck loop 18



oticon  
PEOPLE FIRST