

156mm

RISE POWER STAND

Rise Power Stand is a premium headphones charging stand with a wireless charging pad for your smartphone. A built in USB power port means Rise is compatible with all rechargeable over-ear and on-ear headphones. A machined and anodized aluminum arm keeps your premium headphones showcased and at hand. The 12W Qi wireless charging pad at the base keeps your phone powered up and ready to go. With premium finishes and a compact footprint, Rise is the perfect way to keep your favorite accessories powered.

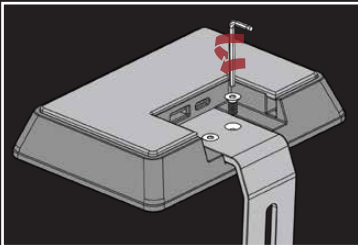

① Assemble headphones rest to base with included screws and tool. Do not over tighten.

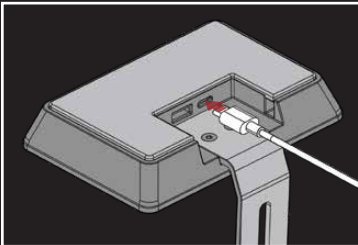

② Connect the included USB-C cable to Rise and the included wall adapter.

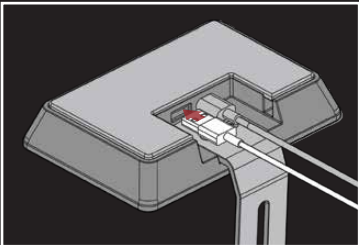

③ Connect the appropriate USB cable (not included) to charge your headphones.

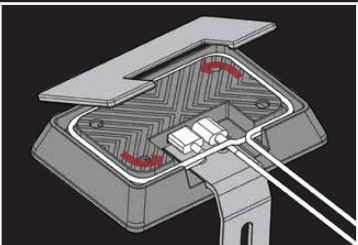

④ Open the bottom cover to use the optional cable management and shorten the headphone charging cable.

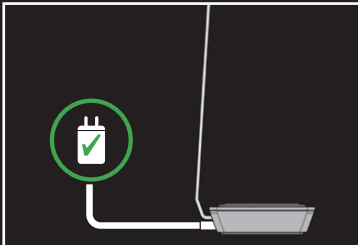

⑤ Connect the wall adapter to power.

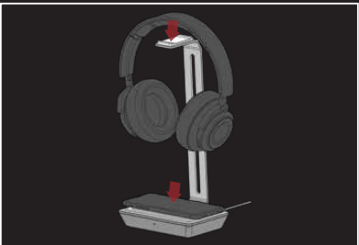

⑥ Place your phone face up as shown to begin wirelessly charging. Rest your headphones as shown and connect headphones charging cable to charge.

Rise Power Stand only works with the included cable and power adapter. Do not connect this charger to your computer or use with power adapters other than the one included.

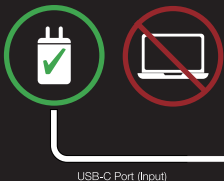

USB-C Port (Input)



Headphone is being charged with USB port

The wireless charging pad can be used to charge any Qi capable devices.

1. **White Solid:** device is detected and charging if needed. Light will not change between charging/fully charged status.

2. **Red Blinking:** non-compatible object, like coins or keys, are placed on the wireless charging pad. It isn't accurate that the LED will turn on if the watch is not placed accurately.

Inside

- Pantone 7622C
- Pantone 432C

FOLDING REFERENCE

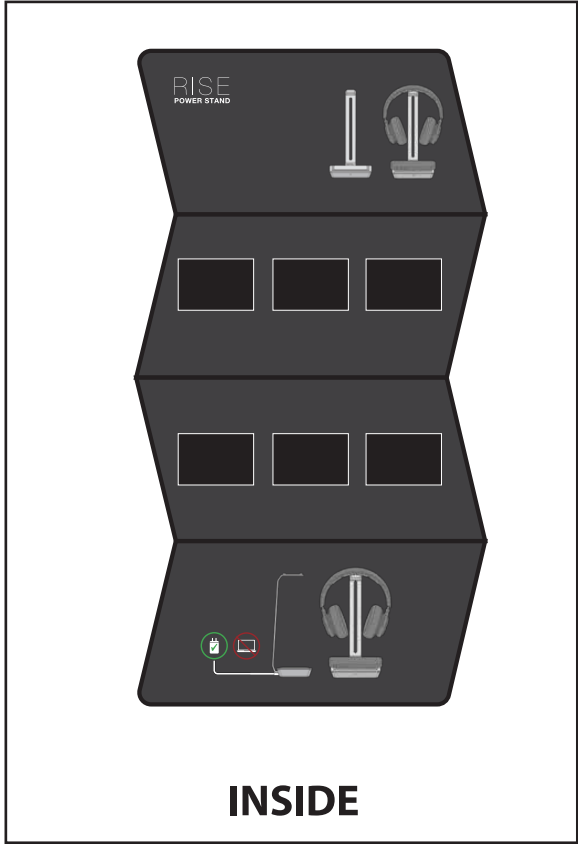

INSIDE



156mm

Outside

- Pantone 7622C
- Pantone 432C

FOLDING REFERENCE



OUTSIDE



260mm

RISE
POWER STAND

FCC Caution: This device complies with part 15 of the FCC Rules. Operation is subject to the following two conditions: (1) This device may not cause harmful interference, and (2) this device must accept any interference received, including interference that may cause undesired operation.

Any Changes or modifications not expressly approved by the party responsible for compliance could void the user's authority to operate the equipment.

Note: This equipment has been tested and found to comply with the limits for a ClassB digital device, pursuant to part 15 of the FCC Rules. These limits are designed to provide reasonable protection against harmful interference in a residential installation. This equipment generates uses and can radiate radio frequency energy and, if not installed and used in accordance with the instructions, may cause harmful interference to radio communications. However, there is no guarantee that interference will not occur in a particular installation. If this equipment does cause harmful interference to radio or television reception, which can be determined by turning the equipment off and on, the user is encouraged to try to correct the interference by one or more of the following measures:

- Reorient or relocate the receiving antenna.
- Increase the separation between the equipment and receiver.
- Connect the equipment into an outlet on a circuit different from that to which the receiver is connected.
- Consult the dealer or an experienced radio/TV technician for help.

***RF warning for Mobile device:** This equipment complies with FCC radiation exposure limits set forth for an uncontrolled environment. This equipment should be installed and operated with minimum distance 20cm between the radiator & your body.

RAPTIC™

Questions

Email: support@RapticStrong.com

www.RapticStrong.com

[f](#) [@](#) [t](#) RapticStrong