

USER MANUAL
V 1.1

Compatible with GoPro®

HERO5

Black, Session™
& HERO4, 3+, 3,
Session™

S1

Smartest Gimbal Stabilizer for GoPro®

REMOVU®

TABLE OF CONTENTS

1. Parts	3
2. Getting Started	6
3. Gimbal Mode	10
4. How to use the Remote Control	12
5. Calibration of Gimbal	13
6. How to use Low Angle	14
7. Firmware Upgrade	15
8. Technical Specs	15
9. Safety Instructions	16
10. Warranty Information	18

Join REMOVU Family

Website www.removu.com



Facebook.com/removuglobal



Instagram.com/removu



Twitter.com/removuglobal



Youtube.com/removu

1. Parts

Part Names

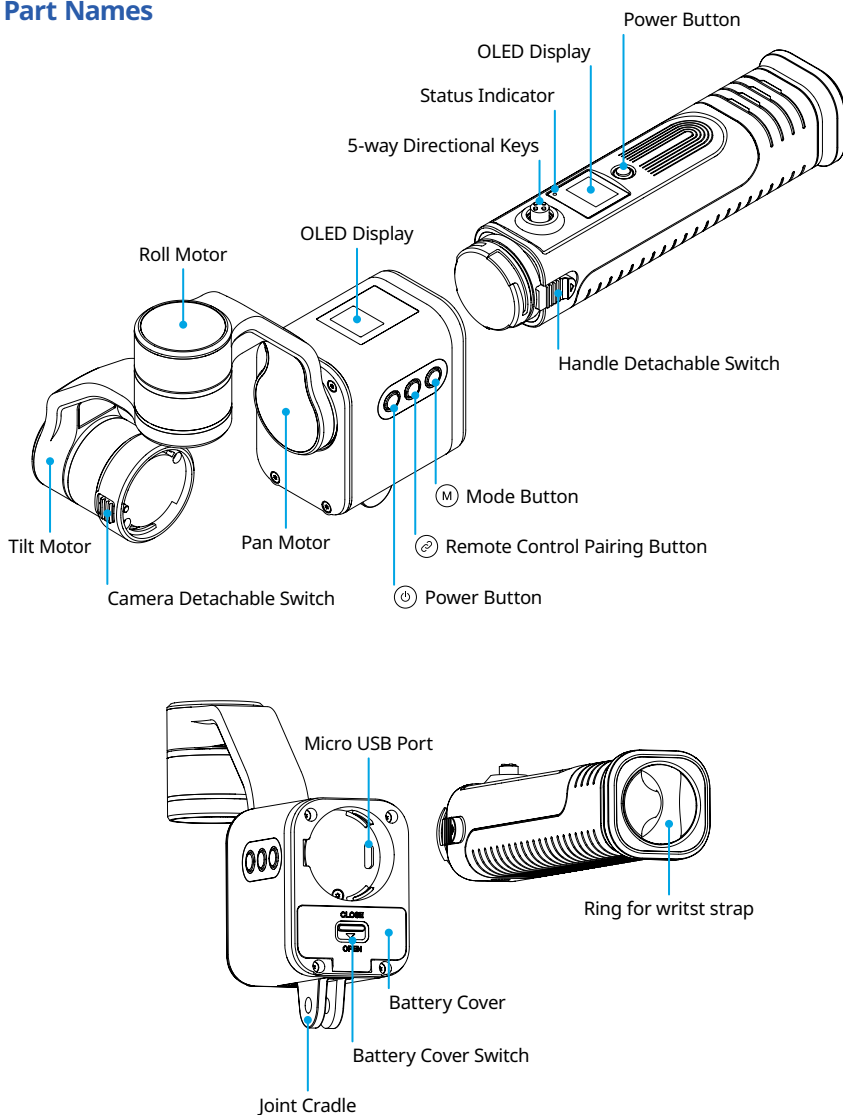

OLED Display Indicators

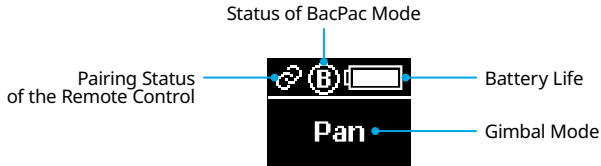

How to attach the handle to the S1

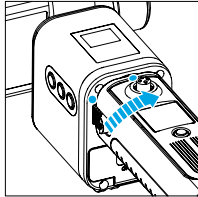
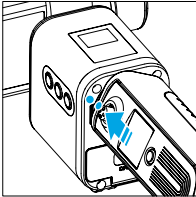

To attach the handle:

There are white dots located on the S1 and the handle. Align the white dot on the handle with the white dot on the S1 and then turn the handle clockwise until the handle is locked.

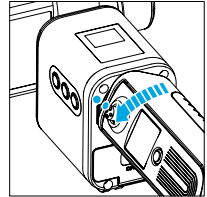
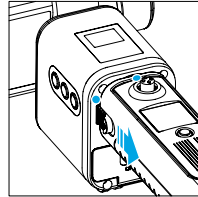

To detach the handle:

While pushing down on the handle's detachable switch, turn the handle counter-clockwise.

How to remove the Remote Control

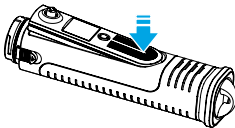

Firmly press on the bottom of the remote control until the remote control pops up from the handle.

How to detach the Cap on the S1 Handle

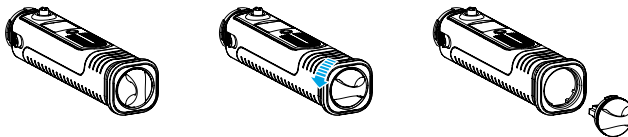

To detach, turn the cap on the S1 Handle counter-clockwise.

To attach, turn the cap on the S1 Handle clockwise.

How to store SD Card inside of the Cap on the S1 Handle

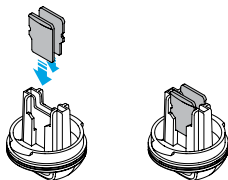

There are dual micro SD slots inside the cap on the S1 handle.

How to use the charger

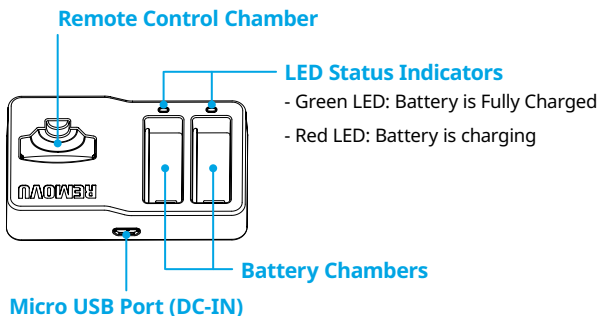

Note: Recommended use with a 5V/2A adaptor.

If you use adaptor that is less than 5V/2A, please charge only one S1 battery.

Note: You CANNOT use gimbal and remote control while charging.

The gimbal and remote control operate only battery.

2. Getting Started



Warning

- Connect a compatible camera to the S1 gimbal. DO NOT turn the power on without a camera connected to the S1 gimbal. It may cause malfunctions.
- Turn the power on the camera before turning on the gimbal.
- Hold the gimbal steady while powering on the gimbal.
- After used S1 on the beach, please wash the S1 with running fresh water. Do not dive S1 under the water.

2-1. HERO5 Users

Step 1. Insert the camera into the frame housing

Unhook the latch on the top right side of frame housing and slide the camera into frame housing. Close the latch to secure.

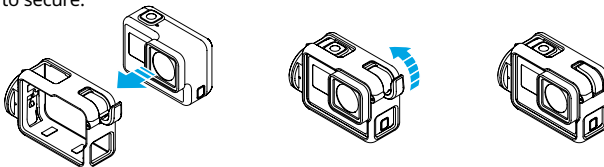

Step 2. Turn the power on the camera

Cam's power can be turned ON/OFF using the button below the joint.

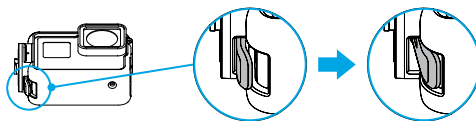

Step 3. "Wind Only" on MANUAL AUDIO CONTROL of HERO5

Please select "Wind Only" on MANUAL AUDIO CONTROL of HERO5 to use with S1.

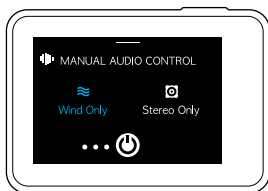

Note: If you do not select this option or select "Stereo Only", noise can be recorded.

Step 4. Mount Camera Housing on to S1 Gimbal

There are white dots located on the S1 gimbal and the housing. Align the white dot on the housing with the white dot on the S1 gimbal and then turn the housing clockwise until it is locked into place.

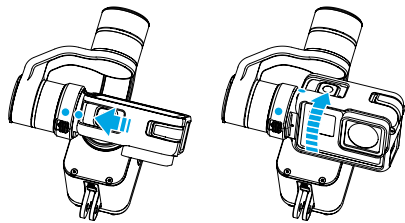

Step 5. Attach the balance weight cap on the tilt motor

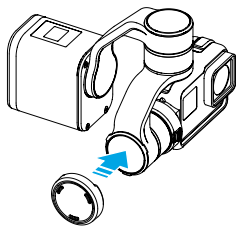

Note: If using S1 without the weight balance cap, it have effect on operating and usage time. Please check that weight balance cap is firmly attached to the S1 before operating the gimbal.

Step 6. Insert Battery into S1

Slide the Lock switch to the open position and open the lid. After inserting the battery, close the lid and slide the Lock switch to the close position.

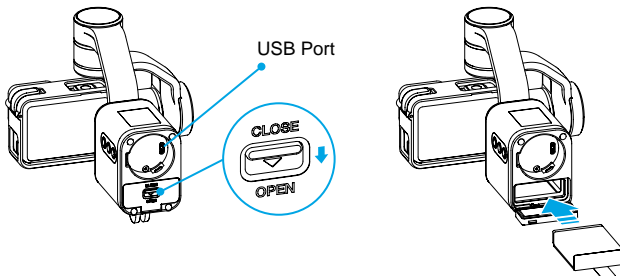

Step 7. Powering On & Using BacPac Mode

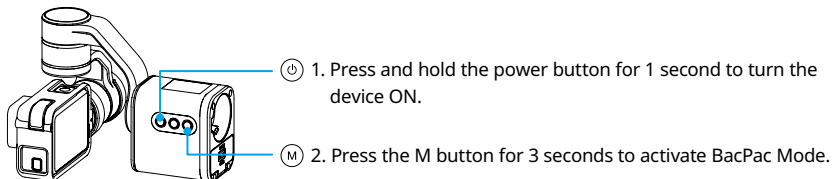

2-2. HERO3, 3+, 4 Users

Step 1. Insert the camera into the frame housing or the rainproof housing

- Frame Housing: Unhook the latch on the top right side of frame housing and slide the camera into frame housing. Close the latch to secure.

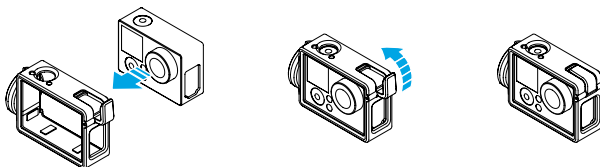

- Rainproof Housing: Place the camera inside the rainproof housing. Then, attach the bottom of the backdoor to the housing, then attach the top of the backdoor to the housing until they click into place.

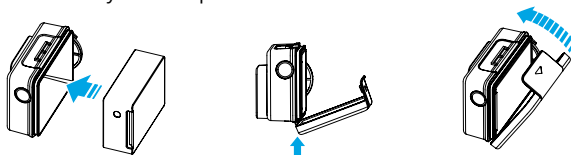

Step 2. Mount Camera Housing on to S1 Gimbal

There are white dots located on the S1 gimbal and the housing. Align the white dot on the housing with the white dot on the S1 gimbal and then turn the housing clockwise until it is locked into place.

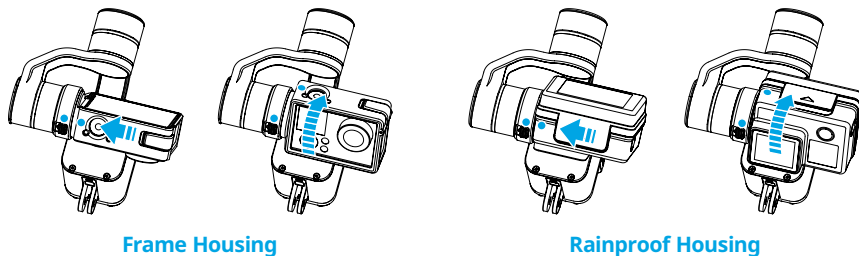

Step 3. Insert Battery into S1

Slide the Lock switch to the open position and open the lid. After inserting the battery, close the lid and slide the Lock switch to the close position.

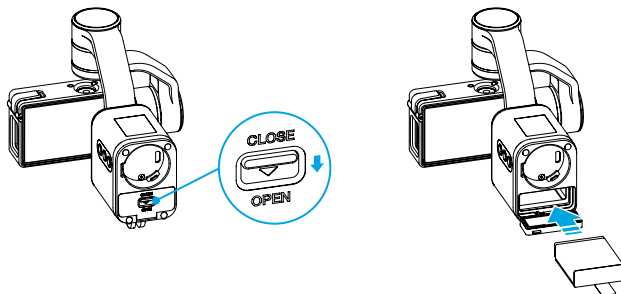

Step 4. Powering On and Off

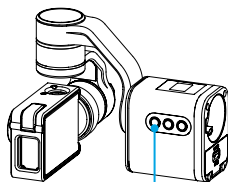

⏻ Press and hold the power button for 1 second to turn the device ON/OFF.

3. Gimbal Mode

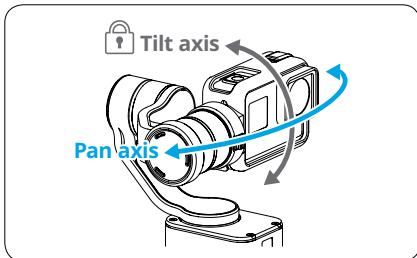

Pan Mode

Tilt and Roll are fixed and camera is permitted to pan left or right.

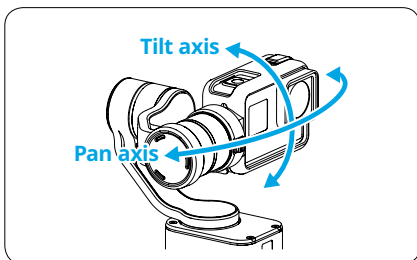

Follow Mode

Camera is permitted to pan left or right and tilt up and down, while Roll is fixed.

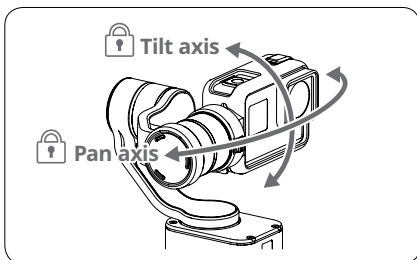

Lock Mode

Camera stays in its current orientation. All Pan / Tilt / Roll are fixed.

Changing Modes

- Gimbal modes can be changed by pressing the mode button.
Modes are cycled in the following order: Pan ► Follow ► Lock

How to use BacPac Mode

BacPac Mode is for using S1 with GoPro LCD Touch BacPac or Battery BacPac.

1. After attaching the BacPac to GoPro camera, place GoPro camera inside rainproof housing and close the housing backdoor using extension backdoor.

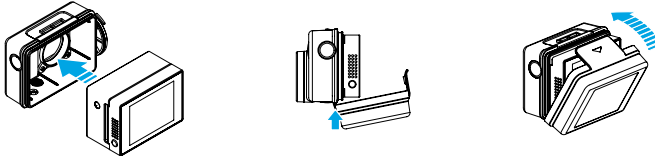

2. In order to get the best performance, please attach the balance weight cap on the tilt motor.

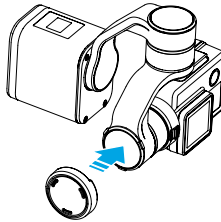

Note: If using S1 without the weight balance cap, it have effect on operating and usage time. Please check that weight balance cap is firmly attached to the S1 before operating the gimbal.



3. Press the M button for 3 seconds to activate BacPac Mode.

4. How to use the Remote Control

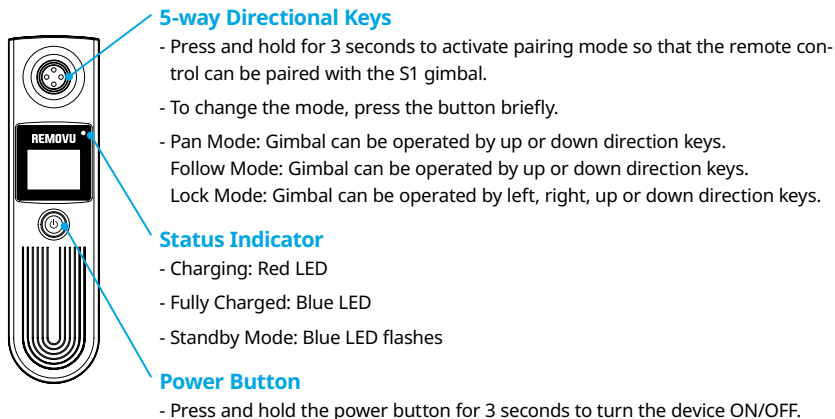
Part Descriptions



Pairing

1. Connect a camera to the gimbal.
2. Turn the power on the gimbal.
3. After the gimbal has powered on, press and hold the pairing button for 3 seconds until the  flashes on the OLED display.
4. Turn the power on the remote control.
5. After the remote control has powered on, press and hold the 5-way direction key for 3 seconds until the OLED displays the pairing icon.
6. Once pairing is complete, the OLED display  to indicate that the remote control and gimbal are paired and connected. The remote control can now be used with the gimbal.

Note: You only need to follow the steps above once. Afterwards, the S1 and remote control will connect automatically.