

# REMOVU<sup>®</sup>

WiFi live view monitoring  
of GoPro

QUICK START GUIDE

# ESSENTIALS

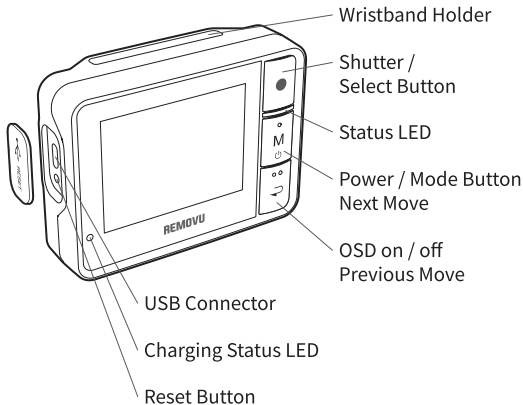

## HOW TO START

1. Turn your camera on  
and turn camera WiFi on.
2. Turn REMOVU on by pressing [ **M** ] button for 1 sec.

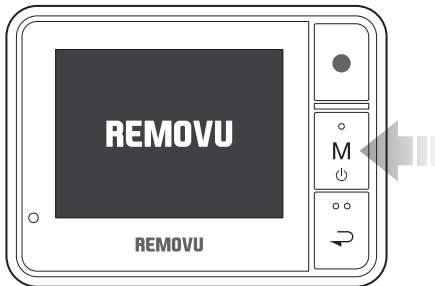

3. When WiFi list shows up,  
select a SSID that you want to connect.

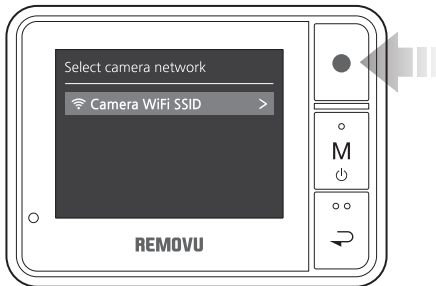

4. Enter 8 the password of the camera SSID.  
The password is 8 digits.  
If less digits, enter button will not be activated.

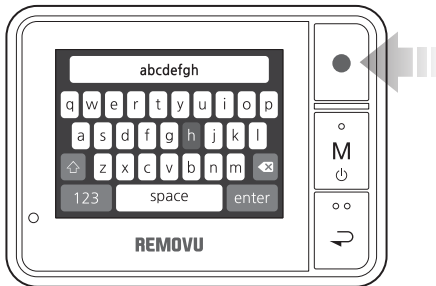

5. If WiFi is connected with the camera,  
live view will show up on REMOVU display.  
Camera's current mode is on REMOVU.  
If you want to change capture mode, press [ **M** ] button.

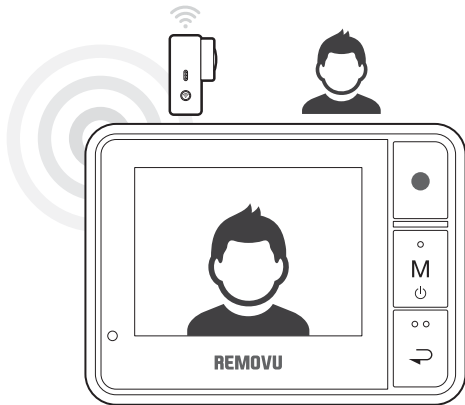

# MENU TREE



VIDEO



PHOTO



BURST  
PHOTO



TIME  
LAPSE



CAMERA  
SETTINGS



REMOVU  
SETTINGS



VIDEO  
RESOLUTION



PHOTO  
RESOLUTION



CONTINUOUS  
PHOTO



BURST  
PHOTO



TIME  
LAPSE



DELETE



BRIGHTNESS



CAMERA  
NETWORK



LANGUAGE



SYSTEM  
INFO



FIRMWARE  
UPDATE

## CHARGING

- Plug REMOVU into a PC with Micro USB cable in the package.

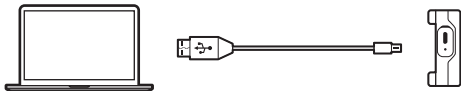

- Plug REMOVU into a USB wall charger (not provided with REMOVU) to charge faster. GoPro charger or iPhone charger will work well.

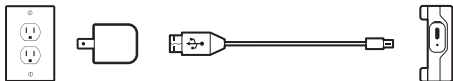



## IN THE BOX

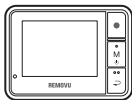

SET

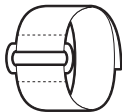

WRISTBAND

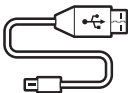

USB CABLE



QUICK GUIDE

# CUSTOMER SUPPORT

REMOVU is dedicated to providing the best possible service. To reach REMOVU customer support, please visit **[www.removu.com](http://www.removu.com)**.

You may find a proper answer from FAQ.

If there is no answer, please send us a message to us on our website. We will get back to you very soon.

## **FCC Declaration Of Conformity**

This device complies with Part 15 of the FCC Rules. Operation is subject to the following two conditions: (1) This device may not cause harmful interference, and (2) This device must accept any interference received, including interference that may cause undesired operation.

### **Caution:**

Any changes or modifications in construction of this device which are not expressly approved by the party responsible for compliance could void the user's authority to operate the equipment.

**Note:**

This equipment has been tested and found to comply with the limits for Class B digital devices, pursuant to Part 15 of the FCC rules. These limits are designed to provide reasonable protection against harmful interference in a residential installation. This equipment generates, uses and can radiate radio frequency energy and, if not installed and used in accordance with the instructions, may cause harmful interference to radio communications.

However, there is no guarantee that interference will not occur in a particular installation. If this equipment does cause harmful interference to radio or television reception, which can be determined by turning the equipment off and on, the user is encouraged to try to correct the interference by one or more of the following measures:

- a. Reorient or relocate the receiving antenna
- b. Increase the separation between the equipment and receiver
- c. Connect the equipment into an outlet on a circuit different from that to which the receiver is connected
- d. Consult the dealer or an experienced radio/TV technician for help

**This device(FCCID: 2AC73-RMVR1) complies with FCC SAR requirement.**

**Caution:**

Risk of explosion if battery is replaced by an incorrect type.  
Dispose of used batteries according to the instructions.

**REMOVU®**  
www.removu.com

REMOVU® by essel-t co., ltd.

Copyright 2014 essel-t co., ltd. All Rights Reserved. Patents Pending.

REMOVU® is a trademark of essel-t co., ltd. registered in the U.S. and other countries.

GoPro® is a trademark of GoPro Inc., registered in the U.S. and other countries.