

Size: 8.4*7CM

TRUE WIRELESS EARPHONES

Manual

Model: EB0203



About pairing:

1. Pairing with one earbud: Long press the Multi-Function button until the LED flashing in red and blue alternately, then turn on the Bluetooth on your device and select "EKBTPE32" on your list, (there would be reminding voice saying connected), then you could enjoy music or making phones calls. It supports reporting incoming calls.

2. Pairing with both sides:

A. Long press the multi-function buttons of both sides at the same time until the led flashing in red and blue alternately, then double click EITHER side to enter pairing mode, (there would be reminding voice "ready for connection") then turn on the Bluetooth on your device and choose "EKBTPE32" to connect. When the led flash slowly in blue (3-5s), they pair successfully with voice.

Note: The call only support single side Bluetooth earphone, shut down, play and suspension can be controlled by any one of the multi-function keys connected earphone, and another headset will be synchronized control. The boot will be directly long press the multi-function button to turn on automatically back at the next time.

Bluetooth usage:

1. Making phone calls:
Be sure the earphone connected with your mobile phone, and then you can make phone calls. When making calls, there is only one side earphone working, and there is incoming call, it would broadcast calling numbers. You answer the call by slightly press the power button one time and refuse to answer by quick press the power button 2 times. When the earphones are in music mode, you dial your latest number by quick press the power button 2 times (redial the latest number).

1

2. Listening to music:

Be sure the earphone connected with your mobile phone, then you can listen to music on your music list. Shortly press the power button to stop the music and replay by press again.

3. Power off.

Long press the power button until led in red when not use, the Bluetooth device enter off mode. It would be power off automatically when the earphone away from your Bluetooth device over 5 minutes. No need to worry power exhausted.

4. Charging:

There is reminding sound when battery is low, and the led would flash in red at the same time. When taking charge, the led would be in red, and turns in blue when fully charged.

Note: the earphone would be forced to shut down when charging even if they are power ON before charging.



2

Warnings:

1. Please do not overuse this earphone or put it under heavy pressure, keep away from moist and heat.

2. Keep away from WIFI, router or other high frequency transmitting equipment to prevent interruption of signal receiving.

3. Please use this earphone under its working range (10meters), and the effect would be better if there is no obstacle between the connected devices.

4. Use this Bluetooth earphone to connect any device with Bluetooth function

Made in China

3

Summary

- 1 Dust-proof mesh
- 2 Multi-function button
- 3 MIC
- 4 Charging port
- 5 Charging Box Light
- 6 Android Charging port

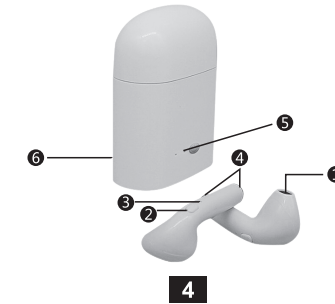

FCC STATEMENT :

This device complies with Part 15 of the FCC Rules. Operation is subject to the following two conditions:

- (1) This device may not cause harmful interference, and
- (2) This device must accept any interference received, including interference that may cause undesired operation.

Warning: Changes or modifications not expressly approved by the party responsible for compliance could void the user's authority to operate the equipment.

NOTE: This equipment has been tested and found to comply with the limits for a Class B digital device, pursuant to Part 15 of the FCC Rules. These limits are designed to provide reasonable protection against harmful interference in a residential installation. This equipment generates uses and can radiate radio frequency energy and, if not installed and used in accordance with the instructions, may cause harmful interference to radio communications. However, there is no guarantee that interference will not occur in a particular installation. If this equipment does cause harmful interference to radio or television reception, which can be determined by turning the equipment off and on, the user is encouraged to try to correct the interference by one or more of the following measures:

- Reorient or relocate the receiving antenna.
- Increase the separation between the equipment and receiver.
- Connect the equipment into an outlet on a circuit different from that to which the receiver is connected.
- Consult the dealer or an experienced radio/TV technician for help.

RF warning statement:

The device has been evaluated to meet general RF exposure requirement. The device can be used in portable exposure condition without restriction.