

设定操作

7

设定页面

- 管理员设置 (Administrator Setting)
- WiFi设置 (WiFi Setting)
- Station模式 (Station Mode)
- 一般设定 (Common Setting)

1. 管理员设置-更改管理者密码

预设密码为12345678,
待填入欲更改密码并再次确认后, 点击“确认”键或是
透过勾选Remember Me记忆密码, 以加速日后操作。
*勿将密码透漏于他人知晓

2. WiFi设置-更改装置名称以及加入密码

于SSID与Password位置填入欲更改资料后,
点击“确认”键进行更改。
*更改后, meCloud将会重开机重新连线
*建议设定连线密码已避免他人误连

3. Station模式

将meCloud与路由器连接之功能, 行动装置便可透过
路由器直接访问meCloud, 而不需再连结meCloud。
当按下搜寻后, 选择附近无线网络并输入该网路密码,
接着勾选Enable并点击“确定”键, 即可连至该网路。

4. 一般设定

韧体更新-透过此功能让装置更新至最新版本。
清除快取-清除暂存行动装置内之档案。
关于我们-公司与产品资讯。

编辑功能图示说明

8



编辑功能图示说明

9



*上传单一档案大小最大不超过4GB
*系统默认meCloud内档案均为上锁, 分享档案前请先
进行解锁。
*使用一键上传时, 将自动于meCloud该分类资料夹内
建立以该行动装置为名称的资料夹。

简易故障排除

当系统无法正常使用或无法正常关机的状态出现时,
请使用尖状物插入meCloud底部小孔(Reset)处, 轻轻
按压一下即可重启系统

*恢复出厂设定(将系统回复为出厂预设值):
关机状态下, 长按电源按钮约15秒, 当双灯亮起又熄灭时, 表示系统已回复
为出厂预设值

Introduction

1

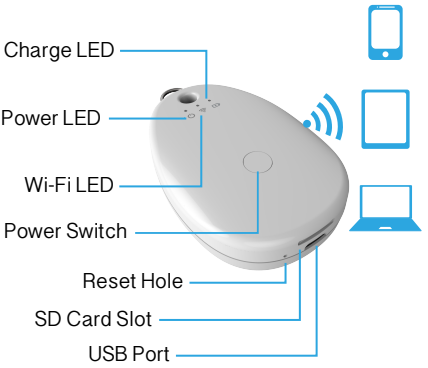

Indicator Description

Indicator LED	Status	Details
Power	Light On / Light Off / Light Flash	ON / OFF / Low power
Wi-Fi	Light Flash / Light Off	WiFi ON / WiFi OFF
Charge	Light On / Light Off	Charging / Fully charged

Supported Formats

2

Supported Formats	
Music	mp3, wav, wma, m4a, aac
Film	avi, mov, 3gp, mp4, rmvb, wmv
Photo	jpg, jpeg, tiff, png, gif, bmp
Document	pdf, xls, xlsx, doc, docx, ppt, pptx, txt

*The formats of playing and viewing
are based on mobile devices.

Features

- Easy to use.
- Easy to carry.
- Support micro SD/SDHC(up to 32GB).
- File backup and sharing management.
- Wireless transmission to share music, videos, photos, documents.

Specification and System/ App. Requirements

3

Dimension and Weight : 70x48x16(mm) / 42(g)
Micro SD card : Support SD/SDHC(up to 32GB)
Battery capacity : Li-Battery 700(mAh)
USB / Wireless Connectivity: USB2.0 ~ 802.11 b/g/n

System Requirements: (for PC only)

- Microsoft Windows XP/ Vista/ 7
- Mac OSX 10.5 or above

App Requirements:

- iOS devices : 4.3.3 or above
- Android devices : 2.3.3 or above

Notice

- Change the administrator password and configure meCloud name/ set password(Recommend to use)
- The maximum playing time will depend on numbers of connecting user and video resolution.
- Wi-Fi data transmission speed may different due to environmental of user device, distance, and the number of users.
- Please charge power at the first time of use.
- Please do not take out the SD card during power-on stage.

File storage location

4

The meCloud App. will automatically create meCloud folder and 4 sub-function(Photo, Film, Music, Document) folders. Pls. don't remove those folders, which will impact App's efficiency.

- Please backup each different file into correct folder during file management.
- During backup, the app will create a new folder (mobile device name) under each functional folder.

Mode instruction

USB mode: (for PC only)

1. Power off meCloud.
2. Connecting meCloud to PC with USB cable.
3. Power On the meCloud acting as a storage device and transfer data through the USB cable.

This mode is available for charging the battery, but unavailable for the Wi-Fi mode function.

Wi-Fi mode:

Search free App [meCloud] and the App provides easy backup and sharing all your photos, videos, music and documents.

*Detailed procedures as described on next page.

Wi-Fi mode procedures

5

Step 1:
Insert the micro SD card.

Step 2:
Press power switch to turn on "meCloud" device.

Step 3:
Download the free App [meCloud] from App Store (iOS) or Google Play(Android) and run the App.

Step 4:
If unconnected with meCloud, the App will appearing "Without the device", pls. select "setting", choose "meCloud_XXXX" to enable the Wi-Fi connection.



Wifi mode procedures

6

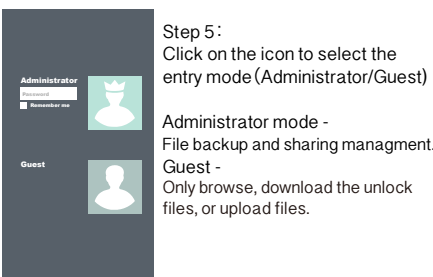

Step 5:
Click on the icon to select the entry mode (Administrator/Guest)

Administrator mode -
File backup and sharing management.
Guest -
Only browse, download the unlock files, or upload files.

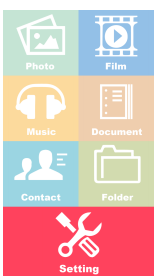

Step 6:
Start Main page.
Enjoy the meCloud !!

Setting

7

- Administrator Setting
- WiFi Setting
- Station Mode
- Common Setting

1. Administrator Setting

Default password is **12345678**,
After typing password and click "Remember me"
for mobile device future use.
*Do not revealed the password to others.

2. WiFi Setting

Configure device name & password, then tap
"Confirm".
*After setting is completed, meCloud will restart.
*Configure password to avoid others connect.
(Recommend to use)

3. Station mode

If you want connect internet via meCloud, you have
to connect meCloud to a wireless network.
Tap "Search" to select an available wireless networks,
and enter the password, then tap "Enable" --> "Confirm"

4. Common Setting

Firmware update-Keep meCloud device up-to-date
with the latest firmware version.
Clear Cache-Clear cache in mobile device.
About me-Information of company and product.

User interface

8

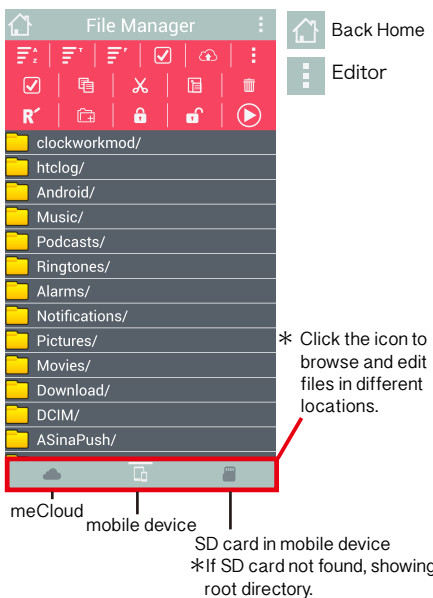

meCloud mobile device
SD card in mobile device
*If SD card not found, showing root directory.

File management operations

9

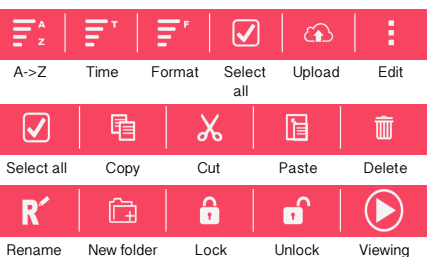

*Support maximum 4GB single file upload.
*The files are locked under default meCloud folder,
pls. unlock file before sharing.
*When meCloud App doing backup, meCloud App will
automatically create a new folder(mobile device name)
under each functional folder.

Troubleshooting

When the meCloud is not available or can not
shutdown, pls. insert a small rod into the reset
hole to reset meCloud.

*Back to factory setting:
Under device power off, click power button about 15s to restart
the device.

保固卡

親愛的用戶
非常感謝您使用meCloud系列產品, 以下請您確認

產品型號:

產品序號:

購買日期:

維修日期:

聯絡方式:

1. 本保固卡為高思高精密電子科技對meCloud產品之售後服務憑證
2. 保固以購買日為起算日, 消費者應妥善保存購買發票或其他相關證明以維護權益
3. 產品上若無meCloud序號或難以辨識或非經高思高精密電子科技有限公司認可之代理進口商時, 恕不提供任何保固或售後服務若需維修, 請洽原購買處
4. 消費者自購買產品七日內, 發生產品不良或故障時, 得憑銷售憑證, 以原箱包裝並備齊配件, 向原經銷商更換, 逾期則以維修方式處理
5. 產品送修時, 請以原廠包裝或適當材料包裝, 如因包裝不當導致運送中發生損壞, 本公司恕不提供保固
6. 產品因下列原因發生不良或損壞時, 不在保固範圍內
A. 天災或人為因素(如摔毀、浸水等)
B. 違反產品手冊之使用提示
C. 超出允許使用之環境
D. 私自拆解結構
E. 非正常使用
7. 保固範圍不包含隨機耗材、贈品、包材
8. 保固期限以產品購買日為起算日, 提供一年之售後服務
9. 過保固後, 本公司將視維修情況, 依本公司收費標準收取維修費用
10. 若由網路購買, 為保障您的權益, 請務必加蓋店章

高思高精密電子科技有限公司
Gosgo Precision Electronic Technology Co., Ltd.
地址: 台灣新北市新莊區中正路657號3樓
電話: +886-2-29013395
網址: www.gosgotech.com

Warranty Card

Dear users:

Thanks for using meCloud products, please confirm the following

Model Name:

Serial Number:

Purchase Date:

Maintenance Date:

Contact Us:

1. This limited warranty card is a proof of purchase of Gosgo Precision Electronic Technology Co., Ltd. for meCloud product.
2. To ensure the rights of the customer, please keep the warranty card or proof of purchase(e.g. invoice, receipt, etc.) as it won't be reissued.
3. The warranty would be considered invalid if there is no dealer stamp or if anything on the card is altered or the serial number label is not clear or removed.
4. If the defect was caused through any of the following is not within the scope of warranty
• By force majeure, such as natural disasters like flood or earthquake, etc.
• By human factors, such as misuse, improper repair or alteration of the components.
C. 超出允許使用之環境
D. 私自拆解結構
E. 非正常使用
5. Consumables, gifts and packaging materials are not within the scope of warranty.
6. The limited warranty shall apply to meCloud products for a period of one year from the date of purchase.
7. If the product is repaired after expiration of the warranty, there will be handling charge.
8. Please ask the store or the distributor to fill out the warranty card as your proof of purchase.

Gosgo Precision Electronic Technology Co., Ltd.
Address: 3F, No. 657, Zhongzheng Rd., Xinzhuang Dist.,
New Taipei City, Taiwan, R.O.C.
Tel: +886-02-29019235
Website: www.gosgotech.com

保固卡

亲爱的用户

非常感谢您使用meCloud系列产品, 以下请您确认

产品型号:

产品序号:

购买日期:

维修日期:

联络方式:

1. 本保固卡为苏州高思高精密电子科技有限公司对meCloud产品之售后服务凭证
2. 保固以购买日为起算日, 消费者应妥善保存购买发票或其他相关证明以维护权益
3. 产品上若无meCloud序号或难以辨识或非经高思高精密电子科技有限公司认可之代理进口商时, 恕不提供任何保固或售後服務若需維修, 請洽原購買處
4. 消費者自購買產品七日內, 發生產品不良或故障時, 得憑銷售憑證, 以原箱包裝並備齊配件, 向原經銷商更換, 逾期則以維修方式處理
5. 產品送修時, 請以原廠包裝或適當材料包裝, 如因包裝不當導致運送中發生損壞, 本公司恕不提供保固
6. 產品因下列原因發生不良或損壞時, 不在保固範圍內
A. 天災或人為因素(如摔毀、浸水等)
B. 違反產品手冊之使用提示
C. 超出允許使用之環境
D. 私自拆解結構
E. 非正常使用
7. 保固範圍不包含隨機耗材、贈品、包材
8. 保固期限以產品購買日為起算日, 提供一年之售後服務
9. 過保固後, 本公司將視維修情況, 依本公司收費標準收取維修費用
10. 若由網路購買, 為保障您的權益, 請務必加蓋店章

苏州高思高精密电子科技有限公司
地址: 江苏省苏州高新区狮山路88号金河国际中心810
电话: +86-0512-68185212/13
网址: www.gosgotech.com

Federal Communications Commission (FCC) Interference Statement

This equipment has been tested and found to comply with the limits for a Class B digital device, pursuant to Part 15 of the FCC Rules.

These limits are designed to provide reasonable protection against harmful interference in a residential installation. This equipment generate, uses and can radiate radio frequency energy and, if not installed and used in accordance with the instructions, may cause harmful interference to radio communications.

However, there is no guarantee that interference will not occur in a particular installation. If this equipment does cause harmful interference to radio or television reception, which can be determined by turning the equipment off and on, the user is encouraged to try to correct the interference by one of the following measures:

- Reorient or relocate the receiving antenna.
- Increase the separation between the equipment and receiver.
- Connect the equipment into an outlet on a circuit different from that to which the receiver is connected.
- Consult the dealer or an experienced radio/TV technician for help.

This device complies with Part 15 of the FCC Rules. Operation is subject to the following two conditions:

(1) This device may not cause harmful interference, and (2) this device must accept any interference received, including interference that may cause undesired operation.

FCC Caution: Any changes or modifications not expressly approved by the party responsible for compliance could void the user's authority to operate this equipment.

RF exposure warning

This equipment complies with FCC radiation exposure limits set forth for an uncontrolled environment.

The equipment must not be co-located or operating in conjunction with any other antenna or transmitter.