



OWNER'S MANUAL

UNLEASH YOUR GAME

Congratulations on your ShotTracker TEAM purchase and your commitment to giving your organization every competitive advantage. You can't improve what you don't measure, and ShotTracker TEAM is the easiest, most effective way to capture real-time stats for your entire team. This manual will familiarize you with the system and help you get started.



SHOTTRACKER TEAM IS COMPRISED OF COMPONENTS THAT WORK TOGETHER TO CAPTURE REAL-TIME STATS FOR YOUR TEAM.

BASKETBALL

As part of the system, you will receive ShotTracker enabled basketballs. These are the only balls that work with ShotTracker TEAM. They have a small sensor inside that collects data, but does not impact playability.

PLAYER TAGS

You will need to distribute the enclosed Player Tags to your players. Prior to doing so, label each tag with a player's number using the stickers provided. The tag slides inside the Player Tag Holder, which is worn on the player's shoe. We've also included a charging cord and small storage bag for each Player Tag.

CHARGING STATION

The Player Tag Charging Station has 15 charging ports. We recommend that you collect and store the Player Tags in the Charging Station while they are not in use. Alternatively, you can rely on your players to keep them charged using their individual charging cords.

COURT SENSORS

The Court Sensors were (or will be) professionally installed in your gym based on the unique configuration of your facility. They are not included in this box. They are white and about 8" long. You may be able to see them in the rafters.

SHOTTRACKER TEAM APP

This app is used only by coaches and can only be used on an iPad. It displays data captured by the system for all the players and the team as a whole.

SHOTTRACKER PLAYER APP

This app is used by the players. It displays data captured by the system for the individuals along with key team highlights.



1 CHARGE YOUR PLAYER TAGS

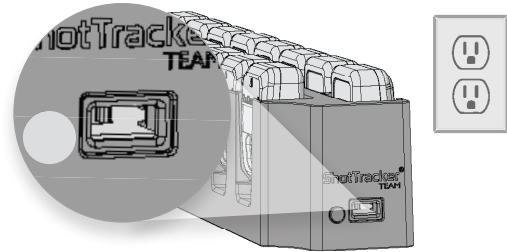

Plug the Charging Station into an electrical outlet using the provided charging cable.

You must use a wall outlet to properly charge the Player Tags. Plugging the USB cable into a computer will not give it enough power to charge the Player Tags.

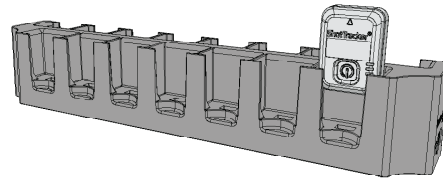

Insert each Player Tag into a port in the Charging Station. The light on the sensor will turn from red to green when fully charged.

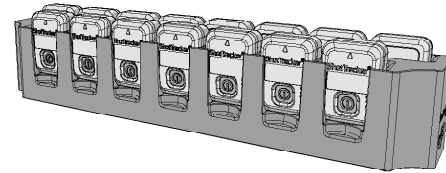

We recommend using the Charging Station when first charging the Player Tags.

Charging takes about 4 hours and will give you approximately 12 hours of playing time.

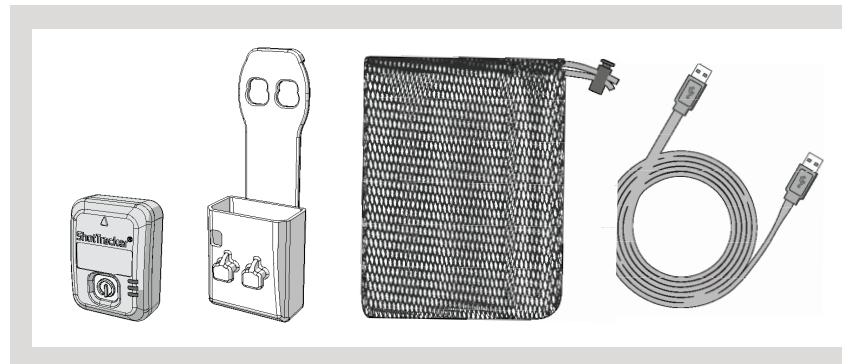

CHARGING CORDS

Each Player Tag box contains a Charging Cord. While we recommend that you collect and charge the Player Tags between uses, they can also be charged by each player using the provided individual USB cables.

2 DOWNLOAD THE SHOTTRACKER TEAM APP

You will receive an email with 1) Directions to download the "ShotTracker TEAM" App on your iPad (must be iPad 2 or newer running iOS 9 or newer) and 2) ShotTracker TEAM login credentials to get you started. If you do not receive this information, please contact us at support@shottracker.com or call 1-844-385-1073.



Use the link provided in your email to download the ShotTracker TEAM App.



When logging into the ShotTracker TEAM App, enter your username and password to get started.



Once you complete the setup, the app will walk you through instructions for assigning the Player Tags to your players, setting up and running a practice, and viewing stats and analytics.

3 READY THE BASKETBALLS

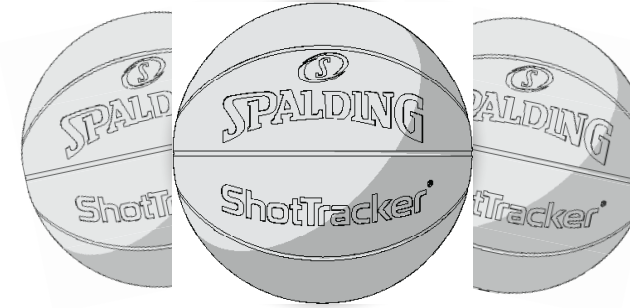

The ShotTracker enabled basketballs come ready to use and are the only balls that work with this system.

TURNING ON THE BASKETBALL

The basketball automatically turns on when in motion. A simple way to turn on the ball is to dribble a few times.

TURNING OFF THE BASKETBALL

The basketball turns off automatically if it's not in motion for a period of time.

4 READY THE PLAYERS

A) TURN ON THE PLAYER TAG

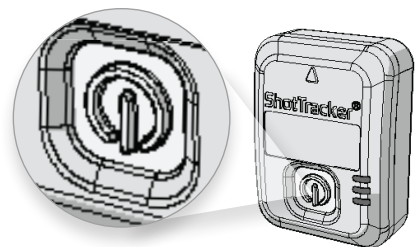

To turn on the Player Tag, press the power button in the middle of the device.



If the light is flashing green, the Player Tag is on.



The tag is ready for use when the light has a quick double flash of amber color.

B) INSERT THE PLAYER TAG INTO THE HOLDER

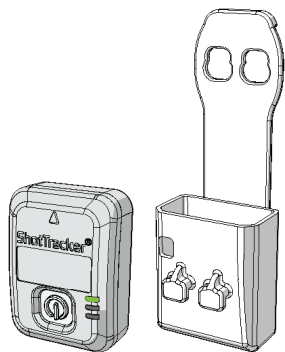

Open the Player Tag Holder.

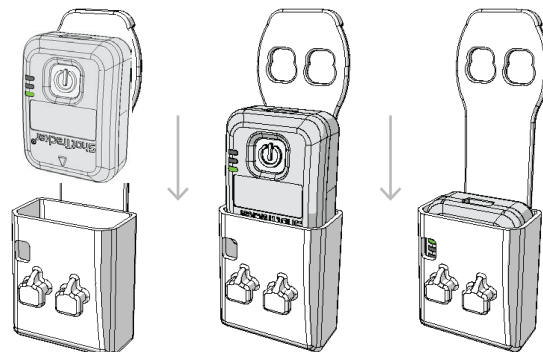

Insert the Player Tag into the Holder with the ShotTracker logo facing up and the down arrow entering the Holder first.

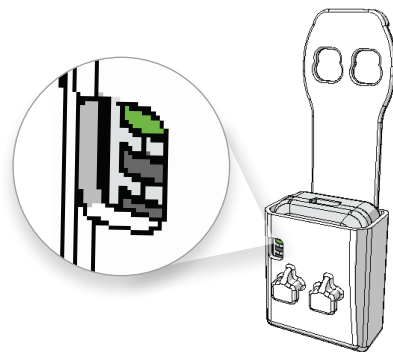

You did it correctly if the three lights on the Player Tag are aligned to the opening in the Player Tag Holder.

C) ATTACH PLAYER TAG HOLDER TO 4 LACES

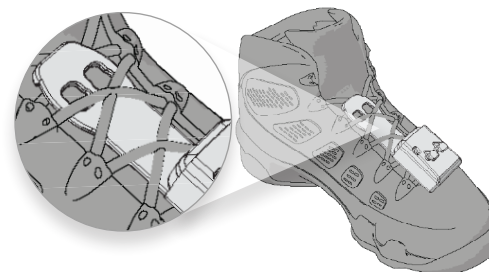

Starting at the toe of your shoe, slide the Player Tag up and under 4 laces. The Player Tag can be worn on either the right or left shoe.

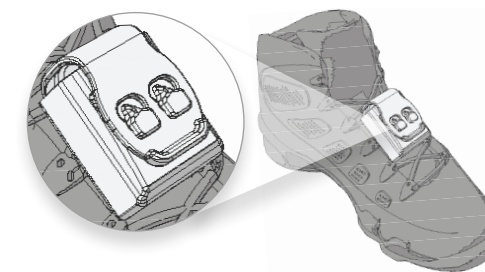

Secure the Player Tag by tightly connecting the two latches in the front of the Player Tag Holder.

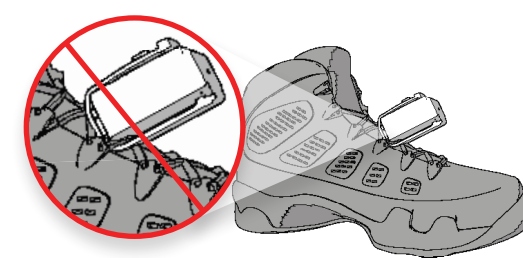

The Player Tag MUST be secured properly to ensure accurate results. Double check that the tag is properly attached to four laces.

5 DOWNLOAD THE SHOTTRACKER PLAYER APP

Once you invite your players to join your team via the TEAM App, they will receive an email with instructions to download the ShotTracker Player App.

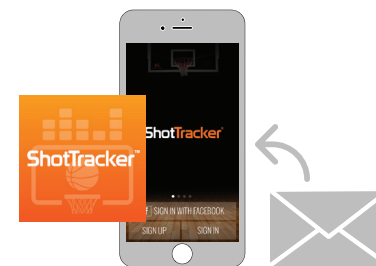

After you invite the players to join, they will receive an email with a link to download the ShotTracker Player App. They can also go to the App Store on their device and search "ShotTracker Player" App.



Each player must download the app, create an account and accept your invitation to access their stats. This app displays a player's performance data and key team highlights.



The ShotTracker Player App can be downloaded on a phone (iOS or Android) or an iPad tablet and is available via the App Store or Google Play Store.

Requirements: iPhone 4S or newer. OS 9 or above.

NEED SOME HELP?

1.844.385.1073 | SUPPORT@SHOTTRACKER.COM



FC

Note: This equipment has been tested and found to comply with the limits for a Class B digital device, pursuant to part 15 of the FCC Rules. These limits are designed to provide reasonable protection against harmful interference in a residential installation. Operation is subject to the following two conditions: (1) This device may not cause harmful interference, and (2) this device must accept any interference received, including interference that may cause undesired operation. This equipment generates, uses and can radiate radio frequency energy and, if not installed and used in accordance with the instructions, may cause harmful interference to radio communications. However, there is no guarantee that interference will not occur in a particular installation. If this equipment does cause harmful interference to radio or television reception, which can be determined by turning the equipment off and on, the user is encouraged to try to correct the interference by one or more of the following measures:

- Reorient or relocate the receiving antenna.
- Increase the separation between the equipment and receiver.
- Connect the equipment into an outlet on a circuit different from that to which the receiver is connected.
- Consult the dealer or an experienced radio/TV technician for help.

CAUTION: Changes or modifications not expressly approved for compliance could void your authority to operate this equipment.

IC

ENGLISH

This devices complies with Industry Canada license-exempt RSS standard(s). Operation is subject to the following two conditions:

- 1.This device may not cause harmful interference;
- 2.This device must accept any interference received, including interference that may cause undesired operation of the device.

FRENCH

Cet appareil est conforme à Industrie Canada une licence standard RSS exonérés (s). Son fonctionnement est soumis aux deux conditions suivantes:1. Cet appareil ne doit pas provoquer d’interférences2. Cet appareil doit accepter toute interférence reçue, y compris les interférences pouvant provoquer un fonctionnement indésirable de l’appareil.

(f) UWB systems operating under the provisions of this section shall bear the following or similar statement in a conspicuous location on the device or in the instruction manual supplied with the device.

This equipment may only be operated indoors. Operation outdoors is in violation of 47 U.S.C. 301 and could subject the operator to serious legal penalties.

RF EXPOSURE WARNING STATEMENTS

This equipment complies with FCC radiation exposure limits set forth for an uncontrolled environment. End users must follow the specific operating instructions for satisfying RF exposure compliance.

Énoncé d’exposition aux rayonnements: Cet équipement est conforme aux limites d’exposition aux rayonnements ioniques RSS-102 Pour un environnement incontrôlé.

The information in this guide may change without notice. The manufacturer assumes no responsibility for any errors that may appear in this guide.

