

S4 Combo Secual / S4 Combo Vid Secual

GSM and Landline Alarm System

Features

- GSM/PSTN transmitter
- Supports up to 30 remote controls, 50 wireless accessories and 50 RFID tags
- Can store up to 5 phone numbers, 5 SMS numbers, and 2 CMS numbers (for systems connected to a Central Monitoring System)
- Arm / disarm the system by SMS, phone call, or App (on iOS or Android)
- Can be disarmed by RFID tag
- Built-in siren (100dB) and call function from the panel
- SMS alerts for power failure, power recovery and low battery
- Audio surveillance of the site from distance
- 2 x 800mAh lithium batteries included (8h battery life in standby mode)

Specifications

Product name

S4 Combo Secual

SKU

S4-C

Control panel power supply

Input: AC 110-240V / 50-60 Hz

Output: DC 12V / 1 A

GSM working frequency

850 / 900 / 1800 / 1900 mHz

Radio-frequency

315MHz (±75KHz)

Standby current

110ma

Alarm current

340mA

Backup batteries

Lithium Batteries: 3.7V / 800 mAh x 2 (BL-5B)

Internal siren

100dB

Housing material

ABS plastic

Operating conditions

Temperature: -10°C~55°C

Humidity: ≤ 80% (non-condensing)

Control panel dimensions (L x W x H)

188 x 132 x 26 mm

Box Content

S4 Control Panel x1

Motion Detectors x2

Door / Window Contacts x2

Remote Controls x2

RFID Tags x2

PSTN Cable x1

PSTN Adaptor x1

AC Adaptors x1

Documentation x1

S4 Combo Vid Secual

+ IP Camera x 1 (with AC Adaptor and manual)

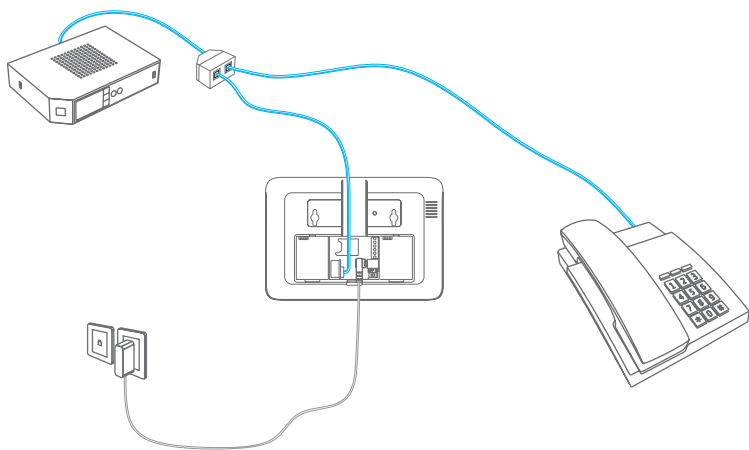

Quick Start-up

Control Panel Layout (Front)

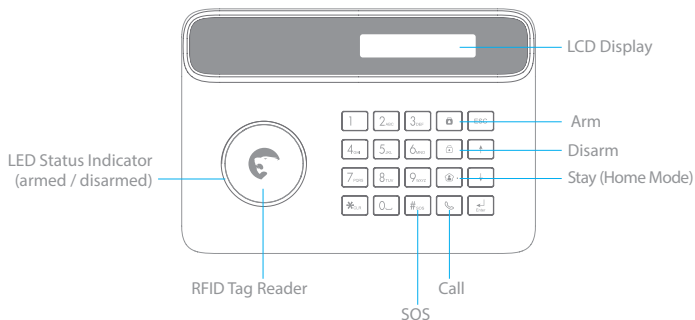

Control Panel Layout (Back)

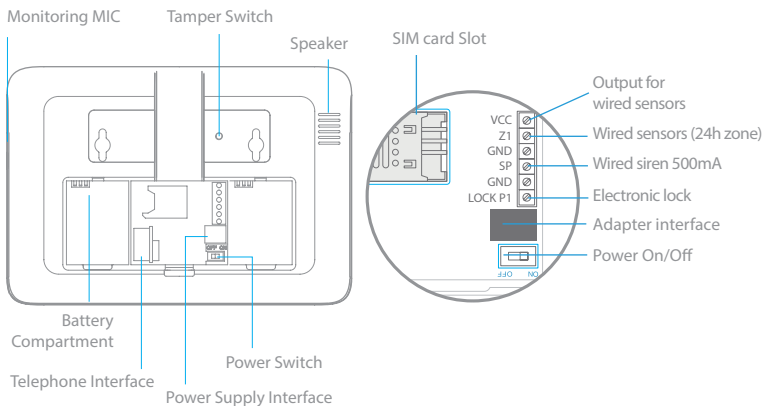

Connect your System

The S4 Combo Secual features a dual GSM and PSTN transmitter. This means that the control panel of your alarm system will communicate with you either through a SIM card (GSM module) or through your telephone landline (PSTN module).

a. Using the PSTN transmitter (telephone landline)

Connect the smaller connector of the telephone cable (supplied with your system) to the landline interface in the battery compartment at the back of the panel. Connect the other end of the telephone cable to the signal output provided by your landline carrier or to the phone connector of your ADSL box.

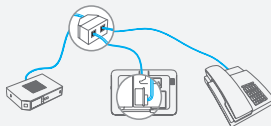

b. Using the GSM transmitter (SIM card)

Open the battery compartment at the back of the control panel and insert a SIM card in the control panel.

Important

Before using the S4 Combo Secual in GSM mode, you need to purchase a SIM card that works on the GSM network with 850 / 900 / 1800 / 1900 MHz frequency. We recommend you to subscribe to a plan with unlimited texts and one hour of voice. For more information, please contact your local reseller.

Important

Make sure the SIM card does not require any PIN code. For more information, please contact your local reseller.

Turning your System On

1. Plug the AC adaptor to an AC socket.
2. Plug the output connector of the AC adaptor into the adaptor interface in the battery compartment at the back of the control panel.
3. Turn the power switch to "ON" (in the battery compartment at the back of the control panel).

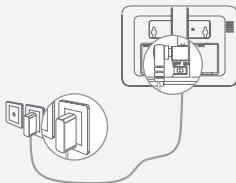

Mount the Control Panel

Before mounting the control panel on the wall, make sure the reception of the GSM signal is sufficient.

Fix the wall-mounting bracket on the wall with screws. Wedge the panel on the bracket, make sure they fit well.

First Operations

Select GSM / PSTN Mode

Refer to the instructions page 12 to deactivate the mode you do not want to use.

GSM mode only (SIM card required, sold separately): set "[LINECUT ALARM](#)" to "OFF"

PSTN mode only (connection to your telephone landline required): set "[GSM FAIL TIP](#)" to "OFF"

By default, both GSM and PSTN are activated.

Store a phone number

To interact with the control panel by SMS, by phone call and/or from the app, at least one phone number must be stored in the control panel. Please refer to the instructions on page 10 of this manual.

Change the language

By default the language of the S4 control panel is set to English. If you wish to change the system language, refer to the instructions on page 25 of this manual. "System language" refers to the language of the SMS you receive from the control panel, and the menu of the LCD display.

Arm / Disarm the System

The alarm system can be armed or disarmed on the control panel, by SMS, by App and by phone call.

On the control panel: Refer to the instructions on page 9 of this manual.

By RFID tag (disarm only): swipe the RFID tag in front of the RFID reader of the control panel.

To start receiving SMS notifications when the system is disarmed by RFID tag, you must store an SMS number and rename the RFID tags as explained respectively on page 21 and page 22 of this manual (up to 4 RFID tags can be renamed). If you have stored several SMS numbers, only the first number stored will receive SMS notifications when your system is disarmed by RFID tag.

By SMS (in GSM mode only):

To arm the system: send "[1](#)" by SMS to the number of the SIM card in the control panel.

To disarm the system: send "[0](#)" by SMS to the number of your system's SIM card.

By app (in GSM mode only): Click on "[Arm](#)" in the app. The app is available for download on the App Store and Google Play (more information on [etiger.com](#)).



Register Wireless Accessories & RFID Tags

1. Type your admin code followed by "Enter" on the control panel to enter the setup menu.
2. Enter the Connection Mode by navigating through the menu: "ACCESSORIES" → "WIRELESS SENSORS", "RFID TAG" or "REMOTE" → "ADD A NEW"
When registering a detector, you will be asked to select the type of detector (Normal Sensor, Home Sensor, Delay Sensor, 24 Hour Sensor). More information on page 10.
3. Trigger the accessory once within the next 15 seconds (for the RFID tag, swipe it in front of the RFID reader of the control panel). You hear one beep: the registration is successful.

Default admin code is 123456. To change the admin code, refer to the instructions "Admin Code" on page 12.

If the accessory has already been registered, the control panel will beep twice. The first accessory registered is assigned to zone 1, the second accessory registered is assigned to zone 2, etc. Zones 1 to 9 can be renamed. Zones 10 to 50 cannot be renamed (refer to the instructions on page 22 to learn how to rename zones).

Speed Dial

Press the Call button "" on the control panel for 3 seconds: the panel auto-dials the first stored phone number. Press the Call button "" to end the call.

Hands-free Phone Call from the Panel

Through PSTN

Press the Call button "" on the control panel, type the phone number you wish to call and press "Enter".

Through GSM

Press the Call button "" on the control panel, type the phone number you wish to call and press the Call button "" again.

Hard Reset

Turn the control panel off. Press and hold the "*" key while turning the control panel on. Then enter "123456" on keyboard.

Settings will be restored to default values. Stored phone numbers and connected accessories will be cleared.



Control Panel Operations

Arm the System

Press the Arm button " on the control panel. The control panel beeps once: the system is armed.

Note

If the Entry / Exit Delay is activated, only the Delay zone will be armed after the delay set (refer to the instructions on page 12 of this manual "Entry / Exit Delay").

Disarm the System

Type your user code and press the Disarm button " on the control panel. The control panel beeps twice: the system is disarmed.

Default user code: 1234

Home Mode

Press the Stay button " on the control panel. The control panel beeps once: the system is armed in Home Mode.

All the sensors assigned to the Normal zone are armed. The sensors assigned to the Home zone are disarmed.

For more information on zone setup, please refer to the instructions on page 17 of this manual.

Emergency Mode

Hold the " button for 3 seconds. The alarm is triggered immediately and the siren rings out. At the same time, the control panel dials the stored phone numbers.

Setup from the Control Panel

The control panel of your alarm system features an LCD display that enables you to navigate through the menu of the control panel and set up your alarm system.

To enter the setting menu, type [*your admin code* + **Enter**] on the control panel.

Default admin code: 123456

In the table on the next page, each column represents a menu or a sub menu. Each menu or submenu will be displayed on one of the two lines of the LCD display. On the LCD display, the current menu, submenu, or setting is shown on the line at the bottom, while the previous menu or submenu is shown on the line at the top.

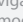
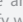
Navigate and select the setting you wish to modify with the keys " or ", and enter each menu or sub menu by pressing "**Enter**".

How to use the keyboard

"*" = delete

"↓" = move forward

"↑" = move backward

"Enter" = select / confirm

"Esc" = back / previous step in the menu / cancel

The tables on the next pages summarize all the settings that can be accessed and modified on the control panel.

Main Menu	Sub Menu 1	Sub Menu 2	Sub Menu 3
PHONE NUMBERS	PHONE [1~5] IS:		-
	SMS NUM [1~5] IS:		
	CMS NUM [1~2] IS:		-
ACCESSORIES	REMOTE	ADD A NEW	-
		DELETE ALL?	1=YES 0=NO
		DELETE ONE	ENTER 01-30:
ACCESSORIES	RFID TAG	ADD A NEW	PLS CONNECT
		DELETE ALL?	1=YES 0=NO
		DELETE ONE	ENTER 01-50
ACCESSORIES	WIRELESS SENSORS	ADD A NEW	NORMAL SENSOR HOME SENSOR DELAY SENSOR 24 HOUR SENSOR
		DELETE ALL?	1=YES 0=NO
		DELETE ONE	ENTER 01-50:
ACCESSORIES	TEST MODE		-

Comments	Note	Quick start-up
<p>Select the phone or SMS number you want to edit, type in the phone number and confirm with the key "Enter". Use the key "*" to clear.</p> <p>5 phone numbers, 5 SMS numbers and 2 CMS numbers can be stored in the control panel.</p>	<p>If you want to set a CMS center phone number, please refer to the instructions on page 17 of this manual.</p>	
<p>The LCD screen displays "PLS CONNECT 30": press any button on the remote control within the next 30 seconds (the countdown is indicated on the screen after "PLS CONNECT", in seconds). You hear one beep, the LCD screen displays "ADD OK! REMOTE [01~30]": the connection is successful.</p>		Control Panel Operations
<p>Select the remote control you wish to delete.</p>		
<p>The LCD screen displays "PLS CONNECT 30": swipe the RFID tag in front of the RFID reader on the control panel within the next 30 seconds (the countdown is indicated on the screen after "PLS CONNECT", in seconds). You hear one beep, the LCD screen displays "ADD OK! RFID [01~50]"; the connection is successful</p>		SMS Operations
<p>Select the RFID tag you wish to delete</p>		
<p>Select the sensor type you wish your sensor to be assigned to (Normal Sensor, 24 Hour Sensor, Delay Sensor, or Home Sensor), press "Enter" to confirm.</p> <p>The LCD screen displays "PLS CONNECT 30": trigger the detector once within the next 30 seconds (the countdown is indicated on the screen after "PLS CONNECT", in seconds). You hear one beep, the LCD screen displays "ADD OK! SENSOR [01~50]"; the connection is successful.</p>	<p>For more information on zone setup, refer to the instructions on page 17.</p>	Accessories
<p>Trigger the sensors you have previously connected to the control panel. You hear 1 beep, the LCD screen displays the signals that have been respectively sent by each sensor triggered. Make sure all the sensors you have triggered are mentioned on the LCD screen. Press "Esc" to exit the test mode.</p>	<p>This mode enables you to test if the sensors have been connected successfully to the control panel.</p>	Safety and Troubleshooting

Main Menu	Sub Menu 1	Sub Menu 2	Sub Menu 3
SYSTEM SETTINGS	DATE AND TIME	YYYY-MM-DD TIME	
SYSTEM SETTINGS	ENTRY EXIT DELAY	ENTRY DELAY	000-300
		EXIT DELAY	000-300
SYSTEM SETTINGS	AUTO ARM / DISARM	AUTO ARM TIME	<00:00>
		AUTO DISARM TIME	<00:00>
		ON OR OFF?	
SYSTEM SETTINGS	CONTROL BY PHONE	ON / OFF	-
SYSTEM SETTINGS	LINECUT ALARM	ON / OFF	-
SYSTEM SETTINGS	GSM FAIL TIP	ON / OFF	
SYSTEM SETTINGS	KEYPAD TONES	ON / OFF	-
SYSTEM SETTINGS	ACCESS CODE	ADMIN CODE	123456
		USER CODE	1234
		DURESS CODE	0000
		OPEN DOOR CODE	8888

Comments	Note	Quick start-up
	(e.g. 2014-06-20 14H30)	Control Panel Operations
<p>This function can be used if you do not want to bring a remote control or RFID tag with you. When the system is armed, you hear one beep every second to remind you to leave. The beep rhythm speeds up during the last 10 seconds. If an intruder is detected, the alarm will be delayed accordingly.</p> <p>Time is calculated in seconds. The Entry and Exit Delay can be set from 0 to 300 seconds.</p>	<p>The entry and exit delay is only for sensors connected as Delay Zone accessories (see "Wireless" on page 10).</p> <p>The Entry Delay gives you time to disarm the system on the control panel without triggering an alarm.</p> <p>The Exit Delay gives you time to arm the system on the control panel and leave your home without triggering an alarm.</p>	
<p>You can set up the system to arm and disarm automatically at a defined time every day.</p>	<p>Setting Auto Arm and Auto Disarm to the exact same time will deactivate the function.</p>	
<p>You can activate or deactivate the control of your system by phone call. Activating the control by phone call enables you to arm and disarm the system and monitor your home by phone call.</p>	<p>See instructions on page 16 for more information on the control of the system by phone call.</p>	SMS Operations
<p>If the linecut alarm is on, the alarm will be triggered if your telephone line is down. The first SMS number stored receives a notification by SMS (only in GSM mode).</p>	<p>Deactivate this function if you want to use the alarm system in GSM mode only.</p>	
<p>Notification of SIM/ GSM signal problem.</p>	<p>Deactivate this function if you want to use the alarm system in PSTN mode only.</p>	
<p>Activate or deactivate the sound when typing on the keyboard of the control panel.</p>		Accessories
<p>Your admin code enables you to enter the setup menu. <i>Default admin code: 123456</i></p>	<p>It is recommended to change all codes before using your system for the first time and to keep your codes secret</p>	
<p>Your user code enables you to disarm the system on the control panel. The user code is the access code requested when you call the control panel. <i>Default user code: 1234</i></p>		
<p>In case of emergency, when you are requested to disarm the system by force, it is recommended to disarm your system with your Duress Code. The panel will silently dial the stored phone numbers. <i>Default duress code: 0000</i></p>		
<p>You can open electronic doors using this code. The door must be wired to the [LOCK] interface on the back of the control panel.</p>		
		Safety and Troubleshooting

Main Menu	Sub Menu 1	Sub Menu 2	Sub Menu 3
SYSTEM SETTINGS	RINGING TIMES	<0-9>	-
SYSTEM SETTINGS	SIREN SETUP	WIRED SIREN	SIREN SWITCH <ON OR OFF?>
			ARM/DISARM TONE <ON OR OFF?>
		IN SIREN VOLUME	0-1 (0=MUTE)
		SIREN ALERT TIME	3 MIN
		BUILT-IN SIREN	SIREN SWITCH <ON OR OFF?>
			ARM/DISARM TONE <ON OR OFF?>
		WIRELESS SIREN	SIREN SWITCH <ON OR OFF?>
			ARM/DISARM TONE <ON OR OFF?>
SYSTEM SETTINGS	USER ID	(4 DIGITS):0000	-
SYSTEM SETTINGS	ARM UPLOAD	ON / OFF	-
	DISARM UPLOAD	ON / OFF	-
SYSTEM SETTINGS	CALL RECYCLE	<0-9>	
SYSTEM SETTINGS	BACKLIGHT TIME	030 S	-
SYSTEM SETTINGS	LANGUAGE	-	-
SYSTEM SETTINGS	RESET	-	-
SYSTEM SETTINGS	ABOUT	ABOUT JUN 4 2014	
HISTORY	-	-	-

Comments	Note	Quick start-up
This function enables you to determine the number of times the control panel will ring before taking your call (for control by phone call).		Control Panel Operations
	Wired siren refers to a siren connected to the control panel by wire.	
		SMS Operations
Siren ringing time is calculated in minutes, default setting is 3 minutes. If you set the ringing time to 0, the siren will not ring out.		
	Built-in siren refers to the siren featured in the control panel.	Accessories
	Wireless siren refers to a siren connected to the control panel by radio-frequency.	
More information on page 17 of this manual	This information is supplied by your CMS center. After having stored the user ID, the CMS center will be able to determine your exact location according to your ID number.	Safety and Troubleshooting
More information on page 17 of this manual		
More information on page 17 of this manual		Safety and Troubleshooting
When the alarm is triggered, the control panel dials the numbers you have stored. If you do not disarm the system, the control panel will call you again (up to 9 times). The "Call Recycle" function enables you to define the number of times the control panel attempts to call you.		
Press "Enter" to adjust the time during which the LCD screen is lit.	Backlight time can be set from 0 to 300 s	Safety and Troubleshooting
Change the language of the system.	Languages available may vary depending on the version of your product.	
All system settings will be restored to default setting. Stored phone numbers and connected accessories will be cleared.		Safety and Troubleshooting
Choose the event log you need to track, press "Enter".	The control panel keeps in record the latest 150 event logs.	Safety and Troubleshooting

Control by Phone Call

This feature is available only after having enabled it from the control panel, as explained on page 12 of this manual.

Method 1

When an alarm has been triggered, the control panel dials the stored phone numbers. When you pick up the phone, follow the voice instructions to control the panel from distance (refer to the instructions in the table below).

Method 2

1. Dial the telephone number of your control panel (either the number of the SIM card in your control panel or the number of the landline to which your panel is connected). After getting through, the voice instructions will guide you to enter your access code.
2. Enter your access code (user code), followed by "#".
3. A voice gives you the options you can select.
4. Select the operations to control the panel (see instructions in the table below).

Note

The call will end automatically if you do not send any command within 30 seconds.

Table of commands for control by phone call

Command	Function	Comment
Press "1"	Arms the system	Voice prompt "System armed"
Press "0"	Disarms the system	Voice prompt "System disarmed"
Press "*"	Audio monitoring	Press "*" to extend the monitoring time
Press "3"	Phone call with control panel	-
Press "6"	Turns the siren off	-
Press "9"	Turns the siren on	-
Press "#"	Exits control by phone call	Hanging up also exits the control by phone call.

Note

In GSM mode, the audio monitoring is not limited in time.

In PSTN mode (connected to your landline), the audio monitoring is limited to 80 seconds. If you wish to extend the time of audio monitoring, press the "*" on your phone before the end of the 80 seconds.

Zone Setup of Accessories

Every detector can be assigned to 4 different categories of zones: Home Zone, Delay Zone, Normal Zone and 24-H Zone. To assign a detector to a zone, follow the instructions on page 10 of this manual (the zone will be assigned at the time of connection of the accessory).

Normal zone

When the system is armed, if a sensor is triggered, the siren rings out. When the system is disarmed, sensors do not trigger an alarm.

24h zone

Regardless the system is armed or disarmed, sensors assigned to the 24h zone can trigger an alarm. *It is recommended to assign smoke detectors, gas detectors and outdoor beam sensors to the 24-H zone.*

Delay zone

If you want to set up the entry and exit delay functions, corresponding sensors must be assigned to the Delay zone. Once the delay time has been set up, the sensors will not trigger the alarm during the delay set. Refer to the instructions "Entry and Exit Delay" on page 12 of this manual. *It is recommended to assign the Door / Window Contact to the Delay zone.*

Home zone

When the system is armed in Home Mode, the sensors assigned to the Home zone do not trigger an alarm. *It is recommend to assign motion detectors to the Home zone so that you can have your system armed in Home Mode when you are home and move inside your home without triggering any alarm.*

Connect to CMS Center

Ignore this step if you are not connected to a CMS center. If you are connected to a CMS center, the control panel will upload your contact ID to the CMS center automatically if an intrusion is detected.

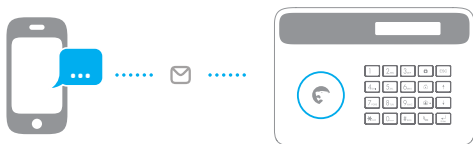

SMS Operations

IMPORTANT: BEFORE USING FOR THE FIRST TIME

INSERT A SIM CARD IN THE CONTROL PANEL BEFORE STARTING SMS OPERATIONS.

MAKE SURE THE SIM CARD DOES NOT REQUIRE ANY PIN CODE.

SAVE A SMS NUMBER IN THE CONTROL PANEL (USING THE CONTROL PANEL).

Only stored numbers can control and configure the system.

(Refer to the instructions page 10)

Each SMS operation defined in this user manual will be illustrated as follows:

You send:



SMS Command

The first blue speech bubble is the SMS command sent by the user.

The first grey speech bubble is the reply sent by the control panel.

The control panel replies:



Control panel's reply

The speech bubbles that follow are the dialogue between the user and the control panel (SMS sent by the user are in blue, SMS sent by the control panel are in grey).

The system is in English by default. To change the system language, refer to the instructions on page 25 of this manual.

Important

When replying to the control panel by SMS, make sure no space follows punctuation marks like ":" or ";". For examples, to store SMS numbers, your SMS must be formatted as follows:

SMS numbers:

1.067890033

2.067890022

3.067890011

4.067890000

5.

No space after "1."

2.0678900

Disarm the System

Send:

0

System disarmed.

Arm the System

Send:

1

System armed.

Home Mode

Send:

2

System in home mode.

Settings Enquiry

Send:

00

System:Disarmed
AC power:on

Note

The values indicated hereinabove will change after having set up the system.

Store Phone Numbers

Send:

5

Phone numbers:

- 1.
- 2.
- 3.
- 4.
- 5.

Copy, paste, then edit
(case sensitive):

Phone numbers:

1. 067890033
2. 067890022
3. 067890011
4. 067890000
- 5.

Ok

Store Phone Numbers for SMS Notifications

Send:

6

SMS numbers:

- 1.
- 2.
- 3.
- 4.
- 5.

Copy, paste, then edit
(case sensitive):

SMS numbers:

1. 067890033
2. 067890022
3. 067890011
4. 067890000
- 5.

Ok

Note

The first SMS number will receive SMS notifications when the system is disarmed by RFID tag. To start receiving these notifications, you must rename the RFID tags. Up to 4 RFID tags can be renamed. Other tags will be attributed a number based on the order of registration to the control panel. Refer to the instructions on page 10 to learn how to register an RFID tag in the control panel.

Rename Zones

Send "91~99". For example for zone 1, send:

91

Zones names:
1.

Copy, paste, then edit
(case sensitive):

Zones names:
1.Entrance door sensor

Ok

Note

Zones 1 to 9 can be renamed. The name of the zone cannot consist of more than 30 Latin characters. Zones 10 to 50 cannot be renamed.

SMS Alert for Accessory Low Battery

(available for two-way accessories such as Motion Detectors)

For accessories assigned to zones that have been renamed, an SMS will be sent under the format "**Zone name** + **low battery**".

Bedroom PIR low battery

For accessories assigned to zones that have not been renamed, an SMS will be sent under the format "**Zone number** + **low battery**".

Zone 10 low battery.

SMS Alert for Accessory Tamper Alarm

(available for two-way accessories such as Motion Detectors)

For accessories assigned to zones that have been renamed, an SMS will be sent under the format "**Zone name** + **tamper alarm**".

Bedroom PIR tamper alarm.

For accessories assigned to zones that have not been renamed, an SMS will be sent under the format "**Zone number** + **tamper alarm**".

Zone 10 tamper alarm.

Rename RFID Tag

Send:

10

Rename RFID tags:

- 1.
- 2.
- 3.
- 4.

Copy, paste, then edit
(case sensitive):

Rename RFID tags:

1. Tom
2. Nurse
3. Nancy
4. David

Ok

Note

The first SMS number will receive SMS notifications when the system is disarmed by RFID tag. To start receiving these notifications, you must rename the RFID tags. Up to 4 RFID tags can be renamed. Other tags will be attributed a number based on the order of registration to the control panel. Refer to the instructions on page 10 to learn how to register an RFID tag in the control panel.

Entry and Exit Delay Time

Send:

11

Entry delay time(0-300sec):0

Exit delay time(0-300sec):0

Copy, paste, then edit
(case sensitive):

Entry delay time(0-300sec):10

Exit delay time(0-300sec):20

Ok

Note

This function will only affect detectors assigned to the Delay zone. Refer to the instructions on "Wireless" on page 10 of this manual to learn how to set up your sensor to the Delay zone.

This function can be used if you do not want to bring a remote control or a RFID tag with you.

When you arm the system, the system will be armed after the delay set. When you disarm the system, the system will be disarmed after the delay set.

When arming the system, you hear one beep every second to remind you to leave. The beep rhythm speeds up during the last 10 seconds. If an intruder is detected, the alarm will be delayed accordingly.

Siren Volume and Ringing Time

Send:

12

Siren volume(0=Mute,1=High):1
Siren ringing time(1-9min):5

Copy, paste, then edit
(case sensitive):

Siren volume(0=Mute,1=High):0
Siren ringing time(1-9min):1

Ok

Disarm Password

Send:

13

Disarm password (4 digits):
1234

Copy, paste, then edit
(case sensitive):

Disarm password (4 digits):
8888

Ok

Change System Language

Send the code corresponding to the language you want to set. For example, for English, send "0001".

0001

Ok

Refer to the table below for the full list of languages:

0001 English	0008 German
0002 French	0009 Spanish
0003 Russian	0010 Finnish
0004 Danish	0011 Norwegian
0005 Dutch	0012 Arabic
0006 Italian	0013 Farsi
0007 Swedish	

Languages available may vary depending on the version of your product.

Restore System to Factory Settings by SMS

Send:

0000

Ok

The settings will be restored to default values. Stored phone numbers and connected accessories will not be deleted.

Note

Only stored numbers can send the SMS to restore factory settings.

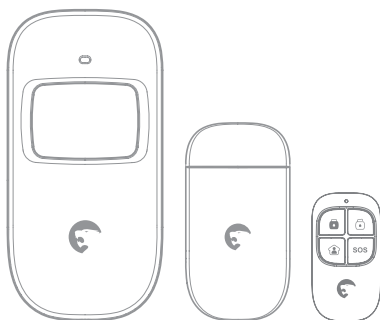

Accessories



Arm the system

Press the Arm button "🔒" to arm the alarm system. The LED indicator lights up (the control panel beeps once). The system is armed.

If an intruder is detected, the siren rings out. (The siren turns off after 5 minutes as per default settings.) In the meantime, the system dials the stored phone numbers automatically.



Disarm the system

Press the Disarm button "🔓" to disarm the alarm system. The LED indicator turns off (the control panel beeps twice). The system is disarmed.

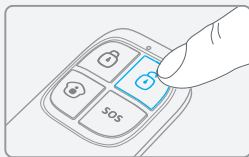



Home Mode

Press the Home Mode button "🏠" on the remote control. The system state LED is on. All the sensors in regular zones are armed except those in the Home Mode zone. The sensors in the Home Mode zone are disarmed so that users can move inside their home.

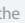

Mute Mode

Press the Home Mode button " " and then the Arm " " or Disarm " " button immediately after. Doing so, the control panel does not beep when you arm or disarm your system.

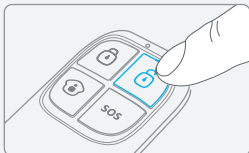

Emergency Mode

Regardless the status of the system, the alarm is triggered when the SOS button "**SOS**" is pressed on the remote control.

At the same time, the control panel sends a notification by SMS ("**RC-01 SOS**", 01 being the remote control's number) and dials the pre-stored phone numbers.



Register in the control panel

Refer to the instructions in the table on page 10 of this manual "**REMOTE**".

To check if the registration is complete, refer to the instructions in the table on page 10 ("Test Mode").

Specifications

Power supply

DC 3V (CR2025 button battery x1)

Static current

≤10 uA

Operating current

≤7 mA

Transmission distance

≤ 80 m (in open area)

Radio-frequency:

315MHz (±75KHz)

Housing material

ABS plastic

Operating conditions

Temperature: -10°C ~ +55°C

Relative Humidity: ≤80%
(non-condensing)

Dimensions

57 x 31 x 11 mm

Wireless Motion Detector

Features

The ES-D1A is a high performance wireless motion detector boasting a digital dual-core fuzzy logic infrared control chip with intelligent analysis. This technology identifies interferences created by body motion and reduces the false alarm rate.

With automatic temperature compensation and anti-air turbulence technology, it easily adapts to environmental changes.

Design

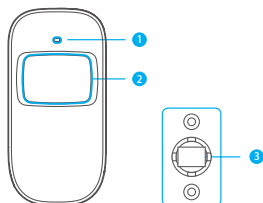

1. LED indicator
2. Detection window
3. Bracket

PCB Layout

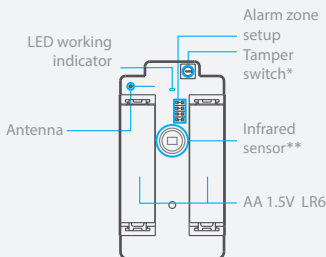

*Tamper switch

When the alarm system is armed, the tamper switch will trigger the alarm if the case is opened.

**Infrared sensor

Detects the infrared rays released by human body motion. Do not touch the surface. Keep the surface clean.

LED indications

Blinks continuously: self-testing

Blinks once: an intruder is detected

Blinks twice: self-testing is complete; entering working mode.

Blinks once every 3 seconds: under-voltage indication, the batteries must be replaced. (You will be informed by SMS when the batteries are low if the motion detector is registered in the control panel.)

Usage

Open the case and remove the battery activation strip. Self-testing will start for 30 seconds.

When the sensor is in operation, if it is triggered more than twice within 3 minutes, it will switch to standby mode to save power. If no movement is detected within the next 3 minutes, the sensor goes back to working mode.

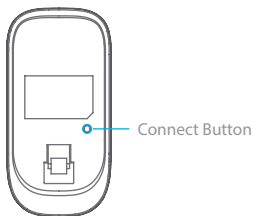

Register in the control panel

Navigate through the menu of the control panel and reach "**ADD A NEW**" (Wireless Sensor). Press the Connect button at the back of the motion sensor or trigger the sensor (by moving in front of it) to register the detector in the control panel.

To check if the registration is complete, refer to the instructions in the table on page 10 "**TEST MODE**".

Installation

Avoid mounting the detector close to windows, air conditioner, heater, refrigerator, oven, sunshine and places where the temperature changes fast or where the air stream flows frequently.

If two detectors are installed in the same detection scope, adjust the location to avoid interferences and false alarms.

Fix the bracket on the wall with screws and attach the detector to the bracket. Adjust the bracket to change the detection distance and angle. It is recommended to mount the detector 2.2 m from the ground.

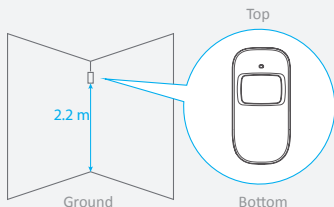

The detector is more sensitive to cross movements than vertical movements.

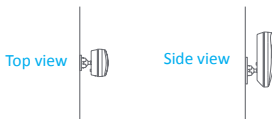

Testing

A. After the installation, turn the detector on. After one minute of self-testing, press the test button, walk in the scope of detection and watch the LED indicator to make sure the detector is working.

B. The LED indicator blinks once when body movement is detected.

C. Adjust the detector angle to achieve the best detection performance.

Specifications

Power supply

DC 3V (AA 1.5V LR6 Batteries x 2)

Static current

$\leq 30\mu\text{A}$

Alarm current

$\leq 15\text{ mA}$

Detection scope

8m / 110°

Transmission distance

$\leq 80\text{m}$ (in open area)

Radio-frequency

315 MHz ($\pm 75\text{ KHz}$)

Housing material

ABS plastic

Operating conditions

Temperature: $-10^{\circ}\text{C} \sim 55^{\circ}\text{C}$

Relative humidity: $\leq 80\%$ (non-condensing)

Detector dimensions (L x W x H)

107 x 53 x 32 mm

Bracket dimensions (L x W x H)

52 x 30 x 26.5 mm

Detection Scope

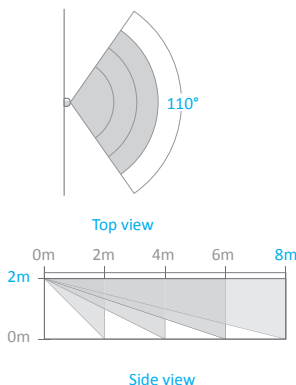

Wireless Door / Window Contact

Features

The ES-D3A is a Door / Window Contact that can be installed on doors, windows, and any other objects that open and close. The sensor sends a signal to the control panel when the magnet is separated from the transmitter.

Thanks to the tamper switch, any attempt to remove the cover of the Door / Window Contact will trigger the alarm.

Design

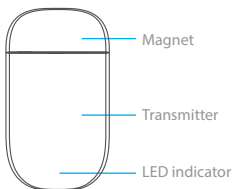

PCB Layout

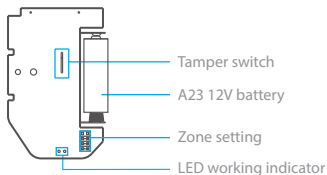

LED indications

Blinks once: the door or window is open and the transmitter sends a signal to the control panel.

Blinks quickly: Low power indication, the batteries must be replaced.

Register in the control panel

Navigate through the menu of the control panel and reach "**ADD A NEW**" (Wireless Sensor). Then separate the magnet from the transmitter to register the detector in the control panel.

To check if the registration is complete, arm the system and separate the magnet from the transmitter again by opening the door or window on which it is installed. If the siren rings out, the registration is successful. Or refer to the instructions in the table on page 10 "**TEST MODE**".

Installation

- Open the case and remove the battery activation strip.
- Mount the sensor on the door and the magnet on the door frame.
- Make sure the magnet is placed above the transmitter.
- Mount the magnet max. 1 cm away from the transmitter and secure the transmitter and magnet with double-sided tape or screws.
- Avoid mounting the sensor in areas with a large amount of metal or electrical wiring such as a furnace or utility room.

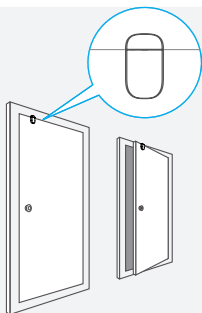

Specifications

Power supply

DC 12V (A23 12V Battery x 1)

Static current

≤ 30 uA

Alarm current

≤ 15 mA

Transmitting distance

≤ 80 m (in open area)

Radio-frequency

315 MHz (± 75 KHz)

Housing material

ABS plastic

Operating conditions

Temperature: -10°C~55°C

Relative humidity: ≤ 80% (non-condensing)

Transmitter dimensions (LxWxH)

60 x 45 x 18 mm

Magnet dimensions (LxWxH)

45 x 19 x 17.5 mm

RFID Tag

Features

The RFID tag enables you to disarm your system or unlock electronic door locks.

Register in the control panel

Refer to the instructions in the table page 10 of this manual ("[RFID TAG](#)").

Specifications

Dimensions

45 x 30 x 7 mm

Register an Additional eTiger Siren

The control panel of the S4 features a built-in 100 dB siren.

Your eTiger security systems supports additional indoor and/or outdoor sirens so to enable you to extend your system according to your needs.

To register an additional eTiger siren, refer to the instructions provided in the manual that comes with your siren.

For more information on sirens and accessories compatible with eTiger security systems, visit our website etiger.com



Troubleshooting and Safety Instructions

Issue	Cause of malfunction	Solution
No response following interaction with the control panel	The control panel is switched off	Open the battery compartment and turn the power on
	Electricity grid failure	Contact your electricity provider
	Backup batteries are empty	Plug the AC adapter to an AC socket
Accessories cannot connect to the control panel	The control panel is not in Connection mode	Make sure the control panel is in Connexion mode
	Accessories have not been triggered for connection	Make sure the accessory is triggered so to send a signal to the control panel
	When attempting the connection, the control panel beeps twice	<p>The accessory has already been connected</p> <p>Make sure you do not trigger any other accessory when connecting one accessory to the control panel (e.g. do not stay in the detection scope of a motion detector if it is not the one you want to connect)</p>
No response from the control panel following commands from the remote control	The remote control has not been connected to the control panel	Follow the instructions in this manual to connect the remote control to the panel
	Remote control is too far from the control panel	Transmission distance of the remote control: 80 m (in open area)
		A signal repeater can be installed to increase the transmission distance
RFID tag fails to disarm the system	RFID tag has not been connected to the control panel	Follow the instructions in this manual to connect the RFID tag to the control panel
Impossible to access settings from the control panel	You are not in the setup menu of the LCD display	Enter your admin code followed by "Enter" to enter the setup menu

If you are experiencing issues that are not described in the FAQ above, visit etiger.com to download the latest update of this user manual and for additional support.

For a safer use of the product and to optimize the lifespan of the product, we recommend you to follow the precautions below:

- The wireless accessories must be connected to the control panel.
- Low power voltage may affect transmission distance.
- Do not press the SOS key on the remote control if it is unnecessary to avoid disturbing neighborhood.
- Check the system regularly to make sure the system works properly.
- The control panel is neither waterproof nor moisture-proof, install it in a shady, cool and dry place.
- The case of the control panel is made of ABS plastic. Keep away from bright light for a longer lifespan.
- The control panel is not explosion-proof. Keep away from fire and flames.
- Install the control panel away from objects such as heater, air conditioner, microwave oven etc. that generate heat or electromagnetic fields.
- Dispose of the batteries according to local regulations.
- Dismantling of this product must be done by professional personnel only.



This product bears the selective sorting symbol for waste electrical and electronic equipment (WEEE). This means that this product must be handled pursuant to European Directive 2002/96/EC in order to be recycled or dismantled to minimize its impact on the environment.

For further information, please contact your local or regional authorities.

Electronic products not included in the selective sorting process are potentially dangerous for the environment and human health due to the presence of hazardous substances.



In compliance with European laws. This product is in compliance with the essential requirements and other relevant provisions of Directive 1999/5/EC.



This product was designed and manufactured in compliance with Directive 2002/95/EC of the European Parliament and of the Council on the restriction of use of certain hazardous substances in electrical and electronic equipment (RoHS Directive - RoHS) and is deemed to comply with the maximum concentration values set by the European Technical Adaptation Committee (TAC).

Manufactured in China.



Images, illustrations and text are non-contractual. ETIGER and the ETIGER logo are registered trademarks and the property of ETIGER. Copyright © 2014 ETIGER. All rights reserved.

FCC Information and Copyright

This equipment has been tested and found to comply with the limits for a Class B digital device, pursuant to part 15 of the FCC Rules.

These limits are designed to provide reasonable protection against harmful interference in a residential installation. This equipment generates,

uses and can radiate radio frequency energy and, if not installed and used in accordance with the instructions, may cause harmful interference

to radio communications. However, there is no guarantee that interference will not occur in a particular installation. If this equipment does

cause harmful interference to radio or television reception, which can be determined by turning the equipment off and on, the user is

encouraged to try to correct the interference by one or more of the following measures:

- Reorient or relocate the receiving antenna.
- Increase the separation between the equipment and receiver.
- Connect the equipment into an outlet on a circuit different from that to which the receiver is connected.
- Consult the dealer or an experienced radio/TV technician for help.

This device complies with part 15 of the FCC Rules. Operation is subject to the following two conditions:

- (1) This device may not cause harmful interference, and
- (2) this device must accept any interference received, including interference that may cause undesired operation.

changes or modifications not expressly approved by the party responsible for compliance could void the user's authority to operate the equipment.

This equipment complies with FCC radiation exposure limits set forth for an uncontrolled environment. This equipment should be installed and operated with minimum distance 20cm between the radiator & your body. This transmitter must not be co-located or operating in conjunction with any other antenna or transmitter.

