

SPECIFICATION

SHEET FOR APPROVAL

(Revision: R: A4)

CUSTOMER(客户名称)	GSD	
CS P/N(客户机种)	WC0F	
PART NAME(品名)	WIFI Antenna	
FREQUENCY(频率)	2.4~2.5G/5.15-5.85G	
ZTX NO.(物料编号)	1.01.00636	G.5.13.WC0FXXXXXX
DATE(日期)	2019-10-09	

CUSTOMER			
QA CHECKED	ME CHECKED	RF CHECKED	MANAGER CHECKED

ZHONG TIAN XUN TECHNOLOGY CO., LTD				
MANAGER CHECKED	MANAGER CHECKED	ME CHECKED	RF CHECKED	LISTER
		黄小宇	李方森	

manufacturer



深圳市中天迅通信技术股份有限公司

SHENZHEN ZHONGTIAN XUN Communication Technology Co.,Ltd.

地址: 深圳市宝安区石岩镇石龙大道 34 号(腾达工业园) 邮编: 518000

电话: 0755-27588320 传真: 0755-27588045 <http://www.chinaztx.com>

Address: Tenada Industrial Park. Shilona Avenue. Shivan Town. Baoan District. Shenzhen

ANTENNA SPECIFICATION

CUS P/N :WC0F
ZTX P/N :WC0F

ApplicationDate:Qct.09,2019
Editor:

Rev: R:A4
Page 1 of 8

Revision history

Version	date	status
A1	2014-11-13	Make an admission
A2	2016-10-25	Optimized structure
A3	2017-03-06	Adjust the length control dimensions
A4	2017-09-14	Change the packaging material



ANTENNA SPECIFICATION

CUS P/N :WC0F
ZTX P/N :WC0F

ApplicationDate:Qct.09,2019
Editor:

Rev: R:A4
Page 2 of 8

Index

		Revision history	1
1		Test equipment	3
2		Product figure	4
3		Antenna test data	4
	3-1	VSWR	4
	3-2	Return loss plot	5
	3-3	Smith Chart	5
	3-4	Matching circuit	6
	3-5	No-source test data	6
	3-6	Environment treatment	6
	3-7	Directional drawing of horizontal plane of	6
	3-8	3D radiation drawing	6~7
4		Mechanical Specification	8

ANTENNA SPECIFICATION

CUS P/N :WC0F
ZTX P/N :WC0F

ApplicationDate:Qct.09,2019
Editor:

Rev: R:A4
Page 3 of 8

1. Test equipment

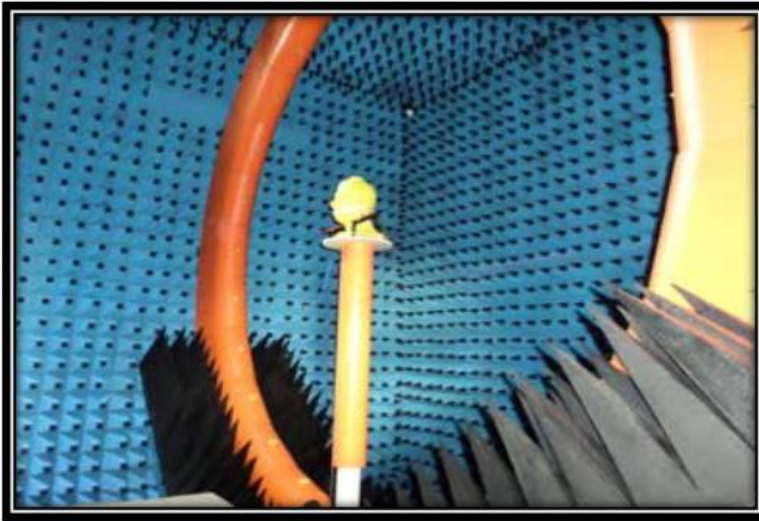

Owned 6 microwave dark room, equipped 2 sets world leading France Satimo SG24 OTA certification test systems (one in SHENZHEN, another one in Shanghai), ETS OTA Standard test system, Blue test reverberation test system which is High repeatability, high accuracy and high resolution. It can quickly provide accurate test reports, fully meet the CITA standards.

Testing range:

Support active, passive testing of GSM/CDMA/WCDMA/TD-SCDMA/LTE/WIFI/WLAN/WiMax/BT/GPS/MIMO/UWB within 0.4-6G.

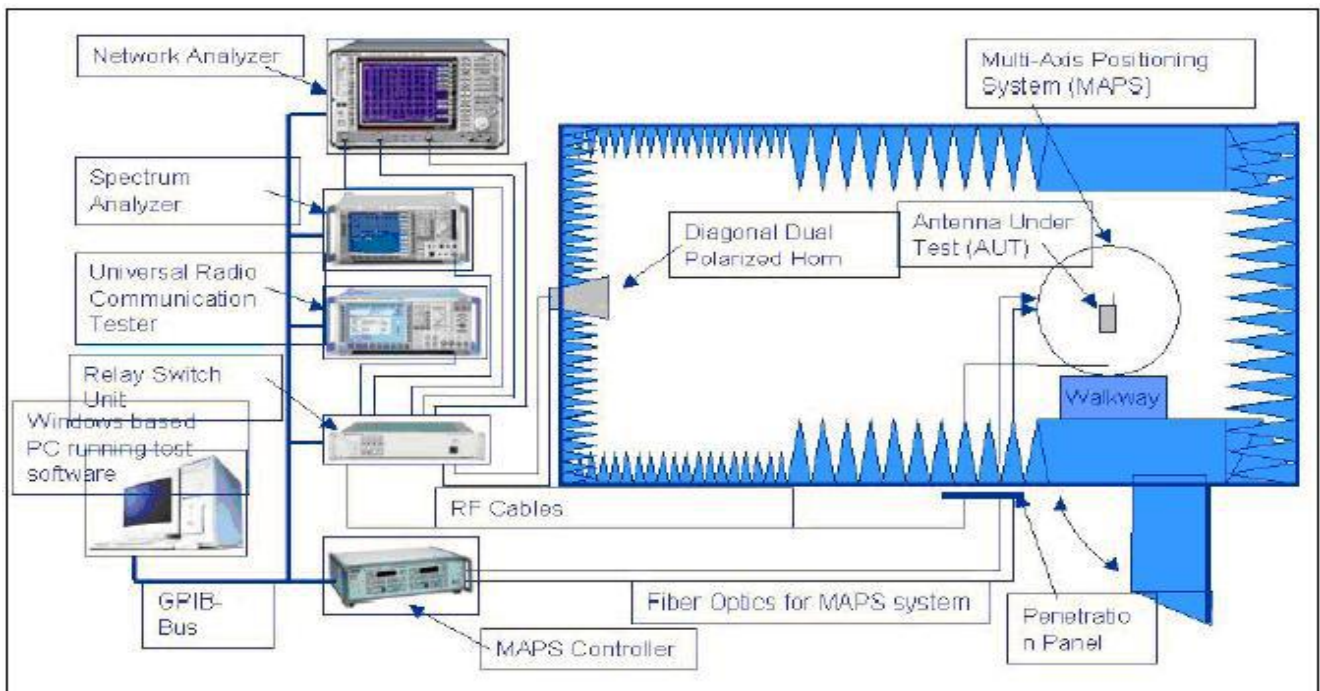

ANTENNA SPECIFICATION

CUS P/N :WC0F
ZTX P/N :WC0F

ApplicationDate:Qct.09,2019
Editor:

Rev: R:A4
Page 4 of 8

2.Product figure

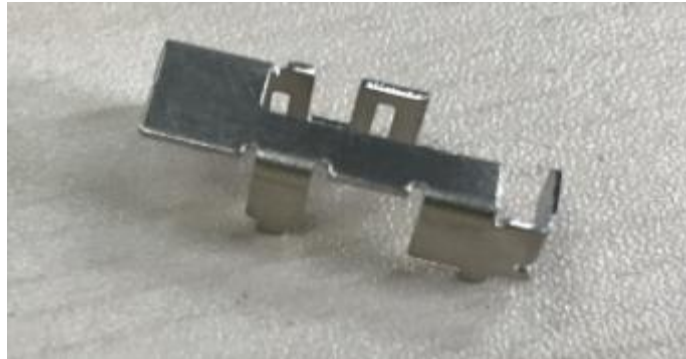

3.Antenna test data

3-1 VSWR

2.4G	2.5G	5.15G	5.85G
1.39	1.37	1.69	1.59



ANTENNA SPECIFICATION

CUS P/N :WC0F
ZTX P/N :WC0F

ApplicationDate:Qct.09,2019
Editor:

Rev: R:A4
Page 5 of 8

3-2 Return loss plot

2.4G	2.5G	5.15G	5.85G
-15.6dB	-16.0dB	-11.8dB	-12.7dB

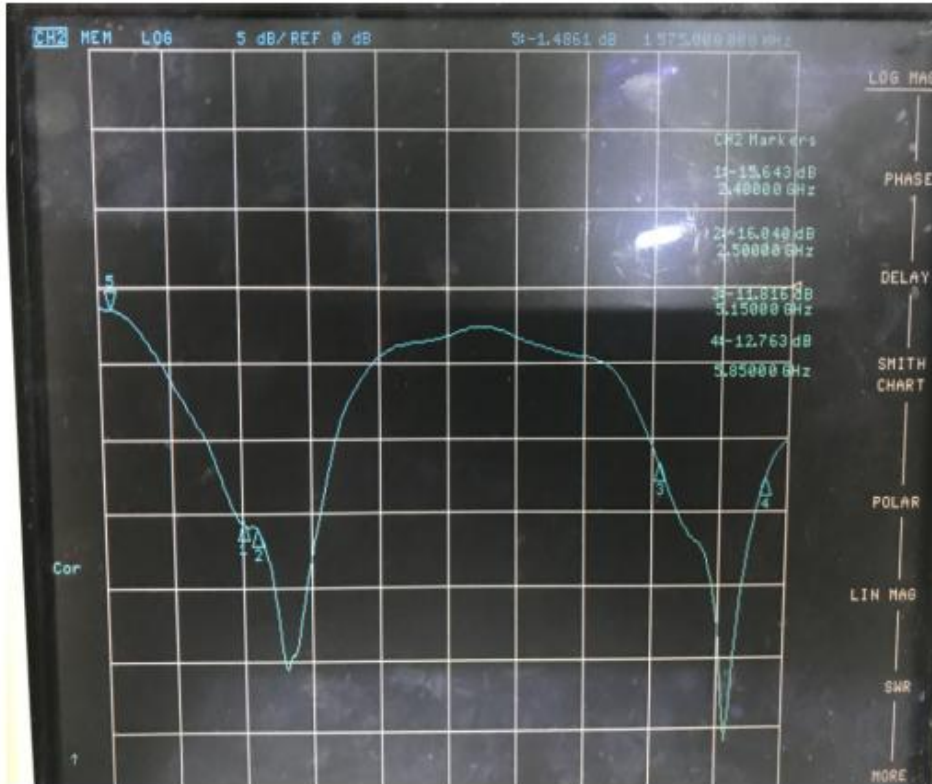

3-3 Smith Chart

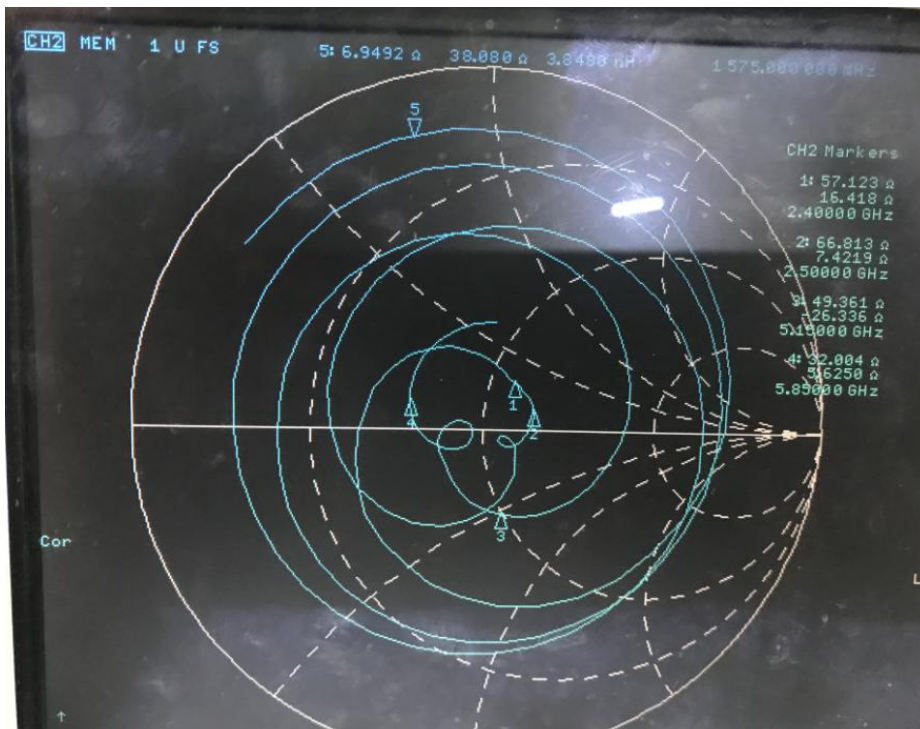

ANTENNA SPECIFICATION

CUS P/N :WC0F
ZTX P/N :WC0F

ApplicationDate:Qct.09,2019
Editor:

Rev: R:A4
Page 6 of 8

3-4 Matching circuit

N/A

3-5 No-source test data

Frequency	2.4G	2.42G	2.45G	2.47G	2.49G
Efficiency	59%	58%	57%	58%	57%
Gain.dB	2.53	2.92	2.86	2.87	2.96

Frequency	5.15G	5.25G	5.75G	5.8G	5.85G
Efficiency	65%	60%	62%	58%	61%
Gain.dB	2.27	2.39	2.57	2.34	2.55

Frequency	Efficiency	Efficiency . dB	Frequency	Gain . dB
2.4E+09	59%	-2.27028	2.4E+09	2.538545
2.41E+09	58%	-2.34515	2.41E+09	2.741231
2.42E+09	58%	-2.39054	2.42E+09	2.922523
2.43E+09	57%	-2.45035	2.43E+09	2.970949
2.44E+09	58%	-2.3768	2.44E+09	2.976098
2.45E+09	57%	-2.44196	2.45E+09	2.864206
2.46E+09	59%	-2.29193	2.46E+09	2.906926
2.47E+09	58%	-2.34219	2.47E+09	2.873983
2.48E+09	58%	-2.37285	2.48E+09	2.916145
2.49E+09	57%	-2.47035	2.49E+09	2.965443
2.5E+09	58%	-2.3868	2.5E+09	2.880728

Frequency	Efficiency	Efficiency . dB	Frequency	Gain . dB
5.15E+09	65%	-1.85252	5.15E+09	2.274527
5.2E+09	62%	-2.0823	5.2E+09	2.314546
5.25E+09	60%	-2.18393	5.25E+09	2.391462
5.3E+09	61%	-2.1755	5.3E+09	2.468697
5.35E+09	61%	-2.14496	5.35E+09	2.405616
5.4E+09	60%	-2.22463	5.4E+09	2.422098
5.45E+09	61%	-2.11757	5.45E+09	2.781158
5.5E+09	61%	-2.15105	5.5E+09	2.714014
5.55E+09	66%	-1.8314	5.55E+09	2.572588
5.6E+09	67%	-1.7071	5.6E+09	2.690885
5.65E+09	67%	-1.74773	5.65E+09	2.804433
5.7E+09	64%	-1.91613	5.7E+09	2.800621
5.75E+09	62%	-2.10672	5.75E+09	2.572987
5.8E+09	58%	-2.34557	5.8E+09	2.347272
5.85E+09	61%	-2.12044	5.85E+09	2.550763

3-6 Environment treatment

N/A

3-7 Directional drawing of horizontal plane of (2.4G)

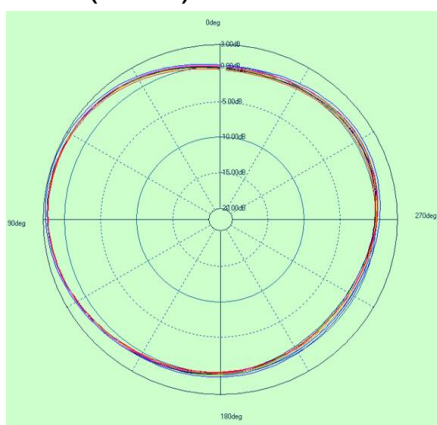

Theta 90deg

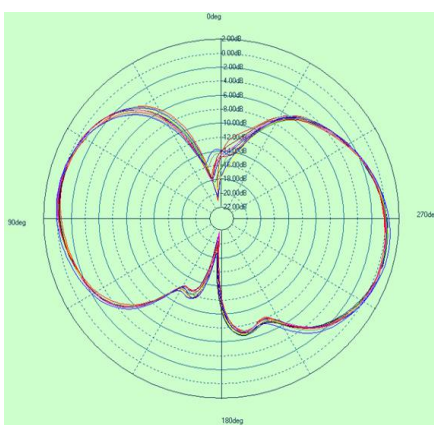

Phi 0deg

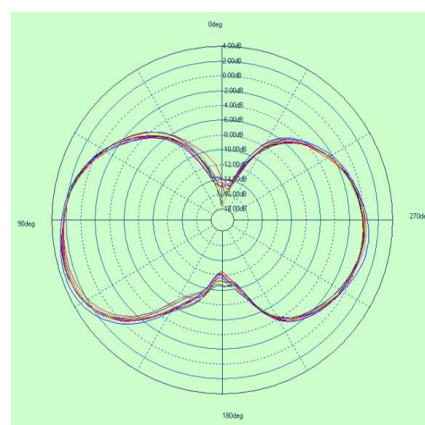

Phi 90deg

ANTENNA SPECIFICATION

CUS P/N :WC0F
ZTX P/N :WC0F

ApplicationDate:Qct.09,2019
Editor:

Rev: R:A4
Page 7 of 8

(5G)

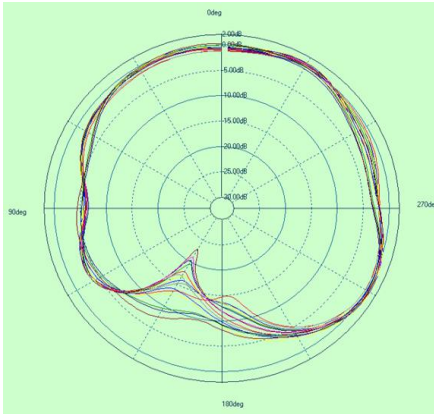

Theta 90deg

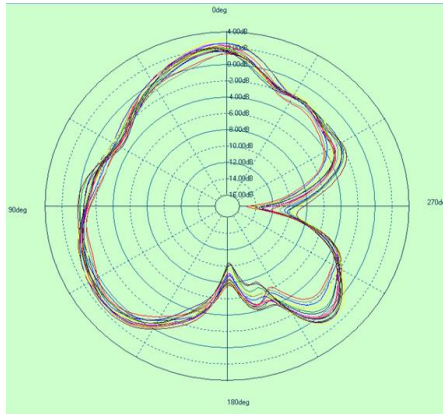

Phi 0deg

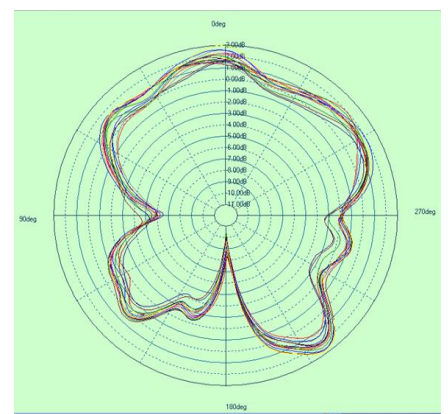

Phi 90deg

3-8 3D radiation drawing

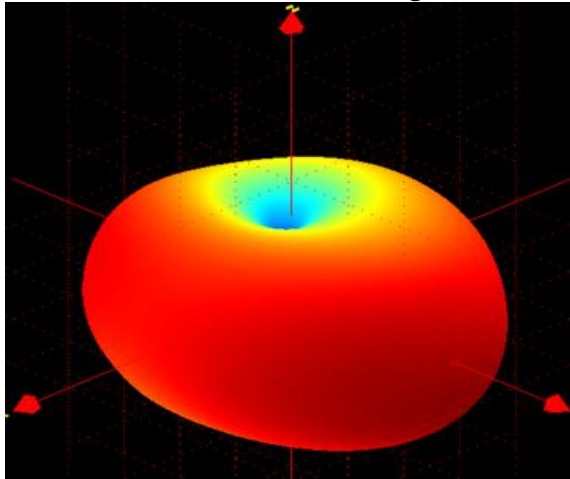

(2.4G)

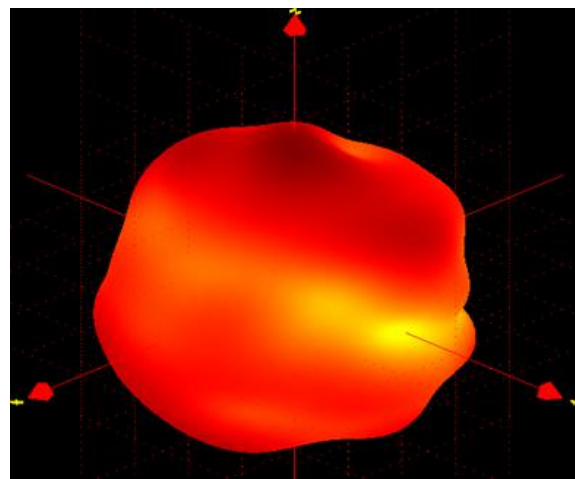

(5G)

ANTENNA SPECIFICATION

CUS P/N :WC0F
ZTX P/N :WC0F

ApplicationDate:Qct.09,2019
Editor:

Rev: R:A4
Page 8 of 8

4. Mechanical Specification

版本	说明	审核	日期	批准	日期
A2	4处插脚改模	黄小宇	2016.10.25		
A3	调整长度管控尺寸	黄小宇	2017.03.06		
A4	更改包装材料	黄小宇	2017.09.12		

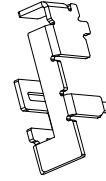
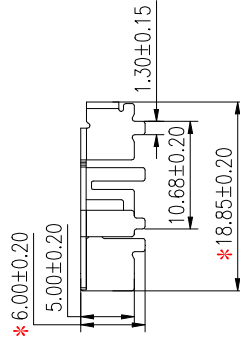
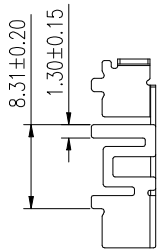
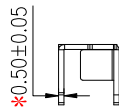
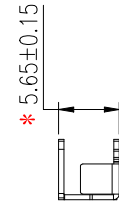
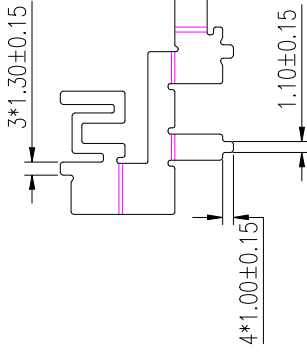

未注明公差		制图		审核		日期		批准	
5-10	±0.08	黄小宇	2017.09.12	mm	A2	1:1	1.01.00642		
10-35	±0.10	郭频	2017.09.12	材料	SUS304	T=0.50mm	原码		1/1
35-50	±0.12	审核	/	工艺	镀膜	产品标准	WC0F (WIFI)		
50-100	±0.15	龙秋霖	2017.09.12	图例	A4		ZTX-QR-R0-018		
100 0VE	±0.20								

MATTER	Rohs (PPM)
Cd	≤100
Pb	≤1000
Hg	≤1000
Cr6+	≤1000
PBB	≤1000
PBDE	≤1000

环保要求:

- 备注:
1. 角度尺寸模具设计时依图纸尺寸作参照, 样品及量产实配即可;
 2. 打"*"为Cpk尺寸 (Cpk ≥ 1.67);
 3. 材质说明: (SUS304 硬度270°-300° 厚度0.50mm);
 4. 字码说明(采用宋体, 要求字迹清晰, 弹片无变形);
 5. 产品不能有油污、毛刺、利边、缺料、变形、压印过深等不良;
 6. 需通过48小时盐雾测试;
 7. 包装方式载带包装, 运输过程中产品不能挤压碰撞等;
 8. 未经过ZTX公司确认, 材料不能随意更改;