

料号	705-LDX10B-00
项目	金属板灯LDX100Bi说明书
成品尺寸	100*140 mm
公差	±1mm
材质	105g 哑粉纸
工艺	骑马订

颜色要求 双色印刷

C:0 M:100 Y:80 K:0

其他

设计师 李佳龙 文案 吴水宁

重要: PDF 文件仅供预览, 实际印刷请使用 AI 转曲文档  
(或 Cdr 转曲文档)

 刀模线 > 标示线刀模线  
 标示线 > 请勿印刷!

印刷要求:

色相正确、印迹牢固、套印准确、各色套印不露杂色,  
套印误差≤1mm, 模切走位≤±1mm

合格证  
QC PASS

# Godox



Wechat  
Official Account  
神牛微信公众号

## 深圳市神牛摄影器材有限公司

地址: 深圳市宝安区福海街道塘尾社区福川工业区厂房2栋  
电话: 0755-29609320(8062) 传真: 0755-25723423 邮箱: godox@godox.com

## GODOX Photo Equipment Co., Ltd.

Add.: Building 2, Yaochuan Industrial Zone, Tangwei Community, Fuhai Street, Bao' an District, Shenzhen 518103, China Tel: +86-755-29609320(8062) Fax: +86-755-25723423  
E-mail: godox@godox.com

[www.godox.com](http://www.godox.com)

Made in China | 705-LDX10B-00

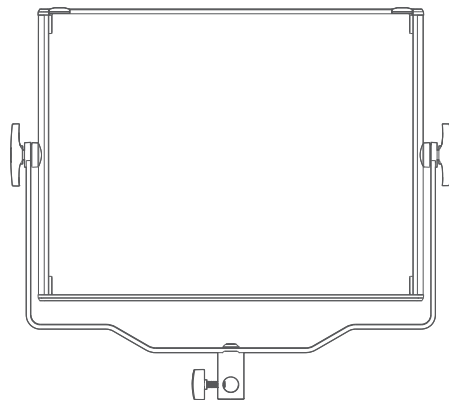

# LDX100 Bi

双色温面板摄影灯  
Bi-color Panel Light

使用手册  
Instruction Manual

## 重要的安全说明及注意事项

首先作为最基本原则：本产品为专业灯光布景设备，应由专业灯光师使用或在专业人士指导下使用。使用时必须始终遵循基本的安全预防措施，具体安全预防措施如下：

1. 使用前必须阅读并理解产品说明书。
2. 专业灯具，禁止儿童使用。当儿童靠近时，家长或监护人必须密切监督，以免儿童因碰撞灯具或私用灯具造成人身伤害。
3. 本灯具并非普通照明灯具，不可用于普通照明，任何有过眼部损伤或眼部敏感的人群均应避免使用本灯具。
4. 灯具点亮时，必须小心使用，禁止接触高温部件，如 LED 灯珠，以免造成灼伤。
5. 灯具点亮时，任何情况下均禁止直视灯珠。应该在专业灯光师指导下使用强光，任何情况下避免长时间处于强光环境，如引起眼睛不适，请及时关闭灯具，暂停使用，请及时就医。
6. 倘灯珠损坏或因热变形，应停止使用，并及时联系制造商、服务代理商或合格的维修人员更换灯珠，以免发生意外。
7. 本产品仅适用于  $-20^{\circ}\text{C}\sim+40^{\circ}\text{C}$  工作环境温度及正常湿度环境下使用。
8. 请勿使用损坏的设备或设备配件，待专业维修人员检查维修，确认设备正常方可使用。
9. 在使用过程中，如果本产品由于跌落、受到挤压或遭受强烈冲击而造成外壳破裂的，请勿继续使用，以免因接触到内部电子元件而受到电击伤害。
10. 如需要延长线，请使用额定电流 $\geq$ 该设备额定电流的延长线。如延长线额定电流小于该设备，可能导致过热。
11. 部分产品电源线较长，请合理放置电源线，使其处于安全位置。避免电源线接触过热物体表面，避免放置不当导致拉扯损坏或绊倒现场人员。请使用原厂原装电源线，如使用非原厂电源线导致产品损坏，概不在本厂维修范围内。
12. 在清洁和维修之前，请务必从电源插座上拔下该设备插头。不使用时，禁止拉扯电源线以将设备插头从电源插座中拔出。正常断电，应是用手抓住该设备插头两端，将插头从电源插座中拔出。此设备需连接到接地插座中。
13. 本设备没有防水性能，请让设备保持干燥，请勿将本设备浸入水中或其他液体中，设备需安装在干燥且通风处，避免在雨天、潮湿、多尘或过热环境下使用。请勿将任何物体置于灯具上或使液体流入灯具内部，以免发生意外。
14. 请勿私自拆卸产品，如产品出现故障，须由本公司或授权的维修人员进行检查维修。
15. 存放本设备之前，请确保设备已完全冷却。存放时，将电源线从设备上拔出。设备应放置于设备便携包内或通风干燥处。
16. 请勿将设备放置在酒精、汽油等易燃挥发的溶剂附近。
17. 本厂不推荐的产品附件，请勿使用，以免导致火灾、触电或人身伤害。
18. 清洁本设备时，请勿用湿布擦拭，请用干布，软布擦拭设备污垢。
19. 设备使用前，请注意将保护罩取下。
20. 本产品已通过 ROHS, CE 和 FCC 认证，请参考相关国家标准使用和操作。

21. 安全说明依据本厂严格测试制定，设备设计和规格如有变更，恕不另行通知。客户可以上神牛官网查看最新的电子版说明，了解产品最新资讯。
22. 部分产品内置锂电池，此类产品请使用专用的充电器进行充电，并且按正确的操作说明，在规定的电压、温度范围内使用。
23. 部分产品使用电池供电，此类产品请勿使用说明书中未指定的任何电池、电源或附件。请将电池和其他附件置于儿童及婴幼儿无法触及之处。如果儿童或婴幼儿吞下电池或附件，请立即就医。如果电池漏液、变色、变形、冒烟或发出异味，请立即将其取出。在取出过程中请小心，以免烫伤。如果继续使用，可能会引起火灾、触电或皮肤烫伤。请勿使用任何变形或改造过的电池，请勿拆卸或改造本产品或电池。请勿加热电池或焊接电池。请勿让电池与火或水接触。请勿让电池受到强烈的外力撞击。请勿将电池的正负极错误插入，或将新旧电池或不同类型的电池混合使用。
24. 一年保修期，消耗品电池、适配器、电源线等配件不在此保修范围内。
25. 经发现，擅自检修设备，将取消一年保修期，维修需要收取相关费用。
26. 对于不规范操作引起的机器故障不在保修范围内。

## 保存这些说明

## 前言

感谢您购买神牛产品。

LDX100Bi 是一款金属材质双色温面板摄影灯，冷暖色温可调，拥有 11 类 FX 场景光效；支持蓝牙 APP/ 无线 2.4G/ 灯体面板控制；常适用于广告摄影、婚纱人像、新闻采访、影视制作、微电影拍摄等场景。

## 主要特点

- 广域色温，支持 2800K-6500K 色温之间自由调节
- 2 种供电方式，支持 DC 供电或 V 口电池供电
- 3 种控制方式，支持蓝牙 APP/2.4G 遥控器 / 灯体控制
- 可拆卸柔光板，为布光提供更多可能
- 拥有 11 类 FX 场景光效：闪光灯、雷闪电、多云、坏灯泡、电视机、蜡烛、火、烟花、爆炸、焊接、SOS
- 可预设 10 组常用光效，实际拍摄无需费时自调
- 底部支架为灯具提供 360° 旋转角度，使实际布光灵活多变。

## 警告

- ▲ 请保持干燥：请勿用湿手接触产品，亦不可将产品浸入水中或暴露于雨中。
- ▲ 请勿私自拆卸产品，如产品出现故障须由本公司或授权的维修人员进行检查维修。
- ▲ 请勿让儿童接触本产品。
- ▲ 本产品不能防水，在雨天及潮湿环境下请注意防水。
- ▲ 请勿放置在超过 40 摄氏度的高温环境中。
- ▲ 请勿在化学品、可燃性气体或其他特殊物质附近使用 LED 灯。在这些场合下，请注意相关警告标识。

## 部件名称

### 灯体

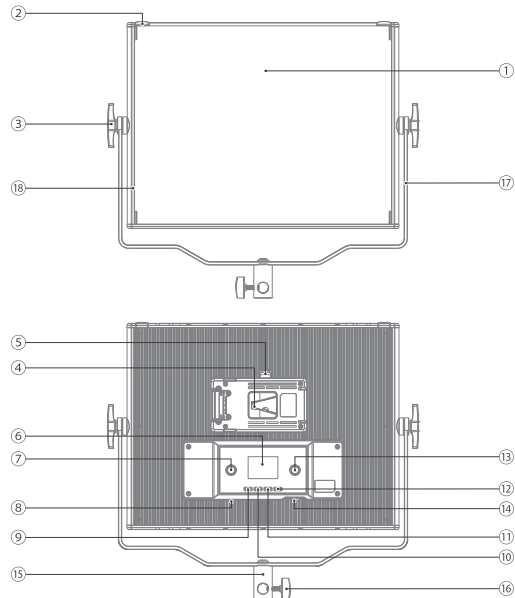

- |            |               |            |
|------------|---------------|------------|
| 1. 可拆卸柔光板  | 7. CCT/FN 旋钮  | 13. DIM 旋钮 |
| 2. 拆装推钮    | 8. DC 输入接口    | 14. 开关按键   |
| 3. 支架调节旋钮  | 9. MODE 按键    | 15. 套筒     |
| 4. V 口型电池槽 | 10. 无线按键      | 16. 套筒旋钮   |
| 5. 显示屏     | 11. 锁定按键      | 17. 支架     |
| 6. 显示屏     | 12. PRESET 按键 | 18. 安装滑道   |

## 物料清单

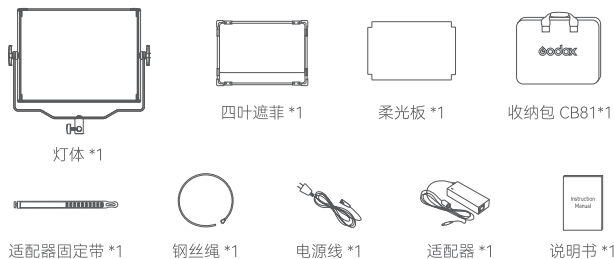

## 可另购附件

遥控器 RC-A6II 柔光箱

## 供电方式

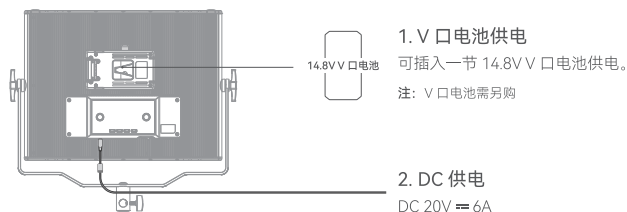

## 安装柔光板

往灯珠反方向推动拆装推钮，将柔光板从灯体上方顺着两侧滑道滑下，最后往灯珠方向推动拆装推钮完成安装。

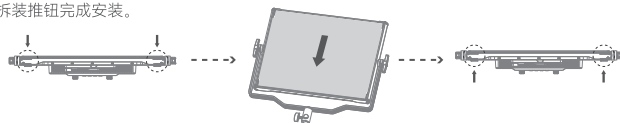

## 安装遮菲

往灯珠反方向推动拆装推钮，将闭合状态下的遮菲从灯体上方顺着两侧滑道滑下，最后往灯珠方向推动拆装推钮完成安装。

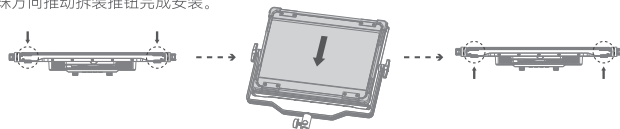

## 同时安装遮菲和柔光板

需要同时安装柔光板和遮菲：请将柔光板安装在遮菲上，往灯珠反方向推动拆装推钮，将安装好柔光板的遮菲从灯体上方顺着两侧滑道滑下，最后往灯珠方向推动拆装推钮完成安装。

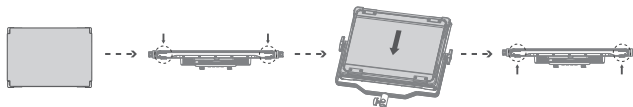

## 开关机

1. 插入一节 V 口电池后，拨动开关按键拨至 < 开 >，即可实现开机。
2. 通过适配器连接交流电后，拨动开关按键拨至 < 开 >，即可实现开机。
3. 无论处于哪种供电，拨动开关按键拨至 < 关 > 即可实现关机。

## 亮度调节

处于 CCT 色温模式 /FX 光效模式界面时，直接旋转 DIM 旋钮即可调节亮度，左旋一次减少 1 个单元值，右旋一次增加 1 个单元值，快速旋转进入快调模式，亮度调节范围为 0%-100%。



## 模式选择

短按 MODE 按键可切换色温模式 /FX 光效模式。

### 1. 色温模式

切换至色温模式，旋转 CCT/FN 旋钮可调节色温，左旋一次减少 100K 色温，右旋一次增加 100K 色温，支持快调，调节范围为 2800-6500K。

短按 CCT/FN 旋钮，可切换至 2800K/3200K/4300K/5600K/6500K。



### 2. FX 场景光效模式

切换至 FX 场景光效模式，旋转 CCT/FN 旋钮可调节光效类型，共有 11 类。短按 CCT/FN 旋钮可调节光效档位。



### 光效表

FX1	FX2	FX3	FX4	FX5	FX6	FX7	FX8	FX9	FX10	FX11
闪光灯	雷闪电	多云	坏灯泡	电视机	蜡烛	火	烟花	爆炸	焊接	SOS

## 无线设置

短按无线按键进入 2.4G 无线设置界面，旋转 CCT/FN 旋钮可选组别 / 频道 /ID/ 蓝牙。

**组别 GR:** 选至组别界面，短按 CCT/FN 旋钮，组别边框出现闪烁，旋转 CCT/FN 旋钮可选 16 个组别 (A-F, 0-9)。



**频道 CH:** 选至频道界面，短按 CCT/FN 旋钮，CH 出现闪烁，旋转 CCT/FN 旋钮可选 32 个频道 (1-32)。



**ID 号:** 选至 ID 界面，短按 CCT/FN 旋钮，ID 出现闪烁，旋转 CCT/FN 旋钮可选 OFF(关闭)/99 个 ID 号 (1-99)。



**蓝牙重置:** 选至蓝牙界面，长按 CCT/FN 旋钮，蓝牙符号出现闪烁，表示正在重置中，闪烁停止，蓝牙重置完毕。

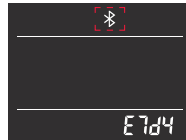

**蓝牙 MAC 码:** 位于蓝牙界面右下角，方便快速找到灯具进行配对。

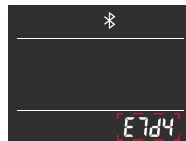

注：2.4G 无线，蓝牙默认开启。

注：使用遥控器 RC-A6II(另购)，遥控器组别、通道和 ID 号需和灯体组别、通道和识别号 (ID 号) 相同。

## “Godox light”APP

扫描二维码即可下载“Godox Light”手机 APP(安卓和苹果系统都可以使用)。

注：首个移动设备(手机或平板电脑)可直接使用 APP 操控灯体,更换其他移动设备时,灯体需进行蓝牙重置方可正常使用 APP。APP 需升级至 V3.0 以上版本。



## 锁定功能

短按锁定按键,界面出现 <🔒>,界面随后被锁定,此时按动其他按键无操作反应;再次短按锁定按键,界面中 <🔒> 消失,界面随后被解锁。

注：锁定功能仅锁定控制面板,无线控制不受此功能影响,2.4G 遥控器/APP 依然可控制灯体。



## 预设功能

短按预设按键进入预设设置界面,旋转 CCT/FN 旋钮可选 P1-P10 个预设组。选好某个预设组后,短按 CCT/FN 旋钮进入某组预设设置,旋转 CCT/FN 旋钮可选 (保存)/ (应用),短按 CCT/FN 旋钮进行确认。 (应用)选项确认后,自动跳转到已预设光效界面。

(保存): 保存当前灯具光效。

(应用): 应用该组预设光效。

注：某组如未预设过光效,界面不显示图标()选项。



## 照度数据

色温	测试条件	照度单位	0.5m	1m	2m
2800K	裸灯	lux	4060	1030	488
		fc	377	96	45.3
	带柔光板	lux	3860	984	464
		fc	358	91.4	43.1
3200K	裸灯	lux	4310	1100	523
		fc	401	102	48.6
	带柔光板	lux	4140	1060	497
		fc	385	98.1	46.2
4300K	裸灯	lux	4670	1190	564
		fc	434	110	52.4
	带柔光板	lux	4490	1140	535
		fc	417	106	49.7
5600K	裸灯	lux	4900	1250	594
		fc	455	116	55.2
	带柔光板	lux	4740	1210	570
		fc	441	113	53
6500K	裸灯	lux	4540	1160	551
		fc	422	108	51.1
	带柔光板	lux	4400	1130	531
		fc	409	105	49.3

注：以上测试皆在灯体 100%亮度下进行,照度值为平均值,非绝对值。

## 规格参数

型号	LXD100Bi
适配器输出	20V = 6A
输入功率	最大≈120W
色温	2800-6500K
调光范围	0%-100%
FX 光效	11 类
CRI	平均≥96
TLCI	平均≥96
频道	32 个(1-32)
组别	16 个(A-F, 0-9)
ID 号	99 个(1-99)
控制方式	2.4GHz 遥控器控制 / 蓝牙 APP 控制 / 灯体控制
2.4G 控制距离	最远 50m
蓝牙控制距离	最远 30m
支架调节角度	360°
工作环境温度	-20°C~+40°C(DC 供电时)
尺寸	417mm*468mm*63mm
净重≈	3.26kg

本设备包含型号核准代码为 :CMIITID:2020DP13510, 为该产品的无线电发射模块。  
设计和规格如有变更, 恕不另行通知。

## Safety Instructions and Attentions

**First of all, as the most basic principle: This product is a professional lighting set equipment and should be used by professional lighting engineers or under the guidance of professionals. Basic safety attentions must always be followed during use, as follows:**

1. Before use, please read and understand these instructions and attentions.
2. Professional lighting is prohibited for children. When children are near, parents or accompanying persons must supervise closely to prevent children from personal injury due to collision with lamps or private use of lamps.
3. This lighting product is not ordinary lighting product and cannot be used for general lighting. Anyone who has suffered eye damage or has sensitive eyes should avoid using this product.
4. When the lamp is on, it must be used with care. Do not touch high-temperature parts, such as LED lamp beads, to avoid burns.
5. When the lamp is on, it is forbidden to look directly at the lamp beads under any circumstances. Strong light should be used under the guidance of professional lighting engineers. Avoid prolonged exposure to strong light under any circumstances. If eye discomfort, please turn off the lamp in time, suspend use, and see a doctor immediately.
6. If the lamp bead is damaged or deformed by heat, stop using this equipment, and contact the manufacturer, service agent or qualified maintenance personnel to replace the lamp bead in time to avoid accidents.
7. This product is only suitable for use in -20°C to +40°C operating environment and normal humidity environment.
8. Do not use damaged equipment or accessories, and wait for professional maintenance personnel to check and repair to confirm being normal before use.
9. During using, if the casing of this product is broken due to being dropped, squeezed or subjected to strong impact, please do not use it, so as to avoid electric shock injury due to contact with internal electronic components.
10. If an extension cord is required, please use an extension cord with a current rating greater than or equal to that of the equipment. If an extension cord is rated less than the equipment, overheating may result.
11. Some products have long power cords, please place the power cords properly and keep them in a safe place. Avoid contacting the power cord with overheating surfaces, avoid improper placement that could cause pulling damage, or trip on-site personnel. Please use the certified power cord from the original manufacturer. If the product is damaged by using a non-certified power cord, it will not be repaired by our factory.



12. Be sure to unplug equipment from the power outlet before cleaning and repairing. When not in use, do not pull the power cord to unplug the equipment. For normal power-off, please hold both ends of the plug of the equipment with your hands and pull the plug out of power outlet. This equipment needs to be connected to a grounded outlet.
13. This equipment is not waterproof, please keep it dry and do not immerse it in water or other liquids. The equipment should be installed in a dry and ventilated place, and avoid using it in rainy, humid, dusty or overheated environments. Do not place any objects on the lamp or let liquid flow into the lamp to avoid accidents.
14. Do not disassemble the product without permission. If the product fails, it must be checked and repaired by authorized maintenance personnel.
15. Before storing, make sure that the equipment has cooled down completely. For storage, unplug the power cord from the equipment. The equipment should be placed in the carrying case or in a ventilated dry place.
16. Do not place equipment near flammable and volatile solvents such as alcohol and gasoline.
17. Do not use accessories that are not recommended by our factory to avoid fire, electric shock or personal injury.
18. When cleaning, do not wipe it with a damp cloth, please use a dry cloth or a soft cloth to wipe the dirt of the equipment.
19. Please take off the protective cover before using.
20. This product complies with ROHS, CE and FCC certification, please refer to the relevant national standards for use and operation.
21. The safety instructions are formulated according to the strict testing of the factory, and the design and specifications of the equipment are subject to change without prior notice. For latest product information, please check the GODOX website and view latest electronic instruction.
22. Some products have built-in lithium batteries. Please use specified chargers, and use them within a proper range of the specified voltage and temperature according to the correct operating instructions.
23. Some products are battery powered. Do not use any batteries, power sources or accessories not specified in the instructions for such products. Keep batteries and other accessories out of the reach of children and infants. In the instance that a child or infant swallows a battery or accessory, immediate emergency medical attention is required. If the battery leaks, becomes discolored, deformed, emits smoke, or emits an abnormal odor, remove it immediately. Be careful during removal to avoid burns. Continued use could result in fire, electric shock, or burns. Do not use any deformed or modified batteries. Do not disassemble or modify this product or battery. Do not heat or solder the battery. Keep the battery away from fire or water. Do not incorrectly

insert the positive and negative ends of batteries, or mix old and new batteries or batteries of different types together.

24. One-year warranty period, accessories such as consumable batteries, adapters, power cords, etc. are not covered by this warranty.
25. If it is found that the equipment is repaired without authorization, the one-year warranty period will be cancelled and relevant fees will be charged for maintenance.
26. Machine failures caused by non-standard operation are not covered by the warranty.

**keep these instructions!**

## Foreword

Thank you for purchasing !

Bi-color Panel Light LDX100Bi features: adjustable color temperature, 11 FX modes, Bluetooth APP/ 2.4G wireless/light body control, making it quite suitable for advertisement shooting, wedding portraits, interviews, film and television production, micro-film shooting etc.

## Main Features

- Wide CCT range freely adjustable from 2800K to 6500K.
- Two ways of power supply: DC power supply or V-mount battery power supply.
- Three ways of controlling: Bluetooth APP, 2.4G remote control and light body.
- Detachable diffuser provides more lighting possibilities.
- 11 FX modes: flash, lightning, cloudy, broken bulb, TV, candle, fire, firework, explosion, welding and SOS.
- 10 preset effects can be saved gives convenience.
- 360° rotatable bracket offers flexibility.

## ⚠ Warning

- ▲ Always keep this product dry. Do not use in rain or in damp conditions.
- ▲ Do not disassemble. Should repairs become necessary, this product must be sent to an authorized maintenance center.
- ▲ Keep out of reach of children.
- ▲ Do not use the flash unit in the presence of flammable gas. In certain circumstance, please pay attention to the relevant warnings.
- ▲ Do not leave or store the product if the ambient temperature reads over 40°C.
- ▲ Do not use the product in the presence of flammable gas. In certain circumstance, please pay attention to the relevant warnings.

## Name of Parts

### Light Body

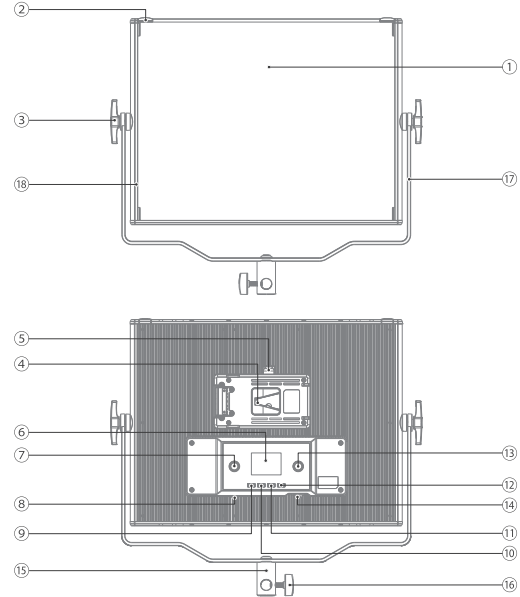

- |                              |                     |                         |
|------------------------------|---------------------|-------------------------|
| 1. Detachable Diffuser       | 7. CCT/FN Dial      | 13. DIM Dial            |
| 2. Disassembly Pusher        | 8. DC Input Port    | 14. Power Switch Button |
| 3. Bracket Adjustment Dial   | 9. MODE Button      | 15. Sleeve              |
| 4. V-mount Battery Slot      | 10. Wireless Button | 16. Sleeve Fixing Knob  |
| 5. Battery Detachment Button | 11. Lock Button     | 17. Bracket             |
| 6. Display                   | 12. PRESET Button   | 18. Installation Slide  |

## What's Inside

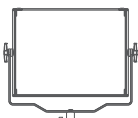

Light Body\*1



Barndoor\*1



Diffuser\*1



Carry Bag CB81\*1



Adapter Fixing Band\*1



Steel Rope\*1



Power Cable\*1



Adapter\*1



Instruction Manual\*1

## Separately Sold Accessories

Remote Control RC-A6II Soft Box

## Power Supply

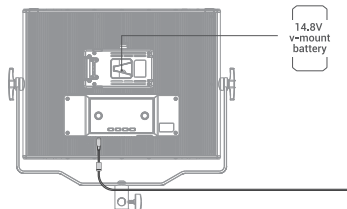

14.8V  
v-mount  
battery

### 1. V-mount battery power supply

One 14.8V V-mount battery installable.

**Note:** V-mount battery is sold separately.

### 2. DC power supply

DC 20V  $\Rightarrow$  6A

## Installation of the Diffuser

Push the disassembly pusher in the opposite direction of the light beads, insert in the diffuser along the slides, and then push the disassembly pusher in the direction of the light beads.

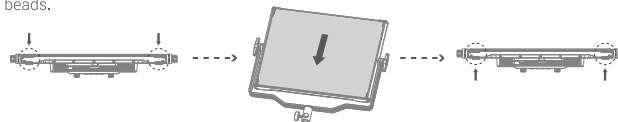

## Installation of the Barndoor

Push the disassembly pusher in the opposite direction of the light beads, insert in the closed barndoor along the slides, and then push the disassembly pusher in the direction of the light beads.

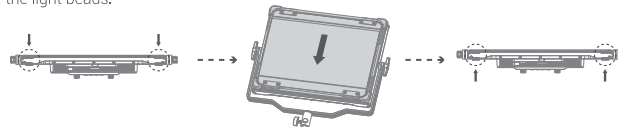

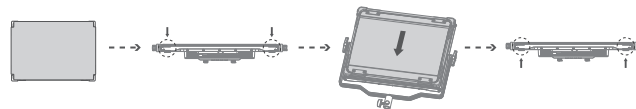

## Installation of the Diffuser and the Barndoor

Install the diffuser onto the barndoor first, then push the disassembly pusher in the opposite direction of the light beads, insert in the barndoor with diffuser along the slides, and then push the disassembly pusher in the direction of the light beads.



## Power Switch

1. Toggle the power switch button to  > after inserted one v-mount battery to turn on the device.
2. Toggle the power switch button to  > after connected to AC power supply with the adapter to turn on the device.
3. Toggle the power switch button to  > in either power supplies can turn off the device.

## Brightness Adjustment

When the light is in CCT/FX mode, turn the DIM dial can adjust the brightness from 0% to 100%. Turn left to decrease the brightness by 1 unit while turn right to increase the brightness by 1 unit, with quick adjustment available by turning quickly.

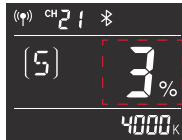

## Mode Selection

Short press the MODE button to switch between CCT mode and FX mode.

### 1. CCT Mode

Turn the CCT/FN dial left once can decrease the CCT value by 100K, while turn right once can increase the CCT value by 100K, with quick adjustment available and adjustable range from 2800K to 6500K.

Short press the CCT/FN dial can switch among 2800K/3200K/4300K/5600K/6500K.



### 2. FX Mode

Turn the CCT/FN dial in FX setting interface to select effect type (11). Short press the CCT/FN dial can adjust the effect level.



## FX Table

FX1	FX2	FX3	FX4	FX5	FX6	FX7	FX8	FX9	FX10	FX11
Flash	Lightning	Cloudy	Broken Bulb	TV	Candle	Fire	Firework	Explosion	Welding	SOS

## Wireless Setting

Short press the wireless button to enter 2.4G wireless setting, short press the CCT/FN dial to select GR/CH/ID/Bluetooth.

**GR:** Short press the CCT/FN dial and the group frame icon blinks, then turn the CCT/FN dial to select among 12 groups (A-F/0-9).



**CH:** Short press the CCT/FN dial and the CH icon blinks, then turn the CCT/FN dial to select among 32 channels (1-32).

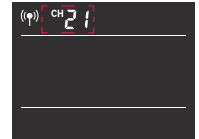

**ID:** Short press the CCT/FN dial and the ID icon blinks, then turn the CCT/FN dial to select among OFF/99 IDs (1-99).

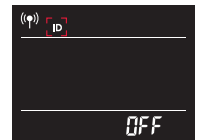

**Bluetooth reset:** Long press the CCT/FN dial until Bluetooth icon blinks means Bluetooth is resetting, it will stop blinking after successfully reset.

