

English

User Manual



More information please visit ADAM store

Specification

Product Name: EVE Bluetooth Transmitter & Receiver

Product Model: ABTADEVEWH

Interface: Micro USB (charge only) x 1  
3.5 mm AUX (individually foldable) x 2

Bluetooth Version: V5.0  
Bluetooth Range: 10 m (33 ft)  
Battery Capacity: 140 mAh  
Usage Time: up to 8 hrs

Operating Temperature: 0 ~ + 40 °C  
Storage Temperature: -20 ~ + 60 °C

Size: 47 x 39.9 x 13.9 mm Weight: 23.5 g  
Warranty: 3 years

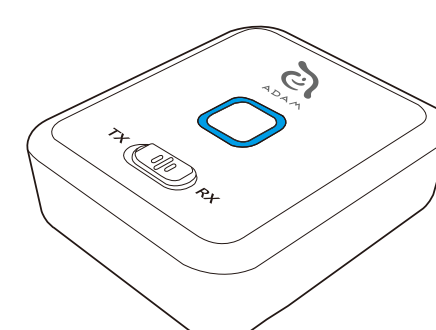

Product Introduction

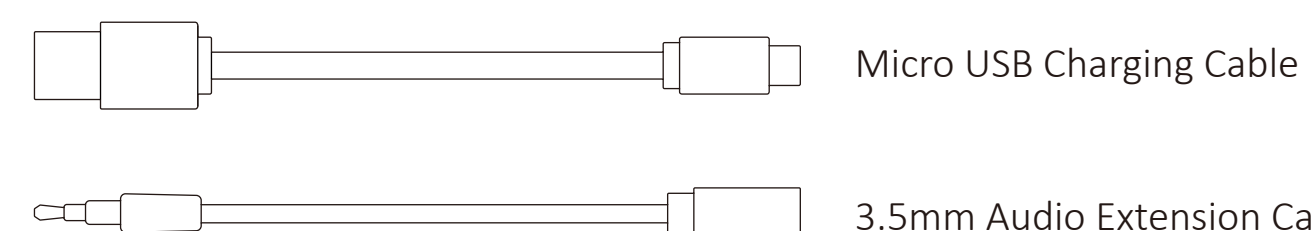
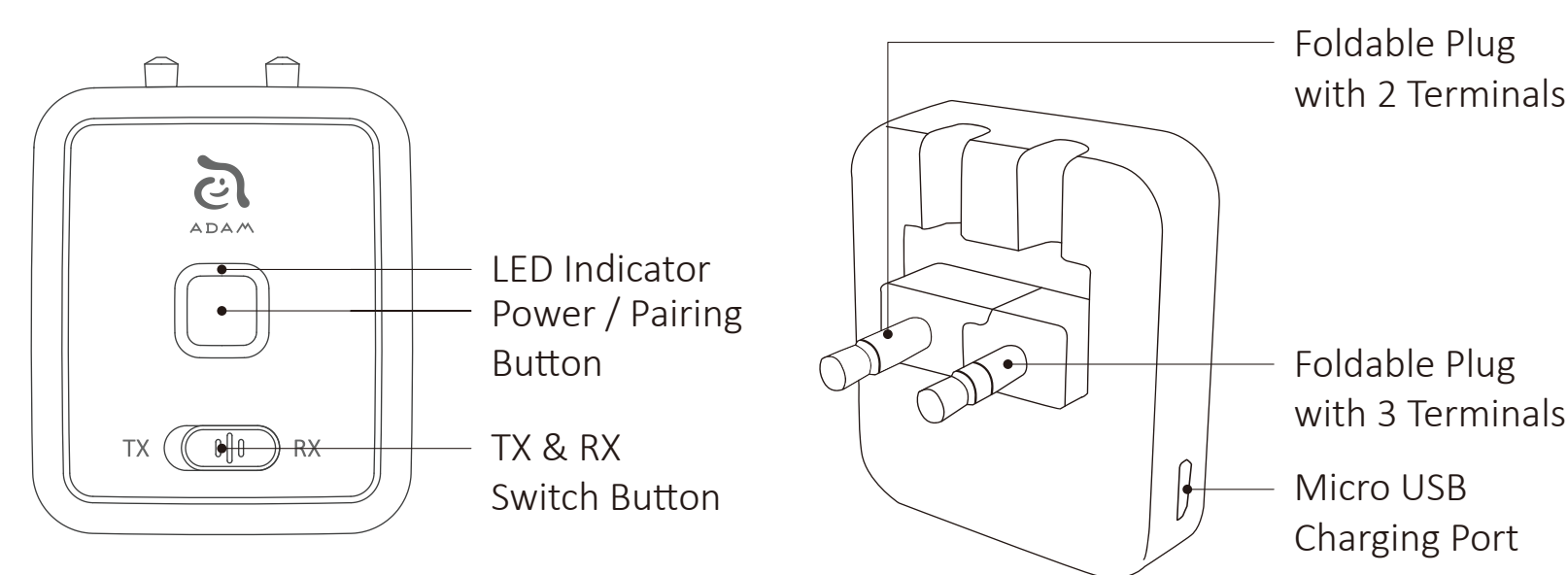

If you hear sound only from single ear, please uses 3-terminal plug (Stereo Plug).

Mode Selection

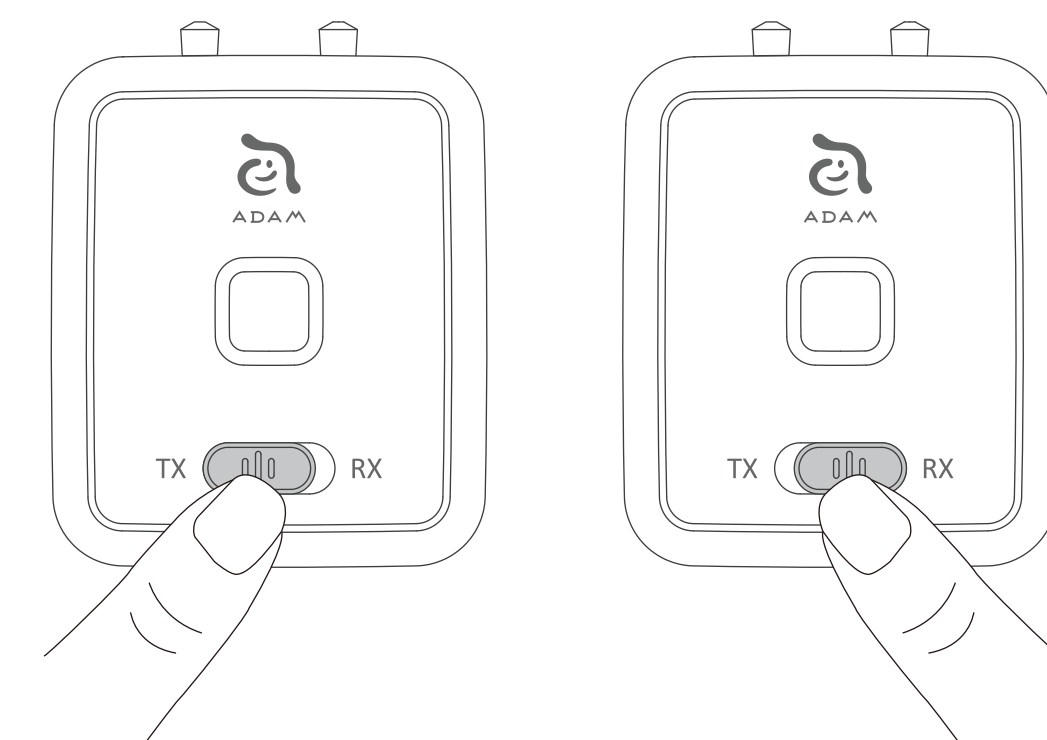

TX RX When you select the switch to "TX" position, the device will be set in "Transmitter Mode".

TX RX When you select the switch to "RX" position, the device will be set in "Receiver Mode".

How to Use

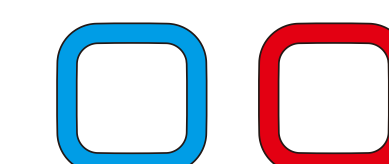
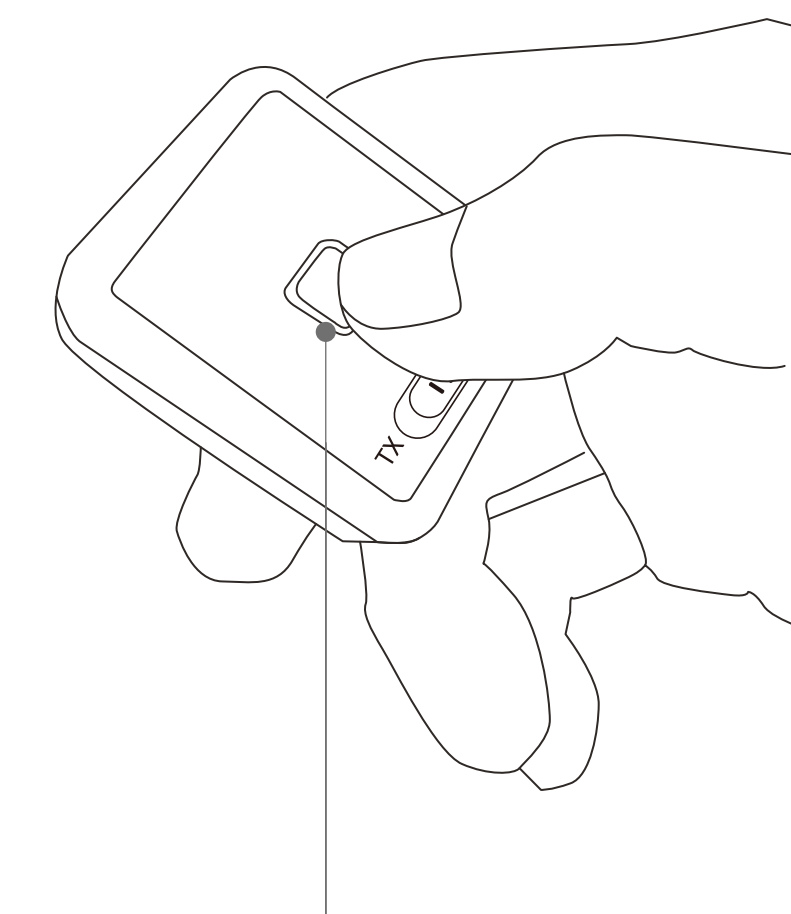

Two colors light

Button Operation

- Power ON / OFF: Long press for 3 sec
- Enable Pairing Mode: Short press twice
- Manual reconnect/disconnect: Short press while turned on
- Reset to default setting: long press for 10 sec while turned off

LED Indicator Status

- Power off: All LEDs off
- ◻ Bluetooth Pairing : Red/Blue flashes alternately
- ◻ Bluetooth Connected: Blue on
- ◻ Standby Mode: Blue flashes once each 5 sec
- ◻ Low Battery Alarm: Red flashes once each 5 sec
- ◻ Battery Charging: Red on

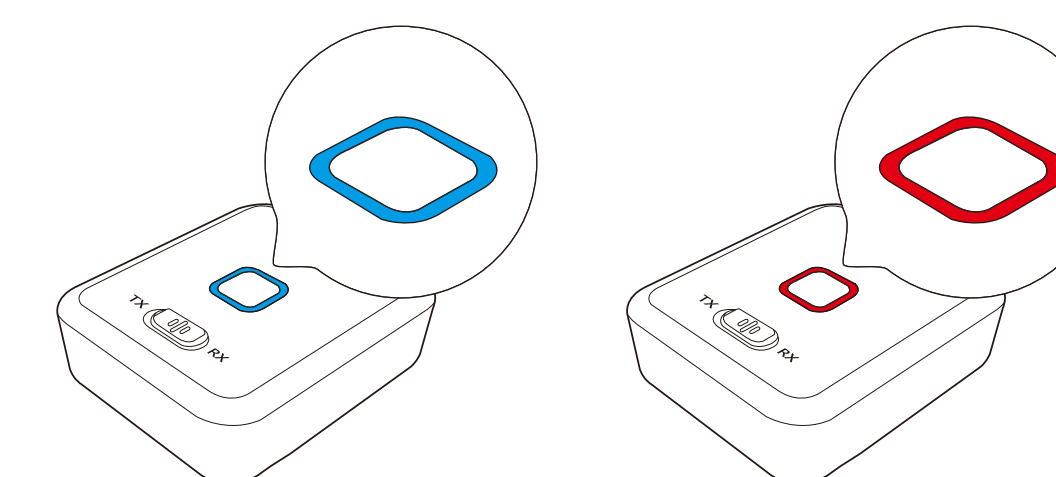

Power On

Power Off

TX Mode Pairing

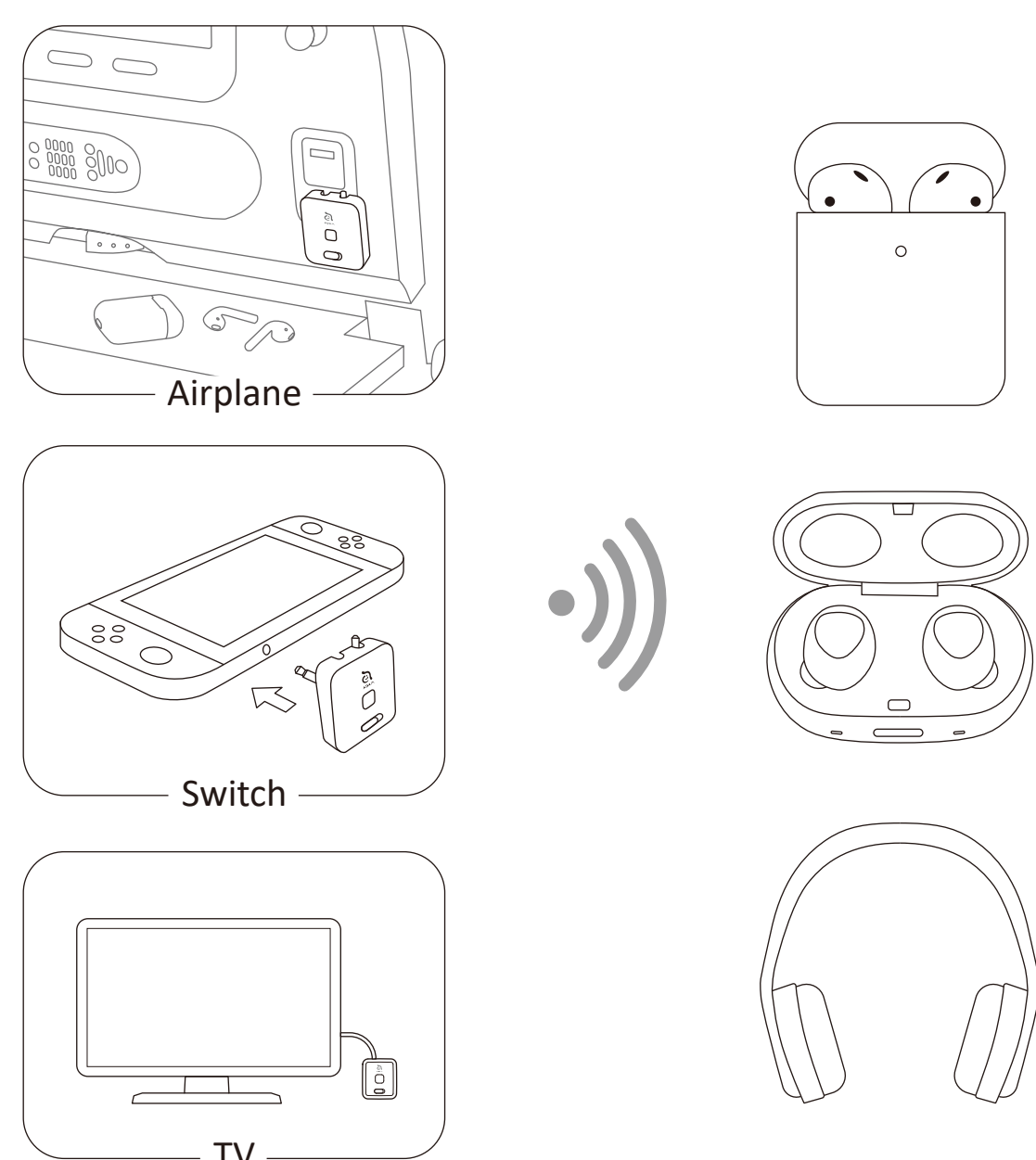

Compatibility

- AirPods Pro
- Apple AirPods
- B&O E8
- Bose QC35
- Bose SoundSport Free
- Powerbeats Pro
- Beats Solo
- Beats Solo Pro
- Beats Studio
- Beats X
- JayBird Run
- Other BT Earphones

Paire with BT Earphones

1. Check EVE switch button is at TX status.
2. Press the pairing button of EVE for 3 sec till power on.
3. Quick tap pairing button of EVE twice and then the LED indicator blinks blue/red alternately.
  - If you use the AirPods, please press the pairing button of Airpods till LED indicator white flashing.
  - If you use the AirPods, The LED indicator of charging box will become green.
4. Put EVE and your BT earphone as close as possible.
5. EVE LED indicator becomes blue, the pairing is completed.

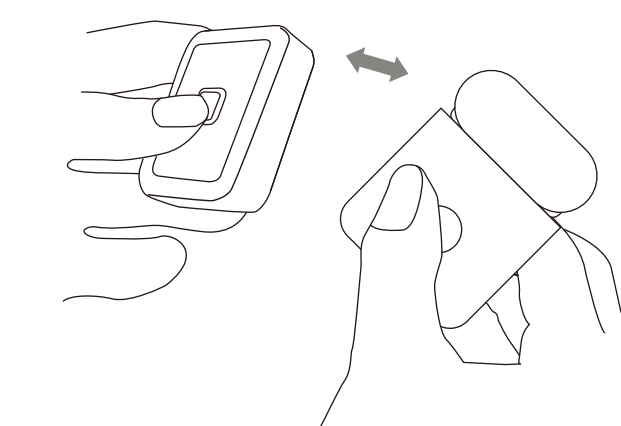
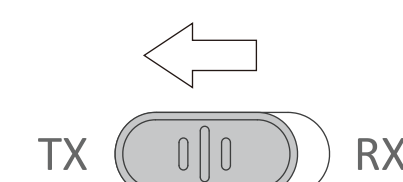

In-Flight Use

Unfold 3-Terminal Plug (Stereo Plug)

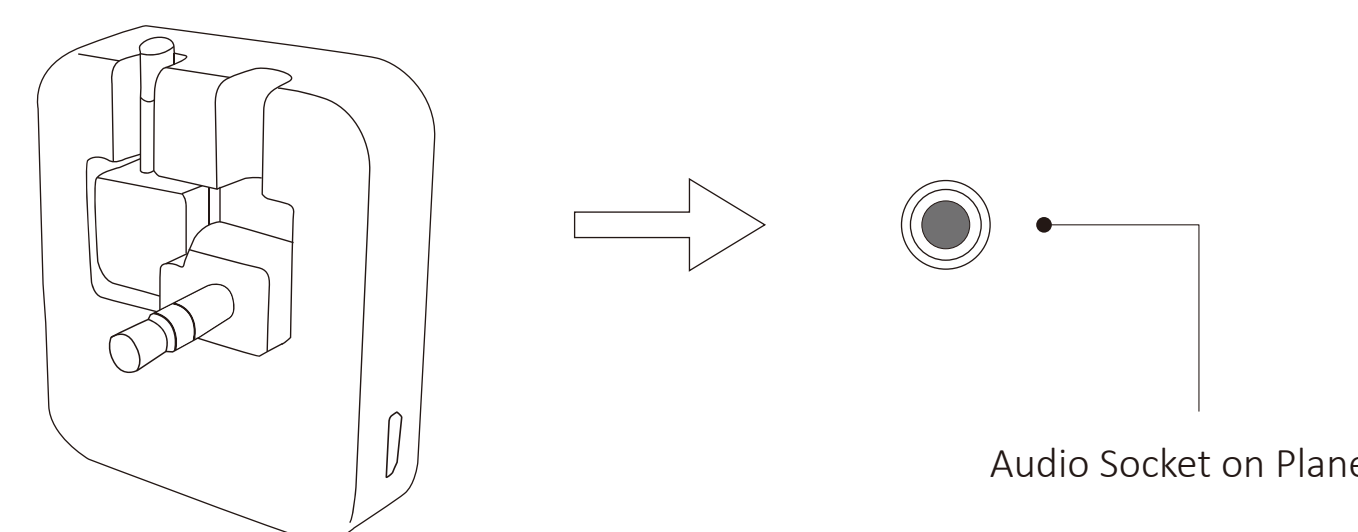

Unfold 2 Plugs

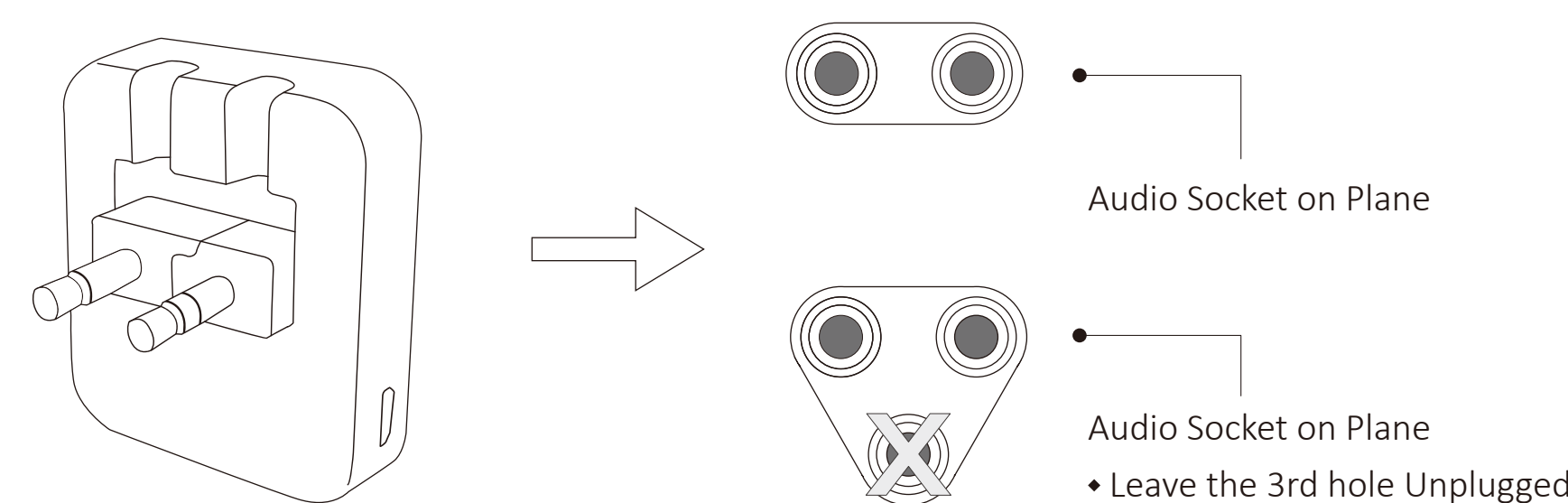

RX Mode Pairing

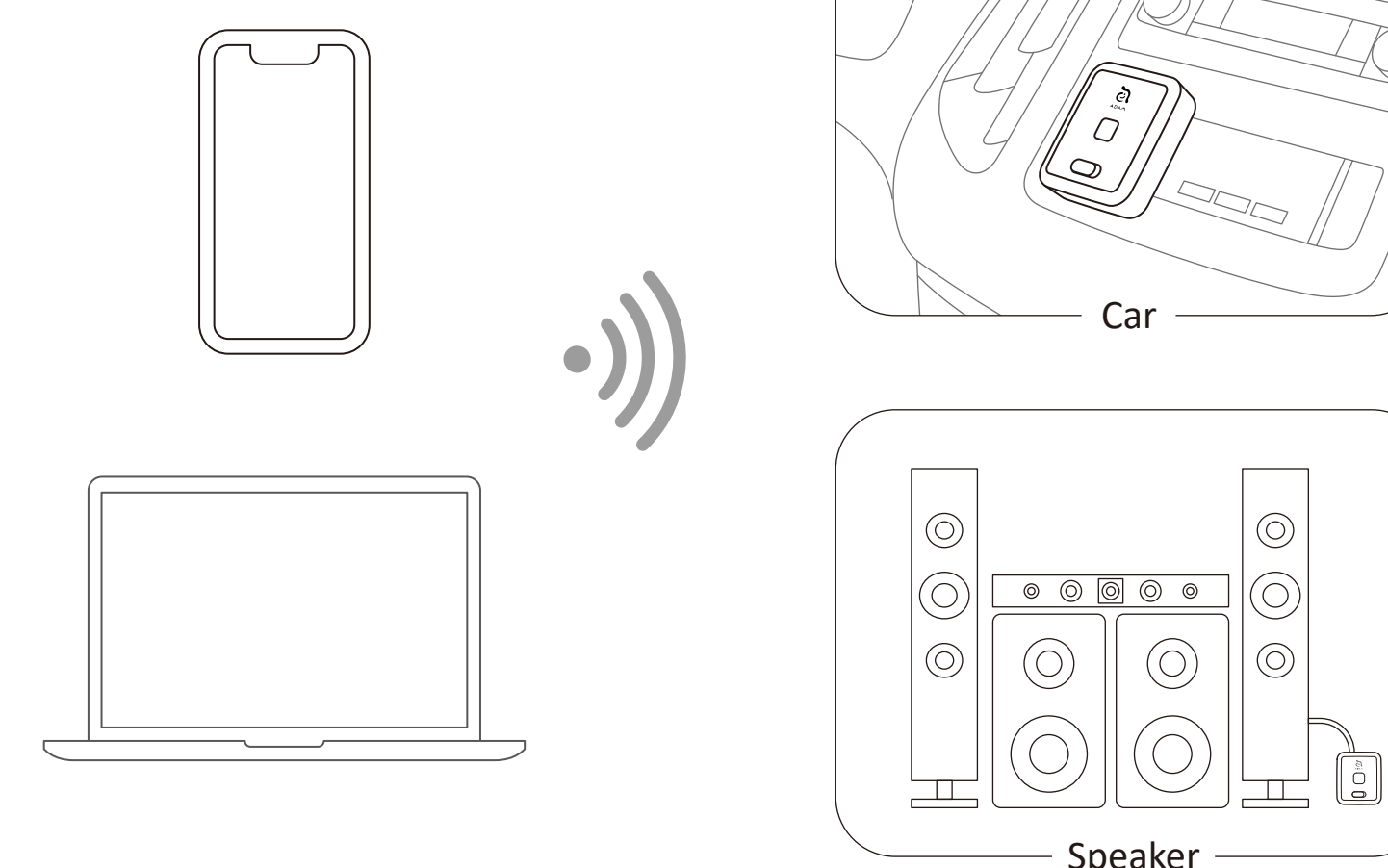

Paire with Mobile Devices

1. Check EVE switch button is at RX status.
2. Turn on the Bluetooth of your mobile device and search for "EVE BT5.0"
3. Press the pairing button of EVE for 3 sec till power on.
4. Quick tap pairing button of EVE twice and then the LED indicator blinks blue/red alternately.
5. Put EVE and your mobile device as close as possible.
6. When EVE LED indicator becomes blue, the pairing is completed.

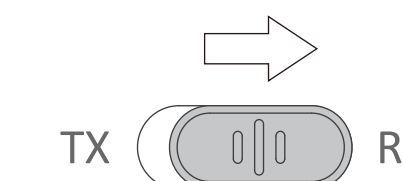

FCC STATEMENT :

Federal Communication Commission Interference Statement  
This equipment has been tested and found to comply with the limits for a Class B digital device, pursuant to Part 15 of the FCC Rules. These limits are designed to provide reasonable protection against harmful interference in a residential installation. This equipment generates, uses, and can radiate radio frequency energy and, if not installed and used in accordance with the instructions, may cause harmful interference to radio communications. However, there is no guarantee that interference will not occur in a particular installation. If this equipment does cause harmful interference to radio or television reception, which can be determined by turning the equipment off and on, the user is encouraged to try to correct the interference by one or more of the following measures:

- Reorient or relocate the receiving antenna.
- Increase the separation between the equipment and receiver.
- Connect the equipment into an outlet on a circuit different from that to which the receiver is connected.
- Consult the dealer or an experienced radio/TV technician for help.

Caution: Any changes or modifications not expressly approved by the party responsible for compliance could void the user's authority to operate this equipment.

FCC Caution:  
This device complies with Part 15 of the FCC Rules. Operation is subject to the following two conditions: (1) This device may not cause harmful interference, and (2) this device must accept any interference received, including interference that may cause undesired operation.

FCC Radiation Exposure Statement:  
RF Exposure: The device has been evaluated to meet general RF exposure requirement. The device can be used in portable exposure condition without restriction, and the transmitter module may not be co-located with any other transmitter or antenna.