

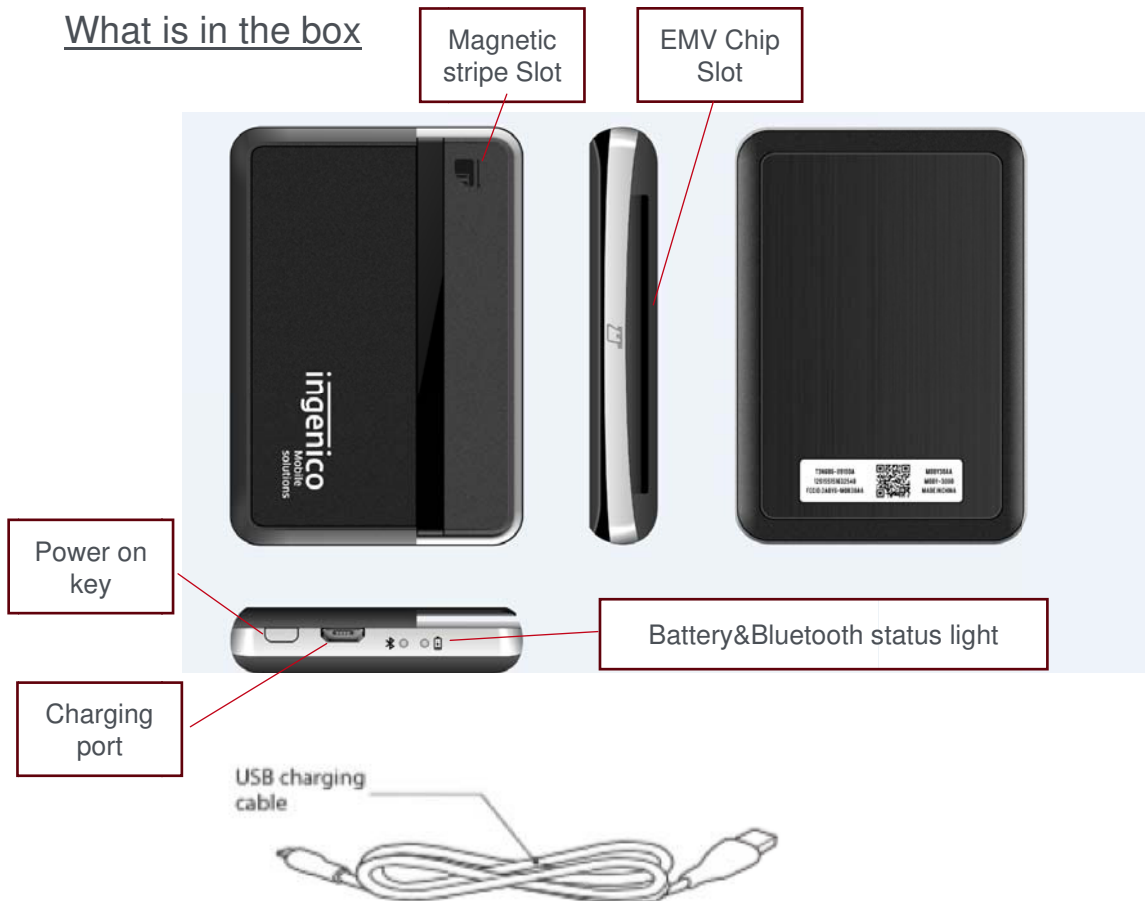

User Guide for MOBY-3000

What is in the box



This card reader supports the acceptance of EMV® chip cards, magnetic stripe cards. It is certified and compliant with industry payment standards: EMV Level 1 / EMV Level 2 / TQM, FCC / RoHS / WEEE.

Pairing the device

Here is how to pair your device via Bluetooth® wireless connection:

- 1 Plug the charging cable into a wall outlet and charge card reader for at least 1 hour
- 2 Open the Mobile App, go to Settings / Card Reader
- 3 Press and hold the Power Button until blue light is blinking and follow on-screen instructions in the app
- 4 Once pairing is successful, the blue light will be steady

LED & status indicator

Battery status

A Red LED is present next to the USB charging port for battery status.

Battery full	Red LED is ON and steady
Battery low	Red LED blinking slowly
Battery out of capacity	Red LED is OFF
Battery charging	Red LED blinking quickly

Bluetooth status: A Blue LED above the Power Button will be ON when a device is connected.

Any Changes or modifications not expressly approved by the party responsible for compliance could void the user's authority to operate the equipment.

This device complies with part 15 of the FCC Rules. Operation is subject to the following two conditions: (1) This device may not cause harmful interference, and (2) this device must accept any interference received, including interference that may cause undesired operation.

This equipment complies with FCC radiation exposure limits set forth for an uncontrolled environment.

This transmitter must not be co-located or operating in conjunction with any other antenna or transmitter.

Note: This equipment has been tested and found to comply with the limits for a Class B digital device, pursuant to part 15 of the FCC Rules. These limits are designed to provide reasonable protection against harmful interference in a residential installation. This equipment generates, uses and can radiate radio frequency energy and, if not installed and used in accordance with the instructions, may cause harmful interference to radio communications. However, there is no guarantee that interference will not occur in a particular installation. If this equipment does cause harmful interference to radio or television reception, which can be determined by turning the equipment off and on, the user is encouraged to try to correct the interference by one or more of the following measures:

- Reorient or relocate the receiving antenna.
- Increase the separation between the equipment and receiver.
- Connect the equipment into an outlet on a circuit different from that to which the receiver is connected.
- Consult the dealer or an experienced radio/TV technician for help.