

Label information Model: (T1301N, T1301S, T1401N, T1401S, T1501N, T1501S, T1601N, T1601S)

A. Information to be displayed

1. The information that will be displayed on the e-label and information that will remain in the user manual is shown below:

	On E-Label	Manual
FCC ID number	Yes	No
SDoc Logo	No	Yes
15.19 statement (“ <i>This device complies with part 15 of the FCC Rules. Operation is subject to the following two conditions: (1) This device may not cause harmful interference, and (2) this device must accept any interference received, including interference that may cause undesired operation.</i> ”)	No	Yes
Class A / B Digital Device user manual statements ₁	No	Yes
Caution to the user that changes or modifications not expressly approved by the party responsible for compliance could void the user's authority to operate the equipment ₁	No	Yes
Information on E-label In Manual	No	Yes

B. Access to the required information on the e-label

1. Users are able to access the information in no more than three steps in a device’s menu. The actual steps are:

To access the e-label information, in the device,

Choose: Settings (on top right corner) > More Options > FCC ID & IC ID

No special access codes or permissions are required to go through the above steps beyond entering a user defined password to protect against unauthorized access to the device.

2. The information is stored on the device, no special accessories or supplemental plug-ins (e.g., a SIM/USIM card) are required to access the information.

Yes

3. Users are provided specific instructions on how to access the information.

The information to the user is provided in the User Manual document shipped with the product.

1. Users are able to access the information in no more than four steps in a device's menu.

Users are able to access the info. in 3 steps as provided above in step 2.

Settings>>More Options>>FCC ID & IC ID info.

2. The above information must be programmed by the responsible party and the information must be secured in such a manner that third-parties cannot modify it.

The e-label information is pre-programmed by the grantee. The user cannot modify the e-label formation.

1:34

◀ Search

LTE



tile

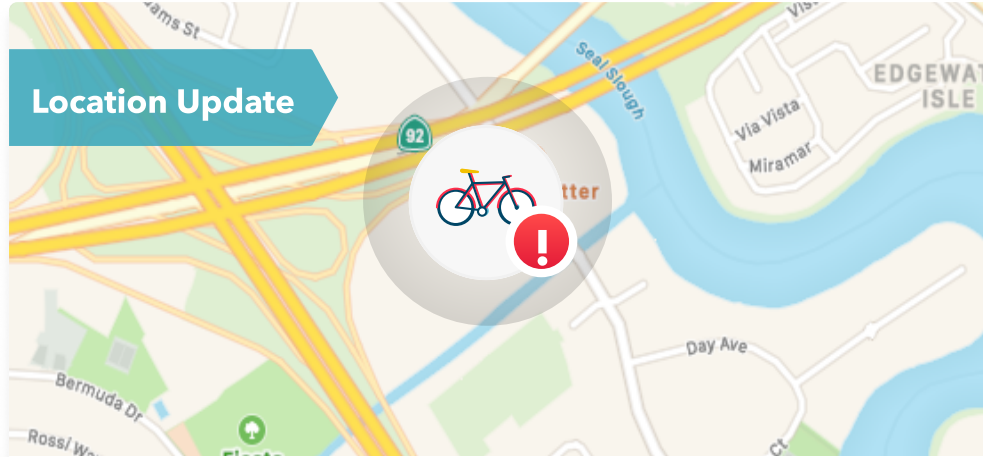

Location Update

Most Recent Location for Keys



1900 S Norfolks, San Mateo. 3mins ago

[Turn Off Notify When Found](#)



Car Keys

Find



Wallet

Find





Bike

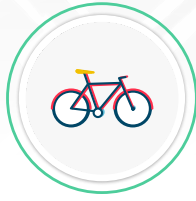

Nearby

Now

Find



Location History



Smart Alerts

Premium



Item Reimbursement

Protect



Find Your Phone

On



Shop Tile



Unlimited Sharing



Tile ringtones

Bionic Birdie



Siri Shortcuts



More Options



Help





More Options



Change Photo

Name

Bike

Category

Bike >

Actions

Tile Default Volume

Loud >

Replace Tile



Transfer Tile



Hide Tile



Basic Reimbursement



Subscription

Upgrade to Premium Protect



Device Details

Activated

2/15/18, 8:45AM

Firmware



FCC ID:

2ABXLT1401S

IC:

11858A-T1401S

CCAFXXXXXXXX

Model:

T1401S

Tile INC

Project Name: Mate 2021 (Royal W/B) ST: Markings on Rear Housing

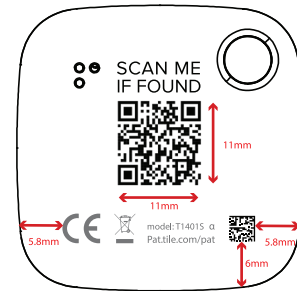

Without reset controller

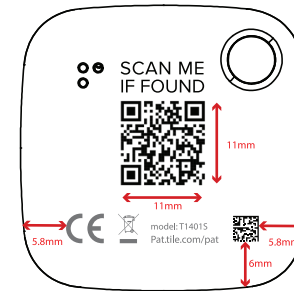

With reset controller

SCALE 1:1

						Line Code	Remark
Drafted:	Eleven	File Name:	Mate 2022 ST Housing Marking	Rev:	PVT&MP.v1	Reference	
PN:	410-10045-00 410-10062-00	SKU	TLE-T1401B TLE-T1401W	Side:	Face		
Scale:	See above	Units:	MM	Date:	09-02-2021		