



# User Manual

## A01-A60 LED Lamp

LED + Wi-Fi REPEATER

### Features

- Install like any other light bulb. Easy to setup and enjoy the extended Wi-Fi signal coverage evenly.
- Supports two Wi-Fi network mode: Access Point (AP) / Repeater
- Two build-in antennas for high throughput data exchange rate of maximum 300Mbps
- Compatible with most smart phones, tablets and computers that support Wi-Fi IEEE 802.11b/g/n standard at 2.4GHz.
- Remote LED lights ON/OFF and dimming control individually or by group
- Download the free Boost Android or iOS App to explore even greater functionality

### Box Contents

- One A01-A60 Bulb
- User Manual
- Limited Written Express Warranty

### Product Specifications

- Power Supply: 100~230V AC, 50/60Hz
- Lamp Socket: E26/E27/B22
- Power Consumption: 7.4W (LED + Wi-Fi Repeater), Peak 9W
- Operating Temperature: -20° C ~ +40° C
- Store Temperature: -40° C ~ +70° C

- Operating Humidity:  $10\% \leq RH \leq 95\%$ , Non condensation
- Atmospheric Pressure: 86kPa ~ 106kPa
- Colour: Neutral White
- Dimensions: 120mm (H) x  $\Phi$  60mm (Dia.)
- Weight: 290g (approx.)

## **Spécifications de produit (par ampoule)**

- Alimentation: 100 ~ 230V AC, 50/60 Hz
- Douille: E26 / E27 / B22
- Consommation d'énergie: 7.4W (LED + Wi-Fi Répéteur), Peak 9W
- Température de service: -20 °C à + 40 °C
- Stocker Température: -40 °C à + 70 °C
- Humidité de fonctionnement:  $10\% \leq HR \leq 95\%$ , sans condensation
- Pression atmosphérique: 86 kPa ~ 106 kPa
- Couleur: Blanc neutre
- Dimensions: 120mm (H) x 60mm  $\Phi$  (. Dia)
- Poids: 290g (environ).

### LED Lights

- Power: 6 Watts
- Luminance: 470 lumens
- Light Beam Angle: 240 degrees
- Colour Temperature: 3000K - Warm White
- CRI: 80
- Dimming: Yes (Do not use with external or outside dimmers. APP SOFTWARE DIMMING CONTROL)

### Ampoules à LED

- Puissance: 6 Watts
- Luminance: 470 lumens
- Angle du faisceau lumineux: 240 degrés
- Température de couleur: 3000K - Blanc chaud
- CRI: 80
- Dimming: Oui ( Ne pas utiliser avec des variateurs de lumière ou à l'extérieur APP LOGICIEL de commande de gradation)

### Wi-Fi Repeater

- Wi-Fi Standard: IEEE 802.11b/g/n
- Wi-Fi Transmitter Frequency Range: 2.412 - 2.462 GHz

- Power: 1.8 Watts (Standby), 2.8 Watts (Full load)
- 2T2R MIMO wireless technology
- Security Mode: 64/128 bit WPA-PSK/WPA2-PSK, WPA/WPA2
- Encryption Type: WEP64/WEP128/TKIP/AES
- Wi-Fi Transmitter power:
  - @ 802.11b: +15dBm (Max)
  - @ 802.11g: +15dBm (Max)
  - @ 802.11n: +17dBm (Max)
- Wi-Fi Receiver power:
  - @ 802.11b: -89dBm
  - @ 802.11g: -81dBm
  - @ 802.11n: -71dBm
- Distance Range between Router and A01-A60 Bulb: 115 feet (near line of sight)

© 2014 SENGLED, Incorporated. All rights reserved. Sengled pulse is a trademark of SENGLED, Incorporated, registered in the United States and other countries. Specifications are subject to change without notice. Apple, iPhone, iPad, iPod, iPod touch and Retina are trademarks of Apple Inc., registered in the U.S. and other countries. iPad Air, iPad mini and Lightning are trademarks of Apple Inc. Other Trademarks and trade names are the property of their respective owners.

## INSTALLATION INSTRUCTIONS

**WARNING** - TO REDUCE THE RISK OF ELECTRIC SHOCK, DO NOT REMOVE THE BACK COVER OR TAKE APART. THERE ARE NO SERVICEABLE PARTS INSIDE.

1. Before installing the Boost into an E26/E27/B22 light bulb socket, turn the light switch to the OFF position. (DO NOT USE WITH EXTERNAL OR OUTSIDE DIMMERS).
2. Screw the bulb into an E26/E27/B22 socket and turn the power on.
3. On the portable smart device (e.g. smartphone or tablet), make sure WLAN is turned on and has been connected to the wireless router with a proper passport.
4. Search for the “boost by Sengled” for corresponding operating system, download and install it on a portable smart device:  
Get App from Google Play Store for Android Devices;



5. Launch the boost by Sengled application, and a 'Welcome' page appears. At the beginning, press the "network" tab to initialize boost A01-A60 bulb's configuration. After that, click the "START" button to enter the configuration and control interface of the bulb/s.

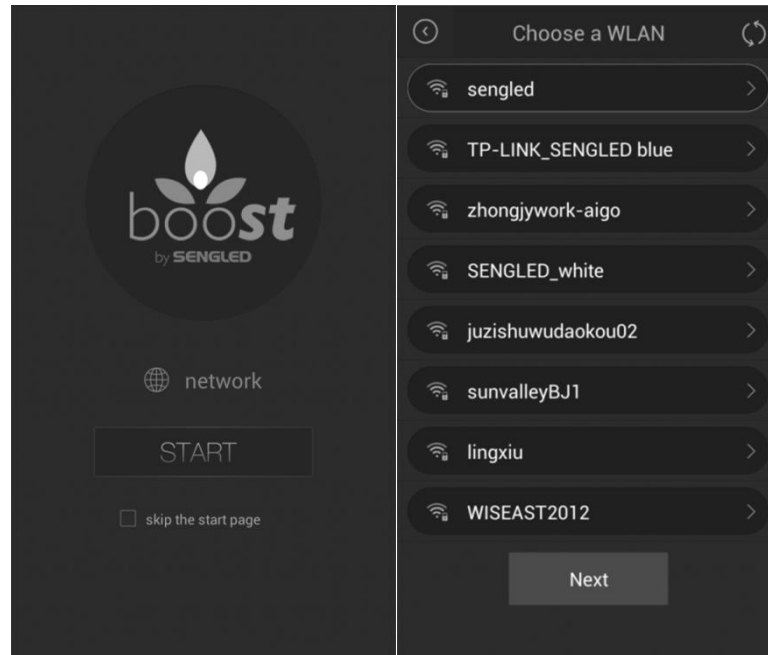

6. The App will search and list out nearby available wireless router/s automatically. Choose one of the routers as the root router. Type in the Access Password and press "Next" to move forward.

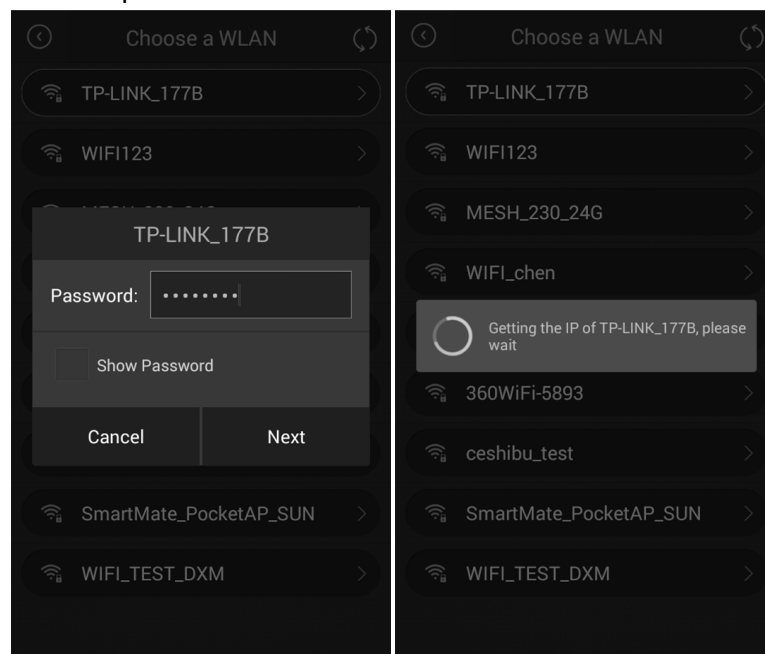

7. Input the access password which is as the router Wi-Fi router, click “Next” to enter the Next step. At this point, APP will send multicast to make the lamp of the Factory Settings is connected to the root router, and the program will search out these lamps. The names of these lamps apply their MAC address the name of the last two as a suffix, and display them on the interface for users to choose whether to access the network.

If there is no any equipment, please check if the lamp is powered on, and click the refresh button to try again.

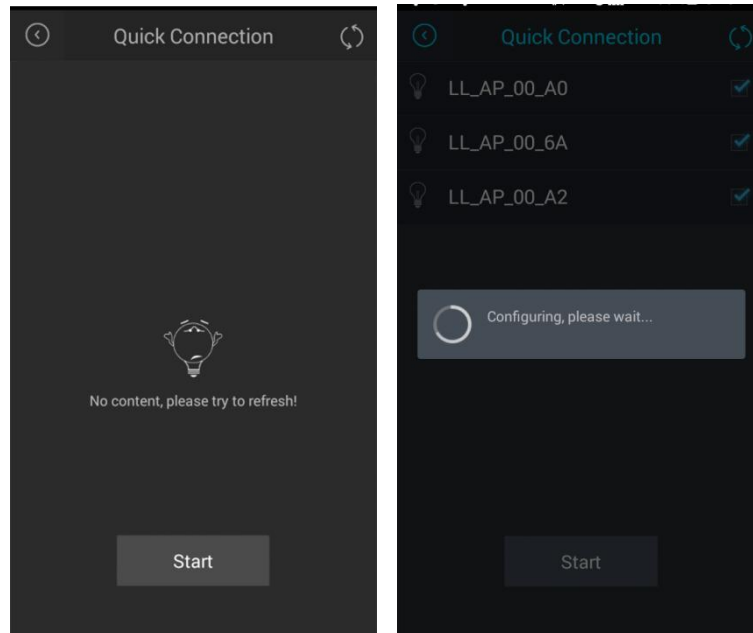

8. The App will also search and list out nearby available boost A01-A60 bulb/s. The default SSID of the bulb is “SENGLED\_AP”. (ATTENTION: Figure shows below, SSID Name of "LL\_AP\_00\_\*\*" only for engineering samples demo).

Press the “Start” tab for configuring all chosen boost A01-A60 bulbs. And the lamps which are not chosen restore to the initial state of factory Settings. If the root router is encrypted, the initialized bulb is also encrypted with a default password of "12345678". Input the bulb password and wait for the configuration process complete.

9. After the process of bulb network configuration has been succeeded, boost A01-A60 bulb/s will reboot (THIS PROCESS MAY TAKE FEW MINUTES, PLEASE BE PATIENCE). Press “Done” and return to the home page. If the configuration failed, refresh the configuration to networking again.

10. The App begins to search the configured online LED bulb/s. (SINCE THE BULB REBOOT PROCESS MAY TAKES FEW MINUTES, PLEASE BE PATIENCE AND REFRESH THE LIST FROM TIME TO TIME). After searching out all configured

bulbs, the interface shows a Main Control Page. This can be used to control the overall LED light dimming and ON/OFF.

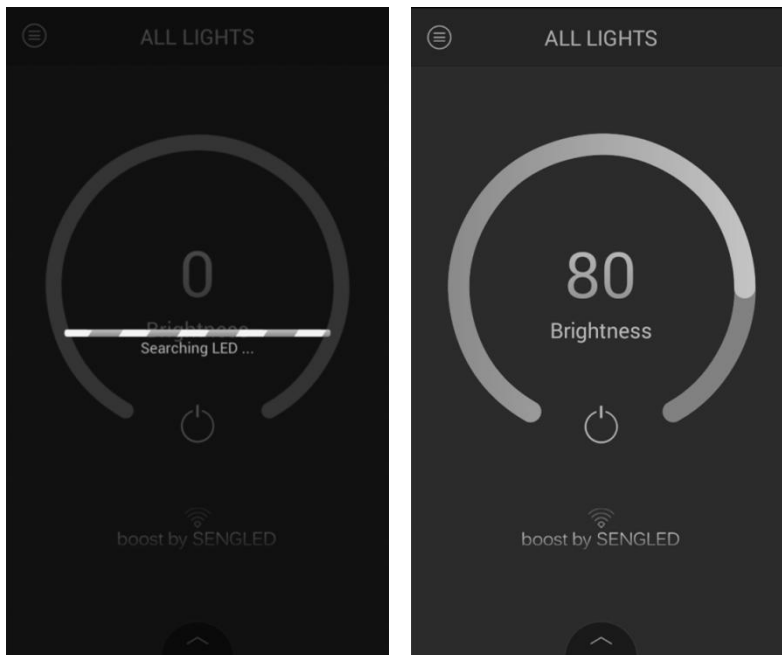

11. To control the LED bulb individually, pull up the bulb list at the bottom, each bulb can be dimmed separately. Click the arrow on the right, and it goes to the bulb wireless network configuration page.
- Main page shows that adjust total brightness. The list displays the brightness of each lamp. The actual brightness is the brightness of each lamp multiplied by the percentage of the total brightness.

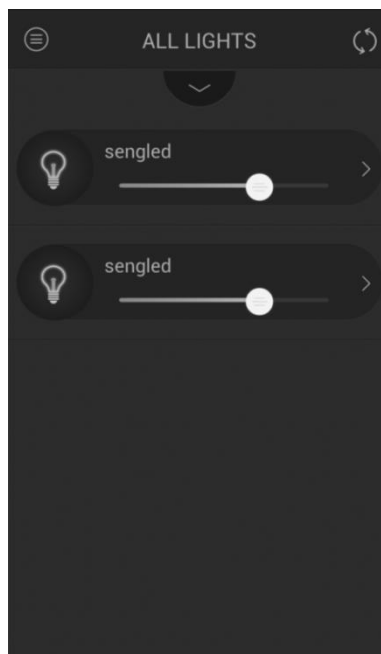

12. Lamp configuration page is read-only mode by default as shown in the

following figure. If need editing the lamp information, click the edit button at top right corner, and enter the lamp password to edit mode.

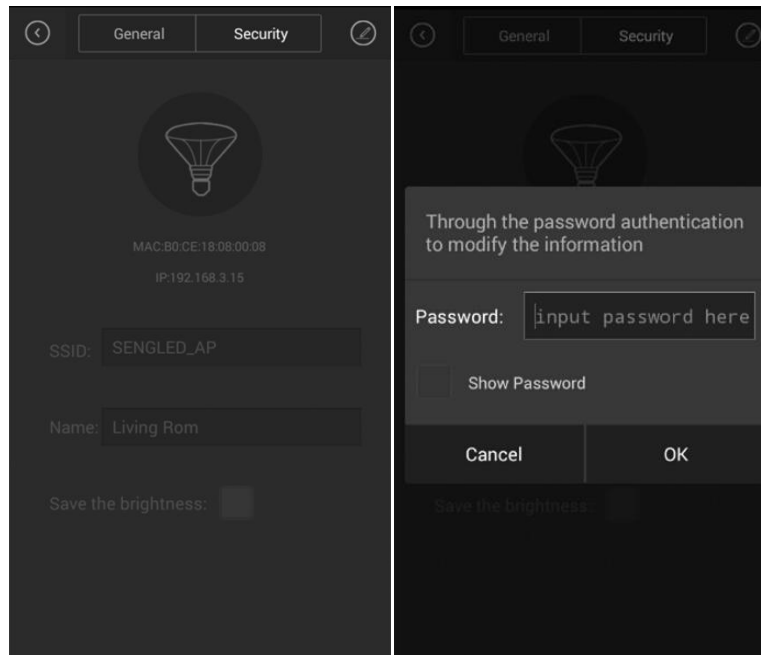

Enter the edit mode, basic setup can modify the SSID, the Name of the light, and set the brightness which the lamp is in power memory last time, so as to recover after the next to electricity save.

Security Settings change the lamp encrypted and password. Security Settings page has a button "Removed from the network" which is used to light restore to factory Settings and removed from the network. Users can use this button to restore the default lights to networking again.

Under the 'General' tab, the wireless network parameters of the bulb are listed (such as MAC address). User can change bulb's SSID (listed on the WLAN table, visible name to public), or Name (listed on the boost by Sengled App) to a more meaningful name, such as "Living Room AP" or "Living Room Wi-Fi". Press "Apply" to active such changes.

Under the 'Security' tab, user can change the Encryption Mode, or change the bulb access Password. Press "Apply" to active such changes.

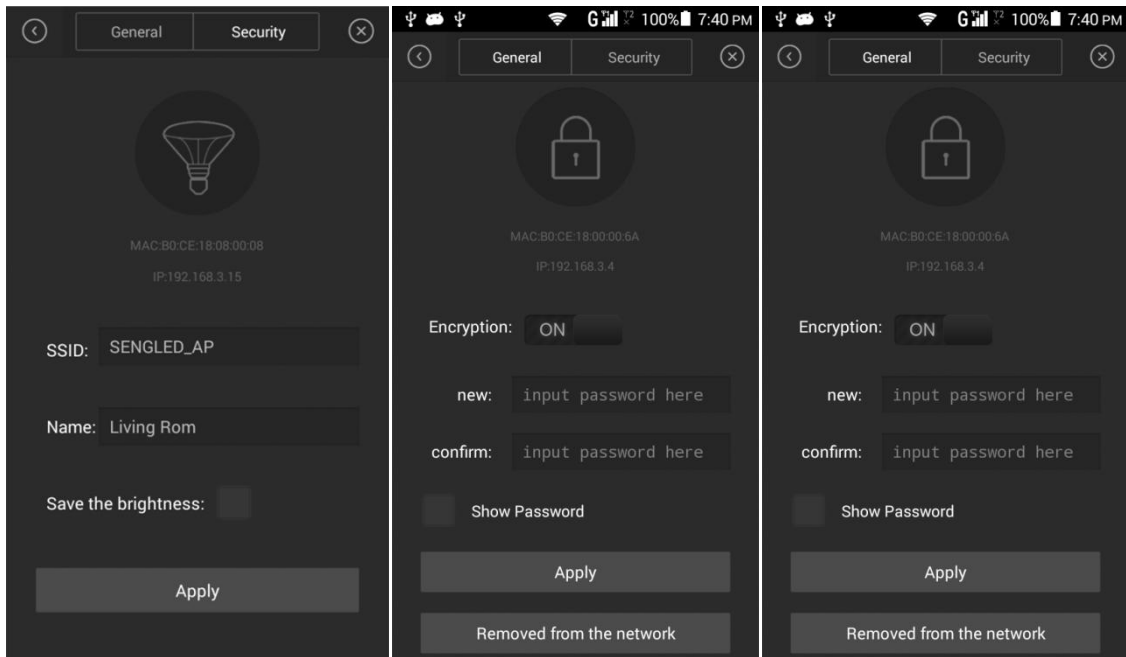

13. If re-configuration of the wireless network is needed, press the Setting Menu button on the Main Control Page and click the "Network" tab. Re-initialize all bulbs on the network and start setup wizard again.

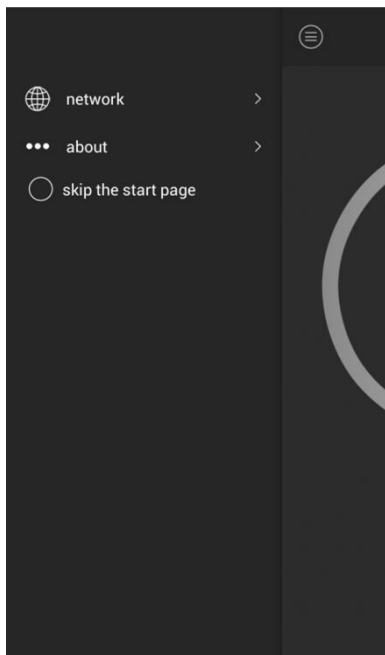

14. If the bulb cannot be detected by the portable smart devices or App in any ways, user can press the physical RESET button to reset the configuration of the bulb (in the middle of the LED lens), as shown below.

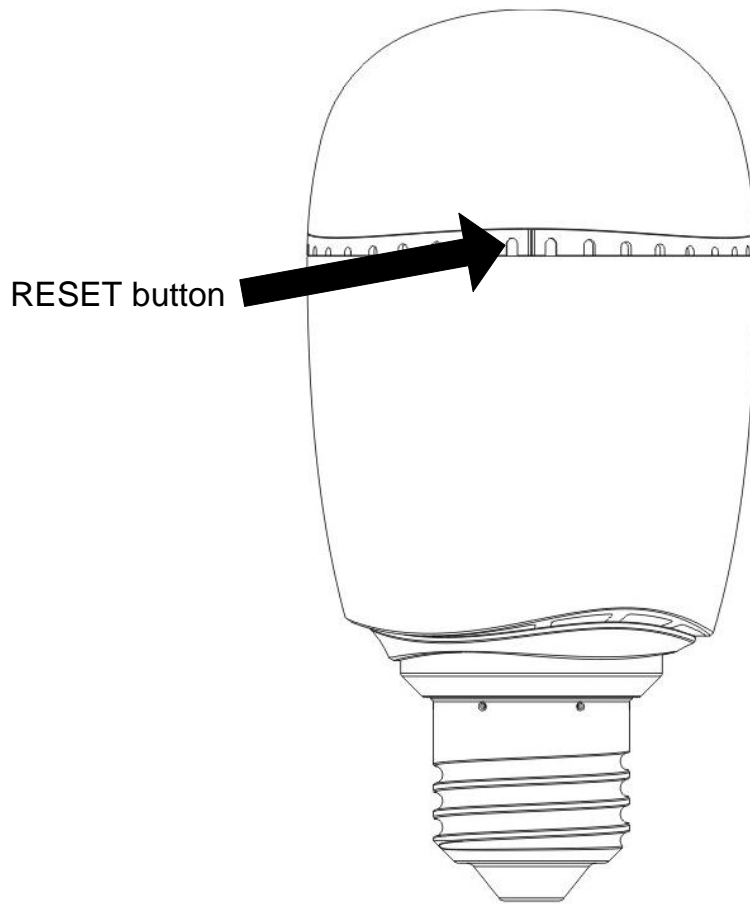

## IMPORTANT SAFETY INSTRUCTIONS



- Read and keep these safety instructions.
- Heed all warnings contained within these instructions.
- Please follow all user manual instructions when installing the product.
- Clean SENGLED product only with a dry towel.
- This Product is intended for indoor use only.
- Do NOT use this product outdoors.
- Do NOT get this product wet and do NOT use near any water source.
- The product should not be exposed to dripping or splashing liquids of any kind.
- Do not install the product near any heat sources, such as heater, radiators, stove, heat registers or other apparatus that produce heat.
- Ensure that the product is stable and secured in place during installation. If the product is dropped or falls out of the light socket, it may cause bodily harm.
- If the product is dropped or falls out of the light socket, it may be damaged. Please check the product for any visible damage.
- To reduce the risk of electric shock, do NOT remove the back cover or take

apart. There are no serviceable parts inside.

- To prevent product failure, the bulb should only be installed in operating environments.
- Do not block any ventilation openings on the product.
- Never push any objects into the openings or slots on the product. Doing so may create an electric shock or fire hazard.
- Maintain sufficient distance around your product for sufficient ventilation, do not put anything within at least 6 inches of lightbulb socket.
- For best protection against lightning, unplug the product from its power source during a storm.
- Only use accessories specifically recommended by the manufacturer.
- Refer all servicing to qualified SENGLED service technician.
- Servicing is required when the product:
  - 1) has been damaged in any way;
  - 2) liquid has been spilled on the product;
  - 3) objects have fallen into the product;
  - 4) the product has been exposed to rain or moisture,
  - 5) the product does not operate normally, or has been dropped.
- Repairs must be performed by a qualified SENGLED technician.
- For bulb with a weight significantly higher than that of the bulbs for which they are a replacement, the increased weight may reduce the mechanical stability of certain luminaires and bulb holders and may impair contact making and bulb retention. Check that all sockets and bulb holders frequently and make sure they are secure and stable.
- The bulb can be hot and should not be touched without taking care.

CAUTION: INDOOR OPERATIONS ARE ONLY ALLOWED

NOT FOR USE IN EMERGENCY LIGHTING.

BE SUITABLE FOR DAMP LOCATIONS.

ENSURE FIXTURE CAN SUPPORT ADDED WEIGHT OF BULB.

ATTENTION: L'UTILISATION EST AUTORISÉE UNIQUEMENT EN INTÉRIEUR.

NE PAS UTILISER COMME ÉCLAIRAGE D'URGENCE.

RISQUE DE CHOC ÉLECTRIQUE – UTILISER UNIQUEMENT DANS UN ENDROIT SEC.

S'ASSURER QUE LE LUMINAIRE EST APTE À SUPPORTER LE SUPPLÉMENT DE POIDS DE L'AMPOULE.

## Warranty Information

### Warranty statement

For this product, the manufacturer grants a warranty of 2 years for workmanship and material.

Warranty repairs may be performed exclusively by an authorised customer service.

The original sales receipt has to be enclosed as proof.

Excluded from this warranty are: normal wear and tear, alterations, rework, damage as a result of carelessness, outside influence, areas of application for which the product is not intended, or products that have been dismantled completely or partially.

### Correct disposal of this product



In the EU, this symbol points out that this product must not be disposed of with domestic waste. Old appliances contain valuable recyclable materials which should be recycled in order not to cause damage to the environment and/or human health through unregulated waste disposal. For that reason, please dispose of old appliances through suitable collection systems or send the appliance to the place where you purchased it for disposal. They will then recycle the materials contained in the appliance.

## Déclaration de garantie

Le fabricant délivre une garantie de 2 ans sur ce produit en cas de vice de fabrication et de matériel.

Les réparations couvertes par la garantie doivent être effectuées exclusivement par un service clientèle autorisé. L'original du justificatif d'achat doit être fourni en tant que preuve d'achat.

Sont exclus de la garantie : l'usure normale, les modifications, les manipulations, les dommages dus à une négligence, une incidence extérieure, les domaines d'application pour lesquels le produit n'est pas conçu ou les produits complètement ou partiellement démontés.

### Élimination correcte de ce produit



Au sein de l'UE, ce symbole indique que le produit ne doit pas être éliminé dans les ordures ménagères. Les appareils usagés contiennent des matériaux précieux pouvant être recyclés et qui doivent être réintégrés dans un processus de recyclage afin de ne causer aucun dommage à l'environnement ou à la santé humaine dû à une élimination non contrôlée. Veuillez donc éliminer les anciens appareils en passant par des systèmes appropriés ou envoyer l'appareil à éliminer au magasin où il a été acheté. Celui-ci fera le nécessaire pour intégrer l'appareil dans un processus de recyclage.

## **FCC STATEMENT FOR USERS**

This device complies with part 15 of the FCC Rules. Operation is subject to the following two conditions:

- (1) This device may not cause harmful interference, and
- (2) this device must accept any interference received, including interference that may cause undesired operation.

## **SECTION 15.21**

The user's manual or instruction manual for an intentional or unintentional radiator shall caution the user that changes or modifications not expressly approved by the party responsible for compliance could void the user's authority to operate the equipment. In cases where the manual is provided only in a form other than paper, such as on a computer disk or over the Internet, the information required by this section may be included in the manual in that alternative form, provided the user can reasonably be expected to have the capability to access information in that form.

## **FEDERAL COMMUNICATION COMMISSION INTERFERENCE STATEMENT, SECTION 15.105(b)**

This equipment has been tested and found to comply with the limits for a class B digital device, pursuant to part 15 of the FCC Rules. These limits are designed to provide reasonable protection against harmful interference in a residential installation. This equipment generate, uses and can radiate radio frequency energy and, if not installed and used in accordance with the instructions, may cause harmful interference to radio communications. However, there is no guarantee that interference will not occur in a particular installation. If this equipment does cause harmful interference to radio or television reception, which can be determined by turning the equipment off and on, the user is encouraged to try to correct the interference by one or more of the following measures:

- Reorient or relocate the receiving antenna.
- Increase the separation between the equipment and receiver.
- Connect the equipment into an outlet on a circuit different from that to which the receiver is connected.
- Consult the dealer or an experienced radio/TV technician for help.

## **RF RADIATION EXPOSURE WARNING**

This equipment must be installed and operated in accordance with provided instructions and the antenna(s) used for this transmitter must be installed to provide a separation distance of at least 20 cm from all persons and must not be

co-located or operated in conjunction with any other antenna or transmitter. End-users and installers must be provided with antenna installation instructions and transmitter operating conditions to satisfy RF exposure compliance.

## IC Radiation Exposure Statement for Canada

This device complies with Industry Canada licence-exempt RSS standard(s). Operation is subject to the following two conditions: (1) this device may not cause interference, and (2) this device must accept any interference, including interference that may cause undesired operation of the device.

Le présent appareil est conforme aux CNR d'Industrie Canada applicables aux appareils radio exempts de licence. L'exploitation est autorisée aux deux conditions suivantes : (1) l'appareil ne doit pas produire de brouillage, et (2) l'utilisateur de l'appareil doit accepter tout brouillage radioélectrique subi, même si le brouillage est susceptible d'en compromettre le fonctionnement.

Under Industry Canada regulations, this radio transmitter may only operate using an antenna of a type and maximum (or lesser) gain approved for the transmitter by Industry Canada. To reduce potential radio interference to other users, the antenna type and its gain should be so chosen that the equivalent isotropically radiated power (e.i.r.p.) is not more than that necessary for successful communication.

Conformément à la réglementation d'Industrie Canada, le présent émetteur radio peut fonctionner avec une antenne d'un type et d'un gain maximal (ou inférieur) approuvé pour l'émetteur par Industrie Canada. Dans le but de réduire les risques de brouillage radioélectrique à l'intention des autres utilisateurs, il faut choisir le type d'antenne et son gain de sorte que la puissance isotrope rayonnée équivalente (p.i.r.e.) ne dépasse pas l'intensité nécessaire à l'établissement d'une communication satisfaisante.

User manuals for transmitters equipped with detachable antennas shall also contain the following notice in a conspicuous location:

This radio transmitter (identify the device by certification number, or model number if

Category II) has been approved by Industry Canada to operate with the antenna types listed below with the maximum permissible gain and required antenna impedance for each antenna type indicated. Antenna types not included in this list, having a gain greater than the maximum gain indicated for that type, are strictly prohibited for use with this device.

Le présent émetteur radio (identifier le dispositif par son numéro de certification ou son numéro de modèle s'il fait partie du matériel de catégorie I) a été approuvé par Industrie Canada pour fonctionner avec les types d'antenne énumérés ci-dessous et ayant un gain admissible maximal et l'impédance requise pour chaque type d'antenne. Les types d'antenne non inclus dans cette liste, ou dont le gain est supérieur au gain maximal indiqué, sont strictement interdits pour l'exploitation de l'émetteur.

**IMPORTANT NOTE:**

Radiation Exposure Statement:

This equipment complies with "Industry Canada RSS-102 for radiation exposure limits set forth for an uncontrolled environment".

This equipment should be installed and operated with minimum distance 20cm between the radiator and your body.