

- Product Warranty -

Product Title	Voice Caddie T7
Serial No	
Date of Purchase	
Supplier	
Name	
Phone	
Warranty Period	1 year from purchase (6 months for battery and other components)

Battery Duration

- Average Duration (Watch): about 9 – 10 days
- Golf Mode: 27 Holes



Responsible Party – U.S Contact Information
Street Address : 13951 Valley View Ave
City, State : La Mirada, CA Postal Code : 90638
Country : United States
Telephone Number : 562-926-3978
Internet Contact Information : swoo@voicecaddie.com

T7

Quick Guide Book

Detailed instructions of this product are available from VOICE CADDIE website.

www.voicecaddie.com





V.AI™?

Indicate automatically the function who need at each place on the course.

※A.I. service made by VOICE CADDIE

Ex) Teeing ground: play 'Course Preview' automatically to check a course before a shot
Second or Third shot: Indicate 'Green Attack Info.' automatically for attacking green
On green or Around green: Indicate 'Green Undulation' automatically

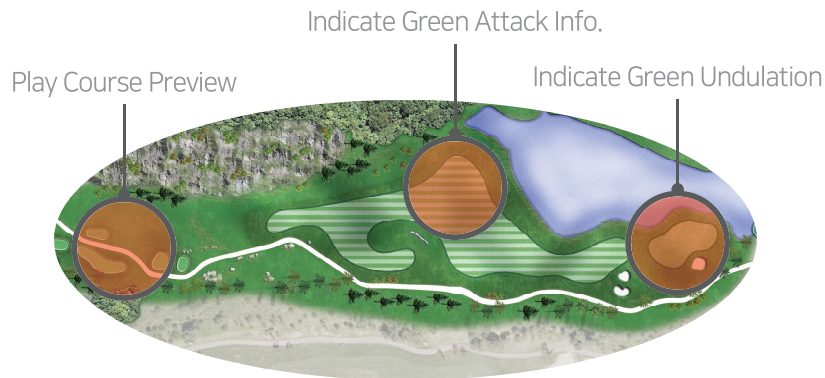

※Disconnect V.AI

Go to menu > Option > Golf option > V.AI > OFF

Time/Date Settings

Automatic Setting (Outdoor Only)

Golf mode or Fitness mode touch from menu



▶ Select Golf mode to automatically set time based on GPS signals



▶ After selecting Fitness mode



Select Walking, Running or Cycling to automatically set time based on GPS signals

Time Settings

Manual Setting (Indoor/Outdoor)

From menu, touch  > Touch 'Time'



- ① Touch 'Current time' from screen



- ② Set Current time
 - Set by sliding upward or downward
 - Touch 'v' below to set

Date Settings

Manual Setting(Indoor/Outdoor)

From menu, touch  > Touch 'Date'



- ① Touch 'Date' from screen



- ② Set Date
 - Set by sliding upward or downward
 - Touch 'v' below to set

Major Button Functions

Power ON/OFF:
press and hold power button
Backlight ON: Short-press power button

► FULL TOUCH Screen



Power (ON/OFF)
Backlight ON

How to enter Golf mode

Touch 'Golf mode' icon to automatically recognize holes based on GPS signals

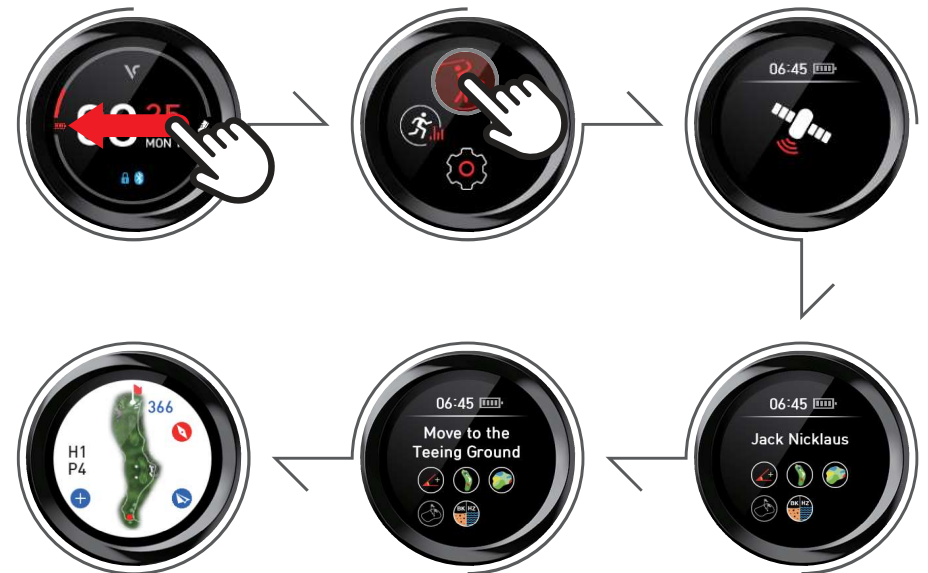

Pedometer View / Change Watch Face

Pedometer View



- Enter Pedometer View by sliding to right from watch screen
- Touch icon to view weekly statistics



Steps



Distance



Calories

Watch Face Settings



- press and hold from watch screen to change watch face
- Toggle watch face by sliding to left or right
- Toggle colors using upper tab(TBD)
- Touch 'V' below to set

'Course View, Green View, Yardage View' Screen

From 'Course View',
slide to left (←) to enter 'Green View'
slide to right (→) to enter 'Yardage View'



Course View



Green View



Yardage View

'Course View, Green View' images may vary depending on region and circumstances of each golf course.

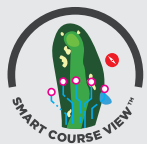

Course Preview

- Touch 'Course Preview'  from teeing ground to play 'Course Preview'

Return to 'Golf mode' after play
Return to golf mode immediately
if touch screen during playback

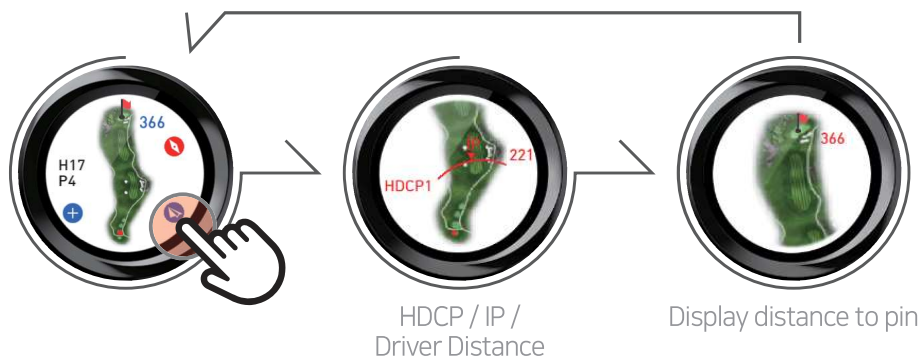

Pin Pointing

- Display pin direction and remaining distance of selected hole from golfers position
- 'Touch Pin Pointing'  icon to display a pop-up

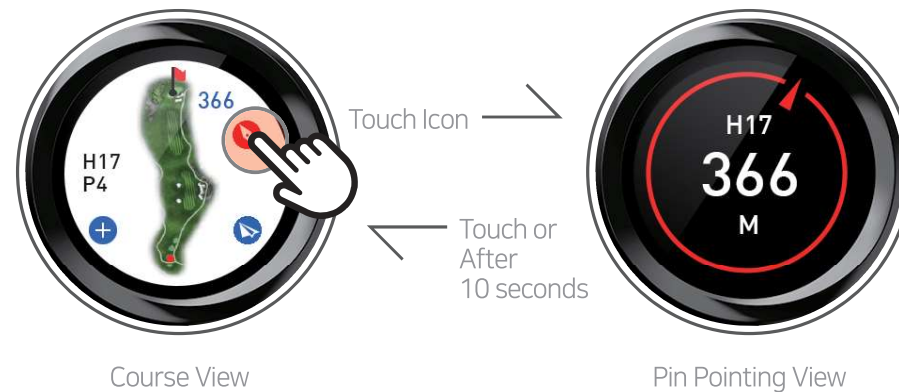

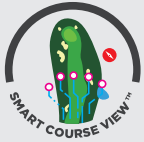

B/H Zone (Bunker / Hazard)

Display distance to front and back of bunker / hazard

Touch bunker or hazard

* Zoom in to more easily select

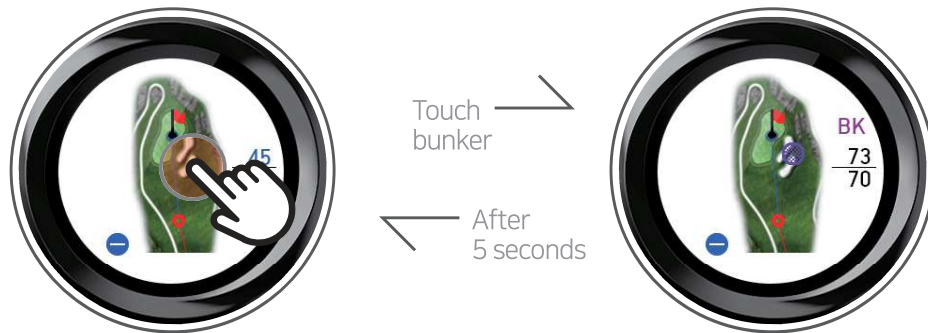

Real Green Undulation / Green Zoom

Real Green Undulation

- Applied actual green undulation data with Shades

Green Zoom

- Zoom in: Touch **+** icon
- Zoom out: Touch **-** icon

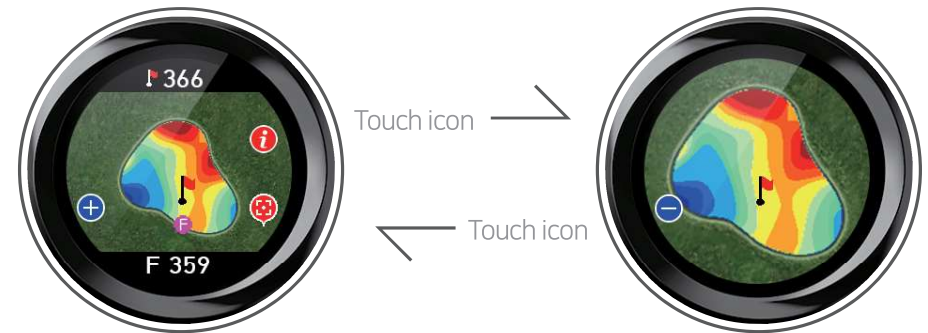

Real Green Undulation

Green Zoom



Green Attack Info.

- Touch 'Green Attack Info.'  icon to view green strategy pop-up
- Indicate distance to safe zone at the back of green and horizontal/vertical lengths of green

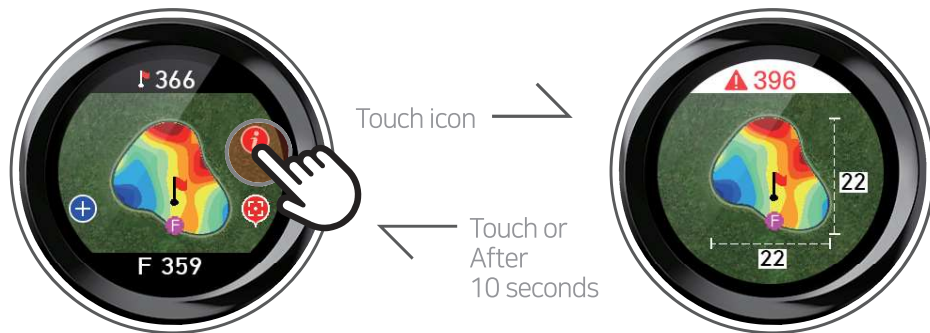

Active Green

- Automatically sets green's shape depending on player's position

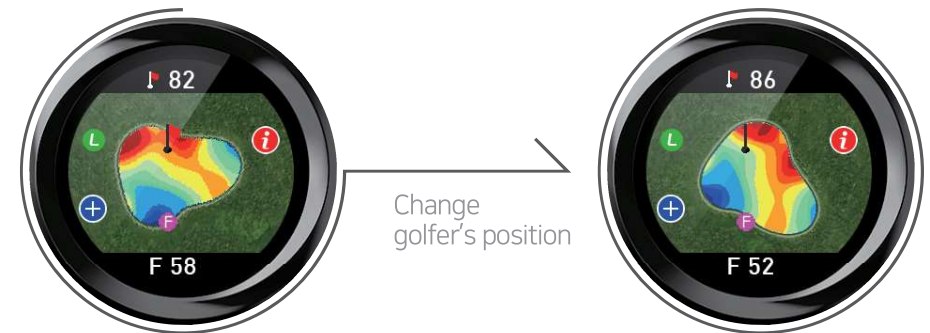

How to Connect to Application

RESET

▶ Activate Bluetooth



① Slide downward from watch screen



② Touch 'Connect' to activate Bluetooth



③ Check authentication number of T7

[App Functions] Quick GPS / Download Latest Golf tracking Data and FW / View and Share Score Statistics / Manage Round Trekking and History Display calls, texts and social media notifications

Search and install 'My Voice Caddie' on  Play Store /  Appstore.



Press and Hold the Power button for 10 seconds will reset and restart.

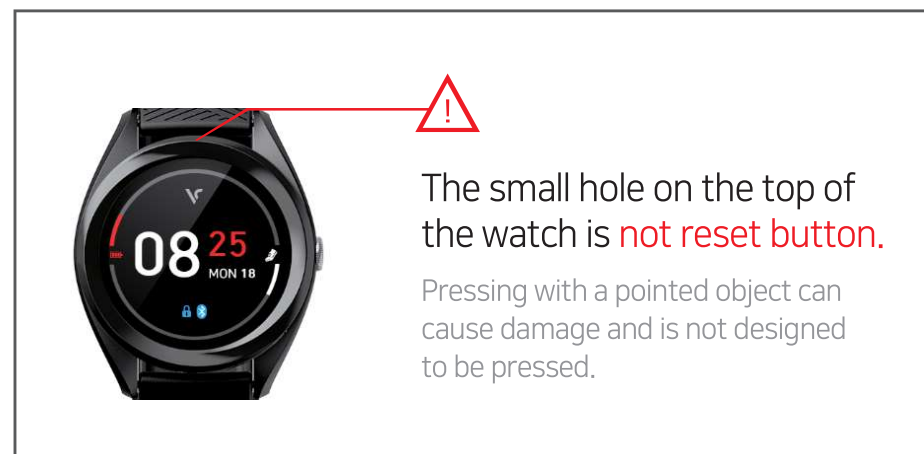

Cautions for Use

- The time to locate the satellite in the golf mode may vary depending on reception environment (climate and topography).
- The battery may deplete faster in regions with poor satellite reception and cold weather. To maximize battery use, it is advised to switch on the device outdoors.
- Storing the device in a hot place such as inside your car in summer and a humid place such as golf bag may cause device failure.
- Taking a shower or entering the bathroom with wearing a watch can cause defective.

Caution

This equipment has been tested and found to comply with The limits for a Class B digital device, pursuant to part 15 of the FCC Rules.

These limits are designed to provide reasonable protection against harmful interference in a residential installation. This equipment generates, uses and can radiate radio frequency energy and, if not installed and used in accordance with the instructions, may cause harmful interference to radio communications. However, there is no guarantee that interference will not occur in a particular installation. If this equipment does cause harmful interference to radio or television reception which can be determined by turning the equipment off and on, the user is encouraged to try to correct the interference by one or more of the following measures:

Caution

- Reorient or relocate the receiving antenna.
- Increase the separation between the equipment and receiver.
- Connect the equipment into an outlet on a circuit different from that to which the receiver is connected.
- Consult the dealer or an experienced radio / TV technician for help.
- This device complies with part 15 of the FCC Rules. Operation is subject to the following two conditions:
 - 1) This device may not cause harmful interference, and
 - 2) This device must accept any interference received, including interference that may cause undesired operation.
- Any changes or modifications not expressly approved by the party responsible for compliance could void the user's authority to operate this equipment.
- The device has been evaluated to meet general RF exposure requirement.
- The device can be used in portable exposure condition without restriction
- * Risk of explosion if battery is replaced by an incorrect type. Dispose of used batteries according to the instructions.

Product Warranty

1. This product has been manufactured under strict quality control and inspection, and consumers' lawful right to damage is compensated according to the consumer damage compensation regulation by the Ministry of Finance and Economy.
2. Free servicing is provided to failure occurring from normal conditions within warranty period.
3. Failures due to user negligence are charged for servicing even within the warranty period.
4. When inquiring for servicing and compensation for damage, please provide this warranty card and purchase receipt.