

► Components

- Main unit / Remote control / USB cable / User Guide
- Optional: Pouches, Bumper

► Setting

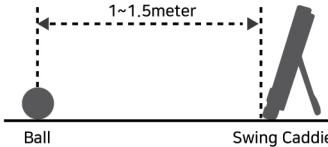

► Product Part Name



Remote Control

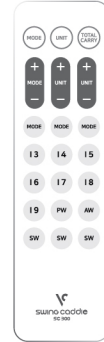

- MODE : Practice / Target
- UNIT
- TOTAL / CARRY
- VOLUME
- LOFT
- TARGET
- Club selection

► Basic practice mode

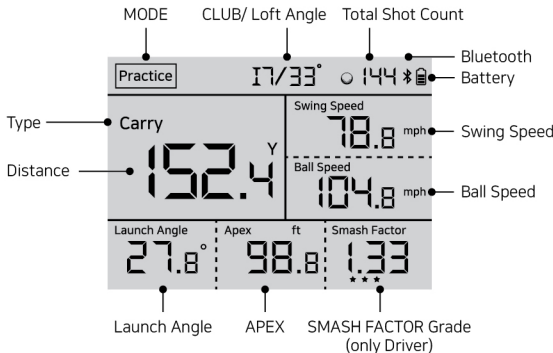

► Manual

Button	One Click	More than 2 seconds
Mode / Power	Mode Target (Practice ↔ Target)	Power (On / Off)
Club / Loft Angle	Club selection	Loft angle setting
+ / Distance	volume up	Distance Setting
- / Unit	volume down	Unit Setting

► Club selection

- Body : [C] Loft Angle Short press button
(DRIVER ► W3 ► W4 ► W5 ► W6 ► W7 ► U3 ► U4 ► U5 ► U6 ► U7 ► I3 ► I4 ► I5 ► I6 ► I7 ► I8 ► I9 ► PW ► AW ► GW ► SW ► LW)

► Basic practice mode

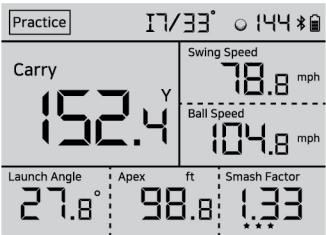

► Target distance practice mode

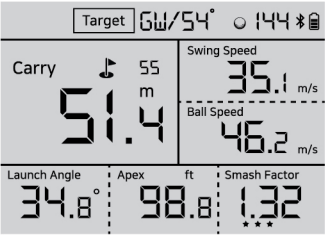

► Bluetooth connection method

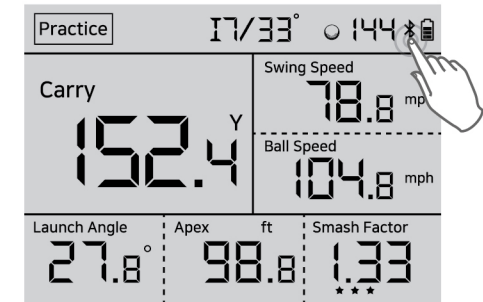

STEP 1

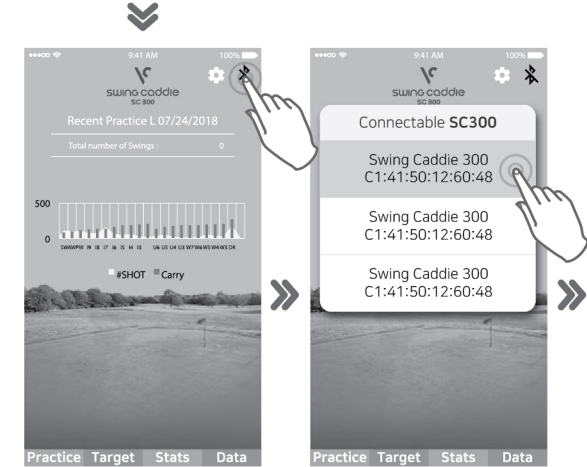

STEP 2

STEP 3

► Specifications Sensor

Sensor	Frequency	K band 24 GHz
	Sensor	Doppler radar sensor
Power	Battery	Rechargeable-Lithium 5000mAh
	Charging time	About 6 hours
	Usage time	About 12 hours
Spec	Size	164(W) X 118.2(H) X 29.5(T) mm
	Weight	About 435g(Include battery)
	Operating temperature	10℃ ~ 50℃
Range	Acceptance range	Mounted horizontally within 1.5 meters after the ball
	Recognition range	Ball Distance 15 ~ 350 M / Y



STEP 4

Caution

This device complies with Part 15 of the FCC Rules. Operation is subject to the following two conditions: (1) this device may not cause harmful interference, and (2) this device must accept any interference received, including interference that may cause undesired operation.

This equipment has been tested and found to comply with the limits for a Class B digital device, pursuant to part 15 of the FCC Rules.

These limits are designed to provide reasonable protection against harmful interference in a residential installation. This equipment generates, uses and can radiate radio frequency energy and, if not installed and used in accordance with the instructions, may cause harmful interference to radio communications. However, there is no guarantee that interference will not occur in a particular installation. If this equipment does cause harmful interference to radio or television reception, which can be determined by turning the equipment off and on, the user is encouraged to try to correct the interference by one or more of the following measures:

- Reorient or relocate the receiving antenna.
- Increase the separation between the equipment and receiver.
- Connect the equipment into an outlet on a circuit different from that to which the receiver is connected.
- Consult the dealer or an experienced radio/TV technician for help.

Any changes or modifications not expressly approved by the party responsible for compliance could void the user's authority to operate this equipment. This device must not be co-located or operating in conjunction with any other antenna or transmitter.

The antenna(s) must be installed such that a minimum separation distance of at least 20 cm is maintained between the radiator (antenna) and all persons at all times.

Warranty

One Year Limited Warranty

Voice Caddie warrants this hardware product against defects in materials and workmanship for a period of one year from the date of original retail purchase. If a defect exists, at its option Voice Caddie will (1) repair the product at no charge, (2) exchange the product with a product that is new or like-new and is at least functionally equivalent to the original product, or (3) refund the purchase price of the product. Voice Caddie shall have no obligation to repair, replace or refund until the customer returns the defective product to Voice Caddie. This warranty does not apply: (1) to damage caused by accident, abuse, misuse, misapplication, or non-Voice Caddie products; (2) to damage caused by service performed by anyone who is not a Voice Caddie Authorized Service Provider; or (3) to a product or part that has been modified without the written permission of Voice Caddie.

For more information on Voice Caddie's warranty and return policy, please visit www.voicecaddie.com

Product Name	Swing Caddie	Warranty Period	
Model Name	SC300	1 year after the date of purchase (Excludes battery and other components)	
Serial Number			
Purchase Date			
Purchaser's Address			
Full Name		Telephone	

► Customer Center

Toll free : +1-888-939-3978

Email : support@voicecaddie.com

Website : www.voicecaddie.com

"MAKE GOLF Practice FUN!"

SC 300



Carry / Total (Carry+Run)

Swing / Ball Speed

Launch Angle

Smash Factor

Apex

Spin (Only APP)

Distance Voice Output

Loft angle selectable

Supplier's Declaration of Conformity

Unique Identifier:

SWING CADDIE SC300

Responsible Party – U.S. Contact Information

Voice Caddie

Street Address : 13951 Valley View Ave.

City, State : La Mirada, CA

Postal Code : 90638

United States : United States

Telephone number or internet contact information : 562-926-3978 / swoo@voicecaddie.com

FCC Compliance Statement (for products subject to Part 15)

This device complies with Part 15 of the FCC Rules. Operation is subject to the following two conditions:

(1) This device may not cause harmful interference, and (2) this device must accept any interference received, including interference that may cause undesired operation.