

BPH : Quick Start Guide

LyveHome: (QSG) Quick Start Guide

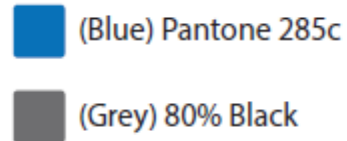

Paper Spec: Neenah Packaging Solutions™ (Or similar)
STARWHITE® Double Thick Cover Tiara Smooth
130DTC (352g/m) 17.1pt. ²

Type: Helvetica Neue

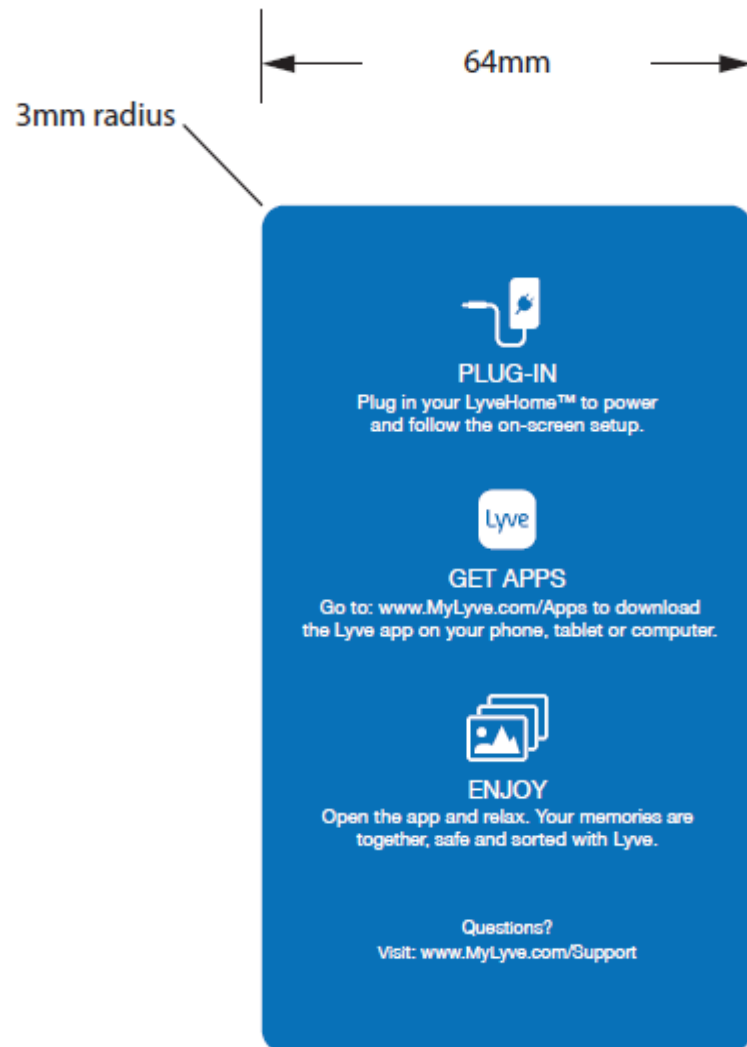

Front

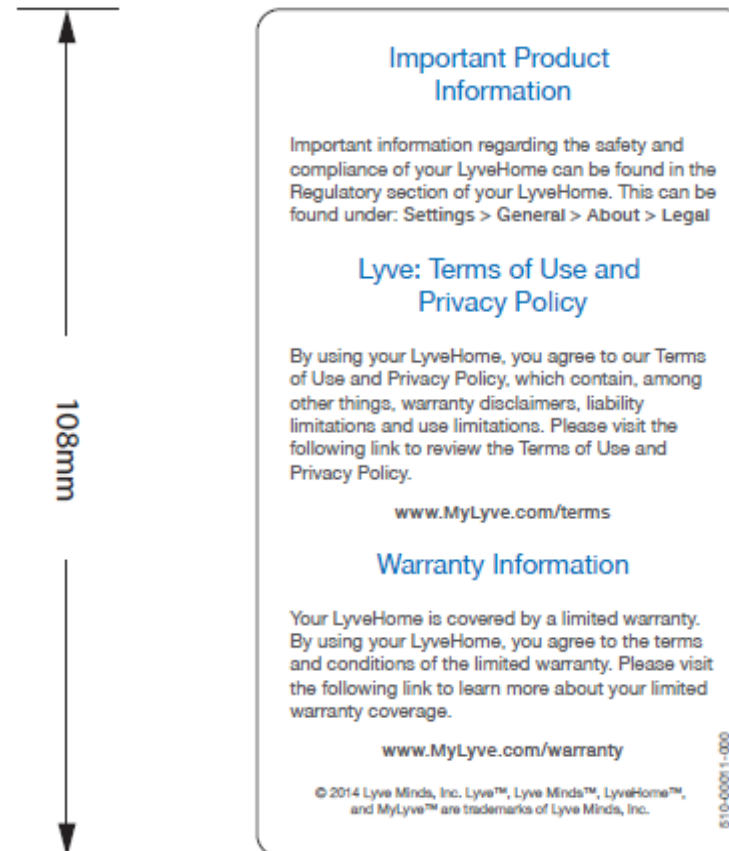

Rear

Setting up Wi-Fi

Setting up Wi-Fi

- From the Home screen, tap **Settings**.
- In **WIRELESS & NETWORKS**, tap **Wi-Fi** and set it to **ON**.
- Available networks are listed.
- Tap a network to connect to or tap **ADD NETWORK** to manually add a connection.

NOTE:

- Connecting to a secured network will prompt for a password.
- Enter the password, then tap **Connect**.



Using Bluetooth

Using Bluetooth

- From the Home screen, tap **Settings**.
- In **WIRELESS & NETWORKS**, tap **Bluetooth** and set it to **ON**.
- Available devices are listed. To search for a new device, tap **SEARCH FOR DEVICES**.
- Tap a detected device.
- To start pairing, enter the **PIN** then tap **OK**.

NOTE:

- The PIN of the device must be the same PIN on the other bluetooth device.
- On some devices, tap **Pair to start pairing**.
- The paired bluetooth device name is Displayed.



FCC Regulations:

Warning Notice for BPH

- FCC Regulations:
- **§ 15.19 (a)(3)**
- This device complies with part 15 of the FCC Rules. Operation is subject to the following two conditions: (1) This device may not cause harmful interference, and (2) this device must accept any interference received, including interference that may cause undesired operation.
- **§ 15.21**
- Changes or modifications not expressly approved by the party responsible for compliance could void the user's authority to operate the equipment.
- **§ 15.105 (b)**
- This equipment has been tested and found to comply with the limits for a Class B digital device, pursuant to part 15 of the FCC Rules. These limits are designed to provide reasonable protection against harmful interference in a residential installation. This equipment generates, uses and can radiate radio frequency energy and, if not installed and used in accordance with the instructions, may cause harmful interference to radio communications. However, there is no guarantee that interference will not occur in a particular installation. If this equipment does cause harmful interference to radio or television reception, which can be determined by turning the equipment off and on, the user is encouraged to try to correct the interference by one or more of the following measures:
 - —Reorient or relocate the receiving antenna.
 - —Increase the separation between the equipment and receiver.
 - —Connect the equipment into an outlet on a circuit different from that to which the receiver is connected.
 - —Consult the dealer or an experienced radio/TV technician for help.
- **§ 15.407 (e)**
- Operation on the 5.15-5.25 GHz frequency band is restricted to indoor use only. The FCC requires indoor use for the 5.15-5.25 GHz band to reduce the potential for harmful interference to co-channel Mobile Satellite Systems.
-
- **FCC RF Exposure Compliance**
- This equipment complies with radio frequency (RF) exposure limits adopted by the Federal Communications Commission for an uncontrolled environment. This equipment should be installed and operated with minimum distance 20 cm between the radiator & your body.