

FRONT

SHARPER IMAGE™

Three-Piece Turntable System



User Guide

T2A

In the box



Three-Piece Turntable System

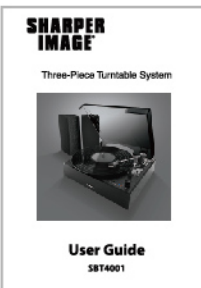

User Guide



Connecting the Speakers

1. Connect the first speaker to the RCA right speaker output, also located on the back of the turntable.
2. Connect the other speaker to the RCA left speaker output, also located on the back of the turntable.
3. Connect the small end of the AC Adapter into the Adaptor port.
4. Plug the AC Adaptor into a wall outlet.
5. Turn the [○] button to the ON position.

Location of Controls

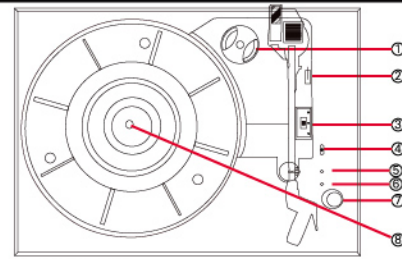

1. 45 RPM
2. Cueing Lever
3. Speed / Record RPM selector switch
4. Bluetooth/ Turntable switch
5. LED Bluetooth indicator light
6. LED power indicator light
7. [○]: Power ON/OFF button / volume knob
8. Spindle

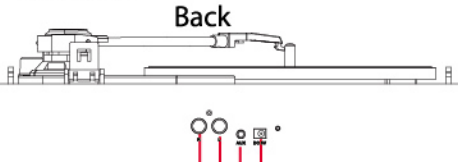

8. RCA right speaker output
9. RCA left speaker output
10. 3.5mm Auxiliary port
11. AC adaptor port

Pairing the Speaker

On a Blackberry
• Go to SETTINGS/OPTIONS > BLUETOOTH
• Enable BLUETOOTH

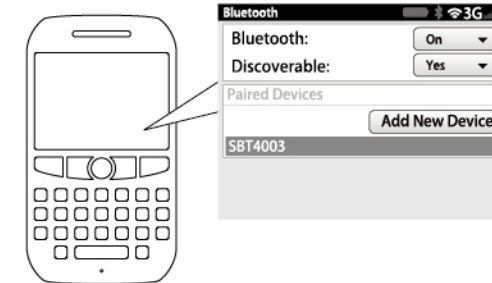

On an Android Phone
• Go to SETTINGS > BLUETOOTH > MENU
Search for devices (Make sure Bluetooth is turned ON)

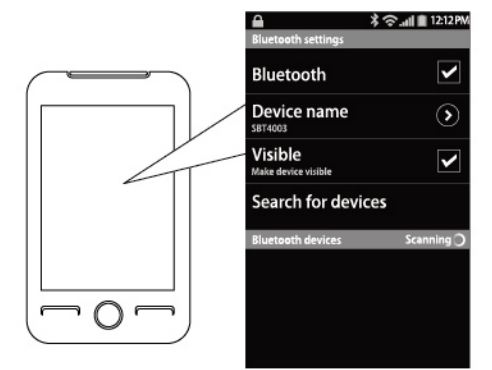

On other Cell Phones/Devices
• Review the instruction manual that came with your phone/device.

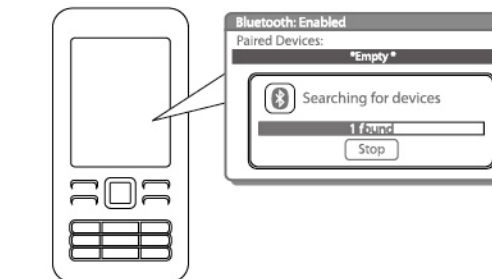

5. When your mobile device has completed scanning, select **SBT4003** from the list of discovered devices.
6. If required, type the password 0000 (four zeros). Select OK or YES on your mobile device to pair your device to the Three-Piece Turntable System.
7. After a successful registration, a tone will be heard and the LED Bluetooth indicator light will remain **BLUE**.

NOTE: If you would like to connect the turntable to another device, you must unpair it from the currently paired device first. In your mobile device's Bluetooth settings, select "SBT4003," then select "unpair." When the turntable has been unpaired, it will automatically go into pairing mode.

The screenshots above are typical of many Bluetooth-enabled devices in the market today, and are used to assist in the explanation of the pairing process. Your Bluetooth-enabled device's interface and interaction with the speaker may slightly differ from the illustrations above.

On an iPhone
• Go to SETTINGS > BLUETOOTH
(Make sure Bluetooth is turned ON)

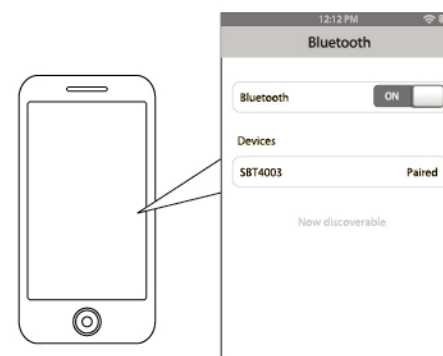

BACK

Using the Turntable with a paired Bluetooth device

- Turn the [○] button to the right to turn the unit ON. Turn it all the way to the left to turn the unit OFF.
- Move the [BT] Bluetooth/Turntable switch to the ON position. If you have already paired your Bluetooth-enabled device to the turntable, it will automatically connect. A tone will be heard and the LED Bluetooth indicator light will remain **BLUE**.
- If you are using the turntable for the first time, go to the "Pairing the Turntable to a Bluetooth-enabled device" section of this user manual and pair the turntable to your desired Bluetooth device.
- Open your mobile device's media player and select a song from your music playlist.

Use your media player's playback controls to play, pause and skip music tracks. Volume can be controlled by your mobile device and the turntable's

Adjusting the volume

- Turn the [○] button/Volume Knob to the left (MIN) to decrease the volume.
- Turn the [○] button/Volume Knob to the right (MAX) to increase the volume.

Playing vinyl records

- Turn the [○] button/Volume Knob to the right to turn the turntable ON.
- If your turntable is in Bluetooth mode, slide the [BT] Bluetooth/Turntable switch to the OFF position.
- Place a record on the turntable.
- Use the Cueing Lever to raise the needle.
- Place the needle over the record.
- Use the Cueing Lever to lower the needle onto the record.

The 45 RPM Adaptor is used to play smaller 7 inch (45 RPM) records on larger turntables. Place the adaptor on the turntable's spindle first then place the 45 RPM record on the turntable.

NOTE: To select another record, use the Cueing Lever to raise the needle and place it in the standby position. When the turntable stops moving, remove the record and place another one on the turntable.

Troubleshooting Tips

I can pair the Three-Piece Turntable System with my Bluetooth device, but I cannot hear any music.

1. Make sure your Bluetooth device supports A2DP profile.
2. Turn up the volume on your Bluetooth device.
3. You may have to unpair the speaker, then re-pair to your device.

My Bluetooth device is not able to pair with the Three-Piece Turntable System.

1. Turn the [○] button/Volume Knob to the right to turn the unit ON.
2. Slide the [BT] Bluetooth/Turntable switch to the ON position. A tone will be heard and the LED Bluetooth indicator light will flash **BLUE**.

Troubleshooting Tips (cont'd)

3. Make sure that your mobile device's Bluetooth function is turned ON. Open your device's Bluetooth settings and scan for other Bluetooth devices.
4. Keep the turntable and your Bluetooth-enabled device within 3 feet of each other

I cannot get the speaker into pairing mode.

1. Make sure the speaker is turned ON before beginning the pairing process.
2. Make sure that your device's Bluetooth feature is powered ON and ready to search for Bluetooth devices.
3. Make sure the speaker is fully charged.

Legal information

Caution: Any changes or modifications not expressly approved could void the user's authority to operate the equipment.
FCC Part 15: This device complies with Part 15 of the FCC Rules. Operation is subject to the following two conditions:
(1) This device may not cause harmful interference, and
(2) this device must accept any interference received, including interference that may cause undesired operation.

Note: This equipment has been tested and found to comply with the limits for a Class B digital device, pursuant to part 15 of the FCC Rules. These limits are designed to provide reasonable protection against harmful interference in a residential installation. This equipment generates, uses and can radiate radio frequency energy and, if not installed and used in accordance with the instructions, may cause harmful interference to radio communications. However, there is no guarantee that interference will not occur in a particular installation. If this equipment does cause harmful interference to radio or television reception, which can be determined by turning the equipment off and on, the user is encouraged to try to correct the interference by one or more of the following measures:

- Reorient or relocate the receiving antenna.
- Increase the separation between the equipment and receiver.
- Connect the equipment into an outlet on a circuit different from that to which the receiver is connected.
- Consult the dealer or an experienced radio/TV technician for help.

Limited Warranty

90 Days Limited Warranty
In the unlikely event that this product is defective, or does not perform properly, you may within ninety (90) days from your original date of purchase return it to the authorized service center for repair or exchange.

- TO OBTAIN WARRANTY SERVICE:**
- Call the Customer Support number located below, or go to our website portal to receive an SRQ number.
 - Provide proof of the date of purchase within the package (Dated bill of sale).
 - Prepay all shipping costs to the authorized service center, and remember to insure your return.
 - Include a return shipping address (no P.O. Boxes), a telephone contact number, and the defective unit within the package.
 - Describe the defect or reason you are returning the product.

Limited Warranty (cont'd)

Your product will be repaired or replaced, at our option, for the same or similar model of equal value if examination by the service center determines this product is defective. Products received damaged as a result of shipping will require you to file a claim with the carrier.

The shipping address of the authorized service center is:
Customer Service Dept. 36
c/o Southern Telecom
400 Kennedy Drive
Sayreville, NJ 08872

Should you have any questions or problems concerning this product, please contact our customer service department at:
Customer Support:
Phone: 1-877-768-8481
Monday-Friday 8AM-10PM(EST)

www.southern telecom.com
Click on "Product Support"

Warranty service not provided
This warranty does not cover damage resulting from accident, misuse, abuse, improper installation or operation, lack of reasonable care, and unauthorized modification. This warranty is voided in the event any unauthorized person opens, alters or repairs this product. All products being returned to the authorized service center for repair must be suitably packaged.

Limitation of Warranty:
• THE WARRANTY STATED ABOVE IS THE ONLY WARRANTY APPLICABLE TO THIS PRODUCT. ALL OTHER WARRANTIES, EXPRESS OR IMPLIED (INCLUDING ALL IMPLIED WARRANTIES OF MERCHANTABILITY OR FITNESS FOR A PARTICULAR PURPOSE) ARE HEREBY DISCLAIMED. NO VERBAL OR WRITTEN INFORMATION GIVEN BY AIT, INC. ITS AGENTS, OR EMPLOYEES SHALL CREATE A WARRANTY OR IN ANY WAY INCREASE THE SCOPE OF THIS WARRANTY.

• REPAIR OR REPLACEMENT AS PROVIDED UNDER THIS WARRANTY IS THE EXCLUSIVE REMEDY OF THE CONSUMER. AIT, INC. SHALL NOT BE LIABLE FOR INCIDENTAL OR CONSEQUENTIAL DAMAGES RESULTING FROM THE USE OF THIS PRODUCT OR ARISING OUT OF ANY BREACH OF ANY EXPRESS OR IMPLIED WARRANTY ON THIS PRODUCT. THIS DISCLAIMER OF WARRANTIES AND LIMITED WARRANTY ARE GOVERNED BY THE LAWS OF THE STATE OF NEW YORK. EXCEPT TO THE EXTENT PROHIBITED BY APPLICABLE LAW, ANY IMPLIED WARRANTY OF MERCHANTABILITY OR FITNESS FOR A PARTICULAR PURPOSE ON THIS PRODUCT IS LIMITED TO THE APPLICABLE WARRANTY PERIOD SET FORTH ABOVE.

Some states do not allow the exclusion nor limitation of incidental or consequential damages, or limitations on how long an implied warranty lasts so the above limitations on exclusions may not apply to you. This warranty gives you specific legal rights, and you also may have other rights that vary from state to state.



Sharper Image™ name and logo are registered trademarks. Manufactured and marketed by Southern Telecom under license. © Sharper Image. All Rights Reserved.

SHARPER IMAGE™