



PORTABLE TURNTABLE

{ FOR VINYL AND BLUETOOTH DEVICES }
T1S USER MANUAL

Questions? Need some help? This manual will help you enjoy your new product.

If you still have questions, call our help line: 1-877-768-8481

or visit us at: www.southerntelecom.com Click on "Product Support"

IN THE BOX

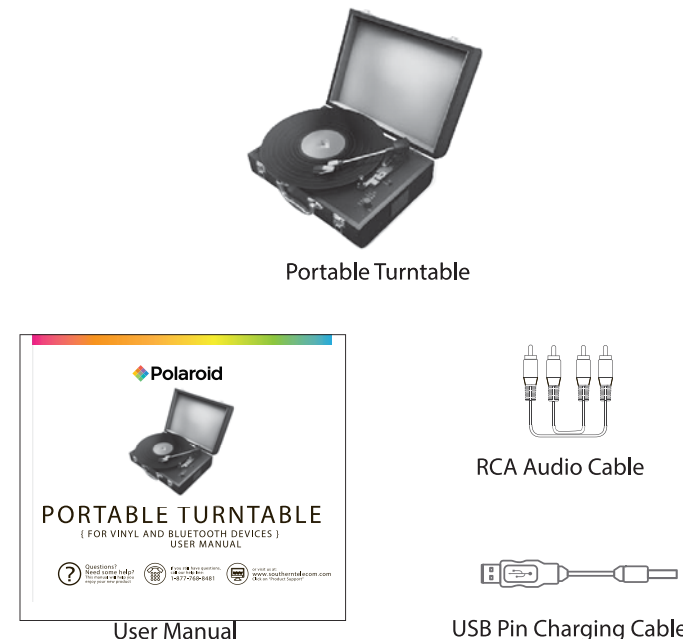

LOCATION OF CONTROLS

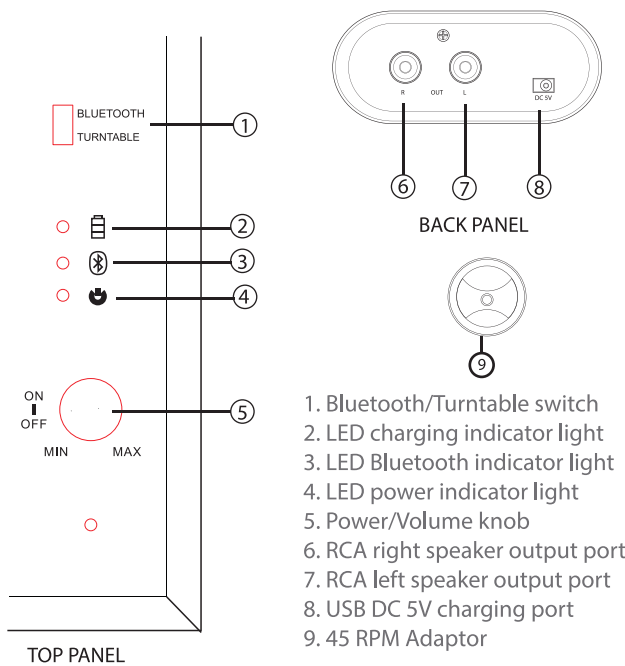

CHARGING THE TURNTABLE

- Charging via DC 5V port:
1. Connect the USB pin charging cable to the DC 5V charging port on the back of the turntable.
 2. Connect the USB end of the USB pin charging cable into your computer or other USB charging device.
 3. The LED charging indicator light is GREEN when charging. It will shut off when the turntable is fully charged.

i Make sure you charge the turntable for at least 8 hours before using it for the first time.

PAIRING THE TURNTABLE

1. Turn the turntable ON.
2. Move the Bluetooth/Turntable switch to the Bluetooth position. The LED Bluetooth indicator light will quickly flash BLUE.
3. Keep the turntable and Bluetooth enabled device within 3 feet of each other during the pairing process.
4. Set your Bluetooth enabled device to search for Bluetooth devices.

i If a paired device is in range, the turntable will connect to it automatically when the Bluetooth/Turntable switch is in the Bluetooth position.

On an iPhone
• Go to SETTINGS > BLUETOOTH (Make sure Bluetooth is turned ON)

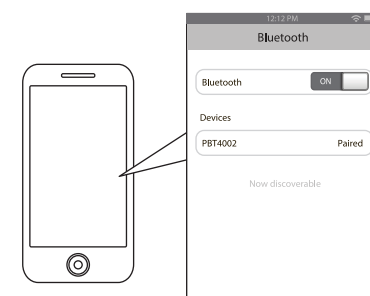

PAIRING THE TURNTABLE (cont'd)

On a Blackberry
• Go to SETTINGS/OPTIONS > BLUETOOTH
• Enable BLUETOOTH

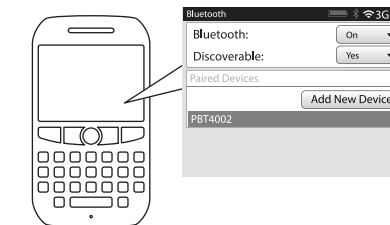

On an Android Phone
• Go to SETTINGS > BLUETOOTH > MENU > Search for devices (Make sure Bluetooth is turned ON)

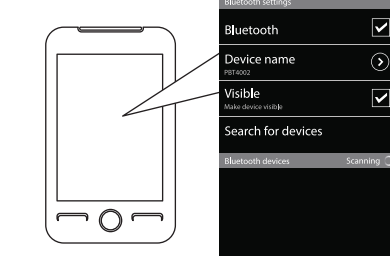

PAIRING THE TURNTABLE (cont'd)

On other Cell Phones/Devices
• Review the instruction manual that came with your phone/device.

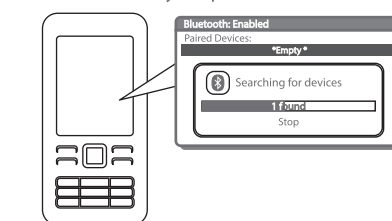

5. When the Bluetooth enabled device finds the turntable, select "PBT4002" from the list of found devices.
6. If required, enter the password 0000. Select OK or Yes to pair the two units.
7. After a successful pairing, the LED Bluetooth indicator light will flash BLUE slowly.

NOTE: If you would like to connect the turntable to another device, you must unpair the unit from the currently paired device first. In your device's Bluetooth settings, select "PBT4000", then select "unpair". When the turntable has been unpaired, it automatically goes into pairing mode again.

i The screenshots above are typical of many Bluetooth enabled devices in the market today, and are used to assist in the explanation of the pairing process. Your Bluetooth enabled device's interface and interaction with the turntable may slightly differ from the illustrations above.

USING THE TURNTABLE

- Powering ON/OFF
- Turn the Power/Volume knob to the right to turn the unit ON. Turn it all the way to the left to turn the unit OFF.
 - Check that your Bluetooth features are turned ON. If you have already paired the turntable with a Bluetooth enabled device, it will automatically connect.
 - If you are using the turntable for the first time, go to the "PAIRING THE TURNTABLE" section of this User Manual, and pair the turntable to your desired Bluetooth device.

- Adjusting the volume
- Turn the Power/Volume knob to the left (MIN) to decrease the volume.
 - Turn the Power/Volume knob to the right (MAX) to increase the volume.

Using the 45 RPM Adaptor

- The 45 RPM Adaptor allows you to play 45 RPM singles on 78 RPM spindle size turntables.
- Remove the 45 RPM Adaptor and place it on the spindle.
 - Place the record on the turntable. Make sure that the adaptor is secure.

PLAYING MUSIC

Playing wireless music
To enjoy wireless music on your Portable Turntable, make sure you are connected to a Bluetooth enabled device. Once connected press PLAY on your Bluetooth device. When playback has begun, you can control the music with your connected device (with devices that have the AVRCP Bluetooth profile).

Playing vinyl records
1. Place the record on the turntable and set the needle on the record.
2. Turn the Power/Volume knob to the right to turn the unit ON.
3. Move the Bluetooth/Turntable switch to the Turntable position.

- Adjusting the volume
- Turn the Volume knob to the left to decrease the volume.
 - Turn the Volume knob to the right to increase the volume.

i You may also adjust the volume from your connected device's volume control.

USING AS A WIRED TURNTABLE

1. Turn the turntable ON.
2. Connect one red plug and white plug of the included RCA Audio Cable to the corresponding right and left speaker output ports on the back of the turntable.
3. Connect the other ends of the RCA Audio cable to an external speaker system's input ports.
4. Open a media player on your device and click on PLAY to start playing your music.
5. Use the controls on your connected device to control music playback and volume.

NOTE: The Turntable's internal speaker volume can be increased or decreased when connected to a Bluetooth enabled device. It will also adjust the volume to an external speaker when connected with the included RCA Audio cable.

TROUBLESHOOTING

? I can pair the Portable Turntable with my Bluetooth device, but I cannot hear any music.

1. Make sure your Bluetooth device supports A2DP profile.
2. Turn up the volume on your Bluetooth device.
3. You may have to unpair the turntable, then re-pair to your device.
4. Use your connected device to increase the volume.

? My Bluetooth device is not able to pair with the Portable Turntable.

1. Make sure the Portable Turntable is turned ON before beginning the pairing process.
2. Keep the Portable Turntable and Bluetooth enabled device within 3 feet of each other during the pairing process.
3. Move the Bluetooth/Turntable switch to the Bluetooth position. The LED Bluetooth indicator light will quickly flash BLUE.
4. Check that YOUR device's Bluetooth feature is turned ON.
5. Try repeating the pairing process, see "Pairing the Turntable".
6. Make sure the turntable is fully charged.

TROUBLESHOOTING (cont'd)

? I cannot get the Portable Turntable into pairing mode.

1. Make sure the Portable Turntable is turned ON before beginning the pairing process.
2. Move the Bluetooth/Turntable switch to the Bluetooth position. The LED Bluetooth indicator light will quickly flash BLUE.
3. The turntable is now in pairing mode.

WARRANTY

This product as supplied and distributed new by AIT, Inc. ("AIT") to the original consumer purchaser is warranted by AIT against defects in material and workmanship for a period of one year from your date of purchase ("Warranty"). In the unlikely event that this product is defective, or does not perform properly, you may within one year from your original date of purchase return it to the authorized service center for repair or exchange.

- TO OBTAIN WARRANTY SERVICE:
- Call the Customer Support number located below, or go to our website portal to receive an SRO number.
 - Provide proof of the date of purchase within the package (Dated bill of sale).
 - Prepay all shipping costs to the authorized service center, and remember to insure your return.
 - Include a return shipping address (no P.O. boxes), a telephone contact number, and the defective unit within the package.
 - Describe the defect or reason you are returning the product.

Your product will be repaired or replaced, at our option, for the same or similar model of equal value if examination by the service center determines this product is defective. Products received damaged as a result of shipping, will require you to file a claim with the carrier.

The shipping address of the authorized service center is:
AIT, Inc.
ATTN: Customer Service (2nd Floor)
14-C 53rd Street
Brooklyn, NY 11232

IN NO EVENT WILL AIT, ITS MANUFACTURERS, DISTRIBUTORS OR PLR IP HOLDINGS, LLC BE LIABLE FOR ANY INCIDENTAL, DIRECT, INDIRECT, SPECIAL, PUNITIVE OR CONSEQUENTIAL DAMAGES (SUCH AS, BUT NOT LIMITED TO, DAMAGES FOR LOSS OF PROFITS, BUSINESS, SAVINGS, DATA OR RECORDS) RELATED TO THIS PRODUCT. EXCEPT AS STATED HEREIN, NO OTHER WARRANTIES SHALL APPLY.

Questions? Need some help? This manual will help you enjoy your new product.

If you still have questions, call our help line: 1-877-768-8481

or visit us at: www.southerntelecom.com Click on "Product Support"



Caution: Any changes or modifications not expressly approved could void the user's authority to operate the equipment.

Note: This equipment has been tested and found to comply with the limits for a Class B digital device, pursuant to part 15 of the FCC Rules. These limits are designed to provide reasonable protection against harmful interference in a residential installation. This equipment generates, uses and can radiate radio frequency energy and, if not installed and used in accordance with the instructions, may cause harmful interference to radio communications. However, there is no guarantee that interference will not occur in a particular installation. If this equipment does cause harmful interference to radio or television reception, which can be determined by turning the equipment off and on, the user is encouraged to try to correct the interference by one or more of the following measures:

- Reorient or relocate the receiving antenna.
- Increase the separation between the equipment and receiver.
- Connect the equipment into an outlet on a circuit different from that to which the receiver is connected.
- Consult the dealer or an experienced radio/TV technician for help.



PLR IP Holdings, LLC, its licensees and affiliates, fully support all electronic waste initiatives. As responsible stewards of the environment, and to avoid violating established laws, you should properly dispose of this product in compliance with all applicable regulations, directives or other governments in the area where you reside. Please check with local authorities or the retailer where you purchased this product to determine a location where you can appropriately dispose of the product.

This device complies with Part 15 of the FCC Rules. Operation is subject to the following two conditions:
(1) This device may not cause harmful interference, and
(2) This device must accept any interference received, including interference that may cause undesired operation.