

165mm

90mm

Accel Portable Wireless Mouse and Pad

Instruction Manual
7142-59

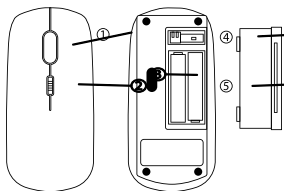

Features:

1. Scroll Wheel
2. DPI Button
3. Motion Sensor
4. USB Receiver
5. Battery Compartment
6. Mouse Cover

What's included:

- 1 x Accel Portable Wireless Mouse
- 1 x Mouse Pad Storage Bag
- 2 x AAA Batteries
- 1 x Instruction Manual

Tech Specifications

- DPI: 800-1200-1600DPI
- Frequency: 2405-2475MHz
- Speed: 1-2Mbps
- Operating System: Windows 98/ME/ 2000/ XP/Vista/Win7/Win 8/Win10/Mac

Instructions:

1. **Battery Installation:**
 - a. Remove the AAA batteries from packaging.
 - b. Open the Battery Cover of the mouse, place batteries accordingly to +/- displays.
 - c. Place battery cover back on the mouse, press until cover clicks into place.

2. Wireless Receiver Installation

1. Remove the mouse cover(6) to reveal the USB Receiver(4).
- Remove the USB receiver, and insert into the USB port of the notebook or PC.
- Computer will identify the receiver automatically or wireless mouse will begin installation instructions.

- Once fully installed mouse, move the mouse around on a flat surface while pressing the scroll wheel and the mouse will connect to the wireless receiver.
- **Note: If using a desktop PC, the distance from workspace to computer could cause connection issues to the receiver. Suggestion would be to use a extended USB Cable*

3. DPI Button Function

- Press the DPI Button to switch between 800 - 1200 - 1600 DPI.
- DPI Function enables you to adjust the mouse sensitivity to a faster or slower pointer speed.

Attention:

1. Auto-sleeping and power sleeping function, device will automatically sleep if inactive for a set amount of time and will reactivate once any key is pressed.
2. Optical mouse could have operating issues on glass, black, and reflective surfaces.
- ** For the best operation, please use a mouse pad.*

SAFETY PRECAUTIONS:

WARNING—When using this product, basic precautions should always be followed, including the following:

1. Read all the instructions before using the product.
2. To reduce the risk of injury, close supervision is necessary when the product is used near children.
3. Do not expose the device to moisture.
4. Do not use the device if damaged or modified.
5. Damaged or modified batteries may exhibit unpredictable behavior resulting in fire, explosion or risk of injury.
6. Do not disassemble the device. Take it to a qualified service person when service or repair is required. Incorrect reassembly may result in a risk of fire or injury.
7. Do not expose the device to fire or excessive temperature. Exposure to fire or temperatures above 212°F may cause explosion.
8. Have servicing performed by a qualified repair person using only identical replacement parts.
This will ensure that the safety of the product is maintained.

FCC Statement:

This device complies with Part 15 of the FCC Rules. Operation is subject to the following two conditions:

- (1) This device may not cause harmful interference, and
- (2) This device must accept any interference received, including interference that may cause undesired operation.

Warning:

Changes or modifications not expressly approved by the party responsible for compliance could void the user's authority to operate the equipment.

Note:

This equipment has been tested and found to comply with the limits for a Class B digital device, pursuant to part 15 of the FCC Rules. These limits are designed to provide reasonable protection against harmful interference in a residential installation. This equipment generates, uses and can radiate radio frequency energy and, if not installed and used in accordance with the instructions, may cause harmful interference to radio communications. However, there is no guarantee that interference will not occur in a particular installation. If this equipment does cause harmful interference to radio or television reception, which can be determined by turning the equipment off and on, the user is encouraged to try to correct the interference by one or more of the following measures:

- Reorient or relocate the receiving antenna.
- Increase the separation between the equipment and receiver.
- Connect the equipment into an outlet on a circuit different from that to which the receiver is connected.
- Consult the dealer or an experienced radio/TV technician for help.

(c) The provisions of paragraphs (a) and (b) of this section do not apply to digital devices exempted from the technical standards under the provisions of § 15.103.
(d) For systems incorporating several digital devices, the statement shown in paragraph

(a) or (b) of this section needs to be contained only in the instruction manual for the main control unit.

(e) In cases where the manual is provided only in a form other than paper, such as on a computer disk or over the Internet, the information required by this section may be included in the manual in that alternative form, provided the user can reasonably be expected to have the capability to access information in that form.



FCC ID: 2ABHA106
MADE IN CHINA

41mm